

Product Description:

Metal Era's Anchor-Tite Drip Edge combines custom engineering and superior performance with an attractive appearance. The patented extruded aluminum anchor bar securely terminates the IB PVC membrane, providing protection superior to any other manufactured or shop-fabricated roof edge. The low profile roofing flange allows for water drainage as needed for drip edge conditions.

This top-line drip edge provides the maximum protection against wind uplift damage that is available in today's roofing market. It also comes with the industry's best warranty - a Lifetime, 215 mph Wind Warranty.

Testing:

- Tested per ANSI/SPRI/FM 4435/ES-1 Standard to a design pressure of 577 lbs./ft² to comply with the International Building Code.
- Factory Mutual 1-585 approved for wind uplift protection.

Sizes:

Sizes range from 4 ½" up to 7 ½" face heights to accommodate multiple nailers and coverage requirements.

- 4 ½" Drip Edge
- 6" Drip Edge
- 7 ½" Drip Edge

Packaging:

Individual pieces per 12' section

Features:

- 12' lengths with pre-punched holes for quicker installation.
- Covers available in 24 ga. steel and .040 aluminum
- Low profile roof flange allows for water drainage as needed for drip edge conditions.
- Radiused and specially fabricated options available
- Eliminates stripping-in or heat welding thanks to non-penetrating design.
- Ensures proper fit and eliminates field fabrication with prefabricated miters and accessories.
- Complements your design with standard and custom finishes and convenient sizes.
- A 30 year Kynar 500® finish warranty is included on coil-coated standard colors.

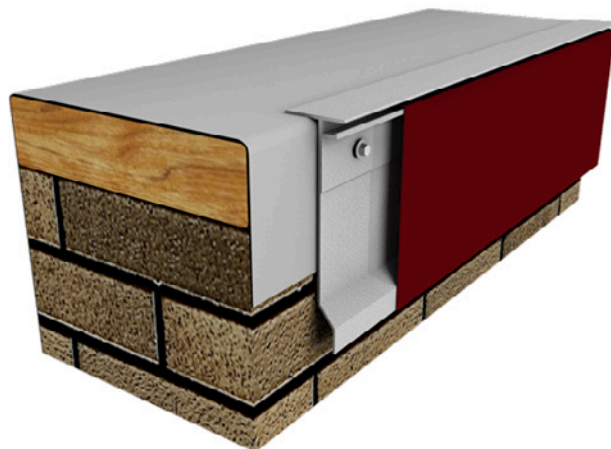

Available Colors:

Standard colors are made from Valspar's Fluropon® High Performance Hylar 5000®/Kynar 500® finish, offering the ultimate in resistance against fading and weathering. Choose among a wide range of standard colors and finishes that meet your job requirements. See color chart for detailed information at www.metalera.com.

Custom Finishes:

- Custom post-coated Kynar 500® colors are available with an included 10 year Kynar 500® finish warranty or a 20 year Kynar 500® finish warranty is available upon request.
- Anodized finishes are also available and come with a 5 year warranty (no warranty available for coil anodized finishing).
- Post-coat/Class 1 Batch Anodized is available with a 5 Year warranty with an option to increase to a 10 Year warranty for an up charge).

Warranty:

The Lifetime, 215 mph is available on all Metal-Era manufactured Anchor-Tite products. It covers replacement or repair of any portion of the system that has failed due to a defect in Metal-Era supplied materials. The warranty covers the roof edge for the lifetime of the roof on which it was originally installed.