

## Mechanically Attached Membrane - Separation Sheet - Wood Deck (New or Tear-Off)

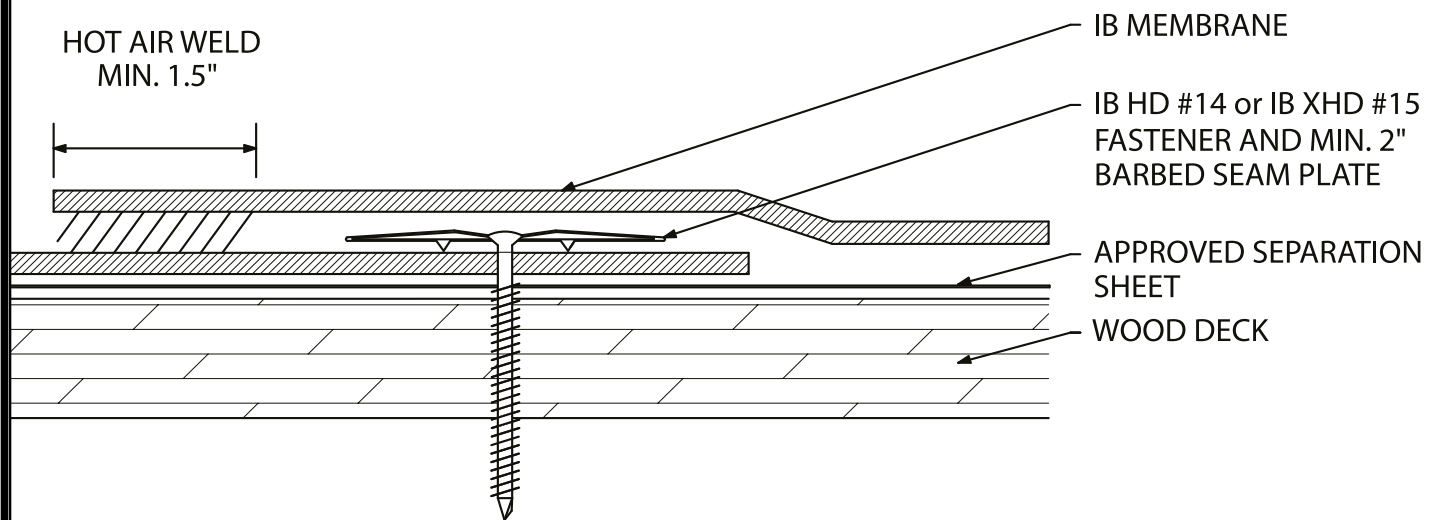

Fire Rating / Max. Slope	Deck Type	Fire Sheet		IB Membrane		Max. Design Pressure**
		Type	Attachment	Fasteners	Attachment	
'Not Rated	7/16" OSB	Approved IB Separation Sheet	Min. IB SD #12, 3" IB Insulation Plate (Preliminarily Attached)	IB HD #14 or XHD #15, IB 2" Barbed Seam Plate	In-Seam 6" o.c. Min. x 67"	Minimum Req for IB Warranty
'Not Rated	5/8" OSB	Approved IB Separation Sheet	Min. IB SD #12, 3" IB Insulation Plate (Preliminarily Attached)	IB HD #14 or XHD #15, IB 2" Barbed Seam Plate	In-Seam 12" o.c. Min. x 67"	Minimum Req for IB Warranty
'Not Rated	1/2" Plywood	Approved IB Separation Sheet	Min. IB SD #12, 3" IB Insulation Plate (Preliminarily Attached)	IB HD #14 or XHD #15, IB 2" Barbed Seam Plate	In-Seam 12" o.c. Min. x 67"	Minimum Req for IB Warranty
'Not Rated	1/2" Plywood	Approved IB Separation Sheet	Min. IB SD #12, 3" IB Insulation Plate (Preliminarily Attached)	IB HD #14 or XHD #15, IB 2" Barbed Seam Plate	In-Seam 6" o.c. Min. x 67"	-37.5 psf (Class 75)
'Not Rated	19/32" Plywood	Approved IB Separation Sheet	Min. IB SD #12, 3" IB Insulation Plate (Preliminarily Attached)	IB HD #14 or XHD #15, IB 2" Barbed Seam Plate	In-Seam 12" o.c. Min. x 67"	-30.0 psf (Class 60)
'Not Rated	19/32" Plywood	Approved IB Separation Sheet	Min. IB SD #12, 3" IB Insulation Plate (Preliminarily Attached)	IB HD #14 or XHD #15, IB 2" Barbed Seam Plate	In-Seam 6" o.c. Min. x 67"	-45.0 psf (Class 90)
'Not Rated	19/32" Plywood	Approved IB Separation Sheet	Min. IB SD #12, 3" IB Insulation Plate (Preliminarily Attached)	IB XHD #15, IB 2-3/8" Barbed Seam Plate	In-Seam 6" o.c. Min. x 67"	-67.5 psf (Class 135)
'Not Rated	19/32" Plywood	Approved IB Separation Sheet	Min. IB SD #12, 3" IB Insulation Plate (Preliminarily Attached)	IB XHD #15, IB 2-3/8" Barbed Seam Plate	In-Seam 6" o.c. Min. x 31"	-127.5 psf (Class 255)

Approved Separation Sheet: IB Separator Sheet, IB Poly Separator Sheet, IB HD Poly Separator Sheet

Fire Classification Note: 'This assembly is not UL Classified.

\*\*Refer to Substrate Resistance Table for required pull-out values.

For additional information about IB Roof Systems requirements, recommendations, installation details, approvals, and limitations for the above assemblies, please refer to the latest edition of the IB Roof Systems Specifications Manual. For Technical Services please contact IB Technical Department at 800-426-1626.

Membranes:	Membrane Color:					Warranty Length***			Warranty Type***	
IB PVC Single-Ply 50 Mil	White*	Gray	Tan	Bronze	ChemGuard*	10 Year	15 Year	20 Year	Total Systems - No Dollar Limit (TSW) Warranty Plus (WP) Commercial Limited Material Warranty (CLMW) Residential Limited Material Warranty (RLMW)	
IB PVC Single-Ply 60 Mil	White*	Cool Sand*	Cool Stone*	Gray	Tan	15 Year	20 Year	25 Year		
IB PVC Single-Ply 80 Mil	White*	Gray	Tan	Bronze	ChemGuard*	15 Year	20 Year	25 Year		

\*Meets CRRG, Title 24 & EnergyStar Standards

\*\*\*Refer to Warranty Selection Guide for Warranty Riders, Term Length Limitations, and eligibility requirements of the Warranty Program

Submitted By:

Address:

Email:

Project Name:

Address:

