

Mechanically Attached Membrane - Cover Board - Insulation - Existing Roof - Wood Deck (Recover)

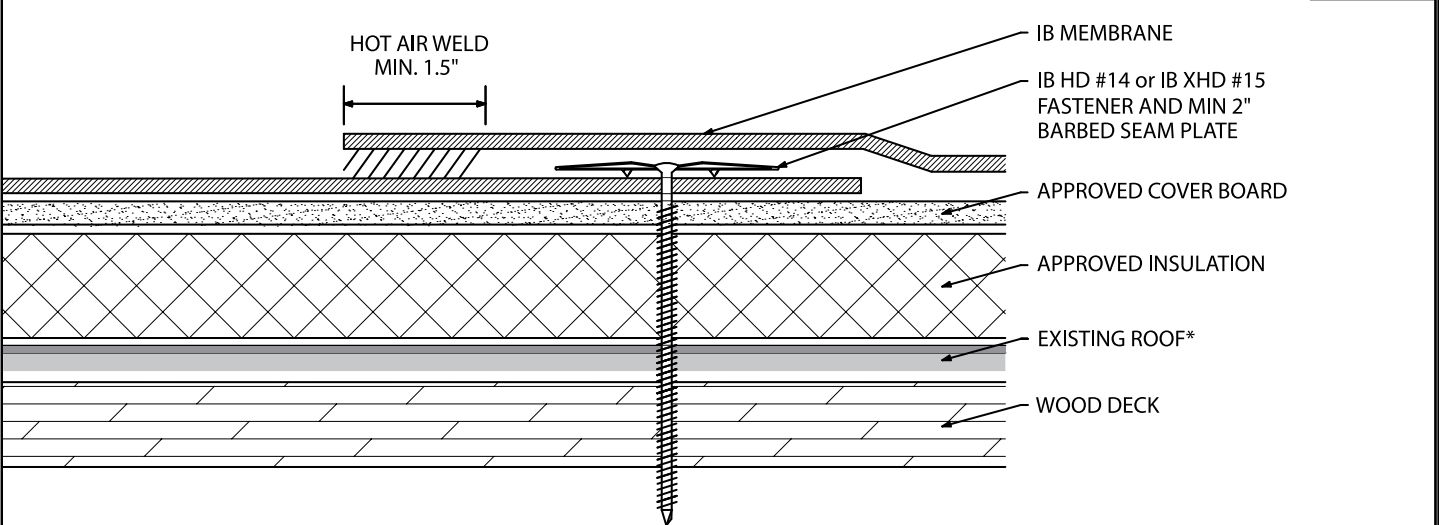

Fire Rating / Max. Slope		Deck Type	Cover Board / Insulation (over Existing Roof)		IB Membrane		Max. Design Pressure**
			Type	Attachment	Fasteners	Attachment	
	Not Rated	7/16" OSB	Approved Cover Board & Approved Insulation	Min. IB SD #12, 3" IB Insulation Plate (6 per 4' x 8')	IB HD #14 or XHD #15, IB 2" Barbed Seam Plate	In-Seam 6" o.c. Min. x 67"	Minimum Req for IB Warranty
	'Class "A" Unlimited	5/8" OSB	Approved Cover Board & Approved Insulation	Min. IB SD #12, 3" IB Insulation Plate (6 per 4' x 8')	IB HD #14 or XHD #15, IB 2" Barbed Seam Plate	In-Seam 12" o.c. Min. x 67"	Minimum Req for IB Warranty
	'Class "A" Unlimited	1/2" Plywood	Approved Cover Board & Approved Insulation	Min. IB SD #12, 3" IB Insulation Plate (6 per 4' x 8')	IB HD #14 or XHD #15, IB 2" Barbed Seam Plate	In-Seam 12" o.c. Min. x 67"	Minimum Req for IB Warranty
	'Class "A" Unlimited	1/2" Plywood	Approved Cover Board & Approved Insulation	Min. IB SD #12, 3" IB Insulation Plate (6 per 4' x 8')	IB HD #14 or XHD #15, IB 2" Barbed Seam Plate	In-Seam 6" o.c. Min. x 67"	-37.5 psf (Class 75)
	'Class "A" Unlimited	19/32" Plywood	Approved Cover Board & Approved Insulation	Min. IB SD #12, 3" IB Insulation Plate (6 per 4' x 8')	IB HD #14 or XHD #15, IB 2" Barbed Seam Plate	In-Seam 12" o.c. Min. x 67"	-30.0 psf (Class 60)
	'Class "A" Unlimited	19/32" Plywood	Approved Cover Board & Approved Insulation	Min. IB SD #12, 3" IB Insulation Plate (6 per 4' x 8')	IB HD #14 or XHD #15, IB 2" Barbed Seam Plate	In-Seam 6" o.c. Min. x 67"	-45.0 psf (Class 90)
	'Class "A" Unlimited	19/32" Plywood	Approved Cover Board & Approved Insulation	Min. IB SD #12, 3" IB Insulation Plate (6 per 4' x 8')	IB XHD #15, IB 2-3/8" Barbed Seam Plate	In-Seam 6" o.c. Min. x 67"	-67.5 psf (Class 135)
	'Class "A" Unlimited	19/32" Plywood	Approved Cover Board & Approved Insulation	Min. IB SD #12, 3" IB Insulation Plate (6 per 4' x 8')	IB XHD #15, IB 2-3/8" Barbed Seam Plate	In-Seam 6" o.c. Min. x 31"	-127.5 psf (Class 255)

Existing Roof: APP or SBS modified bitumen, smooth or granule surfaced asphaltic built-up roof, or single-ply membrane (CPA, CSPE, EPDM, PVC, or TPO)

Approved Insulation: IB EnergyBoard II or III, or IB Approved UL Classified Polyisocyanurate, IB Approved UL Classified Expanded Polystyrene, IB Approved UL Classified Extruded Polystyrene Insulation

Approved Cover Board: DensDeck, DensDeck Prime, DensDeck StormX, Securock Ultralight Glass-Mat, Securock Ultralight Coated Glass-Mat, Securock Gypsum Fiber Board, DexCell Glass-Mat Roof Board, or DexCell FA Glass Mat Roof Board, minimum 1/2" thickness; or minimum 1/2" thickness IB HD ISO or H-Shield HD ISO; or minimum 1/2" thickness Structodek HD Primed. Note: Use of cover board less than 1/2" may not maintain UL classification.

Fire Classification Note: 1UL Class A over existing Class A or maintains existing classification without slope limitation when utilized with any UL Classified polyisocyanurate, any thickness and minimum 1/2" UL Classified gypsum cover board over an existing insulated or non-insulated cap sheet or smooth surfaced roof. 2Maintains existing Classification for any Class A, B or C, coated or uncoated, insulated, or un-insulated, smooth surfaced, Type G3 mineral surfaced cap sheet or mineral surfaced modified bitumen membrane BUR system when utilized with any UL Classified insulation and minimum 1/4" Securock Gypsum Fiber Board. 3The use of other IB Approved cover boards may not retain UL Classification. 4Recover over existing single-ply roof may not retain fire classification.

****Refer to Substrate Resistance Table for required pull-out values.**

For additional information about IB Roof Systems requirements, recommendations, installation details, approvals, and limitations for the above assemblies, please refer to the latest edition of the IB Roof Systems Specifications Manual. For Technical Services please contact IB Technical Department at 800-426-1626.

Membranes:	Membrane Color:					Warranty Length***			Warranty Type***
IB PVC Single-Ply 50 Mil	White*	Gray	Tan	Bronze	ChemGuard*	10 Year	15 Year	20 Year	Total Systems - No Dollar Limit (TSW)
IB PVC Single-Ply 60 Mil	White*	Cool Sand*	Cool Stone*	Gray	Tan	15 Year	20 Year	25 Year	Warranty Plus (WP)
IB PVC Single-Ply 80 Mil	White*	Gray	Tan	Bronze	ChemGuard*	15 Year	20 Year	25 Year	Commercial Limited Material Warranty (CLMW)
									Residential Limited Material Warranty (RLMW)

*Meets CRRC, Title 24 & EnergyStar Standards

***Refer to Warranty Selection Guide for Warranty Riders, Term Length Limitations, and eligibility requirements of the Warranty Program

Submitted By:

Address:

Email:

Project Name:

Address: