

Mechanically Attached Membrane - Cover Board - Insulation - Steel Deck (New or Tear-off)

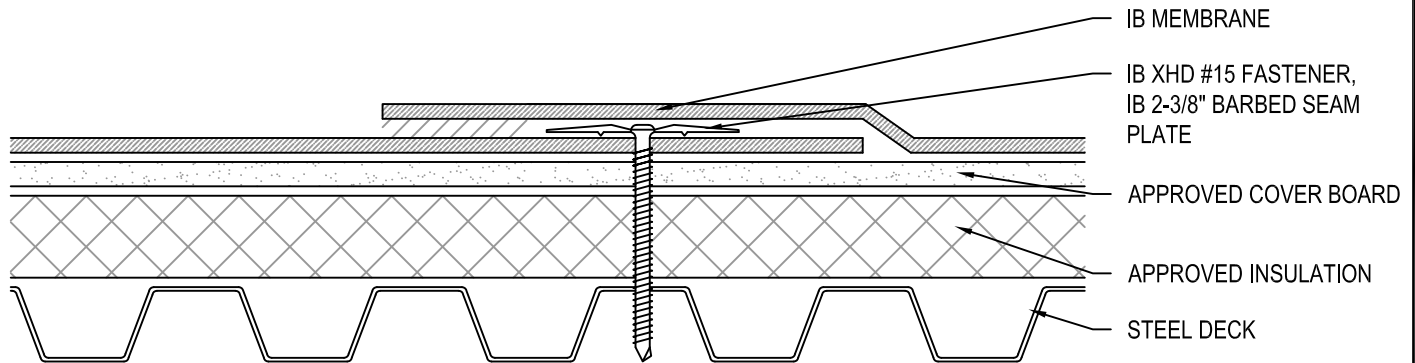

Fire Rating / Max. Slope	Deck Type	Cover Board / Insulation		IB Membrane		Max. Design Pressure**
		Type	Attachment	Fasteners	Attachment	
<input type="checkbox"/> Class 'A' Unlimited	Min. 22 ga., Type B, Grade 80 Steel	Approved Cover Board & Approved Insulation	IB SD #12, IB 3" Insulation Plate (6 per 4' x 8')	IB XHD #15, IB 2-3/8" Barbed Seam Plate	18" o.c. Min.	-30.0 psf (Class 60)
<input type="checkbox"/> Class 'A' Unlimited	Min. 22 ga., Type B, Grade 80 Steel	Approved Cover Board & Approved Insulation	IB SD #12, IB 3" Insulation Plate (6 per 4' x 8')	IB XHD #15, IB 2-3/8" Barbed Seam Plate	12" o.c. Min.	-45.0 psf (Class 90)
<input type="checkbox"/> Class 'A' Unlimited	Min. 22 ga., Type B, Grade 80 Steel	Approved Cover Board & Approved Insulation	IB SD #12, IB 3" Insulation Plate (6 per 4' x 8')	IB XHD #15, IB 2-3/8" Barbed Seam Plate	6" o.c. Min.	-60.0 psf (Class 120)

Approved Cover Board: Dens Deck, Dens Deck Prime, Securock Glass-Mat or Gypsum-Fiber Roof Board, minimum 1/4" thickness.

Approved Insulation: IB Energy Board II & III or IB Approved UL Classified Polyisocyanurate Insulation, minimum 1.5" thickness.

** Refer to Substrate Resistance table for required pull-out values.

For additional information about IB Roof Systems requirements, recommendations, installation details, approvals and limitations for the above assemblies, please refer to the latest edition of the IB Roof Systems Specifications Manual. For Technical Services please contact us at 800-426-1626.

Membranes:	Colors:	Warranties:	Warranty Lengths:
<input type="checkbox"/> 50 Mil Membrane	<input type="checkbox"/> White* <input type="checkbox"/> Cool Sand* <input type="checkbox"/> ChemGuard*	<input type="checkbox"/> Total System (NDL)	<input type="checkbox"/> 10 yr (50, 60, and 80 mil)
<input type="checkbox"/> 60 Mil Membrane	<input type="checkbox"/> Gray <input type="checkbox"/> Green <input type="checkbox"/> Red	<input type="checkbox"/> Warranty Plus	<input type="checkbox"/> 15 yr (50, 60, and 80 mil)
<input type="checkbox"/> 80 Mil Membrane	<input type="checkbox"/> Tan <input type="checkbox"/> Brown <input type="checkbox"/> Custom: _____	<input type="checkbox"/> Commercial Limited Material	<input type="checkbox"/> 20 yr (60 and 80 mil)
	* Meets CRRC, Title-24, & EnergyStar Standards	<input type="checkbox"/> Lifetime Residential Limited Material	<input type="checkbox"/> 25 yr (80 mil)

Submitted By: Address: Telephone:	Project Name: Address:
--	----------------------------------

