

## Mechanically Attached Membrane - Insulation - Existing Roof - Steel Deck (Recover)

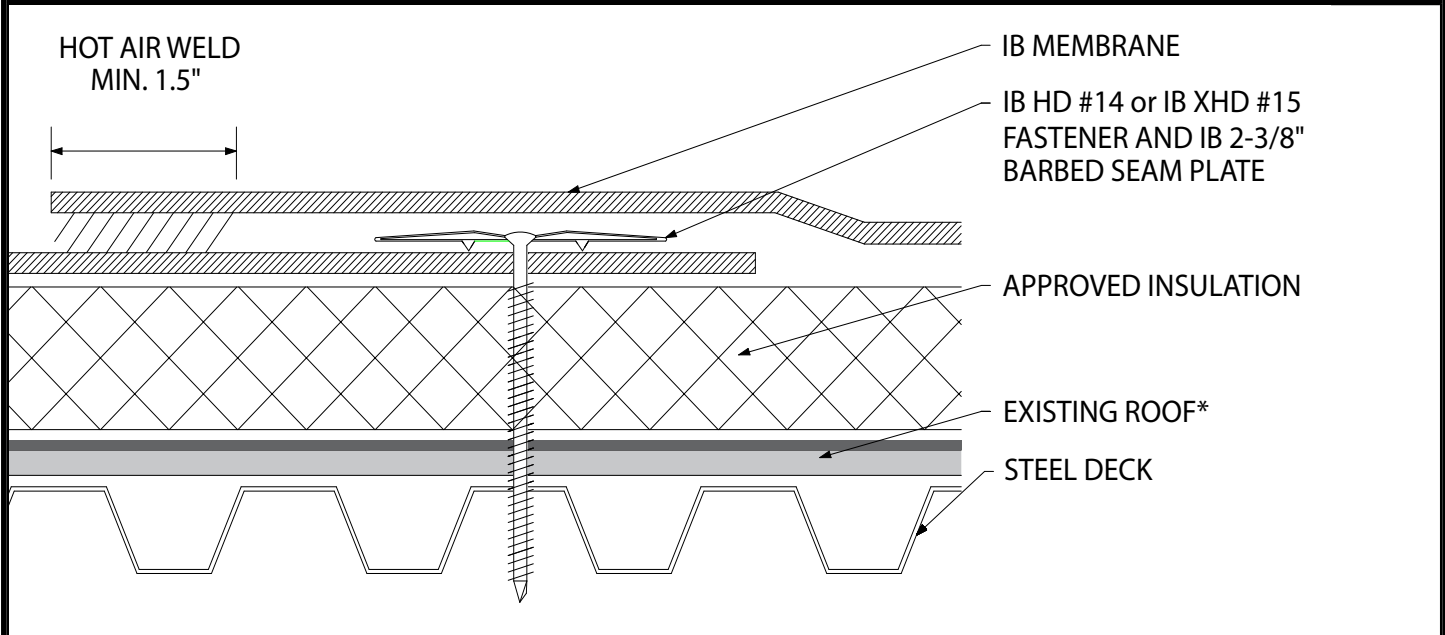

Fire Rating / Max. Slope	Deck Type	Insulation (over Existing Roof)		IB Membrane		Max. Design Pressure**
		Type	Attachment	Fasteners	Attachment	
'Class 'A' 3":12"	Min. 22 ga. Type B, Grade 33 Steel	Approved IB Insulation	Min. IB SD #12, 3" IB Insulation Plate (6 per 4' x 8')	IB HD #14 or XHD #15, IB 2-3/8" Barbed Seam Plate	In-Seam 18" o.c. Min. x 67"	Minimum Req for IB Warranty
'Class 'A' 3":12"	Min. 22 ga. Type B, Grade 33 Steel	Approved IB Insulation	Min. IB SD #12, 3" IB Insulation Plate (6 per 4' x 8')	IB HD #14 or XHD #15, IB 2-3/8" Barbed Seam Plate	In-Seam 12" o.c. Min. x 67"	Minimum Req for IB Warranty
'Class 'A' 3":12"	Min. 22 ga. Type B, Grade 33 Steel	Approved IB Insulation	Min. IB SD #12, 3" IB Insulation Plate (6 per 4' x 8')	IB HD #14 or XHD #15, IB 2-3/8" Barbed Seam Plate	In-Seam 6" o.c. Min. x 67"	Minimum Req for IB Warranty
'Class 'A' 3":12"	Min. 22 ga. Type B, Grade 80 Steel	Approved IB Insulation	Min. IB SD #12, 3" IB Insulation Plate (6 per 4' x 8')	IB XHD #15, IB 2-3/8" Barbed Seam Plate	In-Seam 18" o.c. Min. x 67"	-30.0 psf (Class 60)
'Class 'A' 3":12"	Min. 22 ga. Type B, Grade 80 Steel	Approved IB Insulation	Min. IB SD #12, 3" IB Insulation Plate (6 per 4' x 8')	IB XHD #15, IB 2-3/8" Barbed Seam Plate	In-Seam 12" o.c. Min. x 67"	-45.0 psf (Class 90)
'Class 'A' 3":12"	Min. 22 ga. Type B, Grade 80 Steel	Approved IB Insulation	Min. IB SD #12, 3" IB Insulation Plate (6 per 4' x 8')	IB XHD #15, IB 2-3/8" Barbed Seam Plate	In-Seam 6" o.c. Min. x 67"	-67.5 psf (Class 135)
'Class 'A' 3":12"	Min. 22 ga. Type B, Grade 80 Steel	Approved IB Insulation	Min. IB SD #12, 3" IB Insulation Plate (6 per 4' x 8')	IB XHD #15, IB 2-3/8" Barbed Seam Plate	In-Seam 6" o.c. Min. x 31"	-127.5 psf (Class 255)

**Existing Roof:** APP or SBS modified bitumen, smooth, granule or gravel surfaced asphaltic built-up roof, or Single-Ply (CPA, CSPE, EPDM, PVC or TPO)

**Approved Insulation:** IB EnergyBoard II or III; H-Shield or H-Shield CG; or IB Approved UL Classified Polyisocyanurate Insulation

**Fire Classification Note(s):** <sup>1</sup>UL Class A up to 3":12" when utilized with IB EnergyBoard II or AC Foam II, any thickness, over an existing insulated or non-insulated cap, sheet smooth or gravel surfaced (loose gravel may be removed). <sup>2</sup>UL Class A up to 1/2":12" when utilized with one layer of 3" or two layers of 1.5" H-Shield CG, over an existing Class A, B or C roofing system (gravel may be removed from gravel built-up or ballasted single-ply system). <sup>3</sup>UL Class B up to 1/2":12" when utilized with minimum 1.9" H-Shield CG over an existing Class A, B or C roofing system (gravel may be removed from gravel built-up or ballasted single-ply system). <sup>4</sup>The use of other IB Approved Insulations or lesser thicknesses may not retain Classification.

\*\*Refer to Substrate Resistance Table for required pull-out values.

For additional information about IB Roof Systems requirements, recommendations, installation details, approvals, and limitations for the above assemblies, please refer to the latest edition of the IB Roof Systems Specifications Manual. For Technical Services please contact IB Technical Department at 800-426-1626.

Membranes:	Membrane Color:					Warranty Length***			Warranty Type***
IB PVC Single-Ply 50 Mil	White*	Gray	Tan	Bronze	ChemGuard*	10 Year	15 Year	20 Year	Total Systems - No Dollar Limit (TSW)
IB PVC Single-Ply 60 Mil	White*	Cool Sand*	Cool Stone*	Gray	Tan	15 Year	20 Year	25 Year	Warranty Plus (WP)
IB PVC Single-Ply 80 Mil	White*	Gray	Tan	Bronze	ChemGuard*	15 Year	20 Year	25 Year	Commercial Limited Material Warranty (CLMW)
									Residential Limited Material Warranty (RLMW)

\*Meets CRRC, Title 24 & EnergyStar Standards

\*\*\*Refer to Warranty Selection Guide for Warranty Riders, Term Length Limitations, and eligibility requirements of the Warranty Program

Submitted By:

Project Name:

Address:

Address:

Email:

