

Mech. Attch. Membrane - Cover - Insulation - Vapor Barrier - Thermal Barrier - Steel Deck (New or Tear Off)

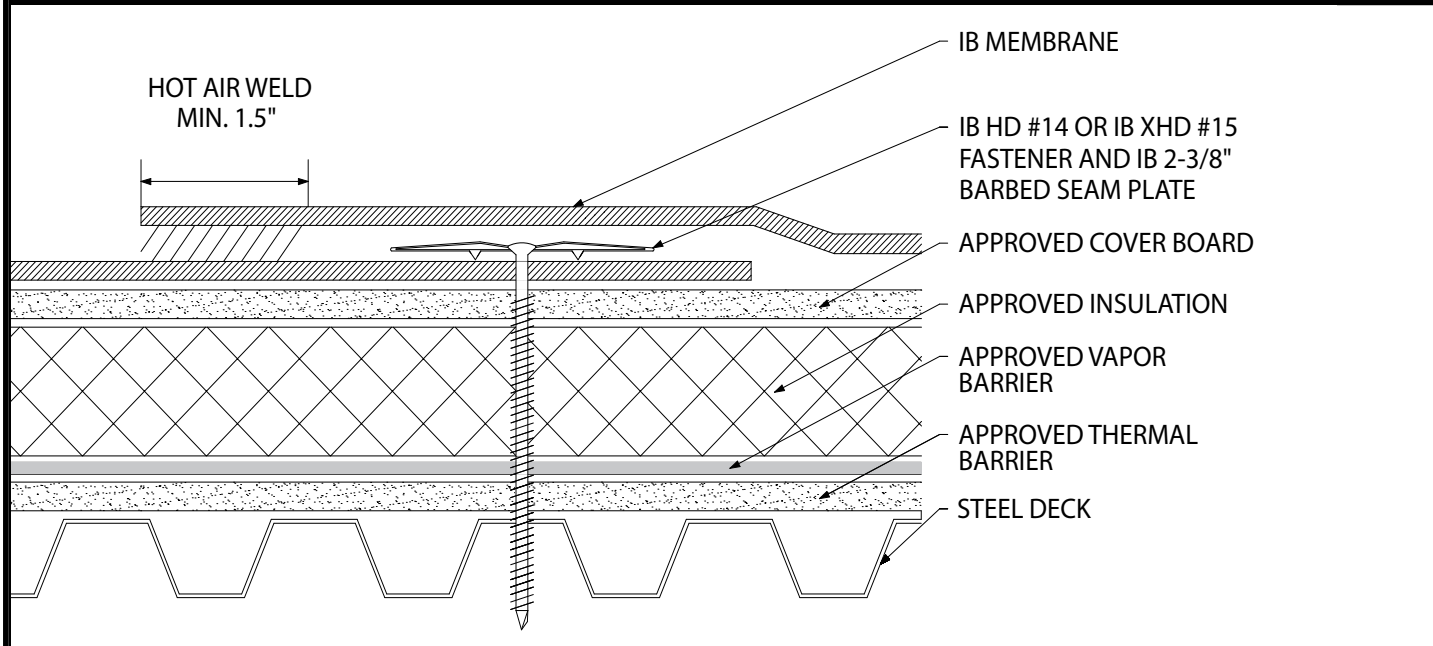

Fire Rating / Max. Slope	Deck Type	Cover Board/Insulation (over Vapor Barrier/Thermal Barrier)		IB Membrane		Max. Design Pressure**
		Type	Attachment	Fasteners	Attachment	
'Class 'A' ½":12"	Min. 22 ga. Type B, Grade 80 Steel	Approved Cover Board/ Insulation & Approved Vapor Barrier/Thermal Barrier	Min. IB SD #12, 3" IB Insulation Plate 1 per 2 sq ft (16 per 4' x 8')	IB XHD #15, IB 2-3/8" Barbed Seam Plate	In-Seam 18" o.c. Min. x 67"	-30.0 psf (Class 60)
'Class 'A' ½":12"	Min. 22 ga. Type B, Grade 80 Steel	Approved Cover Board/ Insulation & Approved Vapor Barrier/Thermal Barrier	Min. IB SD #12, 3" IB Insulation Plate 1 per 2 sq ft (16 per 4' x 8')	IB XHD #15, IB 2-3/8" Barbed Seam Plate	In-Seam 12" o.c. Min. x 67"	-45.0 psf (Class 90)
'Class 'A' ½":12"	Min. 22 ga. Type B, Grade 80 Steel	Approved Cover Board/ Insulation & Approved Vapor Barrier/Thermal Barrier	Min. IB SD #12, 3" IB Insulation Plate 1 per 2 sq ft (16 per 4' x 8')	IB XHD #15, IB 2-3/8" Barbed Seam Plate	In-Seam 6" o.c. Min. x 67"	-67.5 psf (Class 135)
'Class 'A' ½":12"	Min. 22 ga. Type B, Grade 80 Steel	Approved Cover Board/ Insulation & Approved Vapor Barrier/Thermal Barrier	Min. IB SD #12, 3" IB Insulation Plate 1 per 2 sq ft (16 per 4' x 8')	IB XHD #15, IB 2-3/8" Barbed Seam Plate	In-Seam 6" o.c. Min. x 31"	-127.5 psf (Class 255)

Thermal Barrier: DensDeck Prime, DensDeck StormX, Securock Ultralight Coated Glass-Mat, Securock Gypsum Fiber Board, or DexCell FA Glass Mat Roof Board, minimum ½" thickness

Approved Vapor Barrier: IBarrier SA Membrane, or SopraVap'r SA applied using self-adhesive techniques

Approved Insulation: IB EnergyBoard II or III; or H-Shield or H-Shield CG; or IB Approved UL Classified Polyisocyanurate Insulation; IB Approved UL Classified Expanded Polystyrene, IB Approved UL Classified Extruded Polystyrene Insulation

Approved Cover Board: DensDeck, DensDeck Prime, DensDeck StormX, Securock Ultralight Glass-Mat, Securock Ultralight Coated Glass-Mat, Securock Gypsum Fiber Board, DexCell Glass-Mat Roof Board, or DexCell FA Glass Mat Roof Board, minimum ¼" thickness; IB HD ISO or H-Shield HD ISO, minimum ½" thickness; or Structodek HD Primed, minimum ½" thickness

Fire Classification Note: ¹UL Class 'A' up to ½":12" over any of the above listed IB Approved Vapor Barrier when utilized with minimum 1" H-Shield CG or 3" IB EnergyBoard III or AC Foam-III and minimum ¼" DensDeck, DensDeck Prime, Securock Ultralight Glass-Mat, Securock Ultralight Coated Glass-Mat, DexCell Glass-Mat Roof Board, or DexCell FA Glass Mat Roof Board, or minimum 7/16" DexCell Cement Board or minimum ½" gypsum board over any of the above listed IB Approved Vapor Barrier. ²UL Class 'A' up to ½":12" over any of the above listed IB Approved Vapor Barrier when utilized with minimum ½" IB HD ISO or H-Shield HD ISO over any UL Classified insulation (except expanded or extruded polystyrene), any combination, any thickness, may be used below the 1/2 in. minimum thickness. ³Use of other IB Approved Insulations and/or IB Approved Cover Boards and/or any Vapor Barrier not listed above may not achieve UL Classification.

**Refer to Substrate Resistance Table for required pull-out values.

For additional information about IB Roof Systems requirements, recommendations, installation details, approvals, and limitations for the above assemblies, please refer to the latest edition of the IB Roof Systems Specifications Manual. For Technical Services please contact IB Technical Department at 400-426-1626.

Membranes:	Membrane Color:					Warranty Length***			Warranty Type***
IB PVC Single-Ply 50 Mil	White*	Gray	Tan	Bronze	ChemGuard*	10 Year	15 Year	20 Year	Total Systems - No Dollar Limit (TSW) Warranty Plus (WP) Commercial Limited Material Warranty (CLMW) Residential Limited Material Warranty (RLMW)
IB PVC Single-Ply 60 Mil	White*	Cool Sand*	Cool Stone*	Gray	Tan	15 Year	20 Year	25 Year	
IB PVC Single-Ply 80 Mil	White*	Gray	Tan	Bronze	ChemGuard*	20 Year	25 Year	30 Year	
*Meets CRRC, Title 24 & EnergyStar Standards						***Refer to Warranty Selection Guide for Warranty Riders, Term Length Limitations, and eligibility requirements of the Warranty Program			
Submitted By:						Project Name:			
Address:						Address:			
Email:									

