

Mechanically Attached Membrane - Cover Board - Insulation - Existing Roof - Steel Deck (Recover)

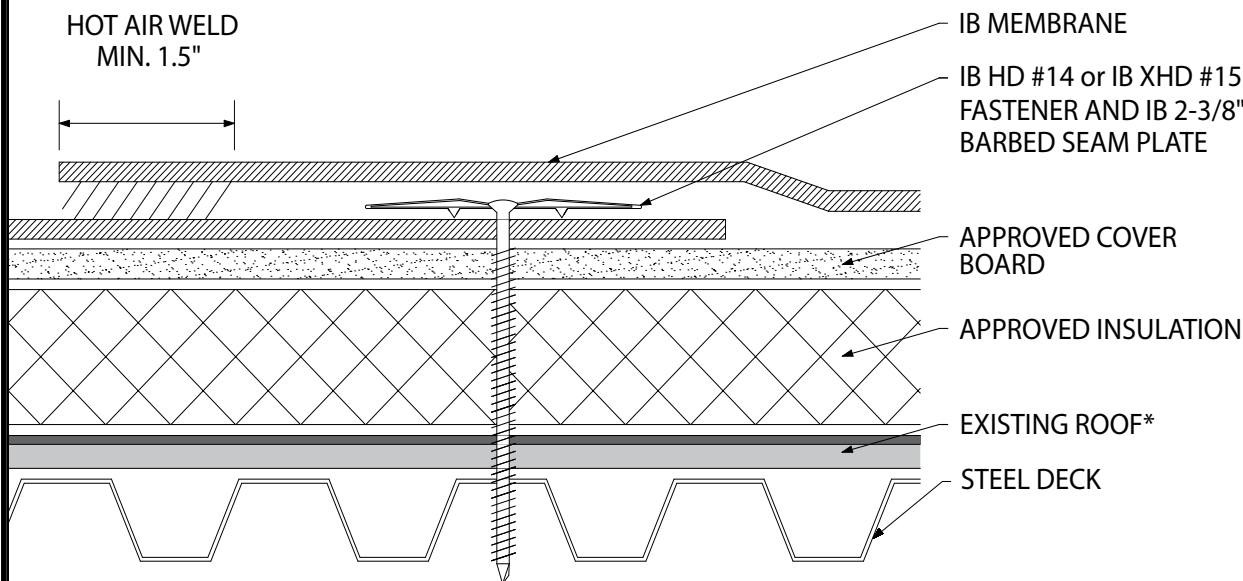

Fire Rating / Max. Slope	Deck Type	Cover Board / Insulation (over Existing Roof)		IB Membrane		Max. Design Pressure**
		Type	Attachment	Fasteners	Attachment	
'Class 'A' Unlimited	Min. 22 ga. Type B, Grade 33 Steel	Approved Cover Board & Approved Insulation	Min. IB SD #12, 3" IB Insulation Plate (6 per 4' x 8')	IB HD #14 or XHD #15, IB 2-3/8" Barbed Seam Plate	In-Seam 18" o.c. Min. x 67"	Minimum Req for IB Warranty
'Class 'A' Unlimited	Min. 22 ga. Type B, Grade 33 Steel	Approved Cover Board & Approved Insulation	Min. IB SD #12, 3" IB Insulation Plate (6 per 4' x 8')	IB HD #14 or XHD #15, IB 2-3/8" Barbed Seam Plate	In-Seam 12" o.c. Min. x 67"	Minimum Req for IB Warranty
'Class 'A' Unlimited	Min. 22 ga. Type B, Grade 33 Steel	Approved Cover Board & Approved Insulation	Min. IB SD #12, 3" IB Insulation Plate (6 per 4' x 8')	IB HD #14 or XHD #15, IB 2-3/8" Barbed Seam Plate	In-Seam 6" o.c. Min. x 67"	Minimum Req for IB Warranty
'Class 'A' Unlimited	Min. 22 ga. Type B, Grade 80 Steel	Approved Cover Board & Approved Insulation	Min. IB SD #12, 3" IB Insulation Plate (6 per 4' x 8')	IB XHD #15, IB 2-3/8" Barbed Seam Plate	In-Seam 18" o.c. Min. x 67"	-30.0 psf (Class 60)
'Class 'A' Unlimited	Min. 22 ga. Type B, Grade 80 Steel	Approved Cover Board & Approved Insulation	Min. IB SD #12, 3" IB Insulation Plate (6 per 4' x 8')	IB XHD #15, IB 2-3/8" Barbed Seam Plate	In-Seam 12" o.c. Min. x 67"	-45.0 psf (Class 90)
'Class 'A' Unlimited	Min. 22 ga. Type B, Grade 80 Steel	Approved Cover Board & Approved Insulation	Min. IB SD #12, 3" IB Insulation Plate (6 per 4' x 8')	IB XHD #15, IB 2-3/8" Barbed Seam Plate	In-Seam 6" o.c. Min. x 67"	-67.5 psf (Class 135)
'Class 'A' Unlimited	Min. 22 ga. Type B, Grade 80 Steel	Approved Cover Board & Approved Insulation	Min. IB SD #12, 3" IB Insulation Plate (6 per 4' x 8')	IB XHD #15, IB 2-3/8" Barbed Seam Plate	In-Seam 6" o.c. Min. x 31"	-127.5 psf (Class 255)

Existing Roof: APP or SBS modified bitumen, smooth or granule surfaced asphaltic built-up roof, or single-ply membrane (CPA, CSPE, EPDM, PVC, or TPO)

Approved Insulation: IB EnergyBoard II or III, or IB Approved UL Classified Polyisocyanurate, IB Approved UL Classified Expanded Polystyrene, IB Approved UL Classified Extruded Polystyrene Insulation

Approved Cover Board: DensDeck, DensDeck Prime, DensDeck StormX, Securock Ultralight Glass-Mat, Securock Ultralight Coated Glass-Mat, Securock Gypsum Fiber Board, DexCell Glass-Mat Roof Board, or DexCell FA Glass Mat Roof Board, minimum 1/2" thickness; or minimum 1/2" thickness IB HD ISO or H-Shield HD ISO, or minimum 1/2" thickness Structodek HD Primed.

Fire Classification Note: *Maintains existing classification with unlimited slope but is limited to existing Class A to retain existing Class 'A' Classification, over insulated or uninsulated cap sheet or smooth surfaced roof when covered with any UL Classified polyisocyanurate, any thickness and minimum 1/2-in. thickness UL Classified gypsum cover board. ²UL Class 'A' Classification, limited to 1/2":12" slope and limited to any existing Class A, B or C roofing system (gravel may be removed from gravel built-up or ballasted single-ply system) to retain existing Classification, when covered with minimum 3" H-Shield CG and minimum 1/2-in.thick IB HD ISO or H-Shield HD ISO. ³Recover over modified bitumen, or over Single-Ply may not maintain UL classification. ⁴Use of other IB Approved cover boards or lesser thicknesses may not maintain UL classification.

**Refer to Substrate Resistance Table for required pull-out values.

For additional information about IB Roof Systems requirements, recommendations, installation details, approvals, and limitations for the above assemblies, please refer to the latest edition of the IB Roof Systems Specifications Manual. For Technical Services please contact IB Technical Department at 800-426-1626.

Membranes:	Membrane Color:					Warranty Length***			Warranty Type***
IB PVC Single-Ply 50 Mil	White*	Gray	Tan	Bronze	ChemGuard*	10 Year	15 Year	20 Year	Total Systems - No Dollar Limit (TSW)
IB PVC Single-Ply 60 Mil	White*	Cool Sand*	Cool Stone*	Gray	Tan	15 Year	20 Year	25 Year	Warranty Plus (WP)
IB PVC Single-Ply 80 Mil	White*	Gray	Tan	Bronze	ChemGuard*	15 Year	20 Year	25 Year	Commercial Limited Material Warranty (CLMW)
									Residential Limited Material Warranty (RLMW)

*Meets CRRC, Title 24 & EnergyStar Standards

***Refer to Warranty Selection Guide for Warranty Riders, Term Length Limitations, and eligibility requirements of the Warranty Program

Submitted By:

Address:

Email:

Project Name:

Address: