

Mechanically Attached Membrane - Cover Board - Insulation - Existing Roof - Lightweight Concrete (Recover)

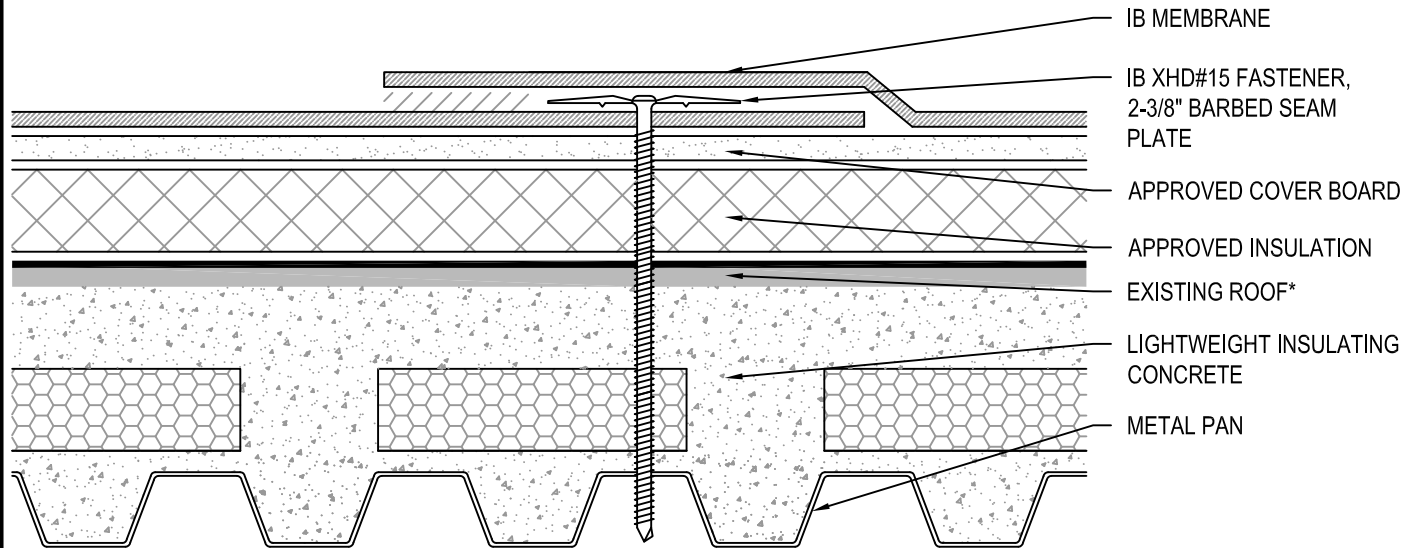

Fire Rating / Max. Slope	Deck Type	Cover Board / Insulation		IB Membrane		Max. Design Pressure**
		Type	Attachment	Fasteners	Attachment	
<input type="checkbox"/> Class 'A' Unlimited	LWIC / Metal Pan	Approved Cover Board or Approved Insulation	IB SD #12, IB 3" Insulation Plate (6 per 4' x 8')	IB XHD #15, IB 2-3/8" Barbed Seam Plate	12" o.c. Min.	Minimum Req. for IB Warranty

Approved Cover Board: Dens Deck, Dens Deck Prime, Securock Glass-Mat or Gypsum-Fiber Roof Board, minimum 1/4" thickness.

Approved Insulation: IB Energy Board II & III or IB Approved UL Classified Polyisocyanurate, Expanded Polystyrene, Extruded Polystyrene Insulation.

* **Existing Roof:** SBS or APP modified, or oxidized asphalt smooth coated, mineral surfaced roofing system.

** Refer to Substrate Resistance table for required pull-out values.

For additional information about IB Roof Systems requirements, recommendations, installation details, approvals and limitations for the above assemblies, please refer to the latest edition of the IB Roof Systems Specifications Manual. For Technical Services please contact us at 800-426-1626.

Membranes:	Colors:	Warranties:	Warranty Lengths:
<input type="checkbox"/> 50 Mil Membrane <input type="checkbox"/> 60 Mil Membrane <input type="checkbox"/> 80 Mil Membrane	<input type="checkbox"/> White* <input type="checkbox"/> Cool Sand* <input type="checkbox"/> ChemGuard* <input type="checkbox"/> Gray <input type="checkbox"/> Green <input type="checkbox"/> Red <input type="checkbox"/> Tan <input type="checkbox"/> Brown <input type="checkbox"/> Custom: _____ * Meets CRRC, Title-24, & EnergyStar Standards	<input type="checkbox"/> Total System (NDL) <input type="checkbox"/> Warranty Plus <input type="checkbox"/> Commercial Limited Material <input type="checkbox"/> Lifetime Residential Limited Material	<input type="checkbox"/> 10 yr (50, 60, and 80 mil) <input type="checkbox"/> 15 yr (50, 60, and 80 mil) <input type="checkbox"/> 20 yr (60 and 80 mil) <input type="checkbox"/> 25 yr (80 mil)

Submitted By: Address: Telephone:	Project Name: Address:
------------------------------------------------	----------------------------------

