

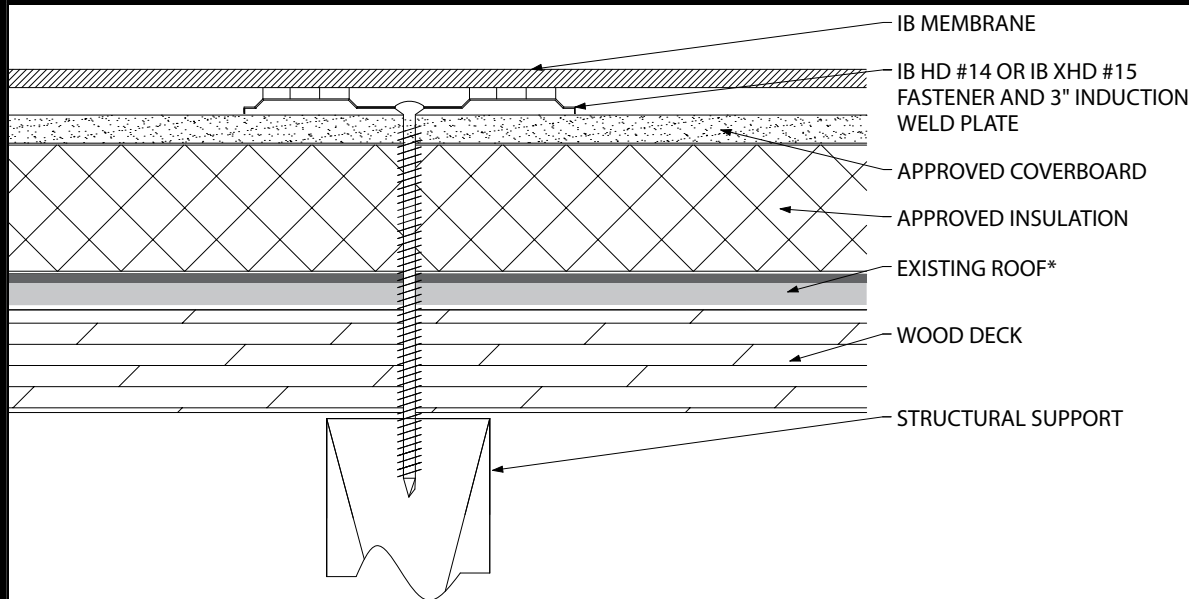

Induction Welded Membrane - Cover Board - Insulation - Existing Roof - Wood Joist (Recover)



Fire Rating / Max. Slope	Deck Type	Cover Board/Insulation (over Existing Roof)			IB Membrane Attachment	Max. Design Pressure**
		Type	Fastener	Attachment		
Not Rated	7/16" OSB	Approved Cover Board & Approved Insulation	Min. IB HD #14, 3" IB isoweld Plate	12" o.c. x max. 48" along wood structural members	Plate bonded with isoweld 3000 tool	Minimum Req for IB Warranty
Not Rated	7/16" OSB	Approved Cover Board & Approved Insulation	Min. IB HD #14, 3" IB Rhinobond Plate	12" o.c. x max. 48" along wood structural members	Plate bonded with Rhinobond tool	Minimum Req for IB Warranty
¹ Class "A" 1":12"	1/2" Plywood	Approved Cover Board & Approved Insulation	Min. IB HD #14, 3" IB isoweld Plate	12" o.c. x max. 48" along wood structural members	Plate bonded with isoweld 3000 tool	Minimum Req for IB Warranty
¹ Class "A" 1":12"	1/2" Plywood	Approved Cover Board & Approved Insulation	Min. IB HD #14, 3" IB Rhinobond Plate	12" o.c. x max. 48" along wood structural members	Plate bonded with Rhinobond tool	Minimum Req for IB Warranty
¹ Class "A" 1":12"	19/32" Plywood	Approved Cover Board & Approved Insulation	Min. IB XHD #15, 3" IB isoweld Plate	12" o.c. x max. 48" along wood structural members	Plate bonded with isoweld 3000 tool	-67.5 psf (Class 135)
¹ Class "A" 1":12"	19/32" Plywood	Approved Cover Board & Approved Insulation	Min. IB XHD #15, 3" IB isoweld Plate	9" o.c. x max. 48" along wood structural members	Plate bonded with isoweld 3000 tool	-97.5 psf (Class 95)

Existing Roof: APP or SBS modified bitumen, smooth or granule surfaced asphaltic built-up roof, or single-ply membrane (CPA, CSPE, EPDM, PVC, or TPO)

Approved Cover Board: DensDeck, DensDeck Prime, DensDeck StormX, Securock Ultralight Glass-Mat, Securock Ultralight Coated Glass-Mat, Securock Gypsum Fiber Board, DexCell Glass-Mat Roof Board, or DexCell FA Glass Mat Roof Board, minimum 1/4" thickness; or minimum 7/16" DexCell Cement Board; minimum 1/2" gypsum board; minimum 1/2" IB HD ISO or HShield HD ISO; or minimum 1/2" thick Structodek HD Primed

Fire Classification Note: ¹UL Class A up to 1":12" limited to insulated or non-insulated cap sheet, smooth or gravel surfaced Built-Up Roof System) or PVC roof system, covered with any of the following gypsum cover boards: minimum 1/4" DensDeck, DensDeck Prime, Securock Ultralight Glass-Mat, Securock Ultralight Coated Glass-Mat, DexCell Glass-Mat Roof Board, or DexCell FA Glass Mat Roof Board, or minimum 7/16" DexCell Cement Board. ²UL Class A or retention of existing classification without slope limitation is limited to use of minimum 1/2" UL Classified gypsum over a Class A to retain existing Classification, insulated or non-insulated cap sheet or smooth surfaced roof. ³Maintains existing Classification for any Class A, B or C, coated or uncoated, insulated, or un-insulated, smooth surfaced, Type G3 mineral surfaced cap sheet or mineral surfaced modified bitumen membrane BUR system when utilized with minimum 1/4" Securock Gypsum Fiber Board.

⁴The use of other IB Approved Cover Boards may not retain UL Classification. ⁵Recover over modified bitumen or single-ply roof may not retain fire classification.

**Refer to Substrate Resistance Table for required pull-out values.

For additional information about IB Roof Systems requirements, recommendations, installation details, approvals, and limitations for the above assemblies, please refer to the latest edition of the IB Roof Systems Specifications Manual. For Technical Services please contact IB Technical Department at 800-426-1626.

Membranes:	Membrane Color:						Warranty Length***			Warranty Type***	
IB PVC Single-Ply 50 Mil	White*	Gray	Tan	Bronze	ChemGuard*		10 Year	15 Year	20 Year	Total Systems - No Dollar Limit (TSW)	
IB PVC Single-Ply 60 Mil	White*	Cool Sand*	Cool Stone*	Gray	Tan		15 Year	20 Year	25 Year	Warranty Plus (WP)	
IB PVC Single-Ply 80 Mil	White*	Gray	Tan	Bronze	ChemGuard*		15 Year	20 Year	25 Year	Commercial Limited Material Warranty (CLMW)	
										Residential Limited Material Warranty (RLMW)	
*Meets CRRC, Title 24 & EnergyStar Standards							***Refer to Warranty Selection Guide for Warranty Riders, Term Length Limitations, and eligibility requirements of the Warranty Program				
Submitted By:							Project Name:				
Address:							Address:				
Email:											