

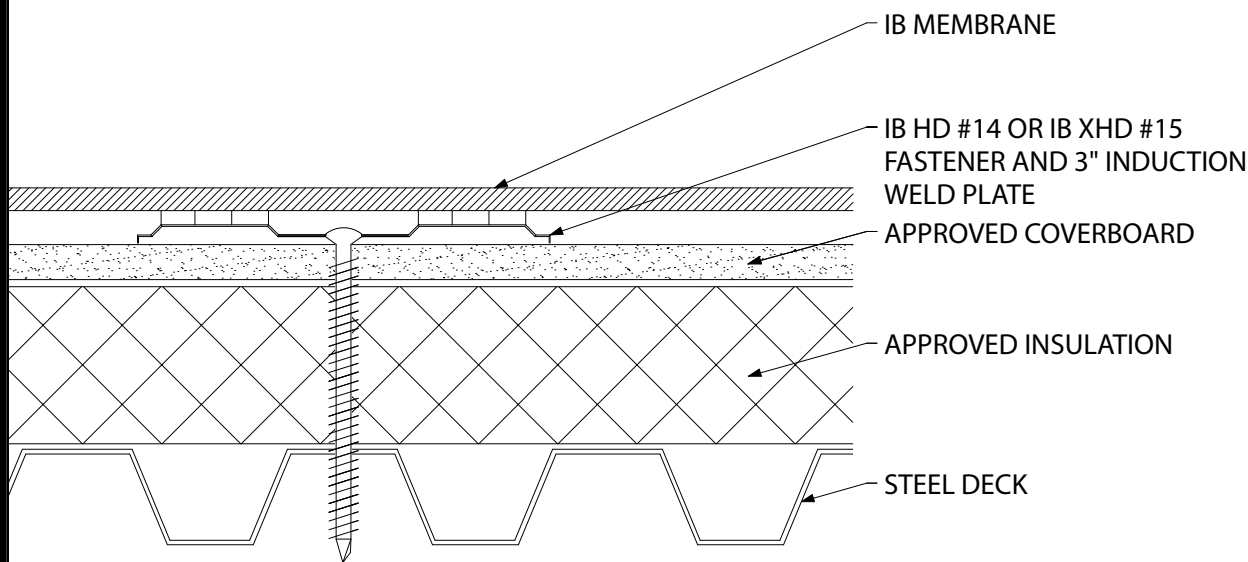

Induction Welded Membrane - Cover Board - Insulation - Steel Deck (New or Tear Off)



Fire Rating / Max. Slope	Deck Type	Cover Board/Insulation			IB Membrane Attachment	Max. Design Pressure**
		Type	Fastener	Attachment		
'Class "A" Unlimited	Min. 22 ga. Type B, Grade 40 Steel	Approved Cover Board & Approved Insulation	Min. IB HD #14, 3" IB isoweld Plate	2x3-ft grid, staggered (6 per 4' x 8')	Plate bonded with isoweld 3000 tool	Minimum Req for IB Warranty
'Class "A" Unlimited	Min. 22 ga. Type B, Grade 40 Steel	Approved Cover Board & Approved Insulation	Min. IB HD #14, 3" IB Rhinobond Plate	2x3-ft grid, staggered (6 per 4' x 8')	Plate bonded with Rhinobond tool	Minimum Req for IB Warranty
'Class "A" Unlimited	Min. 22 ga. Type B, Grade 40 Steel	Approved Cover Board & Approved Insulation	Min. IB XHD #15, 3" IB isoweld Plate	2x3-ft grid, staggered (6 per 4' x 8')	Plate bonded with isoweld 3000 tool	-37.5 psf (Class 75)
'Class "A" Unlimited	Min. 22 ga. Type B, Grade 40 Steel	Approved Cover Board & Approved Insulation	Min. IB XHD #15, 3" IB isoweld Plate	2x2-ft grid, staggered (8 per 4' x 8')	Plate bonded with isoweld 3000 tool	-52.5 psf (Class 105)
'Class "A" Unlimited	Min. 22 ga. Type B, Grade 40 Steel	Approved Cover Board & Approved Insulation	Min. IB XHD #15, 3" IB isoweld Plate	1.5x2-ft grid, staggered (11 per 4' x 8')	Plate bonded with isoweld 3000 tool	-82.5 psf (Class 165)
'Class "A" Unlimited	Min. 22 ga. Type B, Grade 40 Steel	Approved Cover Board & Approved Insulation	Min. IB XHD #15, 3" IB isoweld Plate	12" o.c. x max. 60" along steel structural members	Plate bonded with isoweld 3000 tool	-45.0 psf (Class 90)
'Class "A" Unlimited	Min. 22 ga. Type B, Grade 40 Steel	Approved Cover Board & Approved Insulation	Min. IB XHD #15, 3" IB isoweld Plate	6" o.c. x max. 60" along steel structural members	Plate bonded with isoweld 3000 tool	-90.0 psf (Class 180)

Approved Insulation: IB EnergyBoard II or III, or IB Approved UL Classified Polyisocyanurate, IB Approved UL Classified Expanded Polystyrene, IB Approved UL Classified Extruded Polystyrene Insulation

Approved Cover Board: DensDeck, DensDeck Prime, DensDeck StormX, Securock Ultralight Glass-Mat, Securock Ultralight Coated Glass-Mat, Securock Gypsum Fiber Board, DexCell Glass-Mat Roof Board, or DexCell FA Glass Mat Roof Board, minimum 1/4" thickness; or minimum 1/2" IB HD ISO or H-Shield HD ISO, or minimum 1/2" thick Structodek HD Primed.

Fire Classification Note: ¹UL Class 'A' with unlimited slope when utilized with any UL Classified insulation, any thickness, and covered with any of the following gypsum cover boards: minimum 1/4" DensDeck, DensDeck Prime, Securock Ultralight Glass-Mat, Securock Ultralight Coated Glass-Mat, DexCell Glass-Mat Roof Board, or DexCell FA Glass Mat Roof Board, or minimum 7/16" DexCell Cement Board or minimum 1/2" gypsum board. ²UL Class 'A' up to 4":12" when utilized with any UL Classified insulation, any thickness, and covered with minimum 1/2" Securock Gypsum Fiber Board. ³UL Class 'A' up to 2":12" when utilized with any UL Classified insulation, any thickness, and covered with minimum 1/4" Securock Gypsum Fiber Board. ⁴UL Class 'A' up to 1/2":12" when utilized with minimum 1/2" H-Shield HD ISO over any UL Classified insulation (except expanded or extruded polystyrene), any combination, any thickness, may be used below the 1/2 in. minimum thickness.

⁵Use of other IB Approved Insulations and/or IB Approved Cover Boards may not achieve UL Classification.

**Refer to Substrate Resistance Table for required pull-out values.

For additional information about IB Roof Systems requirements, recommendations, installation details, approvals, and limitations for the above assemblies, please refer to the latest edition of the IB Roof Systems Specifications Manual. For Technical Services please contact IB Technical Department at 800-426-1626.

Membranes:		Membrane Color:				Warranty Length***			Warranty Type***	
IB PVC Single-Ply 50 Mil	White*	Gray	Tan	Bronze	ChemGuard*	10 Year	15 Year	20 Year	Total Systems - No Dollar Limit (TSW)	
IB PVC Single-Ply 60 Mil	White*	Cool Sand*	Cool Stone*	Gray	Tan	15 Year	20 Year	25 Year	Warranty Plus (WP)	
IB PVC Single-Ply 80 Mil	White*	Gray	Tan	Bronze	ChemGuard*	20 Year	25 Year	30 Year	Commercial Limited Material Warranty (CLMW)	
									Residential Limited Material Warranty (RLMW)	

*Meets CRRC, Title 24 & EnergyStar Standards

***Refer to Warranty Selection Guide for Warranty Riders, Term Length Limitations, and eligibility requirements of the Warranty Program

Submitted By:

Address:

Email:

Project Name:

Address:

