

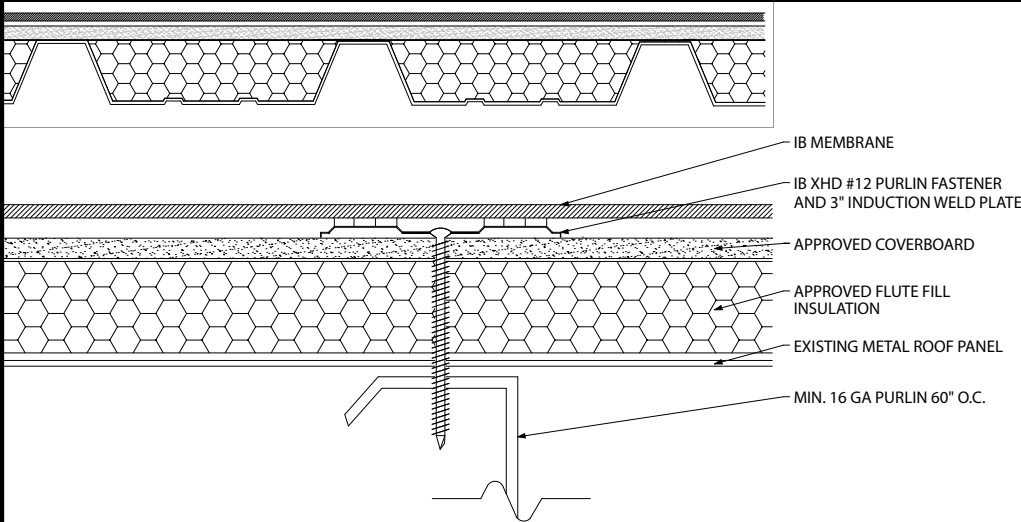

Induction Welded Membrane - Cover Board - Flute Filler - Existing Metal Roof - Purlin Fastened (Recover)



Fire Rating / Max. Slope	Deck Type	Cover Board/Flute Filler (over Existing Metal Roof)			IB Membrane Attachment	Max. Design Pressure**
		Type	Fastener	Attachment		
'Class "A" Unlimited	Metal Roof Panel & 16 gauge, 50 ksi steel purlins spaced max. 60-inch o.c.	Approved Cover Board & Approved Flute Filler Insulation	Min. IB SD #12, 3" IB Insulation Plate (6 per 4' x 8')	IB XHD #15, IB 3" isoweld Plate 12" o.c. along purlins (max 60")	Plate bonded with isoweld 3000 tool	Minimum Req for IB Warranty
'Class "A" Unlimited	Metal Roof Panel & 16 gauge, 50 ksi steel purlins spaced max. 60-inch o.c.	Approved Cover Board & Approved Flute Filler Insulation	Min. IB SD #12, 3" IB Insulation Plate (6 per 4' x 8')	IB XHD #15, IB 3" isoweld Plate 12" o.c. along purlins (max 60")	Plate bonded with Rhinobond tool	Minimum Req for IB Warranty
'Class "A" Unlimited	Metal Roof Panel & 16 gauge, 50 ksi steel purlins spaced max. 60-inch o.c.	Approved Cover Board & Approved Flute Filler Insulation	Min. IB SD #12, 3" IB Insu- lation Plate (6 per 4' x 8')	IB #12 Purlin Fastener, IB 3" isoweld Plate 12" o.c. along purlins (max 60")	Plate bonded with isoweld 3000 tool	-45.0 psf (Class 90)
'Class "A" Unlimited	Metal Roof Panel & 16 gauge, 50 ksi steel purlins spaced max. 60-inch o.c.	Approved Cover Board & Approved Flute Filler Insulation	Min. IB SD #12, 3" IB Insulation Plate (6 per 4' x 8')	IB #12 Purlin Fastener, IB 3" isoweld Plate 6" o.c. along purlins (max 60")	Plate bonded with isoweld 3000 tool	-90.0 psf (Class 180)
'Class "A" Unlimited	Metal Roof Panel & 16 gauge, 50 ksi steel purlins spaced max. 48-inch o.c.	Approved Cover Board & Approved Flute Filler Insulation	Min. IB SD #12, 3" IB Insulation Plate (6 per 4' x 8')	IB #12 Purlin Fastener, IB 3" isoweld Plate 12" o.c. along purlins (max 48")	Plate bonded with isoweld 3000 tool	-67.5 psf (Class 135)
'Class "A" Unlimited	Metal Roof Panel & 16 gauge, 50 ksi steel purlins spaced max. 48-inch o.c.	Approved Cover Board & Approved Flute Filler Insulation	Min. IB SD #12, 3" IB Insu- lation Plate (6 per 4' x 8')	IB #12 Purlin Fastener, IB 3" isoweld Plate 9" o.c. along purlins (max 48")	Plate bonded with isoweld 3000 tool	-97.5 psf (Class 195)

Existing Roof: Metal Standing Seam or lapped seam Metal Panel Roof, having a min. 16 gauge, 50 ksi steel purlin

Approved Flute Filler: IB EnergyBoard II or III, or IB Approved UL Classified Polyisocyanurate, IB Approved UL Classified Expanded Polystyrene, IB Approved UL Classified Extruded Polystyrene Insulation

Approved Cover Board: DensDeck, DensDeck Prime, DensDeck StormX, Securock Ultralight Glass-Mat, Securock Ultralight Coated Glass-Mat, Securock Gypsum Fiber Board, DexCell Glass-Mat Roof Board, or DexCell FA Glass Mat Roof Board, minimum 1/4" thickness; or IB HD ISO minimum 1/4", or minimum 1/2" thick Structodek HD Primed.

Fire Classification Note: ¹UL Class 'A' with unlimited slope when utilized with any UL Classified insulation, any thickness, and covered with any of the following gypsum cover boards: minimum 1/2" DensDeck, DensDeck Prime, Securock Ultralight Glass-Mat, Securock Ultralight Coated Glass-Mat, DexCell Glass-Mat Roof Board, or DexCell FA Glass Mat Roof Board, or minimum 7/16" DexCell Cement Board or minimum 1/2" gypsum board. ²UL Class 'A' up to 4":12" when utilized with any UL Classified insulation, any thickness, and covered with minimum 1/2" Securock Gypsum Fiber Board. ³UL Class 'A' up to 2":12" when utilized with any UL Classified insulation, any thickness, and covered with minimum 1/4" Securock Gypsum Fiber Board. ⁴UL Class 'A' up to 1/2":12" when utilized with minimum 1/2" H-Shield HD ISO over any UL Classified insulation (except expanded or extruded polystyrene), any combination, any thickness, may be used below the 1/2 in. minimum thickness.

⁵Use of other IB Approved Insulations and/or IB Approved Cover Boards may not achieve UL Classification.

**Refer to Substrate Resistance Table for required pull-out values.

For additional information about IB Roof Systems requirements, recommendations, installation details, approvals, and limitations for the above assemblies, please refer to the latest edition of the IB Roof Systems Specifications Manual. For Technical Services please contact IB Technical Department at 800-426-1626.

Membranes:		Membrane Color:				Warranty Length***			Warranty Type***	
IB PVC Single-Ply 50 Mil	White*	Gray	Tan	Bronze	ChemGuard*	10 Year	15 Year	20 Year	Total Systems - No Dollar Limit (TSW)	
	White*	Cool Sand*	Cool Stone*	Gray	Tan	15 Year	20 Year	25 Year	Warranty Plus (WP)	
	White*	Gray	Tan	Bronze	ChemGuard*	20 Year	25 Year	30 Year	Commercial Limited Material Warranty (CLMW)	
IB PVC Single-Ply 60 Mil		White*	Gray	Tan	Bronze	ChemGuard*	20 Year	25 Year	Residential Limited Material Warranty (RLMW)	

*Meets CRRC, Title 24 & EnergyStar Standards

***Refer to Warranty Selection Guide for Warranty Riders, Term Length Limitations, and eligibility requirements of the Warranty Program

Submitted By:

Address:

Email:

Project Name:

Address:

