

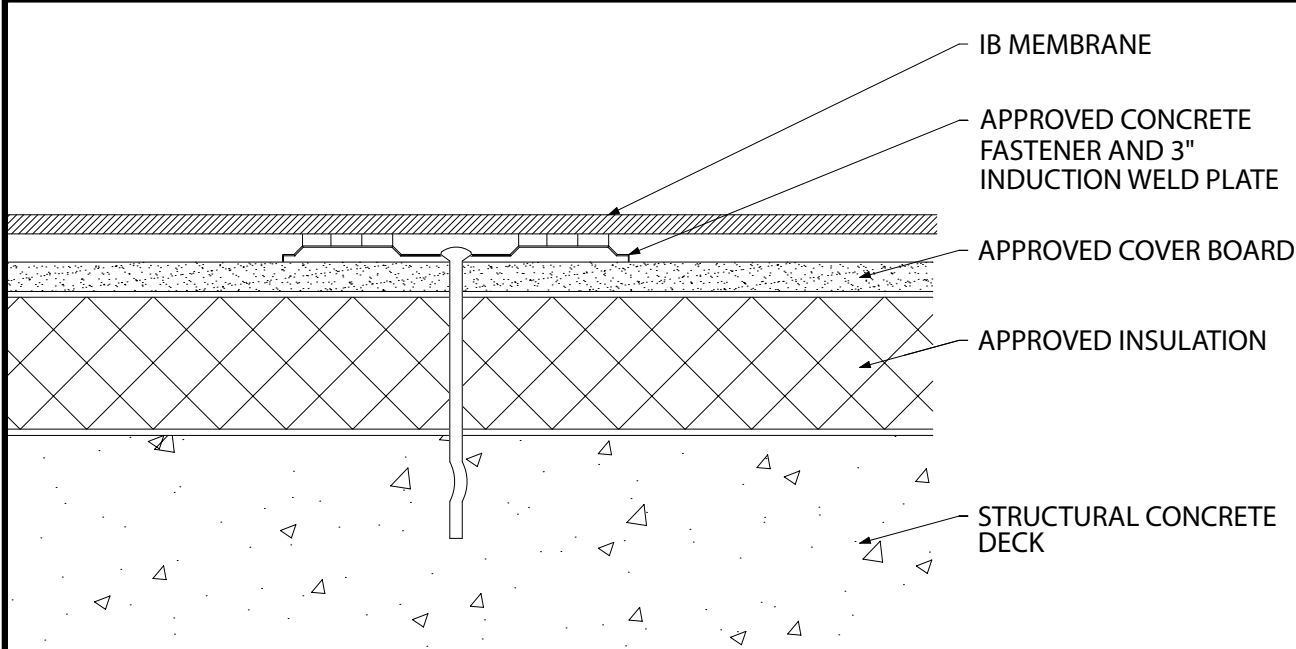

Induction Welded Membrane - Cover Board - Insulation - Concrete Deck (New or Tear Off)



| Fire Rating / Max. Slope | Deck Type | Cover Board/Insulation | | | IB Membrane Attachment | Max. Design Pressure** |
|-----------------------------|---------------------|---|---|---|--|--------------------------------|
| | | Type | Fastener | Attachment | | |
| 'Class "A" Unlimited | Structural Concrete | Approved Cover Board & Approved Insulation | Min. IB HD #14, 3" IB RhinoBond Plate | 2x3-ft grid, staggered (6 per 4' x 8') | Plate bonded with RhinoBond tool | Minimum Req for IB Warranty |
| 'Class "A" Unlimited | Structural Concrete | Approved Cover Board & Approved Insulation | Min. IB HD #14 or XHD #15, 3" IB isoweld Plate | 2x3-ft grid, staggered (6 per 4' x 8') | Plate bonded with isoweld 3000 tool | -37.5 psf (Class 75) |
| 'Class "A" Unlimited | Structural Concrete | Approved Cover Board & Approved Insulation | Min. IB HD #14 or XHD #15, 3" IB isoweld Plate | 2x2-ft grid, staggered (8 per 4' x 8') | Plate bonded with isoweld 3000 tool | -52.5 psf (Class 105) |
| 'Class "A" Unlimited | Structural Concrete | Approved Cover Board & Approved Insulation | Min. IB HD #14 or XHD #15, 3" IB isoweld Plate | 1.5x2-ft grid, staggered (11 per 4' x 8') | Plate bonded with isoweld 3000 tool | -82.5 psf (Class 165) |
| 'Class "A" Unlimited | Structural Concrete | Approved Cover Board & Approved Insulation | Min. IB HD #14 or XHD #15, 3" IB isoweld Plate | 12" o.c. x max. 60" along steel structural members | Plate bonded with isoweld 3000 tool | -45.0 psf (Class 90) |
| 'Class "A" Unlimited | Structural Concrete | Approved Cover Board & Approved Insulation | Min. IB HD #14 or XHD #15, 3" IB isoweld Plate | 6" o.c. x max. 60" along steel structural members | Plate bonded with isoweld 3000 tool | -90.0 psf (Class 180) |

Approved Insulation: IB EnergyBoard II or III, or IB Approved UL Classified Polyisocyanurate, IB Approved UL Classified Expanded Polystyrene, IB Approved UL Classified Extruded Polystyrene Insulation

Approved Cover Board: DensDeck, DensDeck Prime, DensDeck StormX, Securock Ultralight Glass-Mat, Securock Ultralight Coated Glass-Mat, Securock Gypsum Fiber Board, DexCell Glass-Mat Roof Board, or DexCell FA Glass Mat Roof Board, minimum 1/4" thickness; or minimum 1/2" IB HD ISO or H-Shield HD ISO, or minimum 1/2" thick Structodek HD Primed.

Fire Classification Note: ¹UL Class 'A' with unlimited slope when utilized with any UL Classified insulation, any thickness, and covered with any of the following gypsum cover boards: minimum 1/4" DensDeck, DensDeck Prime, Securock Ultralight Glass-Mat, Securock Ultralight Coated Glass-Mat, DexCell Glass-Mat Roof Board, or DexCell FA Glass Mat Roof Board; or minimum 7/16" DexCell Cement Board or minimum 1/2" gypsum board. ²UL Class 'A' up to 4":12" when utilized with any UL Classified insulation, any thickness, and covered with minimum 1/4" Securock Gypsum Fiber Board. ³UL Class 'A' up to 2":12" when utilized with any UL Classified insulation, any thickness, and covered with minimum 1/4" Securock Gypsum Fiber Board. ⁴UL Class 'A' up to 1/4":12" when utilized with minimum 1/2" H-Shield HD ISO over any UL Classified insulation (except expanded or extruded polystyrene), any combination, any thickness, may be used below the 1/2 in. minimum thickness.

⁵Use of other IB Approved Insulations and/or IB Approved Cover Boards may not achieve UL Classification.

**Refer to Substrate Resistance Table for required pull-out values.

| Membranes: | Membrane Color: | | | | | Warranty Length*** | | | Warranty Type*** |
|--------------------------|-----------------|------------|-------------|--------|------------|--------------------|---------|---------|--|
| IB PVC Single-Ply 50 Mil | White* | Gray | Tan | Bronze | ChemGuard* | 10 Year | 15 Year | 20 Year | Total Systems - No Dollar Limit (TSW) |
| IB PVC Single-Ply 60 Mil | White* | Cool Sand* | Cool Stone* | Gray | Tan | 15 Year | 20 Year | 25 Year | Warranty Plus (WP) |
| IB PVC Single-Ply 80 Mil | White* | Gray | Tan | Bronze | ChemGuard* | 20 Year | 25 Year | 30 Year | Commercial Limited Material Warranty (CLMW) |
| | | | | | | | | | Residential Limited Material Warranty (RLMW) |

*Meets CRRC, Title 24 & EnergyStar Standards

***Refer to Warranty Selection Guide for Warranty Riders, Term Length Limitations, and eligibility requirements of the Warranty Program

Submitted By:

Address:

Email:

Project Name:

Address:

