

Fully Adhered Membrane - Cover Board (RB) - Insulation (RB) - Concrete (New or Tear-Off)

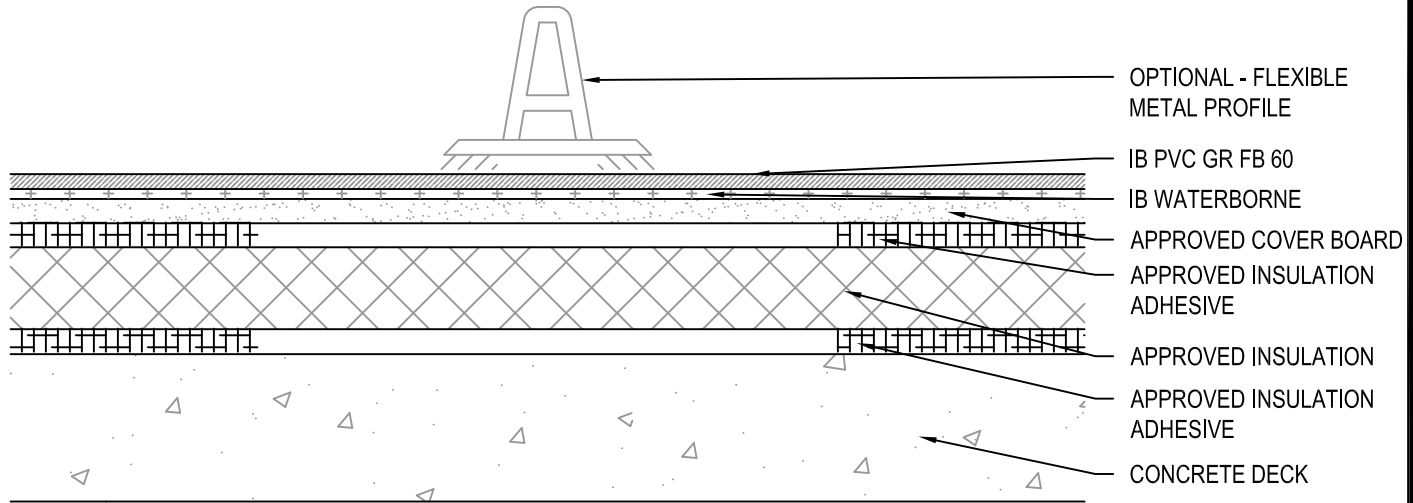

Fire Rating / Max. Slope	Deck Type	Cover Board / Insulation			IB Membrane Attachment	Max. Design Pressure**
		Type	Insulation Adhesive	Attachment		
<input type="checkbox"/> Class 'A' 3" : 12"	Structural Concrete	Min. 1/2" AC Foam HS Cover Board & Approved Insulation	IB Rapid Set Insulation Adhesive	Four continuous ribbons, Min. 1/2" to 3/4" wide 12" o.c.	IB Waterborne	-257.5 psf (Class 515)
<input type="checkbox"/> Class 'A' 3" : 12"	Structural Concrete	Min. 1/2" AC Foam HS Cover Board & Approved Insulation	OlyBond 500 (Spotshot) Insulation Adhesive	Four continuous ribbons, Min. 3/4" to 1" wide 12" o.c.	IB Waterborne	-257.5 psf (Class 515)
<input type="checkbox"/> Class 'A' Unlimited	Structural Concrete	Min. 1/4" Dens Deck Prime & Approved Insulation	IB Rapid Set Insulation Adhesive	Four continuous ribbons, Min. 1/2" to 3/4" wide 12" o.c.	IB Waterborne	-257.5 psf (Class 515)
<input type="checkbox"/> Class 'A' Unlimited	Structural Concrete	Min. 1/4" Dens Deck Prime & Approved Insulation	OlyBond 500 (Spotshot) Insulation Adhesive	Four continuous ribbons, Min. 3/4" to 1" wide 12" o.c.	IB Waterborne	-257.5 psf (Class 515)
<input type="checkbox"/> Class 'A' Unlimited	Structural Concrete	Min. 1/4" Securock Gypsum-Fiber Roof Board & Approved Insulation	IB Rapid Set Insulation Adhesive	Four continuous ribbons, Min. 1/2" to 3/4" wide 12" o.c.	IB Waterborne	-267.5 psf (Class 535)
<input type="checkbox"/> Class 'A' Unlimited	Structural Concrete	Min. 1/4" Securock Gypsum-Fiber Roof Board & Approved Insulation	OlyBond 500 (Spotshot) Insulation Adhesive	Four continuous ribbons, Min. 3/4" to 1" wide 12" o.c.	IB Waterborne	-267.5 psf (Class 535)

Approved Insulation: IB Energy Board II & III or IB Approved UL Classified Polyisocyanurate Insulation, minimum 1" thickness.

** Refer to Substrate Resistance table for required pull-out values.

For additional information about IB Roof Systems requirements, recommendations, installation details, approvals and limitations for the above assemblies, please refer to the latest edition of the IB Roof Systems Specifications Manual. For Technical Services please contact us at 800-426-1626.

Membranes:	Colors:	Warranties:	Warranty Lengths:
<input type="checkbox"/> IB PVC GR FB 60	<input type="checkbox"/> White* <input type="checkbox"/> Aluminum <input type="checkbox"/> Old World Bronze	<input type="checkbox"/> Total System (NDL) <input type="checkbox"/> Warranty Plus <input type="checkbox"/> Commercial Limited Material <input type="checkbox"/> Lifetime Residential Limited Material	<input type="checkbox"/> 10 yr <input type="checkbox"/> 15 yr <input type="checkbox"/> 20 yr
* Meets CRRC, Title-24, & EnergyStar Standards			

Submitted By:
 Address:
 Telephone:

Project Name:
 Address:

