

### Fully Adhered Membrane - Cover Board (RB) - Insulation (MA) - Steel Deck (New or Tear-Off)

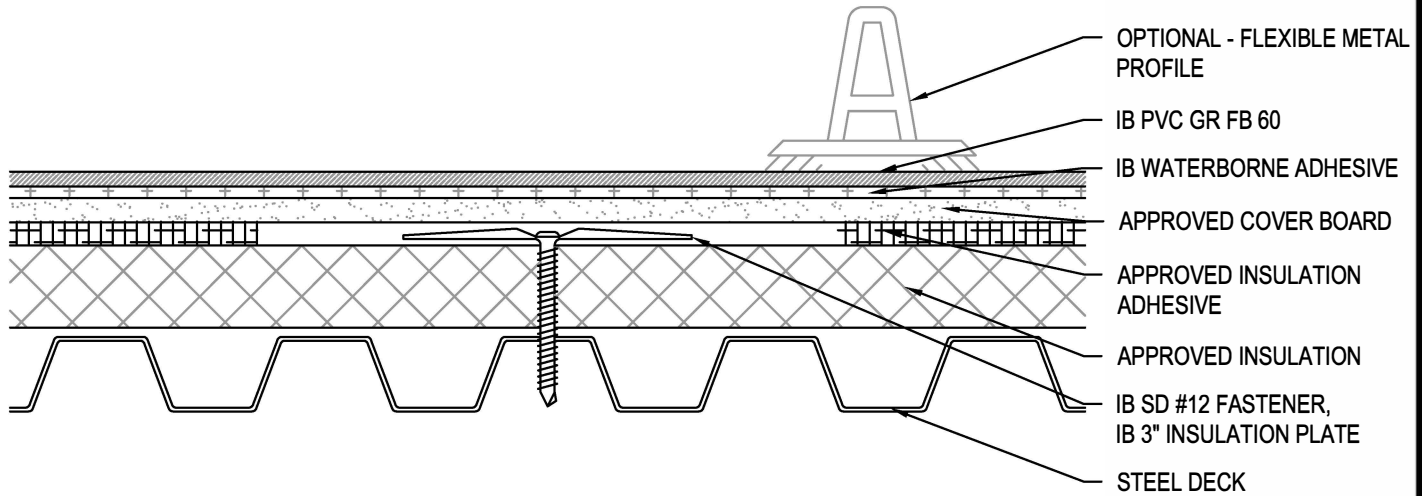

Fire Rating / Max. Slope	Deck Type	Cover Board / Insulation			IB GR FB60 Mil Attachment	Max. Design Pressure**
		Type	Attachment	Fasteners		
<input type="checkbox"/>	Class 'A' Unlimited Min. 22 ga., Type B, Grade 33 Steel	Approved Cover Board	IB Rapid Set Insulation Adhesive Field: 16 per 4' x 8' (1 per 2 sq. ft.)	Four continuous ribbons, Min. 1/2" to 3/4" wide, 12" o.c.	IB Waterborne	-45.0 psf (Class 90)
		Min. 1.5" Approved Insulation		IB SD #12, IB 3" Insulation Plate		
<input type="checkbox"/>	Class 'A' Unlimited Min. 22 ga., Type B, Grade 33 Steel	Approved Cover Board	Olybond 500 (SpotShot) Insulation Adhesive Field: 16 per 4' x 8' (1 per 2 sq. ft.)	Four continuous ribbons, Min. 3/4" to 1" wide, 12" o.c.	IB Waterborne	-45.0 psf (Class 90)
		Min. 1.5" Approved Insulation		IB SD #12, IB 3" Insulation Plate		

**Approved Cover Board:** Dens Deck Prime, Securock Gypsum-Fiber Roof Board, minimum 1/4" thickness.

**Approved Insulation:** IB Energy Board II & III or IB Approved UL Classified Polyisocyanurate Insulation.

\*\* Refer to Substrate Resistance table for required pull-out values.

For additional information about IB Roof Systems requirements, recommendations, installation details, approvals and limitations for the above assemblies, please refer to the latest edition of the IB Roof Systems Specifications Manual. For Technical Services please contact us at 800-426-1626.

Membranes:	Colors:	Warranties:	Warranty Lengths:
<input type="checkbox"/> IB PVC GR FB 60	<input type="checkbox"/> White* <input type="checkbox"/> Aluminum <input type="checkbox"/> Old World Bronze <small>* Meets CRRG, Title-24, &amp; EnergyStar Standards</small>	<input type="checkbox"/> Total System (NDL) <input type="checkbox"/> Warranty Plus <input type="checkbox"/> Commercial Limited Material <input type="checkbox"/> Lifetime Residential Limited Material	<input type="checkbox"/> 10 yr <input type="checkbox"/> 15 yr <input type="checkbox"/> 20 yr

Submitted By:  
Address:  
Telephone:

Project Name:  
Address:

