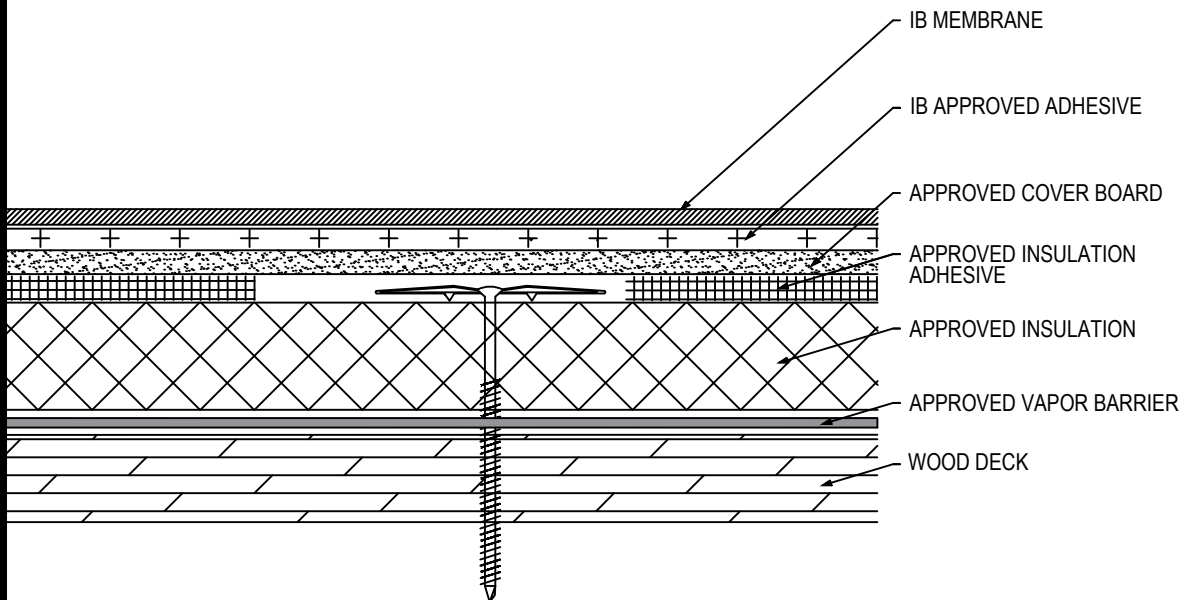

Fully Adhered Membrane - Cover Board (RB) - Insulation (MA) - Vapor Barrier - Wood Deck (New or Tear-Off)

Fire Rating / Max. Slope	Deck Type	Insulation/Vapor Barrier			Cover Board			IB Membrane Attachment	Max. Design Pressure**
		Type	Attachment	Fastener	Type	Insulation Adhesive	Pattern		
<input type="checkbox"/> 1'Class 'A' 1/2":12"	7/16" OSB	Approved Insulation & Approved Vapor Barrier	16 per 4' x 8' (1 per 2 sq. ft.)	Min. IB SD #12 or HD #14, 3" IB Insulation Plate	Min. Approved 1/4" Cover Board	BM, CR20, OB500, OSFA, PG1, or RSIA	Four continuous ribbons, 12" o.c.	IB Approved Adhesive	Minimum Req. for IB Warranty
<input type="checkbox"/> 1'Class 'A' 1/2":12"	1/2" Plywood	Approved Insulation & Approved Vapor Barrier	10 per 4' x 8' (1 per 3.2 sq. ft.)	Min. IB SD #12 or HD #14, 3" IB Insulation Plate	Min. Approved 1/4" Cover Board	BM, CR20, OB500, OSFA, PG1, or RSIA	Four continuous ribbons, 12" o.c.	IB Approved Adhesive	Minimum Req. for IB Warranty
<input type="checkbox"/> 1'Class 'A' 1/2":12"	1/2" Plywood	Min. 1.5" Approved Insulation & Approved Vapor Barrier	20 per 4' x 8' (1 per 1.6 sq. ft.)	Min. IB SD #12 or HD #14, 3" IB Insulation Plate	Min. Approved 1/4" Cover Board	BM, CR20, OB500, OSFA, PG1, or RSIA	Four continuous ribbons, 12" o.c.	IB Approved Adhesive	-45.0 psf (Class 90)
<input type="checkbox"/> 1'Class 'A' 1/2":12"	19/32" Plywood	Min. 1.5" Approved Insulation & Approved Vapor Barrier	24 per 4' x 8' (1 per 1.3 sq. ft.)	Min. IB XHD #15, 3" IB Insulation Plate	Min. Approved 1/4" Cover Board	CR20, OB500, OSFA, PG1, or RSIA	Eight continuous ribbons, 6" o.c.	IB Approved Adhesive	-75.0 psf (Class 150)
<input type="checkbox"/> 1'Class 'A' 1/2":12"	19/32" Plywood	Min. 1.5" Approved Insulation & Approved Vapor Barrier	24 per 4' x 8' (1 per 1.3 sq. ft.)	Min. IB XHD #15, 3" IB Insulation Plate	Min. 1/4" Securock Gypsum Fiber Board	BoardMax	Eight continuous ribbons, 6" o.c.	IB Approved Adhesive	-75.0 psf (Class 150)

Approved Vapor Barrier: IBarrier SA Membrane, SopraVap'r SA, applied using self-adhesive techniques

Approved Insulation: IB EnergyBoard II or III, or IB Approved UL Classified Polyisocyanurate, IB Approved UL Classified Expanded Polystyrene, IB Approved UL Classified Extruded Polystyrene Insulation

Approved Cover Board: DensDeck Prime, Securock Gypsum Fiber Board, minimum 1/4" thickness; or minimum 1/2" IB HD ISO; or minimum 1/2" thick Structodek HD Primed

Approved Insulation Adhesive: BM = Polyset BoardMax, CR-20 = Polyset CR-20, OB500 = OlyBond 500 Adhesive Fastener, OSFA = Millennium One-Step Foamable Adhesive; PG-1 = Millennium PG-1 Pump Grade Adhesive; or RSIA = IB Rapid Set Insulation Adhesive; maximum bead spacing 12" o.c. unless otherwise indicated.

Fire Classification Note(s): 1'UL Class 'A' up to 1/2":12" when utilized with any UL Classified insulation (except expanded or extruded polystyrene), any combination, any thickness and covered with minimum 1/2" H-Shield HD ISO and membrane adhered using 1'IB Vertibond 432 Bonding Adhesive" at 1-gal/60-ft² or 1'IB Water Borne 636 Adhesive" at 1-gal/140-ft². 2The use of other IB Approved Cover Boards and/or other IB Approved membrane adhesives may not achieve UL Classification.

** Refer to Substrate Resistance table for required pull-out values.

For additional information about IB Roof Systems requirements, recommendations, installation details, approvals and limitations for the above assemblies, please refer to the latest edition of the IB Roof Systems Specifications Manual. For Technical Services please contact us at 800-426-1626.

Membranes:	Membrane Color:	Warranty Length***	Warranty Type***
<input type="checkbox"/> IB PVC Single-Ply 50 Mil	<input type="checkbox"/> White* <input type="checkbox"/> Gray <input type="checkbox"/> Tan <input type="checkbox"/> Bronze <input type="checkbox"/> ChemGuard*	<input type="checkbox"/> 10 Year <input type="checkbox"/> 15 Year <input type="checkbox"/> 20 Year	<input type="checkbox"/> Total System - No Dollar Limit (NDL)
<input type="checkbox"/> IB PVC Single-Ply 60 Mil	<input type="checkbox"/> White* <input type="checkbox"/> Cool Sand* <input type="checkbox"/> Cool Stone* <input type="checkbox"/> Gray <input type="checkbox"/> Tan	<input type="checkbox"/> 15 Year <input type="checkbox"/> 20 Year <input type="checkbox"/> 25 Year	<input type="checkbox"/> Warranty Plus (WP)
<input type="checkbox"/> IB PVC Single-Ply 80 Mil	<input type="checkbox"/> White* <input type="checkbox"/> Gray <input type="checkbox"/> Tan <input type="checkbox"/> Bronze <input type="checkbox"/> ChemGuard*	<input type="checkbox"/> 20 Year <input type="checkbox"/> 25 Year <input type="checkbox"/> 30 Year	<input type="checkbox"/> Commercial Limited Material Warranty (CLMW)
			<input type="checkbox"/> Residential Limited Material Warranty (RLMW)

* Meets CRRC, Title-24, & EnergyStar Standards

*** Refer to Warranty Selection Guide for Warranty Riders, Term Length Limitations, and eligibility requirements of the Warranty Program

Submitted By:

Address:

Email:

Project Name:

Address: