

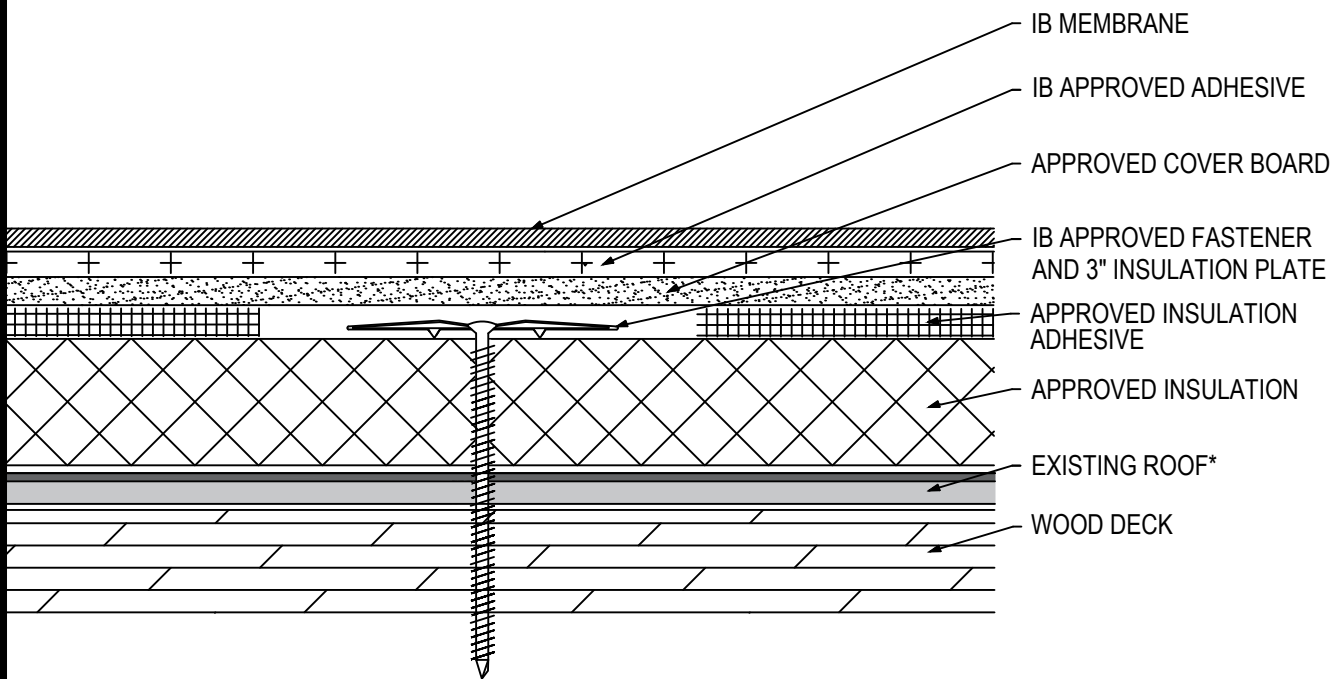





Fully Adhered Membrane - Cover Board (RB) - Insulation (MA) - Existing Roof - Wood Deck (Recover)

| Fire Rating / Max. Slope | | Deck Type | Insulation (over Existing Roof) | | | Cover Board | | | IB Membrane Attachment | Max. Design Pressure** |
|---|-------------|----------------|---------------------------------|------------------------------------|--|--------------------------------|-------------------------------------|-----------------------------------|---------------------------|------------------------------|
| | | | Type | Attachment | Fastener | Type | Insulation Adhesive | Fasteners | | |
|  | 1'Not Rated | 7/16" OSB | Approved Insulation | 16 per 4' x 8' (1 per 2 sq. ft.) | Min. IB SD #12 or HD #14, 3" IB Insulation Plate | Min. Approved 1/4" Cover Board | BM, CR20, OB500, OSFA, PG1, or RSIA | Four continuous ribbons, 12" o.c. | IB Approved Adhesive | Minimum Req. for IB Warranty |
|  | 1'Not Rated | 1/2" Plywood | Approved Insulation | 10 per 4' x 8' (1 per 3.2 sq. ft.) | Min. IB SD #12 or HD #14, 3" IB Insulation Plate | Min. Approved 1/4" Cover Board | BM, CR20, OB500, OSFA, PG1, or RSIA | Four continuous ribbons, 12" o.c. | IB Approved Adhesive | Minimum Req. for IB Warranty |
|  | 1'Not Rated | 1/2" Plywood | Min. 1.5" Approved Insulation | 20 per 4' x 8' (1 per 1.6 sq. ft.) | Min. IB SD #12 or HD #14, 3" IB Insulation Plate | Min. Approved 1/4" Cover Board | BM, CR20, OB500, OSFA, PG1, or RSIA | Four continuous ribbons, 12" o.c. | IB Approved Adhesive | -45.0 psf (Class 90) |
|  | 1'Not Rated | 19/32" Plywood | Min. 1.5" Approved Insulation | 24 per 4' x 8' (1 per 1.3 sq. ft.) | Min. IB XHD #15, 3" IB Insulation Plate | Min. Approved 1/4" Cover Board | BM, CR20, OB500, OSFA, PG1, or RSIA | Four continuous ribbons, 12" o.c. | IB Approved Adhesive | -75.0 psf (Class 150) |
|  | 1'Not Rated | 19/32" Plywood | Min. 1.5" Approved Insulation | 24 per 4' x 8' (1 per 1.3 sq. ft.) | Min. IB XHD #15, 3" IB Insulation Plate | Min. Approved 1/4" Cover Board | BM, CR20, OB500, OSFA, PG1, or RSIA | Four continuous ribbons, 12" o.c. | IB Approved Adhesive | -75.0 psf (Class 150) |

Existing Roof: APP or SBS modified bitumen, smooth or granule surfaced asphaltic built-up roof, or single-ply membrane (CPA, CSPE, EPDM, PVC, or TPO)
Approved Insulation: IB EnergyBoard II or III, or IB Approved UL Classified Polyisocyanurate, IB Approved UL Classified Extruded Polystyrene, IB Approved UL Classified Insulation
Approved Cover Board: DensDeck Prime, Securock Gypsum Fiber Board, minimum 1/4\"/>

Fire Classification Note(s): *This assembly is not UL Classified

** Refer to Substrate Resistance table for required pull-out values.

For additional information about IB Roof Systems requirements, recommendations, installation details, approvals and limitations for the above assemblies, please refer to the latest edition of the IB Roof Systems Specifications Manual. For Technical Services please contact us at 800-426-1626.

| Membranes: | Membrane Color: | Warranty Length*** | Warranty Type*** |
|---|---|--|---|
| <input type="checkbox"/> IB PVC Single-Ply 50 Mil | <input type="checkbox"/> White* <input type="checkbox"/> Gray <input type="checkbox"/> Tan <input type="checkbox"/> Bronze <input type="checkbox"/> ChemGuard* | <input type="checkbox"/> 10 Year <input type="checkbox"/> 15 Year <input type="checkbox"/> 20 Year | <input type="checkbox"/> Total System - No Dollar Limit (NDL) |
| <input type="checkbox"/> IB PVC Single-Ply 60 Mil | <input type="checkbox"/> White* <input type="checkbox"/> Cool Sand* <input type="checkbox"/> Cool Stone* <input type="checkbox"/> Gray <input type="checkbox"/> Tan | <input type="checkbox"/> 15 Year <input type="checkbox"/> 20 Year <input type="checkbox"/> 25 Year | <input type="checkbox"/> Warranty Plus (WP) |
| <input type="checkbox"/> IB PVC Single-Ply 80 Mil | <input type="checkbox"/> White* <input type="checkbox"/> Gray <input type="checkbox"/> Tan <input type="checkbox"/> Bronze <input type="checkbox"/> ChemGuard* | <input type="checkbox"/> 15 Year <input type="checkbox"/> 20 Year <input type="checkbox"/> 25 Year | <input type="checkbox"/> Commercial Limited Material Warranty (CLMW) <input type="checkbox"/> Residential Limited Material Warranty (RLMW) |

* Meets CRRC, Title-24, & EnergyStar Standards

*** Refer to Warranty Selection Guide for Warranty Riders, Term Length Limitations, and eligibility requirements of the Warranty Program

| | |
|--|----------------------------------|
| Submitted By: Address: Email: | Project Name: Address: |
|--|----------------------------------|