

## Fully Adhered Membrane - Cover Board (MA) - Wood Deck (New or Tear-Off)

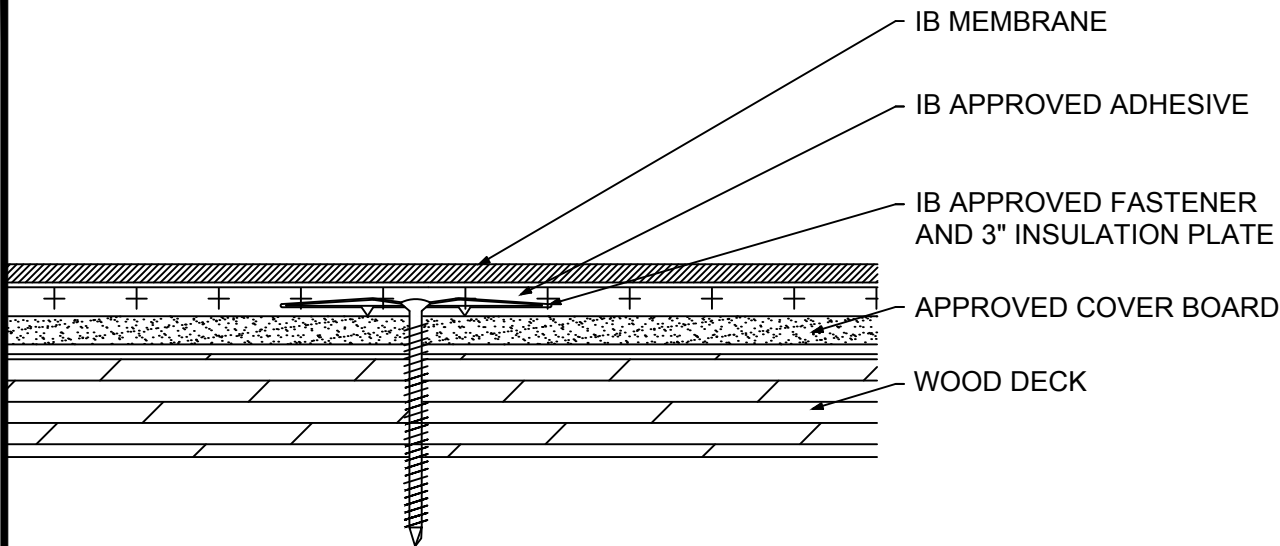

Fire Rating / Max. Slope	Deck Type	Cover Board			IB Membrane Attachment	Max. Design Pressure**
		Type	Attachment	Fasteners		
<input type="checkbox"/> Not Classified	7/16" OSB	Min. Approved 1/4" Cover Board	16 per 4' x 8' (1 per 2 sq. ft.)	IB SD #12 or HD #14, IB 3" Insulation Plate	IB Approved Adhesive	Minimum Req. for IB Warranty
<input type="checkbox"/> Not Classified	7/16" OSB	Min. Approved 1/2" Cover Board	12 per 4' x 8' (1 per 2.67 sq. ft.)	IB SD #12 or HD #14, IB 3" Insulation Plate	IB Approved Adhesive	Minimum Req. for IB Warranty
<input type="checkbox"/> <sup>1</sup> Class 'A' Unlimited	1/2" Plywood	Min. Approved 1/4" Cover Board	12 per 4' x 8' (1 per 2.67 sq. ft.)	IB SD #12 or HD #14, IB 3" Insulation Plate	IB Approved Adhesive	Minimum Req. for IB Warranty
<input type="checkbox"/> <sup>1</sup> Class 'A' Unlimited	1/2" Plywood	Min. Approved 1/2" Cover Board	10 per 4' x 8' (1 per 3.2 sq. ft.)	IB SD #12 or HD #14, IB 3" Insulation Plate	IB Approved Adhesive	Minimum Req. for IB Warranty
<input type="checkbox"/> <sup>1</sup> Class 'A' Unlimited	19/32" Plywood	Min. Approved 1/4" Cover Board	20 per 4' x 8' (1 per 1.6 sq. ft.)	IB SD #12 or HD #14, IB 3" Insulation Plate	IB Approved Adhesive	-45.0 psf (Class 90)
<input type="checkbox"/> <sup>1</sup> Class 'A' Unlimited	19/32" Plywood	Min. Approved 1/4" Cover Board	24 per 4' x 8' (1 per 1.3 sq. ft.)	IB XHD #15, IB 3" Insulation Plate	IB Approved Adhesive	-75.0 psf (Class 150)

**Approved Cover Board:** DensDeck Prime, DensDeck StormX, Securock Ultralight Coated Glass-Mat, Securock Gypsum Fiber Board, or DexCell FA Glass Mat Roof Board, minimum 1/4" thickness; or minimum 7/16" DexCell Cement Board; minimum 1/2" IB HD ISO or HShield HD ISO; or minimum 1/2" thick Structodek HD Primed

**Fire Classification Note(s):** <sup>1</sup>UL Class 'A' with unlimited slope when utilized with any of the following gypsum cover boards: minimum 1/4" DensDeck Prime or DexCell FA Glass Mat Roof Board, or minimum 7/16" DexCell Cement Board and membrane adhered using IB Vertibond 432 Bonding Adhesive. <sup>2</sup>UL Class 'A' up to 4":12" when utilized with minimum 1/2" Securock Gypsum Fiber Board and membrane adhered using IB Vertibond 432 Bonding Adhesive. <sup>3</sup>UL Class 'A' up to 1/4":12" when utilized with minimum 7/16-in. thick "DEXcell" Cement Board, or minimum 1/4-in. thick "DensDeck Prime® Roofboard" or "DEXcell FA Glass Mat Roof Board", or "SECUROCK® Coated Glass-Mat Roof Board" directly over a plywood roof deck with all butt joints in the barrier board staggered a minimum of 6-in. from plywood roof deck butt joints, and membrane adhered using "IB Water Borne 636 Adhesive". <sup>4</sup>UL Class 'A' up to 1/2":12" when utilized with minimum 1/2" H-Shield HD ISO and membrane adhered using IB Vertibond 432 Bonding Adhesive. <sup>5</sup>UL Class 'A' up to 1/4":12" when utilized with minimum 1/4" Securock Gypsum Fiber Board and membrane adhered using IB Vertibond 432 Bonding Adhesive. <sup>6</sup>The use of other IB Approved Cover Boards may not achieve UL Classification.

**\*\* Refer to Substrate Resistance table for required pull-out values.**

**For additional information about IB Roof Systems requirements, recommendations, installation details, approvals and limitations for the above assemblies, please refer to the latest edition of the IB Roof Systems Specifications Manual. For Technical Services please contact us at 800-426-1626.**

Membranes:	Membrane Color:	Warranty Length***	Warranty Type***
<input type="checkbox"/> IB PVC Single-Ply 50 Mil	<input type="checkbox"/> White* <input type="checkbox"/> Gray <input type="checkbox"/> Tan <input type="checkbox"/> Bronze <input type="checkbox"/> ChemGuard*	<input type="checkbox"/> 10 Year <input type="checkbox"/> 15 Year <input type="checkbox"/> 20 Year	<input type="checkbox"/> Total System - No Dollar Limit (NDL)
<input type="checkbox"/> IB PVC Single-Ply 60 Mil	<input type="checkbox"/> White* <input type="checkbox"/> Cool Sand* <input type="checkbox"/> Cool Stone* <input type="checkbox"/> Gray <input type="checkbox"/> Tan	<input type="checkbox"/> 15 Year <input type="checkbox"/> 20 Year <input type="checkbox"/> 25 Year	<input type="checkbox"/> Warranty Plus (WP)
<input type="checkbox"/> IB PVC Single-Ply 80 Mil	<input type="checkbox"/> White* <input type="checkbox"/> Gray <input type="checkbox"/> Tan <input type="checkbox"/> Bronze <input type="checkbox"/> ChemGuard*	<input type="checkbox"/> 20 Year <input type="checkbox"/> 25 Year <input type="checkbox"/> 30 Year	<input type="checkbox"/> Commercial Limited Material Warranty (CLMW)
			<input type="checkbox"/> Residential Limited Material Warranty (RLMW)

\* Meets CRRC, Title-24, & EnergyStar Standards

\*\*\* Refer to Warranty Selection Guide for Warranty Riders, Term Length Limitations, and eligibility requirements on the Warranty Program

<b>Submitted By:</b> Address: Email:	<b>Project Name:</b> Address:
--	----------------------------------