

### Fully Adhered Membrane (SP) - Insulation (MA) - Existing Roof - Wood Deck (Recover)

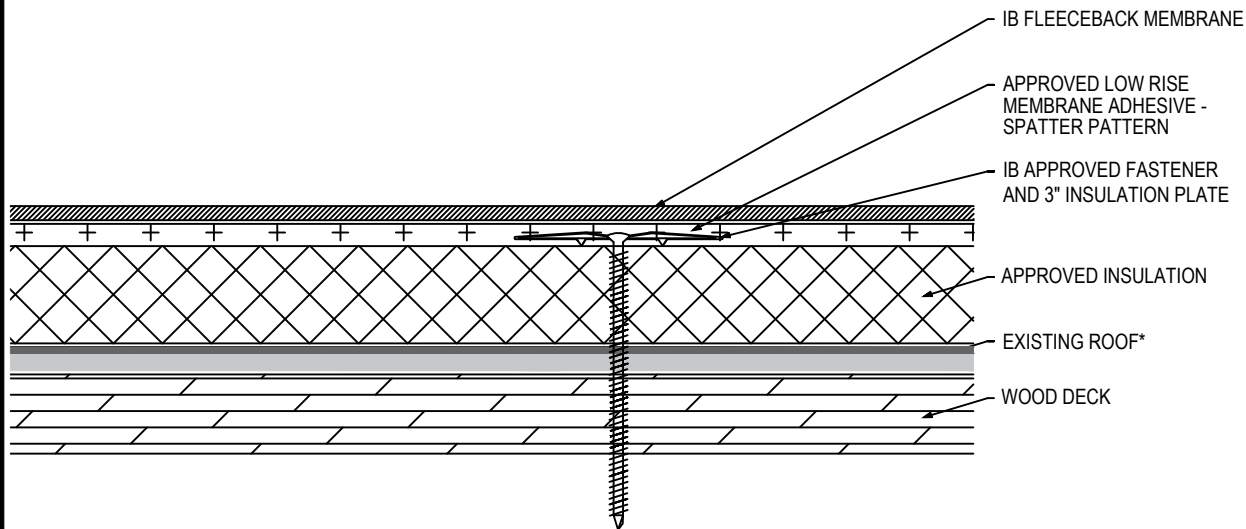

Fire Rating / Max. Slope	Deck Type	Insulation (over Existing Roof)			IB Fleeceback Membrane Attachment	Max. Design Pressure**
		Type	Attachment	Fasteners		
<input type="checkbox"/> Not Rated	7/16" OSB	1.5" Approved Insulation	16 per 4' x 8' (1 per 2 sq. ft.)	IB SD #12 or HD #14, IB 3" Insulation Plate	CR-20 Spatter Pattern 3.75 lbs/square	Minimum Req. for IB Warranty
<input type="checkbox"/> Not Rated	7/16" OSB	2" Approved Insulation	12 per 4' x 8' (1 per 2.67 sq. ft.)	IB SD #12 or HD #14, IB 3" Insulation Plate	CR-20 Spatter Pattern 3.75 lbs/square	Minimum Req. for IB Warranty
<input type="checkbox"/> <sup>1</sup> Maintains Existing 1":12"	1/2" Plywood	1" Approved Insulation	12 per 4' x 8' (1 per 2.67 sq. ft.)	IB SD #12 or HD #14, IB 3" Insulation Plate	CR-20 Spatter Pattern 3.75 lbs/square	Minimum Req. for IB Warranty
<input type="checkbox"/> <sup>1</sup> Maintains Existing 1":12"	1/2" Plywood	1.5" Approved Insulation	10 per 4' x 8' (1 per 3.2 sq. ft.)	IB SD #12 or HD #14, IB 3" Insulation Plate	CR-20 Spatter Pattern 3.75 lbs/square	Minimum Req. for IB Warranty
<input type="checkbox"/> <sup>1</sup> Maintains Existing 1":12"	1/2" Plywood	2" Approved Insulation	8 per 4' x 8' (1 per 4 sq. ft.)	IB SD #12 or HD #14, IB 3" Insulation Plate	CR-20 Spatter Pattern 3.75 lbs/square	Minimum Req. for IB Warranty
<input type="checkbox"/> <sup>1</sup> Maintains Existing 1":12"	1/2" Plywood	1.5" Approved Insulation	20 per 4' x 8' (1 per 1.6 sq. ft.)	IB SD #12 or HD #14, IB 3" Insulation Plate	CR-20 Spatter Pattern 3.75 lbs/square	-45.0 psf (Class 90)
<input type="checkbox"/> <sup>1</sup> Maintains Existing 1":12"	19/32" Plywood	1.5" Approved Insulation	24 per 4' x 8' (1 per 1.3 sq. ft.)	IB XHD #15, IB 3" Insulation Plate	CR-20 Spatter Pattern 3.75 lbs/square	-75.0 psf (Class 150)

**Existing Roof:** APP or SBS modified bitumen, smooth or granule surfaced asphaltic built-up roof, or single-ply membrane (CPA, CSPE, EPDM, PVC, or TPO)

**Approved Insulation:** IB EnergyBoard II or III, Atlas AC Foam II or III; H-Shield, or H-Shield CG

**Fire Classification Note(s):** <sup>1</sup>Maintains existing up to 1":12" slope over any Class A, B or C built up roof system when utilized with any of the following roof insulations: IB Energy Board II, IB Energy Board III, AC Foam II, or AC Foam III any thickness mechanically attached. <sup>2</sup>Use of other IB Approved Insulations may not achieve UL Classification. <sup>3</sup>Recover over modified bitumen or single ply may not retain fire classification.

**\*\* Refer to Substrate Resistance table for required pull-out values.**

**For additional information about IB Roof Systems requirements, recommendations, installation details, approvals and limitations for the above assemblies, please refer to the latest edition of the IB Roof Systems Specifications Manual. For Technical Services please contact us at 800-426-1626.**

Membranes:	Membrane Color:	Warranty Length***	Warranty Type***
<input type="checkbox"/> IB PVC Single-Ply 50 FB Mil	<input type="checkbox"/> White*	<input type="checkbox"/> 10 Year <input type="checkbox"/> 15 Year <input type="checkbox"/> 20 Year	<input type="checkbox"/> Total System - No Dollar Limit (NDL)
<input type="checkbox"/> IB PVC Single-Ply 60 FB Mil	<input type="checkbox"/> White*	<input type="checkbox"/> 15 Year <input type="checkbox"/> 20 Year <input type="checkbox"/> 25 Year	<input type="checkbox"/> Warranty Plus (WP)
<input type="checkbox"/> IB PVC Single-Ply 80 FB Mil	<input type="checkbox"/> White*	<input type="checkbox"/> 15 Year <input type="checkbox"/> 20 Year <input type="checkbox"/> 25 Year	<input type="checkbox"/> Commercial Limited Material Warranty (CLMW)
			<input type="checkbox"/> Residential Limited Material Warranty (RLMW)

\* Meets CRRC, Title-24, & EnergyStar Standards

\*\*\* Refer to Warranty Selection Guide for Warranty Riders, Term Length Limitations, and eligibility requirements of the Warranty Program

<b>Submitted By:</b>	<b>Project Name:</b>
<b>Address:</b>	<b>Address:</b>
<b>Email:</b>	