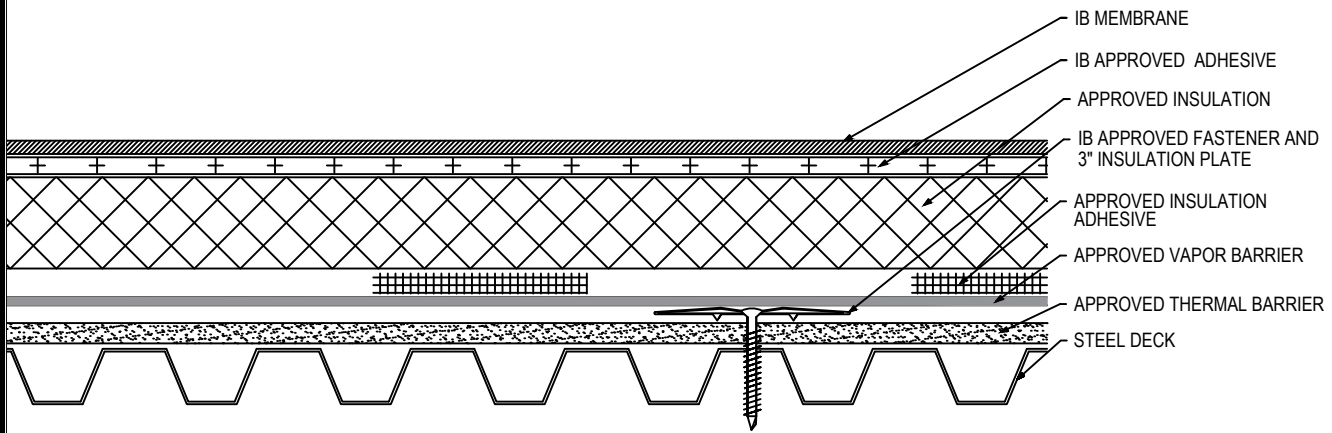

Fully Adhered Membrane - Insulation (RB) - Vapor Barrier - Thermal Barrier (MA) - Steel Deck (New or Tear Off)

| Fire Rating / Max. Slope | Deck Type | Thermal Barrier/Vapor Barrier | | | Insulation | | | IB Membrane Attachment | Max. Design Pressure** |
|--|---|--|---|--|--------------------------------|--|--------------------------------------|------------------------------|---------------------------------|
| | | Type | Attachment | Fastener | Type | Insulation Adhesive | Pattern | | |
| <input type="checkbox"/> ¹ Class "A" ¹ / ₂ " : 12" | Min 22 ga. Type B Grade 33 Steel | Min ¹ / ₂ " Approved Thermal Barrier & Vapor Barrier | 8 per 4' x 8' (1 per 4.0 sq. ft.) | Min. IB SD #12 or HD #14, 3" IB Insulation Plate | Min. 1" Approved Insulation | BM, CR20, OB500, OSFA, PG1, or RSIA | Four continuous ribbons, 12" o.c. | IB Approved Adhesive | Minimum Req. for IB Warranty |
| <input type="checkbox"/> ¹ Class "A" ¹ / ₂ " : 12" | Min 22 ga. Type B Grade 33 Steel | Min ¹ / ₂ " Approved Thermal Barrier & Vapor Barrier | 12 per 4' x 8' (1 per 2.67 sq. ft.) | Min. IB SD #12 or HD #14, 3" IB Insulation Plate | Min. 1" Approved Insulation | BM, CR20, OB500, OSFA, PG1, or RSIA | Four continuous ribbons, 12" o.c. | IB Approved Adhesive | Minimum Req. for IB Warranty |
| <input type="checkbox"/> ¹ Class "A" ¹ / ₂ " : 12" | Min 22 ga. Type B Grade 33 Steel | Min ¹ / ₂ " Approved Thermal Barrier & Vapor Barrier | 16 per 4' x 8' (1 per 2.0 sq. ft.) | Min. IB SD #12 or HD #14, 3" IB Insulation Plate | Min. 1" Approved Insulation | BM, CR20, OB500, OSFA, PG1, or RSIA | Four continuous ribbons, 12" o.c. | IB Approved Adhesive | Minimum Req. for IB Warranty |

Approved Thermal Barrier: DensDeck Prime, Securock Gypsum Fiber Board, minimum ¹/₂" thickness

Approved Vapor Barrier: IBarrier SA Membrane, SopraVap'r SA, applied using self-adhesive techniques

Approved Insulation: IB EnergyBoard II or III, Atlas AC Foam II or III; H-Shield, or H-Shield CG

Approved Insulation Adhesive: BM = Polyset BoardMax, CR-20 = Polyset CR-20, OB500 = OlyBond 500 Adhesive Fastener, OSFA = Millennium One-Step Foamable Adhesive; PG-1 = Millennium PG-1 Pump Grade Adhesive; or RSIA = IB Rapid Set Insulation Adhesive; maximum bead spacing 12" o.c. unless otherwise indicated

Fire Classification Note(s): ¹UL Class 'A' up to ¹/₂" : 12" when utilized with minimum 1" thickness H-Shield CG, or minimum 3" thickness AC Foam III or IB EnergyBoard III. ²UL Class 'C' Classification with an unlimited slope when utilized with minimum 1" thickness H-Shield ISO or H-Shield CG. ³Other IB Approved Insulations or lesser thicknesses may not achieve UL Classification.

** Refer to Substrate Resistance table for required pull-out values.

For additional information about IB Roof Systems requirements, recommendations, installation details, approvals and limitations for the above assemblies, please refer to the latest edition of the IB Roof Systems Specifications Manual. For Technical Services please contact us at 800-426-1626.

| Membranes: | Membrane Color: | Warranty Length*** | Warranty Type*** |
|---|---|--|---|
| <input type="checkbox"/> IB PVC Single-Ply 50 Mil | <input type="checkbox"/> White* <input type="checkbox"/> Gray <input type="checkbox"/> Tan <input type="checkbox"/> Bronze <input type="checkbox"/> ChemGuard* | <input type="checkbox"/> 10 Year <input type="checkbox"/> 15 Year <input type="checkbox"/> 20 Year | <input type="checkbox"/> Total System - No Dollar Limit (NDL) |
| <input type="checkbox"/> IB PVC Single-Ply 60 Mil | <input type="checkbox"/> White* <input type="checkbox"/> Cool Sand* <input type="checkbox"/> Cool Stone* <input type="checkbox"/> Gray <input type="checkbox"/> Tan | <input type="checkbox"/> 15 Year <input type="checkbox"/> 20 Year <input type="checkbox"/> 25 Year | <input type="checkbox"/> Warranty Plus (WP) |
| <input type="checkbox"/> IB PVC Single-Ply 80 Mil | <input type="checkbox"/> White* <input type="checkbox"/> Gray <input type="checkbox"/> Tan <input type="checkbox"/> Bronze <input type="checkbox"/> ChemGuard* | <input type="checkbox"/> 20 Year <input type="checkbox"/> 25 Year <input type="checkbox"/> 30 Year | <input type="checkbox"/> Commercial Limited Material Warranty (CLMW) |
| | | | <input type="checkbox"/> Residential Limited Material Warranty (RLMW) |

* Meets CRRC, Title-24, & EnergyStar Standards

*** Refer to Warranty Selection Guide for Warranty Riders, Term Length Limitations, and eligibility requirements of the Warranty Program

Submitted By:

Address:

Email:

Project Name:

Address: