

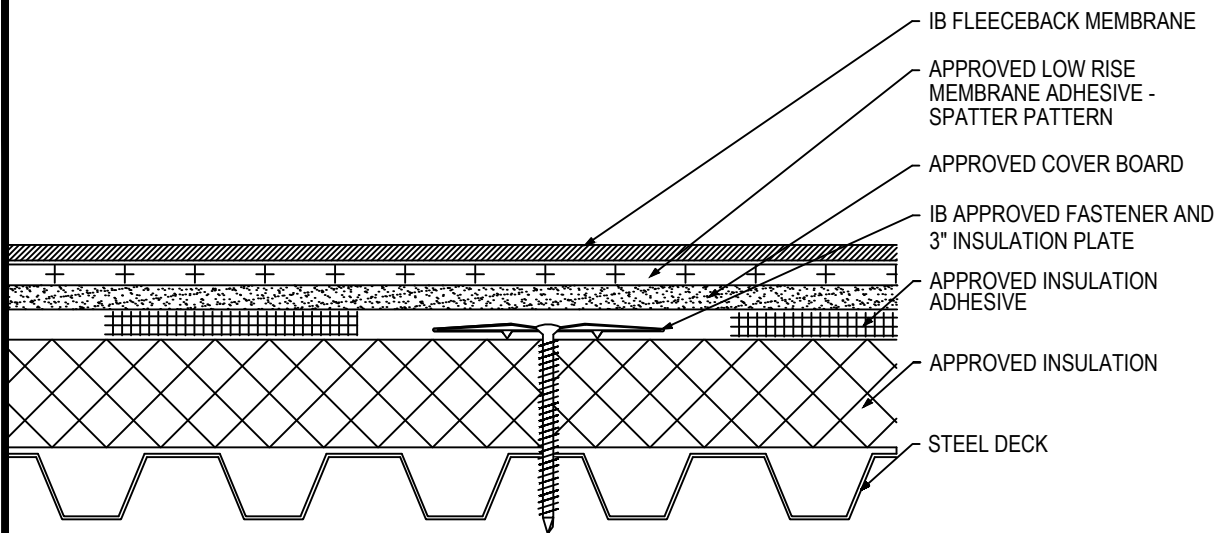





Fully Adhered Membrane (SP) - Cover Board (RB) - Insulation (MA) - Steel Deck (New or Tear Off)



Fire Rating / Max. Slope		Deck Type	Insulation			Cover Board			IB Fleeceback Membrane Attachment	Max. Design Pressure**
			Type	Attachment	Fasteners	Type	Insulation Adhesive	Pattern		
	'Class "A" Unlimited	Min. 22 ga. Type B, Grade 33 Steel	Min. 1" Approved Insulation	12 per 4' x 8' (1 per 2.9 sq. ft.)	Min. IB SD #12 or HD #14, 3" IB Insulation Plate	Min. Approved 1/4" Cover Board	BM, CR20, OB500, OSFA, PG1, or RSIA	Four continuous ribbons, 12" o.c.	CR-20 Spatter Pattern 3.75 lbs/square	Minimum Req. for IB Warranty
	'Class "A" Unlimited	Min. 22 ga. Type B, Grade 33 Steel	Min. 2" Approved Insulation	11 per 4' x 8' (1 per 2.9 sq. ft.)	Min. IB SD #12 or HD #14, 3" IB Insulation Plate	Min. Approved 1/4" Cover Board	BM, CR20, OB500, OSFA, PG1, or RSIA	Four continuous ribbons, 12" o.c.	CR-20 Spatter Pattern 3.75 lbs/square	-45.0 psf (Class 90)
	'Class "A" Unlimited	Min. 22 ga. Type B, Grade 33 Steel	Min. 2" Approved Insulation	20 per 4' x 8' (1 per 1.6 sq. ft.)	Min. IB SD #12 or HD #14, 3" IB Insulation Plate	Min. 1/4" DensDeck Prime	CR20, OB500, OSFA, PG1, or RSIA	Eight continuous ribbons, 6" o.c.	CR-20 Spatter Pattern 3.75 lbs/square	-60.0 psf (Class 120)
	'Class "A" Unlimited	Min. 22 ga. Type B, Grade 33 Steel	Min. 2" Approved Insulation	20 per 4' x 8' (1 per 1.6 sq. ft.)	Min. IB XHD #15 3" IB Insulation Plate	Min. Approved 1/4" Cover Board	CR20, OB500, OSFA, PG1, or RSIA	Eight continuous ribbons, 6" o.c.	CR-20 Spatter Pattern 3.75 lbs/square	-75.0 psf (Class 150)
	'Class "A" Unlimited	Min. 22 ga. Type B, Grade 33 Steel	Min. 2" Approved Insulation	24 per 4' x 8' (1 per 1.3 sq. ft.)	Min. IB XHD #15 3" IB Insulation Plate	Min. 1/4" Securock Gypsum Fiber Board	CR20, OB500, OSFA, PG1, or RSIA	Eight continuous ribbons, 6" o.c.	CR-20 Spatter Pattern 3.75 lbs/square	-97.5 psf (Class 195)

Approved Insulation: IB EnergyBoard II or III, AC Foam II or III, H-Shield or H-Shield CG, IB Approved UL Classified Expanded Polystyrene, IB Approved UL Classified Extruded Polystyrene Insulation.

Approved Cover Board: DensDeck Prime, Securock Coated Glass-Mat Roof Board, Securock Gypsum Fiber Board, DexCell FA Glass Mat Roof Board minimum 1/4" or minimum 7/16-in. thick DexCell Cement Board, or minimum 1/2" IB HD ISO or H-Shield HD ISO; or minimum 1/2" thick Structodek HD Primed.

Approved Insulation Adhesive: BM = Polyset BoardMax, CR-20 = Polyset CR-20, OB500 = OlyBond 500 Adhesive Fastener, OSFA = Millennium One-Step Foamable Adhesive; PG-1 = Millennium PG-1 Pump Grade Adhesive; or RSIA = IB Rapid Set Insulation Adhesive; maximum bead spacing 12" o.c. unless otherwise indicated

Fire Classification Note(s): ¹UL Class 'A' up with unlimited slope when utilized with any of the following IB Approved ISO Insulations: IB Energy Board II, IB Energy Board III, AC Foam II, AC Foam III, any thickness, mechanically and minimum 1/4-in thick DensDeck Prime, Securock Coated Glass-Mat Roof Board, or DexCell FA Glass Mat Roof Board, or minimum 7/16-in. thick DexCell Cement Board, adhered with any UL Classified Insulation adhesive. ²UL Class 'A' up to 1":12" when utilized with any UL Classified Insulation (except expanded or extruded polystyrene), any combination, any thickness, mechanically attached and minimum 1/2" IB HD ISO or H-Shield HD ISO, adhered with any UL Classified Insulation adhesive. ³UL Class 'A' up to 1/2":12" when utilized with any UL Classified insulation (except expanded or extruded polystyrene), any combination, any thickness, mechanically attached and minimum 1/4" Securock Gypsum Fiber Board, adhered with any UL Classified insulation adhesive. ⁴The use of other IB Approved Cover Boards may not achieve UL classification.

**** Refer to Substrate Resistance table for required pull-out values.**

For additional information about IB Roof Systems requirements, recommendations, installation details, approvals and limitations for the above assemblies, please refer to the latest edition of the IB Roof Systems Specifications Manual. For Technical Services please contact us at 800-426-1626.

Membranes:	Membrane Color:	Warranty Length***	Warranty Type***
<input type="checkbox"/> IB PVC Single-Ply FB 50 Mil	<input type="checkbox"/> White*	<input type="checkbox"/> 10 Year <input type="checkbox"/> 15 Year <input type="checkbox"/> 20 Year	<input type="checkbox"/> Total System - No Dollar Limit (NDL)
<input type="checkbox"/> IB PVC Single-Ply FB 60 Mil	<input type="checkbox"/> White*	<input type="checkbox"/> 15 Year <input type="checkbox"/> 20 Year <input type="checkbox"/> 25 Year	<input type="checkbox"/> Warranty Plus (WP)
<input type="checkbox"/> IB PVC Single-Ply FB 80 Mil	<input type="checkbox"/> White*	<input type="checkbox"/> 20 Year <input type="checkbox"/> 25 Year <input type="checkbox"/> 30 Year	<input type="checkbox"/> Commercial Limited Material Warranty (CLMW)
			<input type="checkbox"/> Residential Limited Material Warranty (RLMW)

* Meets CRRC, Title-24, & EnergyStar Standards

*** Refer to Warranty Selection Guide for Warranty Riders, Term Length Limitations, and eligibility requirements of the Warranty Program

Submitted By: Address: Email:	Project Name: Address:
--	----------------------------------