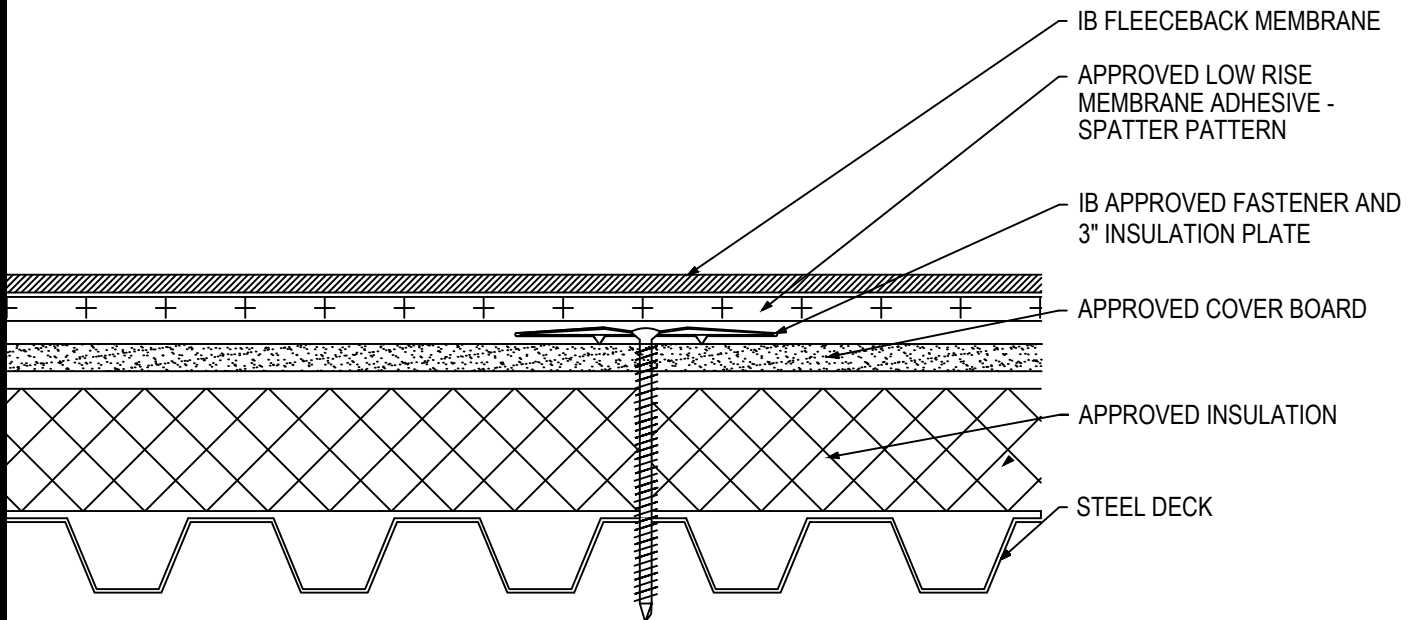

**Fully Adhered Membrane (SP) - Cover Board(MA) - Insulation(MA) - Steel Deck (New or Tear-Off)**

Fire Rating / Max. Slope	Deck Type	Insulation / Cover Board			IB Fleeceback Membrane Attachment	Max. Design Pressure**
		Type	Attachment	Fasteners		
<input type="checkbox"/> 'Class 'A' Unlimited	Min 22 ga. Type B, Grade 33 Steel	Min. Approved 1/4" Cover Board & Approved Insulation	10 per 4' x 8' (1 per 3.2 sq. ft.)	IB SD #12 or HD #14, IB 3" Insulation Plate	CR-20 Spatter Pattern 3.75 lbs/square	Minimum Req. for IB Warranty
<input type="checkbox"/> 'Class 'A' Unlimited	Min 22 ga. Type B, Grade 33 Steel	Min. Approved 1/2" Cover Board & Approved Insulation	12 per 4' x 8' (1 per 2.67 sq. ft.)	IB SD #12 or HD #14, IB 3" Insulation Plate	CR-20 Spatter Pattern 3.75 lbs/square	Minimum Req. for IB Warranty
<input type="checkbox"/> 'Class 'A' Unlimited	Min 22 ga. Type B, Grade 33 Steel	Min. Approved 1/4" Cover Board & Approved Insulation	16 per 4' x 8' (1 per 2.0 sq. ft.)	IB SD #12 or HD #14, IB 3" Insulation Plate	CR-20 Spatter Pattern 3.75 lbs/square	-45.0 psf (Class 90)
<input type="checkbox"/> 'Class 'A' Unlimited	Min 22 ga. Type B, Grade 33 Steel	Min. Approved 1/2" Cover Board & Approved Insulation	24 per 4' x 8' (1 per 1.3 sq. ft.)	IB XHD #15, IB 3" Insulation Plate	CR-20 Spatter Pattern 3.75 lbs/square	-75.0 (Class 150)

**Approved Insulation:** IB Energy Board II or III, H-Shield, or H-Shield CG, or IB Approved UL Classified Polyisocyanurate, IB Approved UL Classified Expanded Polystyrene, IB Approved UL Classified Extruded polystyrene Insulation

**Approved Cover Board:** DensDeck Prime, Securock Gypsum Fiber Board, minimum 1/4" thickness; or minimum 1/2" IB HD ISO or H-Shield HD ISO; or minimum 1/2" thick Structodek HD Primed

**Fire Classification Note(s):** <sup>1</sup>UL Class 'A' with unlimited slope when utilized with any of the following IB Approved ISO insulations: IB Energy Board II, IB Energy Board III, ACFoam II, ACFoam III, any thickness, loose laid or mechanically attached and minimum 1/4-in thick DensDeck Prime, Securock Coated Glass-Mat Roof Board, or DexCell FA Glass Mat Roof Board, or minimum 7/16-in thick DexCell Cement Board, mechanically fastened. <sup>2</sup>UL Class 'A' up to 1":12" when utilized with any UL Classified insulation (except expanded or extruded polystyrene), any combination, any thickness, loosely laid or mechanically attached and minimum 1/2" IB HD ISO or H-Shield HD ISO, mechanically attached. <sup>3</sup>UL Class 'A' up to 1/2":12" when utilized with any UL Classified insulation (except expanded or extruded polystyrene), any combination, any thickness, loosely laid or mechanically attached and minimum 1/2" Securock Gypsum Fiber Board, mechanically attached. <sup>4</sup>The use of other IB Approved Cover Boards may not achieve UL classification.

\*\* Refer to Substrate Resistance table for required pull-out values.

**For additional information about IB Roof Systems requirements, recommendations, installation details, approvals and limitations for the above assemblies, please refer to the latest edition of the IB Roof Systems Specifications Manual. For Technical Services please contact us at 800-426-1626.**

Membranes:	Membrane Color:	Warranty Length***	Warranty Type***
<input type="checkbox"/> IB PVC Single-Ply FB50 Mil	<input type="checkbox"/> White*	<input type="checkbox"/> 10 Year <input type="checkbox"/> 15 Year <input type="checkbox"/> 20 Year	<input type="checkbox"/> Total System - No Dollar Limit (NDL)
<input type="checkbox"/> IB PVC Single-Ply FB60 Mil	<input type="checkbox"/> White*	<input type="checkbox"/> 15 Year <input type="checkbox"/> 20 Year <input type="checkbox"/> 25 Year	<input type="checkbox"/> Warranty Plus (WP)
<input type="checkbox"/> IB PVC Single-Ply FB80 Mil	<input type="checkbox"/> White*	<input type="checkbox"/> 20 Year <input type="checkbox"/> 25 Year <input type="checkbox"/> 30 Year	<input type="checkbox"/> Commercial Limited Material Warranty (CLMW)
			<input type="checkbox"/> Residential Limited Material Warranty (RLMW)

\* Meets CRRC, Title-24, & EnergyStar Standards

\*\*\* Refer to Warranty Selection Guide for Warranty Riders, Term Length Limitations, and eligibility requirements of the Warranty Program

**Submitted By:**  
Address:  
Email:

**Project Name:**  
Address: