

## Fully Adhered Membrane - Insulation(MA) - Concrete Deck (New or Tear-Off)

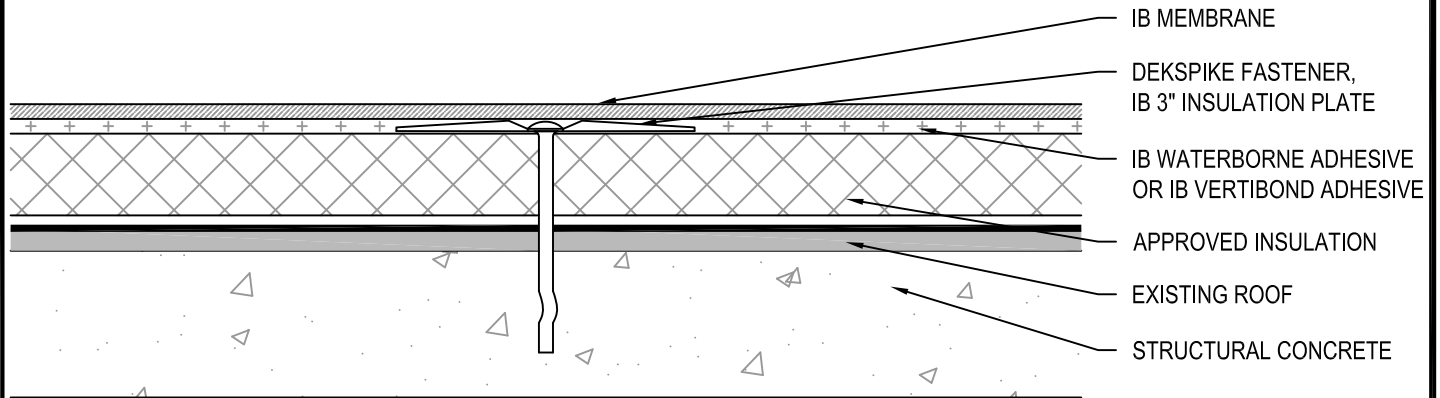

Fire Rating / Max. Slope	Deck Type	Insulation (over Existing Roof)			IB Membrane Attachment	Max. Design Pressure**
		Type	Attachment	Fasteners		
<input type="checkbox"/> Class 'A' 2" : 12"	Structural Concrete	Min. 1.5" Approved Insulation	10 per 4' x 8' (1 per 3.2 sq. ft.)	Dekspike, IB 3" Insulation Plate	IB Waterborne or IB Vertibond Adhesive	-30.0 psf (Class 60)
<input type="checkbox"/> Class 'A' 2" : 12"	Structural Concrete	Min. 1.5" Approved Insulation	16 per 4' x 8' (1 per 2 sq. ft.)	Dekspike, IB 3" Insulation Plate	IB Waterborne or IB Vertibond Adhesive	-45.0 psf (Class 90)
<input type="checkbox"/> Class 'A' 2" : 12"	Structural Concrete	Min. 2" Approved Insulation	8 per 4' x 8' (1 per 4 sq. ft.)	Dekspike, IB 3" Insulation Plate	IB Waterborne or IB Vertibond Adhesive	-45.0 psf (Class 90)

**Approved Insulation:** IB Energy Board II & III or IB Approved UL Classified Polyisocyanurate Insulation.

\*\* Refer to Substrate Resistance table for required pull-out values.

For additional information about IB Roof Systems requirements, recommendations, installation details, approvals and limitations for the above assemblies, please refer to the latest edition of the IB Roof Systems Specifications Manual. For Technical Services please contact us at 800-426-1626.

Membranes:	Colors:	Warranties:	Warranty Lengths:
<input type="checkbox"/> 50 Mil Membrane	<input type="checkbox"/> White* <input type="checkbox"/> Cool Sand* <input type="checkbox"/> ChemGuard*	<input type="checkbox"/> Total System (NDL)	<input type="checkbox"/> 10 yr (50, 60, and 80 mil)
<input type="checkbox"/> 60 Mil Membrane	<input type="checkbox"/> Gray <input type="checkbox"/> Green <input type="checkbox"/> Red	<input type="checkbox"/> Warranty Plus	<input type="checkbox"/> 15 yr (50, 60, and 80 mil)
<input type="checkbox"/> 80 Mil Membrane	<input type="checkbox"/> Tan <input type="checkbox"/> Brown <input type="checkbox"/> Custom: _____	<input type="checkbox"/> Commercial Limited Material	<input type="checkbox"/> 20 yr (60 and 80 mil)
	* Meets CRRC, Title-24, & EnergyStar Standards	<input type="checkbox"/> Lifetime Residential Limited Material	<input type="checkbox"/> 25 yr (80 mil)

<b>Submitted By:</b> Address: Telephone:	<b>Project Name:</b> Address:
--	----------------------------------

