

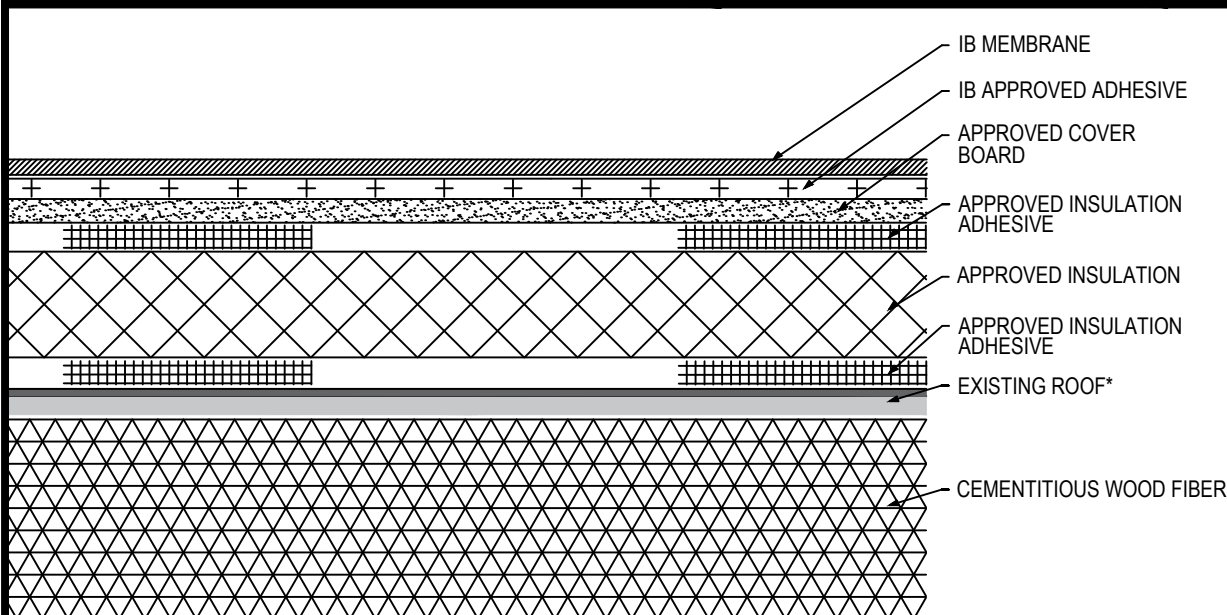





Fully Adhered Membrane - Cover Board (RB) - Insulation (RB) - Existing Roof - Cementitious Wood Fiber Deck (Recover)

Fire Rating / Max. Slope		Deck Type	Insulation (over Existing Asphaltic Roof)			Cover Board			IB Membrane Attachment	Max. Design Pressure**
			Type	Adhesive	Pattern	Type	Adhesive	Pattern		
	Not Rated	Cementitious Wood Fiber	Approved Insulation	BM, CR20, OB500, OSFA, PG1, or RSIA	Four continuous ribbons, 12" o.c.	Approved Cover Board	BM, CR20, OB500, OSFA, PG1, or RSIA	Four continuous ribbons, 12" o.c.	IB Approved Adhesive	Minimum Req for IB Warranty
	Not Rated	Cementitious Wood Fiber	Min. 2" Insulfoam IX EPS Insulation or Min. 1.5" EnergyBoard II Insulation	OB500	Four continuous ribbons, 12" o.c.	1/4" DensDeck Prime or 1/4" Securock Gypsum Fiber Board	OB500	Four continuous ribbons, 12" o.c.	IB Approved Adhesive	-120.0 psf (Class 240)
	Not Rated	Cementitious Wood Fiber	Min. 1.5" EnergyBoard II or AC Foam II Insulation	OSFA, PG1, or RSIA	Four continuous ribbons, 12" o.c.	1/4" DensDeck Prime or 1/4" Securock Gypsum Fiber Board	OSFA, PG1, or RSIA	Four continuous ribbons, 12" o.c.	IB Approved Adhesive	-232.5 psf (Class 465)
	Not Rated	Cementitious Wood Fiber	Min. 1.0" EnergyBoard II or III, AC Foam II or III, or H-Shield or H-Shield CG Insulation	CR20	Four continuous ribbons, 12" o.c.	1/4" DensDeck Prime	CR20	Four continuous ribbons, 12" o.c.	IB Approved Adhesive	-257.5 psf (Class 515)
	Not Rated	Cementitious Wood Fiber	Min. 1.0" EnergyBoard II or III, AC Foam II or III, or H-Shield or H-Shield CG Insulation	CR20	Four continuous ribbons, 12" o.c.	1/4" Securock Gypsum Fiber Board	CR20	Four continuous ribbons, 12" o.c.	IB Approved Adhesive	-267.5 psf (Class 535)

Existing Roof: APP or SBS modified bitumen, smooth or granule surfaced asphaltic built-up roof only

Approved Insulation: IB EnergyBoard II or III, AC Foam II or III, H-Shield or H-Shield CG or Insulfoam IX EPS, or IB Approved UL Classified Polyisocyanurate,

Approved Cover Board: DensDeck Prime, Securock Coated Glass-Mat Roof Board, Securock Gypsum Fiber Board, or DexCell FA Glass Mat Roof Board minimum 1/4" thickness; or minimum 7/16-in. thick DexCell Cement Board or minimum 1/2" IB HD ISO; or minimum 1/2" thick StructoDeck HD Primed

Approved Insulation Adhesive: BM = Polyset BoardMax, CR-20 = Polyset CR-20, OB500 = OlyBond 500 Adhesive Fastener, OSFA = Millennium One-Step Foamable Adhesive; PG-1 = Millennium PG-1 Pump Grade Adhesive; or RSIA = IB Rapid Set Insulation Adhesive; maximum bead spacing 12" o.c. unless otherwise indicated.

Fire Classification Note(s): *This assembly is not UL Classified.

**** Refer to Substrate Resistance table for required pull-out values.**

For additional information about IB Roof Systems requirements, recommendations, installation details, approvals and limitations for the above assemblies, please refer to the latest edition of the IB Roof Systems Specifications Manual. For Technical Services please contact us at 800-426-1626.

Membranes:	Membrane Color:	Warranty Length***	Warranty Type***
<input type="checkbox"/> IB PVC Single-Ply 50 Mil	<input type="checkbox"/> White* <input type="checkbox"/> Gray <input type="checkbox"/> Tan <input type="checkbox"/> Bronze <input type="checkbox"/> ChemGuard*	<input type="checkbox"/> 10 Year <input type="checkbox"/> 15 Year <input type="checkbox"/> 20 Year	<input type="checkbox"/> Total System - No Dollar Limit (NDL)
<input type="checkbox"/> IB PVC Single-Ply 60 Mil	<input type="checkbox"/> White* <input type="checkbox"/> Cool Sand* <input type="checkbox"/> Cool Stone* <input type="checkbox"/> Gray <input type="checkbox"/> Tan	<input type="checkbox"/> 15 Year <input type="checkbox"/> 20 Year <input type="checkbox"/> 25 Year	<input type="checkbox"/> Warranty Plus (WP)
<input type="checkbox"/> IB PVC Single-Ply 80 Mil	<input type="checkbox"/> White* <input type="checkbox"/> Gray <input type="checkbox"/> Tan <input type="checkbox"/> Bronze <input type="checkbox"/> ChemGuard*	<input type="checkbox"/> 15 Year <input type="checkbox"/> 20 Year <input type="checkbox"/> 25 Year	<input type="checkbox"/> Commercial Limited Material Warranty (CLMW)
			<input type="checkbox"/> Residential Limited Material Warranty (RLMW)

* Meets CRRC, Title-24, & EnergyStar Standards

*** Refer to Warranty Selection Guide for Warranty Riders, Term Length Limitations, and eligibility requirements of the Warranty Program

Submitted By:

Address:

Email:

Project Name:

Address: