

## Stone Ballasted Membrane - Insulation (LL) - Existing Roof - Concrete Deck (Recover)

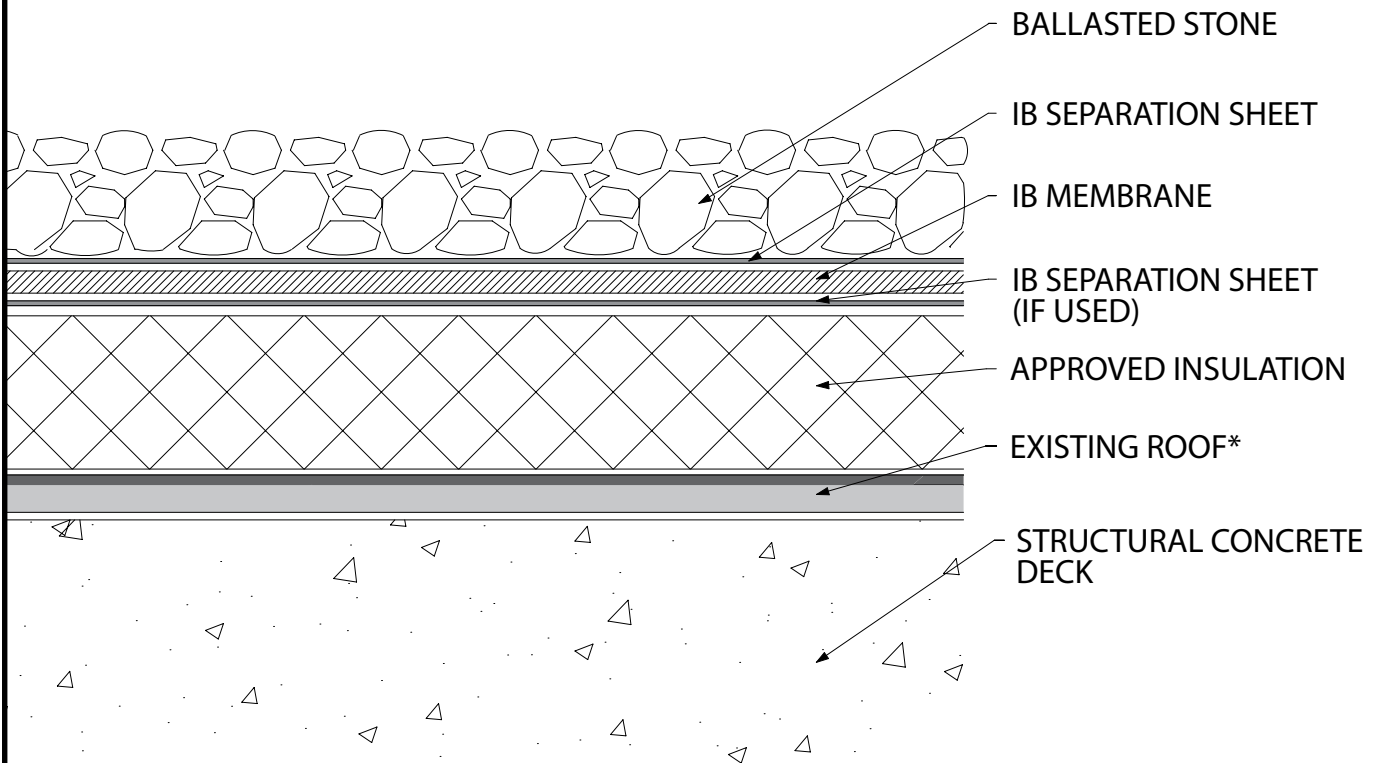

Fire Rating / Max. Slope	Deck Type	Insulation		IB Membrane	Separation Sheet	Surfacing	Max. Design Pressure**
		Type	Attachment				
<sup>1</sup> Maintains Existing 2":12"	Structural Concrete	IB Approved Insulation	Loose Laid	Loose Laid 60 or 80 Mil	IB Approved Separation Sheet	#4 Stone Ballast 10 lbs. / sq. ft.	Refer to ANSI/SPRI RP-4

**Existing Roof:** APP or SBS modified bitumen, smooth, granule or gravel surfaced asphaltic built-up roof, or Single-Ply (CPA, CSPE, EPDM, PVC or TPO).

**Approved Insulation:** IB EnergyBoard II or III, or IB Approved UL Classified Polyisocyanurate, IB Approved UL Classified Expanded Polystyrene, IB Approved UL Classified Extruded Polystyrene Insulation.

**Fire Classification Note:** <sup>1</sup>Maintains existing Classification up to 2":12" over any Class A, B or C built up system, smooth surface or gravel surfaced, gravel may be removed and utilized with any thickness, UL Classified insulation, covered with IB membrane and stone ballast at 10 lbs ft<sup>2</sup>. <sup>2</sup>Other IB Approved Insulations or lesser rates of ballast may not achieve UL Classification. <sup>3</sup>Recover over modified bitumen or other single-ply roofs may not retain fire classification.

**\*\*Refer to Substrate Resistance Table for required pull-out values.**

For additional information about IB Roof Systems requirements, recommendations, installation details, approvals, and limitations for the above assemblies, please refer to the latest edition of the IB Roof Systems Specifications Manual. For Technical Services please contact IB Technical Department at 800-426-1626.

Membranes:	Membrane Color:					Warranty Length***		Warranty Type***
IB PVC Single-Ply 60 Mil	White*	Cool Sand*	Cool Stone*	Gray	Tan	15 Year	20 Year	Total Systems - No Dollar Limit (TSW) Warranty Plus (WP)
IB PVC Single-Ply 80 Mil	White*	Gray	Tan	Bronze	ChemGuard*	20 Year	25 Year	Commercial Limited Material Warranty (CLMW) Residential Limited Material Warranty (RLMW)

\*Meets CRRC, Title 24 & EnergyStar Standards

\*\*\*Refer to Warranty Selection Guide for Warranty Riders, Term Length Limitations, and eligibility requirements of the Warranty Program

Submitted By:

Address:

Email:

Project Name:

Address:

