

APPROVED RIGID INSULATION EPS, XPS, POLYISOCYANURATE INSULATION & COVER BOARD
(IB FASTENER & 3" INSULATION PLATES, 6 PER 4' X 8' BOARD)

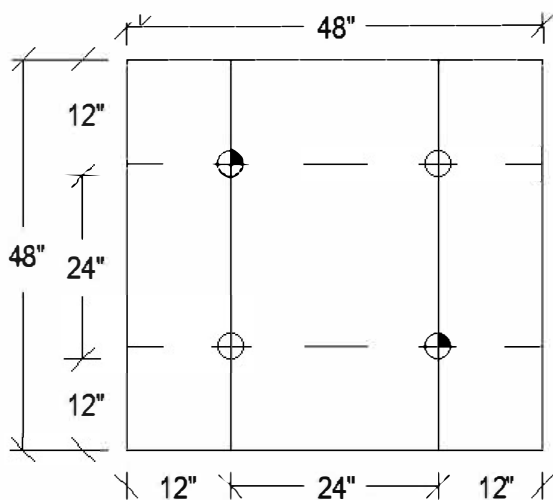

APPROVED RIGID INSULATION EPS, XPS, POLYISOCYANURATE INSULATION & COVER BOARD
(IB FASTENER & 3" INSULATION PLATES, 4 PER 4' X 8' BOARD)

NOTES:

1. FASTENING PATTERNS ARE PROVIDED AS GENERAL GUIDELINES FOR FASTENER PLACEMENT FOR MECHANICALLY ATTACHED INSULATION AND COVER BOARD.
2. REQUIRES MINIMUM 1.5 LB/FT³ DENSITY AND MINIMUM .25" LAYER OF GYPSUM OR HD POLYISOCYANURATE COVER BOARD OR MINIMUM 1.0" LAYER OF IB POLYISOCYANURATE BOARD OR THE USE OF AN IB SEPARATION SHEET ABOVE EPS/XPS INSULATION.

Scale: NTS	Detail Name: <i>Fastening Patterns for Insulation - Cover Board</i>	Detail Number: MA-AT-02
Submitted By: Address: Telephone:	Project: Address:	