

**MINIMUM FASTENER PENETRATIONS AT THE DECK  
(STANDARD ATTACHMENT):**

Deck Type:	Penetration Depth:	Fastener Type:
Plywood or Oriented Strand Board:	1/2" completely through deck	IB HD #14 or IB SD #12
1" Minimum Wood Plank:	1" into deck	IB HD #14 or IB SD #12
Steel:	3/4" completely through top flute	IB XHD #15 or IB HD #14, IB SD #12
Light Weight Insulating Concrete over Steel Deck:	3/4" completely through top flute	IB XHD #15 or IB HD #14
Light Weight Insulating Concrete:	1-1/2" into deck	Deklite or GypTec
Structural Concrete:	1-1/4" into deck	CD -10 or Dekspike
Poured Gypsum:	1-1/2" into deck	Deklite or GypTec
Cementitious Wood Fiber:	1-1/2" into deck	Deklite or GypTec

**IB Standard Pull-Test Values for Fasteners**

7/16" OSB	275 lbs
5/8" OSB	350 lbs
1/2" Plywood	425 lbs
1" Minimum Wood Plank	450 lbs
22 ga. Steel	525 lbs
24 ga. Steel	425 lbs
Structural Concrete	800 lbs
LWIC over 24 ga. Steel	425 lbs
Poured Gypsum	300 lbs
Cementitious Wood Fiber	300 lbs
16 ga Purlin	700 lbs

**Scale:**  
NTS

**Detail Name:**

***In-seam Attachment for Mechanically Attached Membrane***

**Detail Number:**

***MA-AT-01***

**Submitted By:**

**Address:**  
**Telephone:**

**Project:**

**Address:**

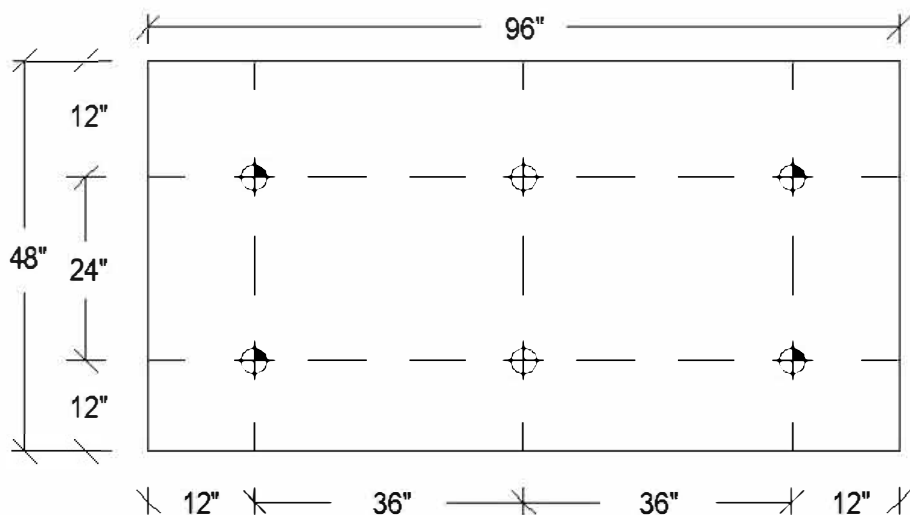

APPROVED RIGID INSULATION EPS, XPS, POLYISOCYANURATE INSULATION & COVER BOARD  
( IB FASTENER & 3" INSULATION PLATES, 6 PER 4' X 8' BOARD )

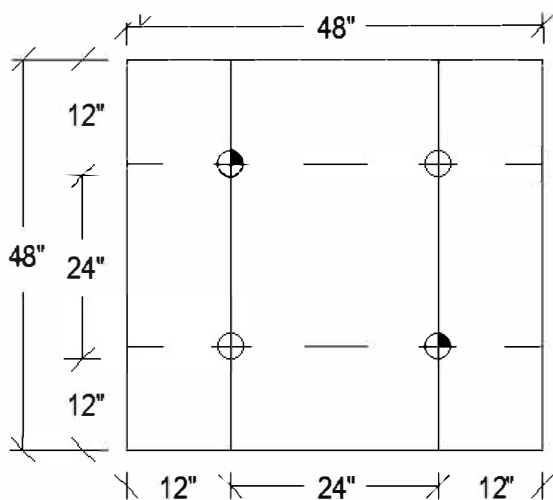

APPROVED RIGID INSULATION EPS, XPS, POLYISOCYANURATE INSULATION & COVER BOARD  
( IB FASTENER & 3" INSULATION PLATES, 4 PER 4' X 8' BOARD )

**NOTES:**

1. FASTENING PATTERNS ARE PROVIDED AS GENERAL GUIDELINES FOR FASTENER PLACEMENT FOR MECHANICALLY ATTACHED INSULATION AND COVER BOARD.
2. REQUIRES MINIMUM 1.5 LB/FT<sup>3</sup> DENSITY AND MINIMUM .25" LAYER OF GYPSUM OR HD POLYISOCYANURATE COVER BOARD OR MINIMUM 1.0" LAYER OF IB POLYISOCYANURATE BOARD OR THE USE OF AN IB SEPARATION SHEET ABOVE EPS/XPS INSULATION.

<b>Scale:</b> NTS	<b>Detail Name:</b> <i><b>Fastening Patterns for Insulation - Cover Board</b></i>	<b>Detail Number:</b> <b>MA-AT-02</b>
<b>Submitted By:</b> Address: Telephone:		<b>Project:</b> Address:

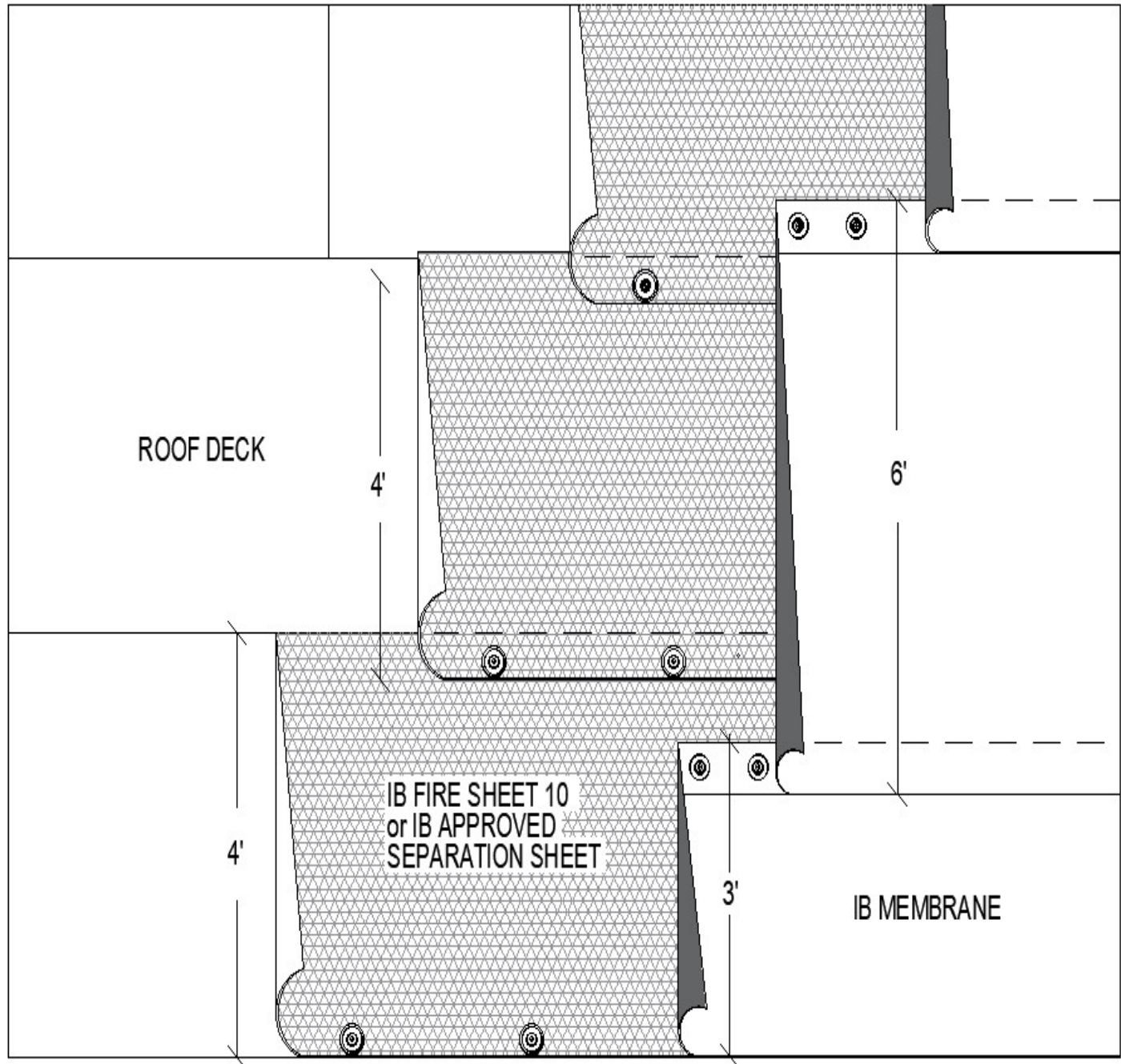

**NOTES:**

1. FIRE SHEETS / SEPARATION SHEETS ARE TO BE PRELIMINARILY ATTACHED TO THE ROOF DECK WITH IB FASTENERS AND 3" INSULATION PLATES.

<b>Scale:</b> NTS	<b>Detail Name:</b> <b>Single Layer Fire Sheet Layout</b>	<b>Detail Number:</b> <b>MA-AT-03</b>
<b>Submitted By:</b> Address: Telephone:		<b>Project:</b> Address:



**NOTES:**

1. FIRE SHEETS ARE TO BE PRELIMINARILY ATTACHED TO THE ROOF DECK WITH IB FASTENERS & 3" INSULATION PLATES.

<b>Scale:</b> NTS	<b>Detail Name:</b>  <b>Double Layer Fire Sheet Layout</b>	<b>Detail Number:</b> <b>MA-AT-04</b>
<b>Submitted By:</b> <b>Address:</b> <b>Telephone:</b>	<b>Project:</b> <b>Address:</b>	





**NOTES:**

1. FIRE SHEETS ARE TO BE PRELIMINARILY ATTACHED TO THE ROOF DECK WITH IB FASTENERS & 3" INSULATION PLATES.

Scale:  
NTS

Detail Name:

*Three Layer Fire Sheet Layout*

Detail Number:  
**MA-AT-05**

Submitted By:  
Address:  
Telephone:

Project:  
Address:

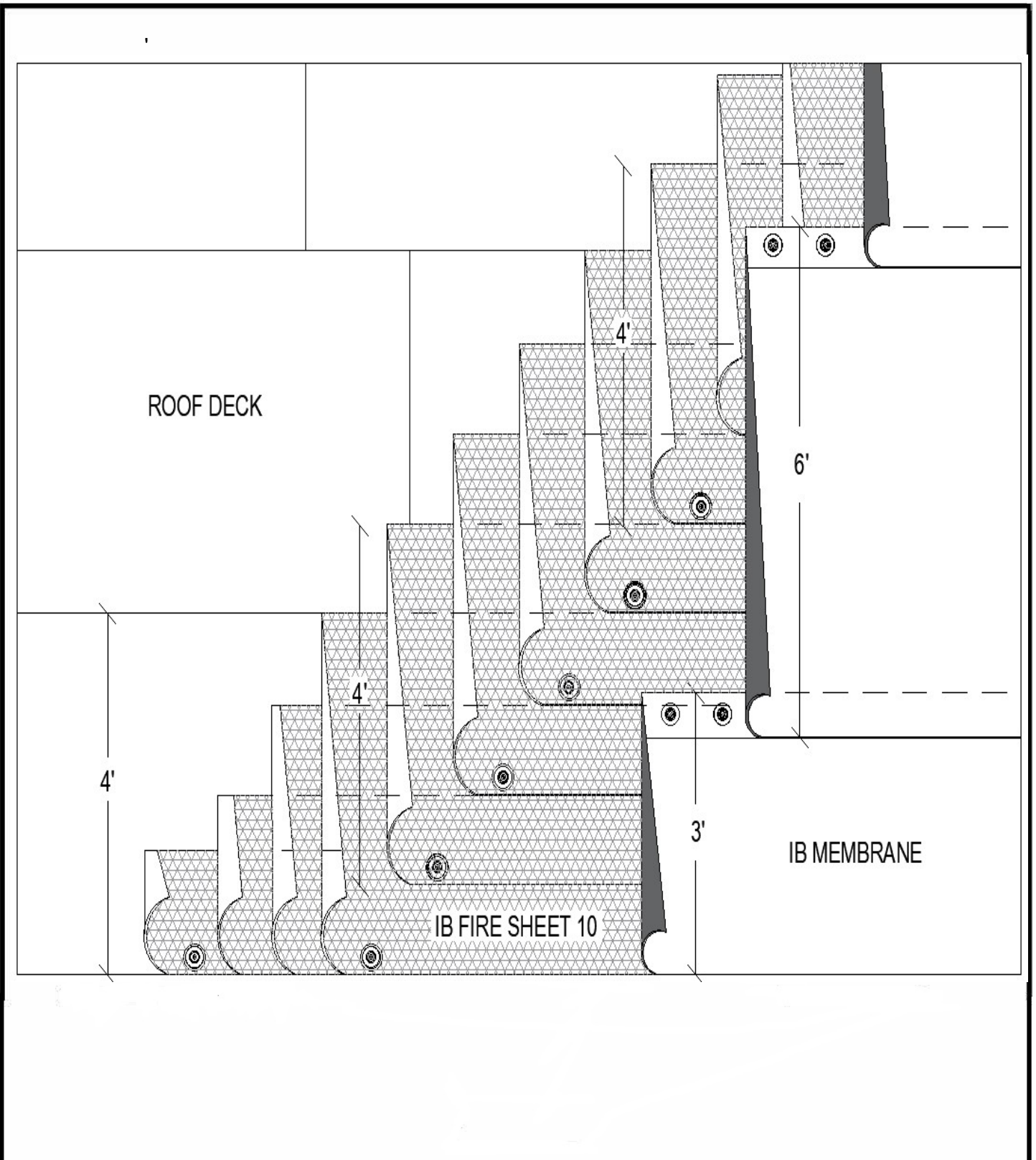

Scale: NTS	Detail Name: <b>Four Layer Fire Sheet Layout</b>	Detail Number: <b>MA-AT-06</b>
Submitted By: Address: Telephone:		Project: Address:

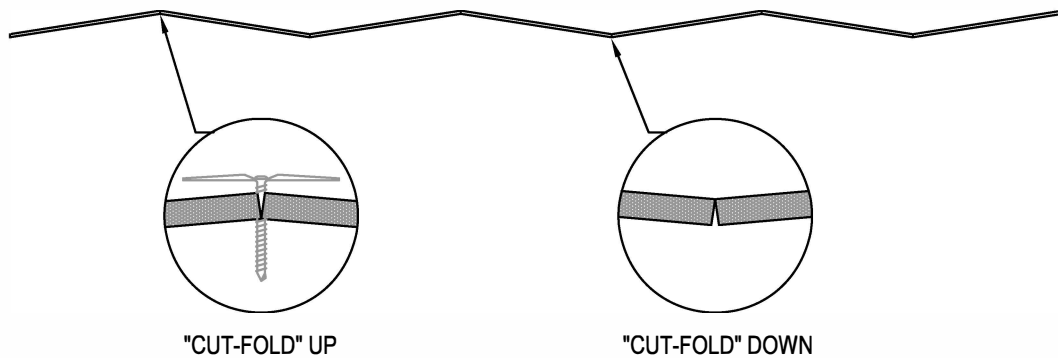
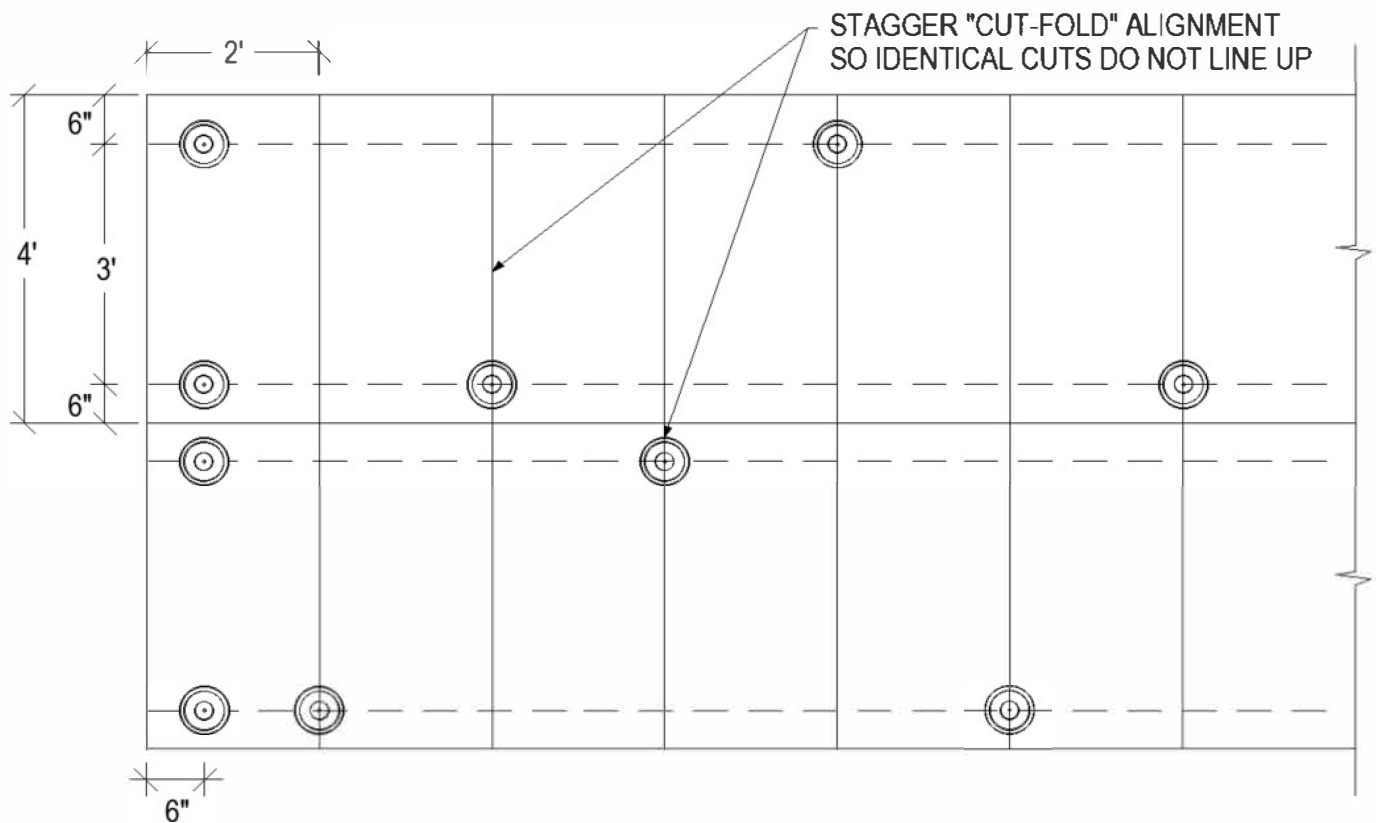

**APPROVED EPS FAN-FOLD INSULATION**  
(IB FASTENERS & 3" INSULATION PLATES: 1 PER 12 SQ FT)

**NOTES:**

1. AN IB SEPARATION SHEET IS REQUIRED FOR EPS FAN-FOLD INSULATIONS NOT APPROVED OR SUPPLIED BY IB ROOF SYSTEMS.

<b>Scale:</b> NTS	<b>Detail Name:</b> <b><i>Fastening Pattern for EPS Fan-Fold</i></b>	<b>Detail Number:</b> <b><i>MA-AT-07</i></b>
<b>Submitted By:</b> Address: Telephone:		<b>Project:</b> Address:

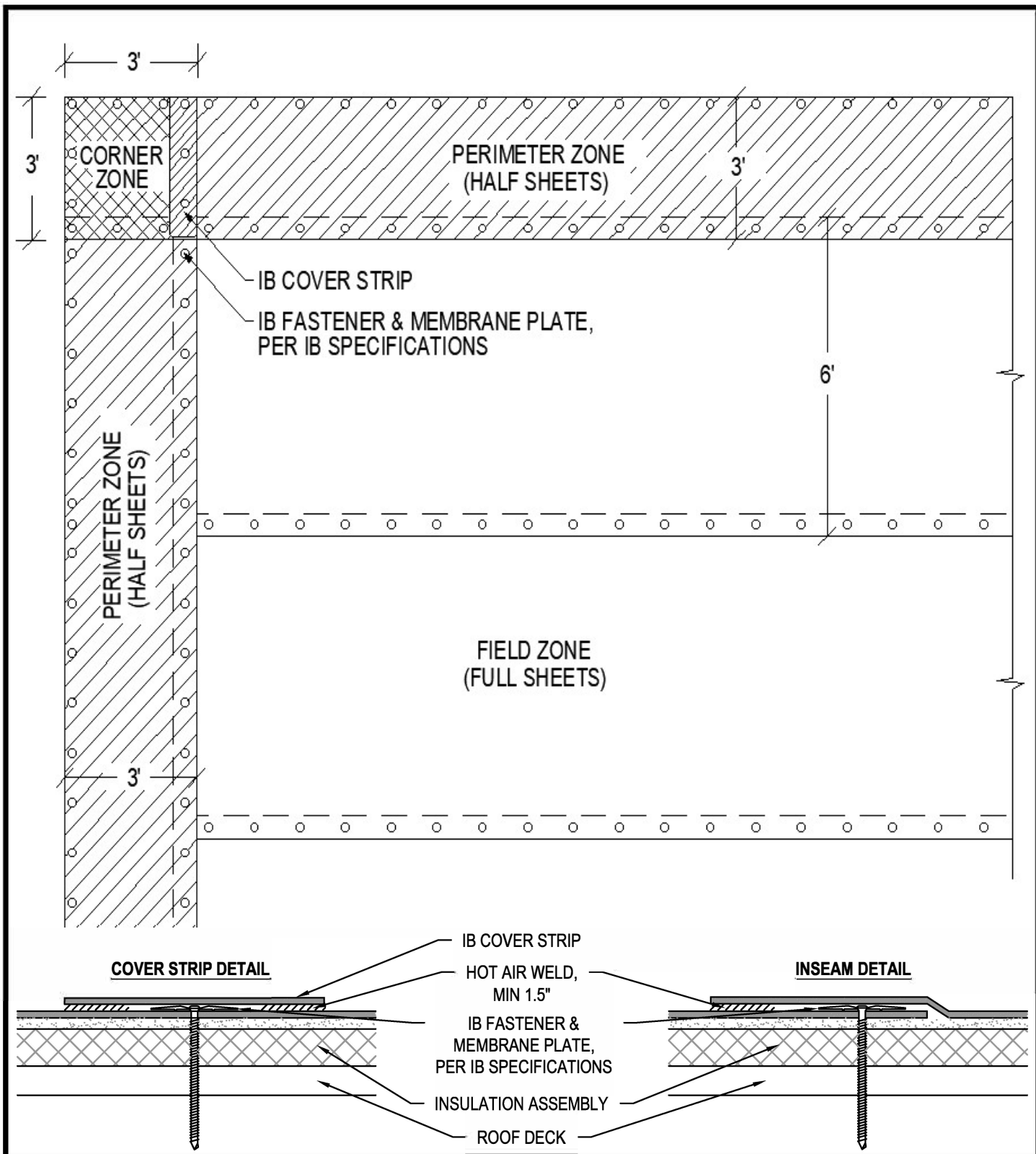

Scale: NTS	Detail Name: <b>One Perimeter Half Sheet Layout</b>	Detail Number: <b>MA-AT-08</b>
Submitted By: Address: Telephone:		Project: Address:



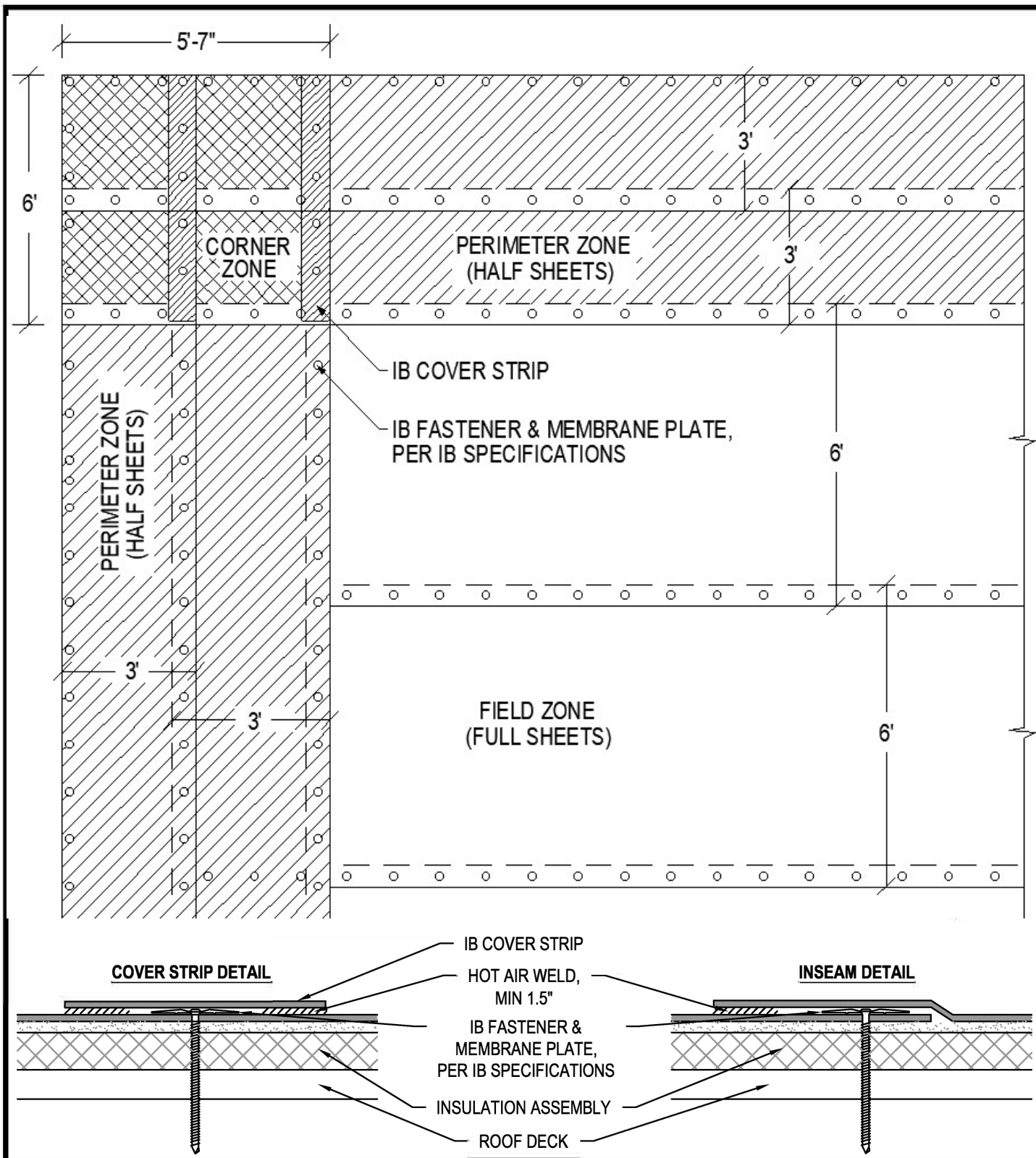

Scale:  
NTS

Detail Name:

**Two Perimeter Half Sheet Layout**

Detail Number:  
**MA-AT-09**

Submitted By:  
Address:  
Telephone:

Project:  
Address:

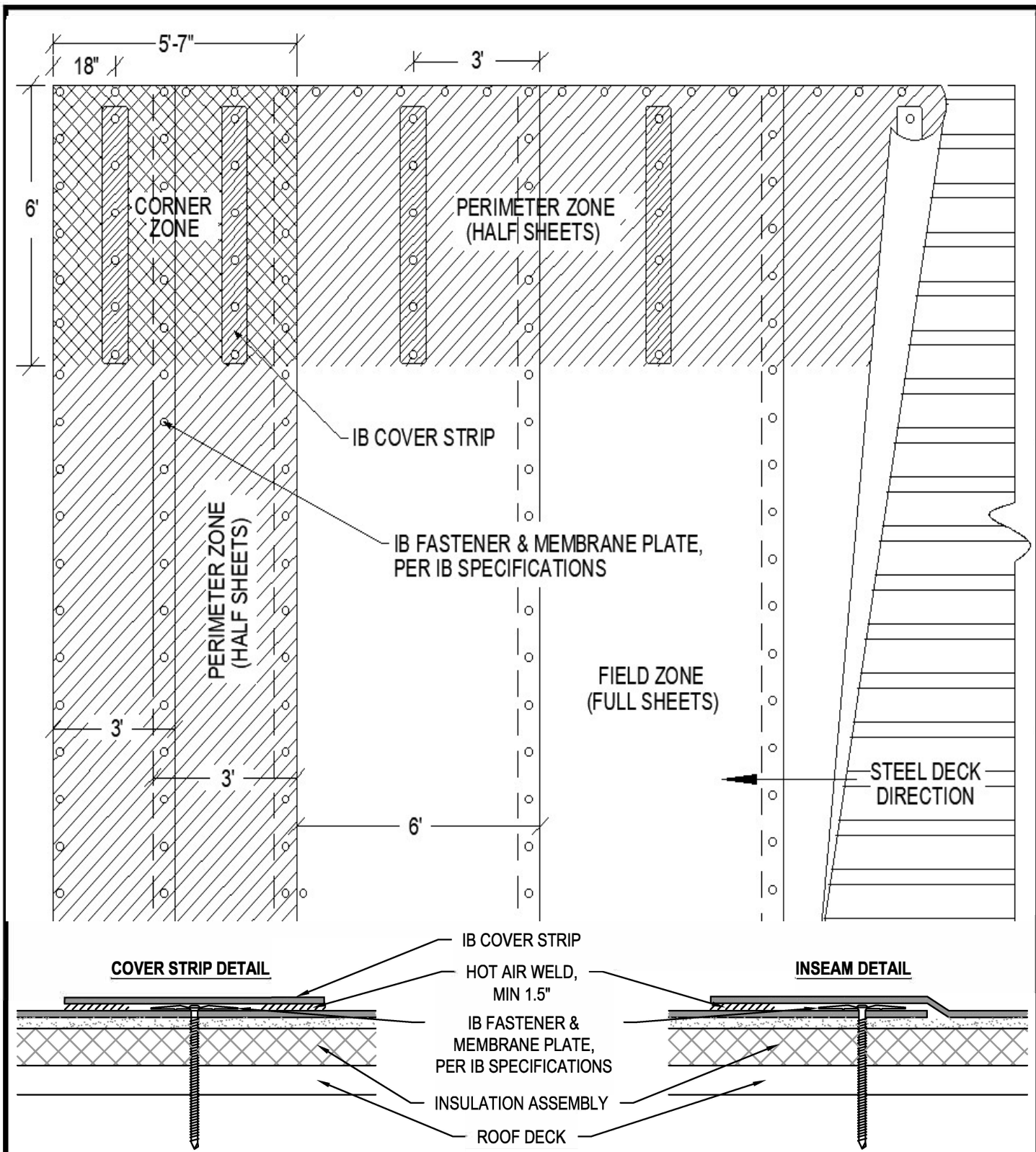

Scale: NTS	Detail Name: <b>FM Sheet Layout - Steel Deck</b>	Detail Number: <b>MA-AT-10</b>
Submitted By: Address: Telephone:		Project: Address:



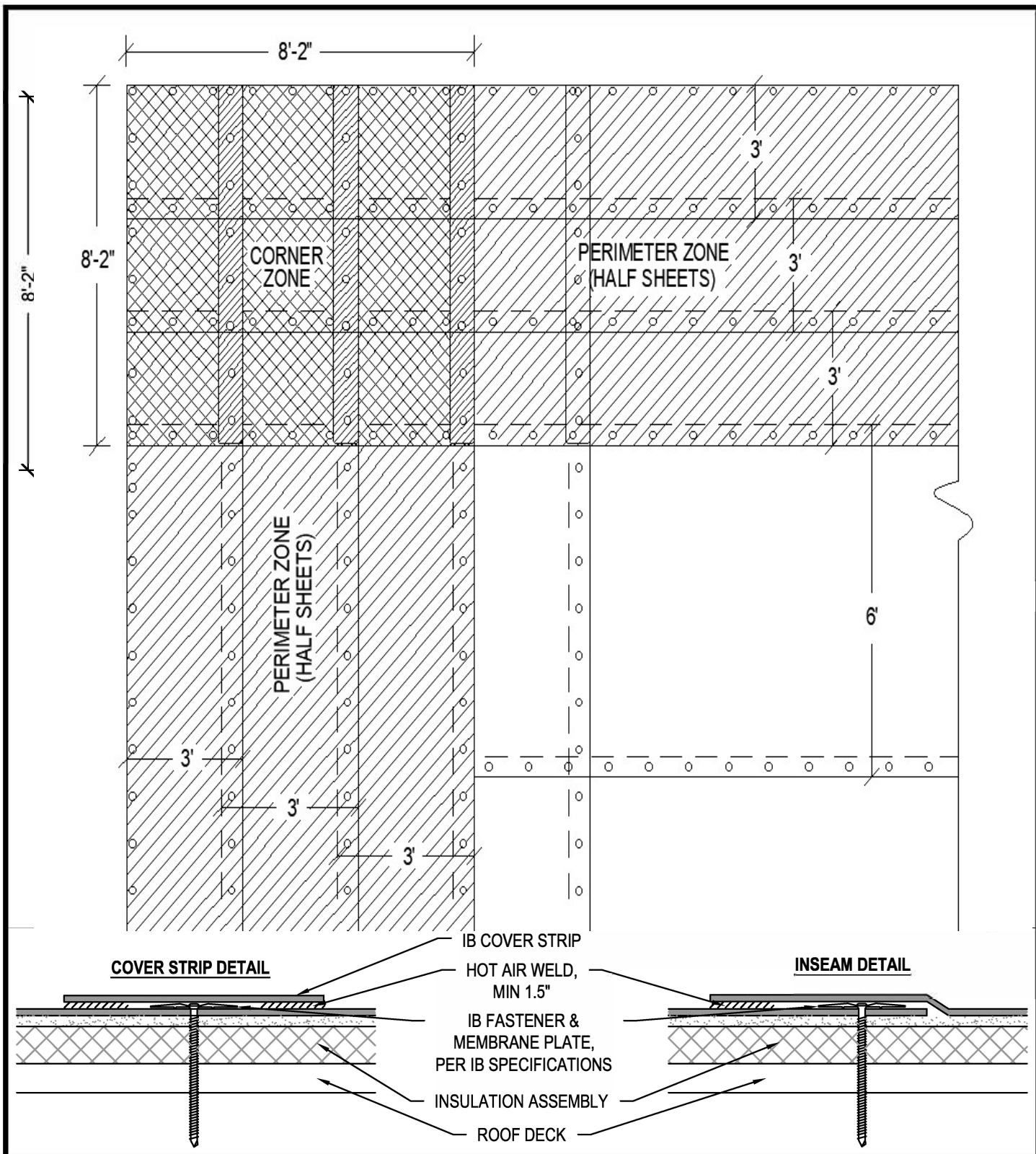

Scale:  
NTS

Detail Name:

**Three Perimeter Half Sheet Layout**

Detail Number:

**MA-AT-11**

Submitted By:

Address:  
Telephone:

Project:

Address:

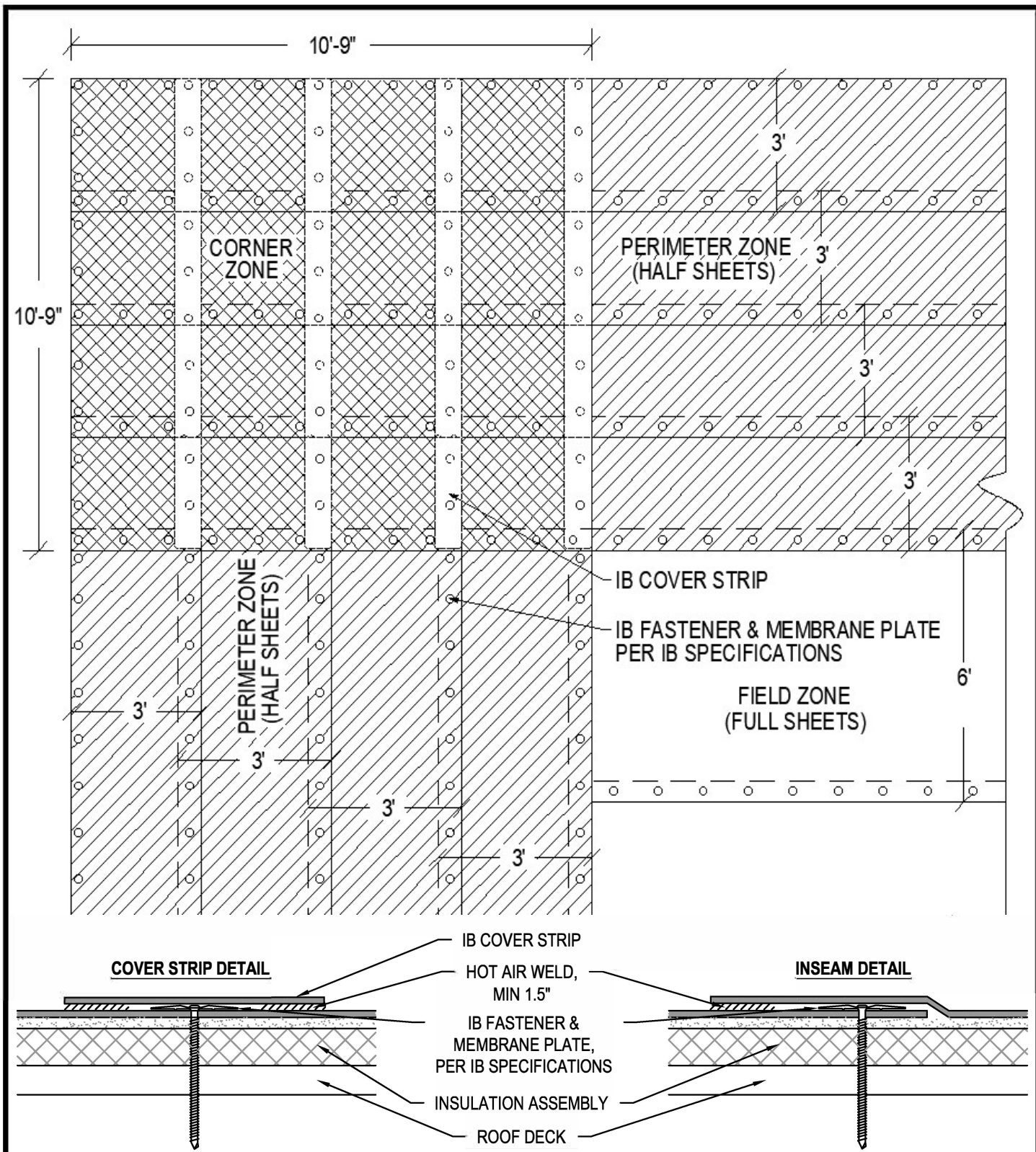

Scale: NTS	Detail Name: <b>Four Perimeter Half Sheet Layout</b>	Detail Number: <b>MA-AT-12</b>
Submitted By: Address: Telephone:		Project: Address:



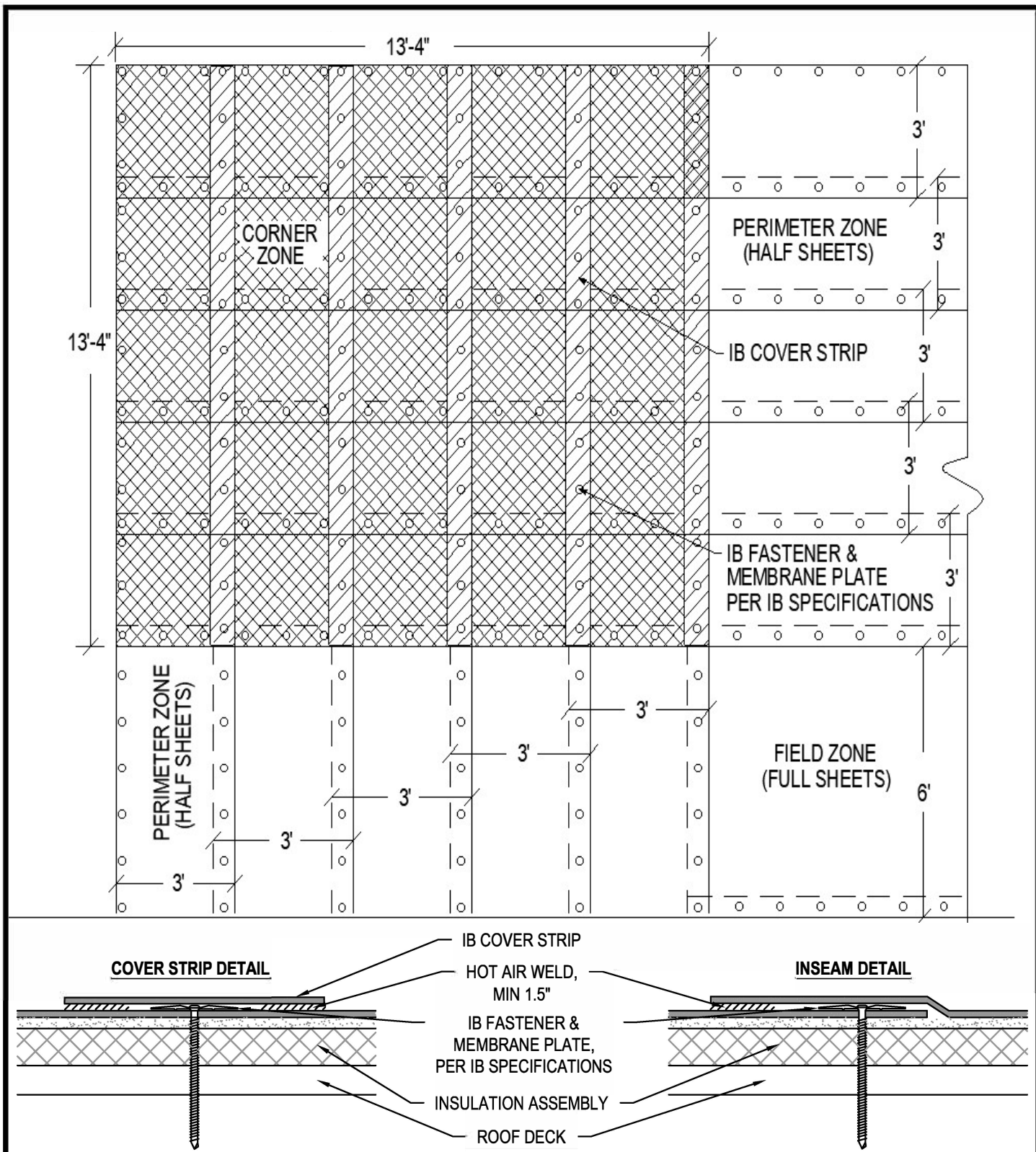

Scale: NTS	Detail Name: <b>Five Perimeter Half Sheet Layout</b>	Detail Number: <b>MA-AT-13</b>
Submitted By: Address: Telephone:	Project: Address:	

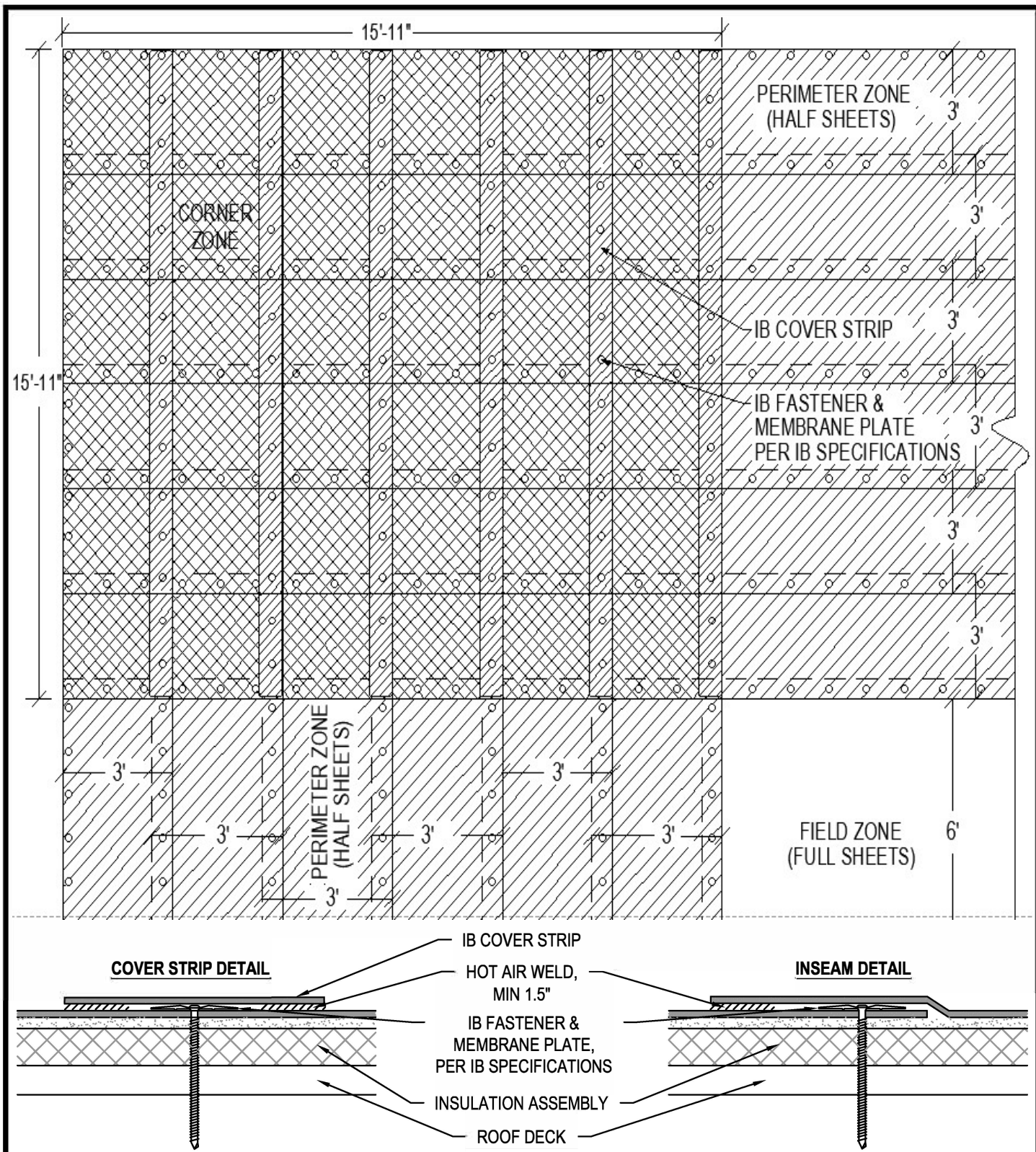

Scale: NTS	Detail Name: <b>Six Perimeter Half Sheet Layout</b>	Detail Number: <b>MA-AT-14</b>
Submitted By: Address: Telephone:	Project: Address:	



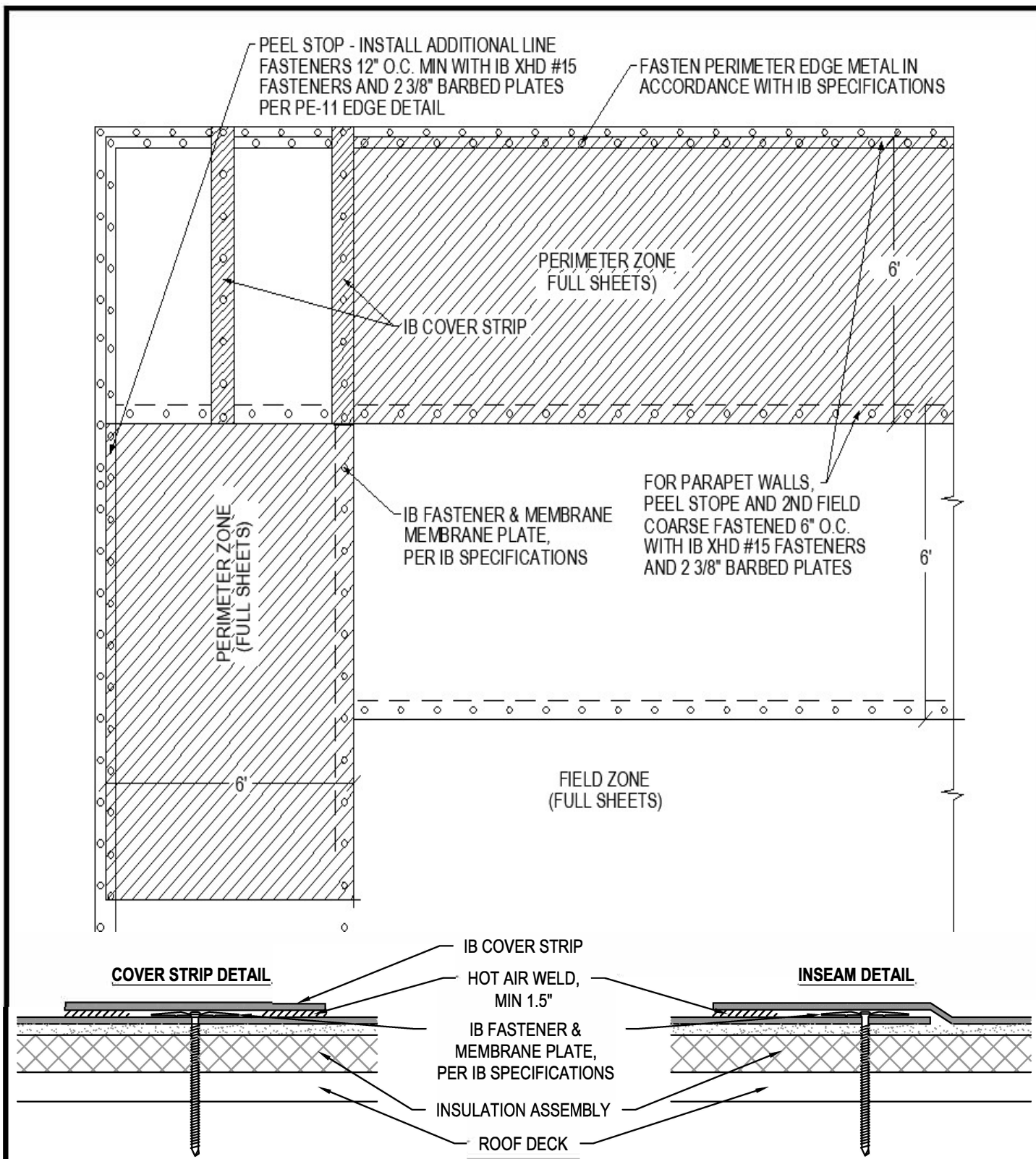

Scale: NTS	Detail Name: <b>Alternate Perimeter Sheet Layout</b>	Detail Number: <b>MA-AT-15</b>
Submitted By: Address: Telephone:		Project: Address:

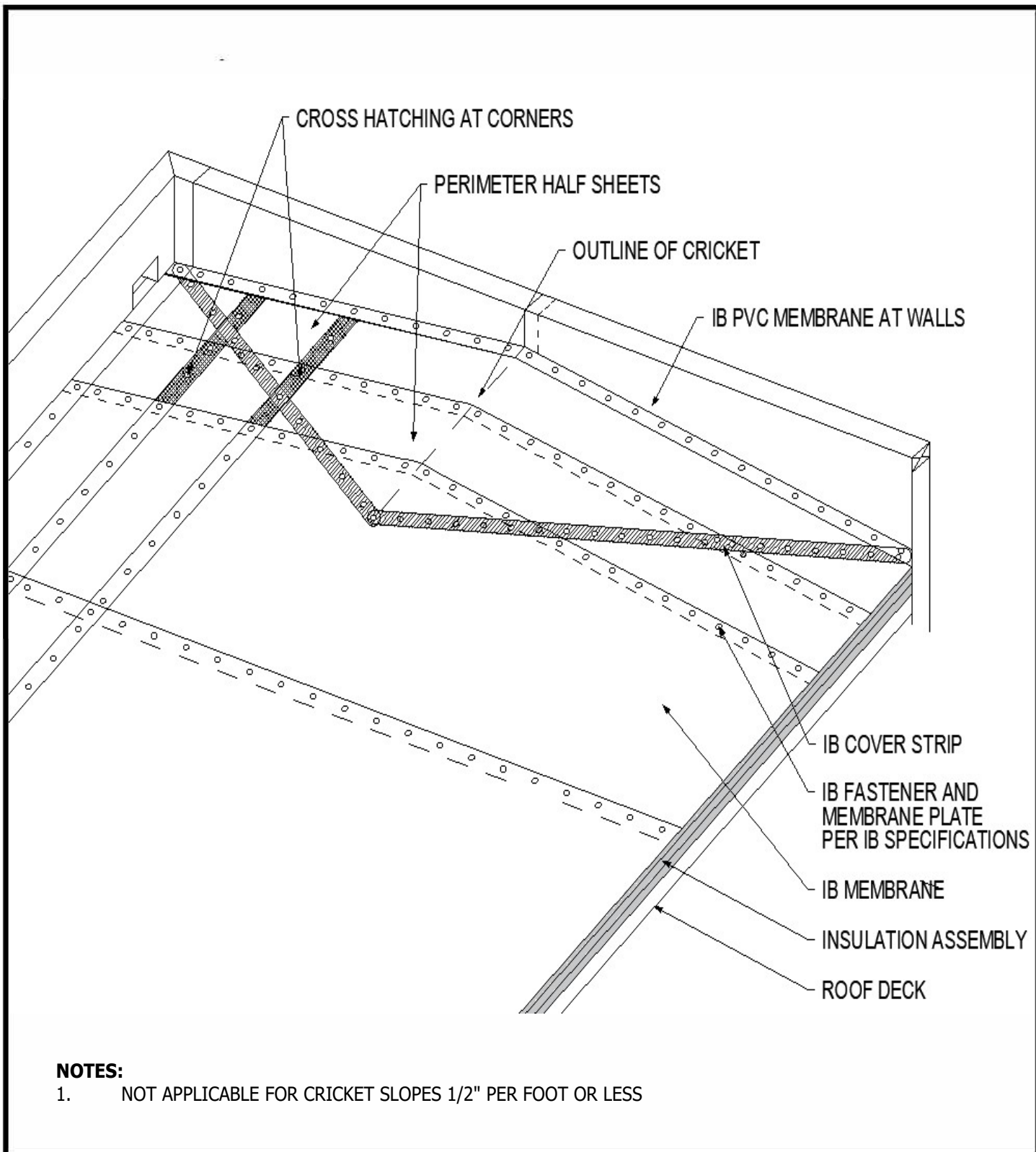

Scale: NTS	Detail Name: <b>Membrane Cricket Layout</b>	Detail Number: <b>MA-AT-16</b>
Submitted By: Address: Telephone:		Project: Address:



**IB MEMBRANE END LAPS**

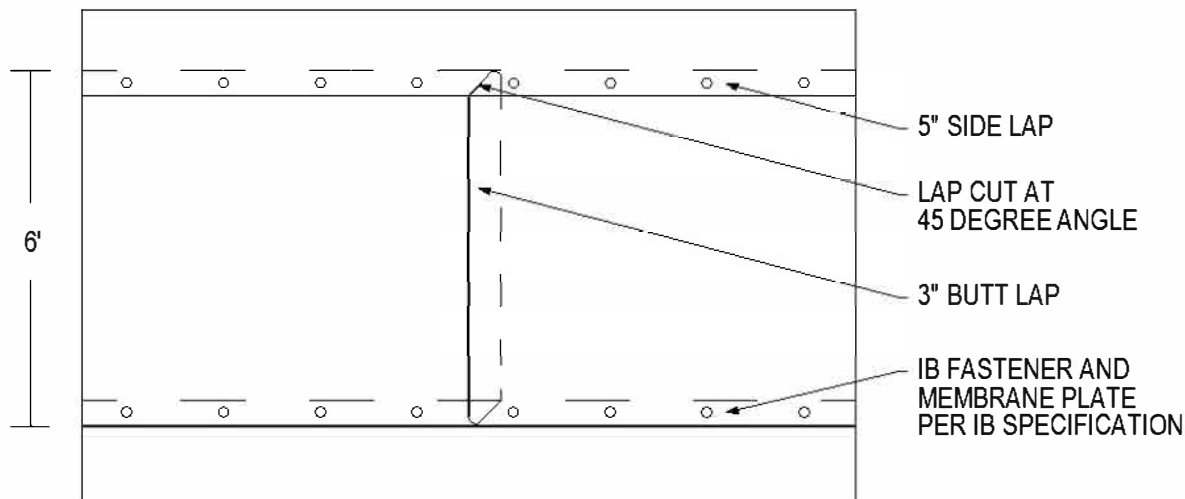

**IB FLEECKBACK MEMBRANE END LAPS**

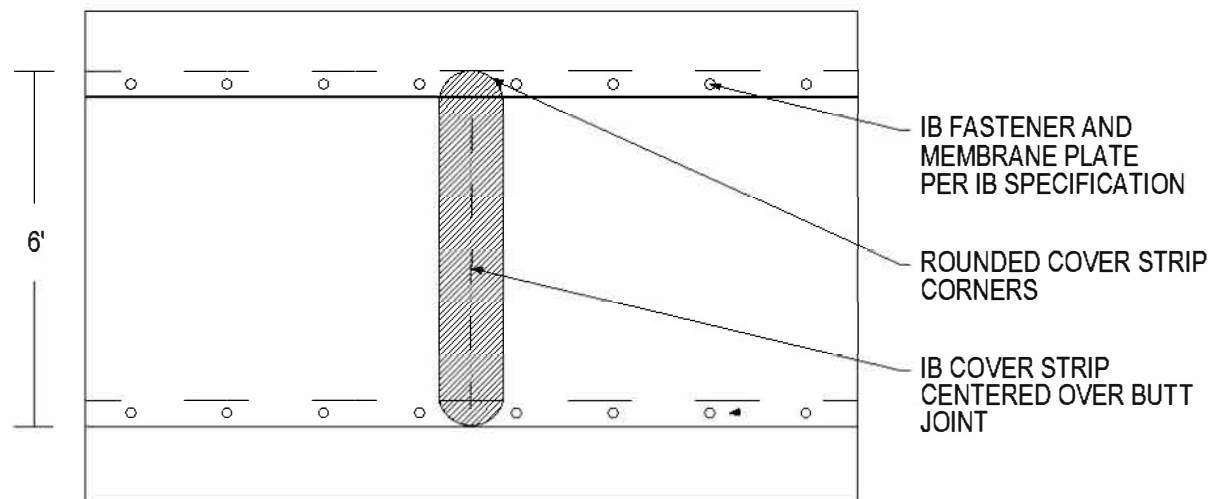

**NOTE:**

1. REFER TO IB ROUND T-JOINT PATCH DETAIL FOR IB 80 MIL PVC SINGLE-PLY MEMBRANE

**Scale:**  
NTS

**Detail Name:**

**Membrane End Laps for Mechanically Attached Membrane**

**Detail Number:**

**MA-AT-17**

**Submitted By:**  
**Address:**  
**Telephone:**

**Project:**  
**Address:**