

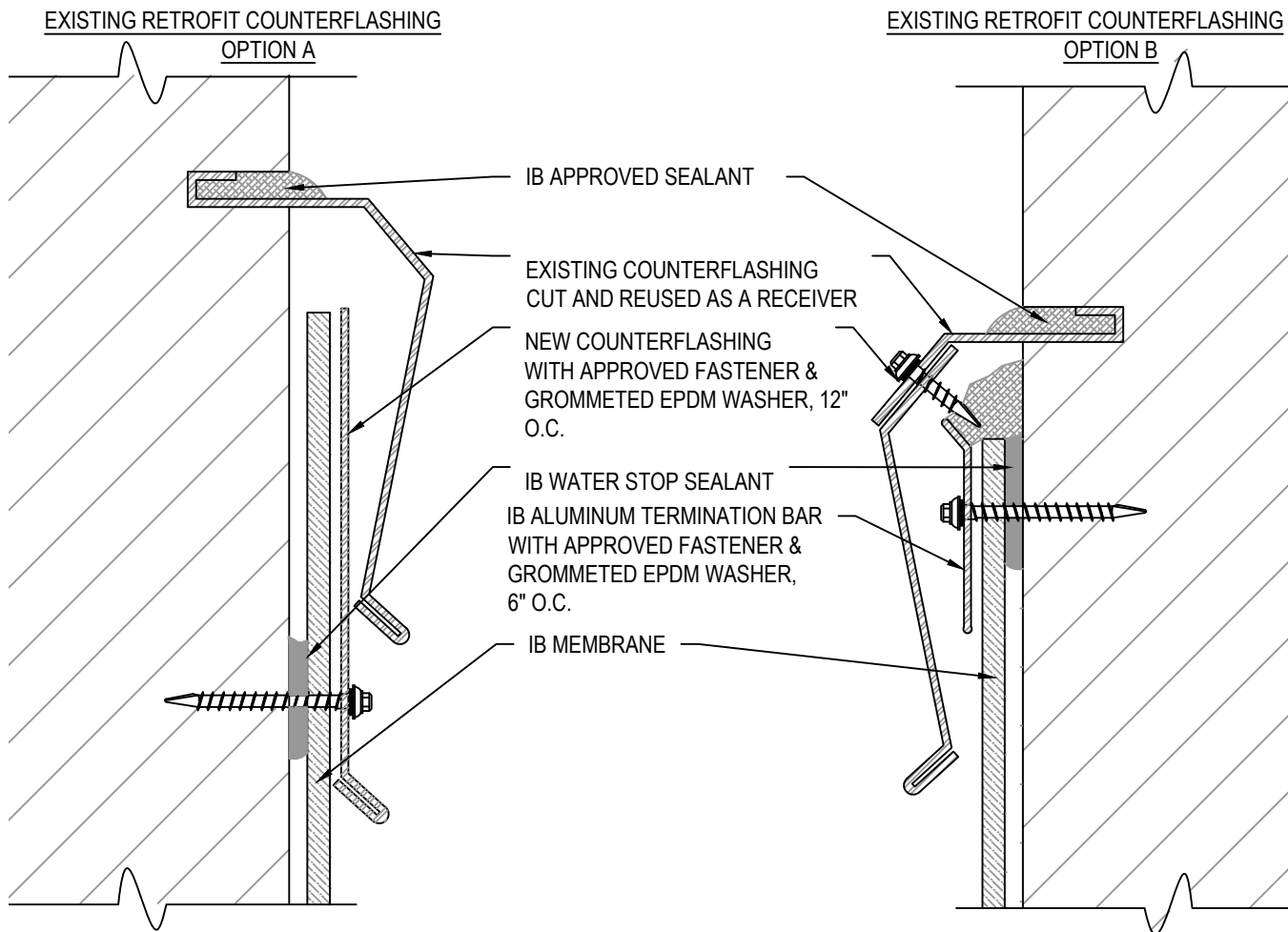

Walls & Base Flashing Terminations



NOTES:

1. STANDARD BASE FLASHINGS 8" ABOVE THE ROOF.
2. ADHERED WALLS: INSTALL MEMBRANE IN IB VERTIBOND ADHESIVE ADDING NOMINAL RATE OF 1 GAL. PER 60 SQ. FT. NET INSTALLED COVERAGE (50% TO SUBSTRATE ALLOW TO DRY WITH REMAINING 50% TO BACK OF SHEET, INSTALL WHILE TACKY)
3. SECURE FLASHINGS AND METAL WORK IN ACCORDANCE WITH IB SPECIFICATIONS AND FLASHING SECUREMENT TABLE.
4. SEALANTS AND CAULKING REQUIRE PERIODIC OWNER MAINTENANCE

APPROVED SUBSTRATE / SEPARATION:

MECHANICALLY ATTACHED RECOVER OVER APPROVED EXISTING WALL AND BASE FLASHINGS

- FULL SEPARATION REQUIRED WITH MINIMUM 1/2" PLYWOOD, 1/4" APPROVED GYPSUM COVER BOARD, 7/16" OSB, OR APPROVED IB SEPARATION SHEET

INDUCTION WELDED RECOVER OVER APPROVED EXISTING WALL AND BASE FLASHINGS

- FULL SEPARATION REQUIRED WITH MINIMUM 1/4" APPROVED GYPSUM COVER BORD

FULLY ADHERED RECOVER OVER APPROVED EXISTING WALL AND BASE FLASHINGS

- FULL SEPARATION REQUIRED WITH MINIMUM 1/2" PLYWOOD, 1/4" APPROVED GYPSUM COVER BOARD, OR 7/16" OSB

Scale:

NTS

Detail Name:

Retrofit Reglet Mount Counterflashing

Detail Number:

FT - 03

Submitted By:

Address:
Telephone:

Project:

Address: