

Scale: NTS	Detail Name: <b>Insulation Layout - Single Layer 4' x 4'</b>	Detail Number: <b>FD - 01</b>
Submitted By: Address: Telephone:		Project: Address:

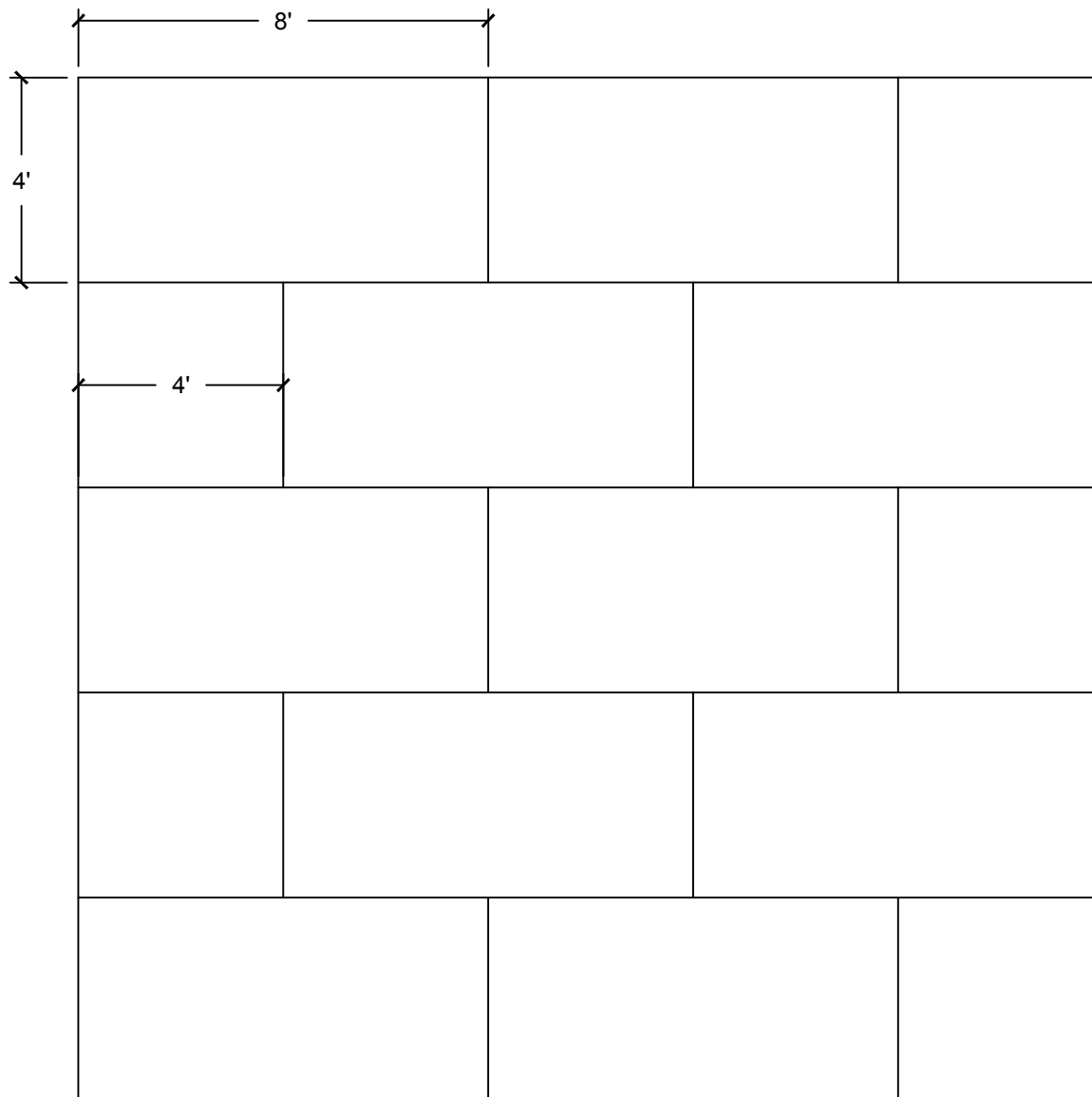

Scale: NTS	Detail Name: <b>Insulation Layout - Single Layer 4' x 8'</b>	Detail Number: <b>FD - 02</b>
Submitted By: Address: Telephone:		Project: Address:

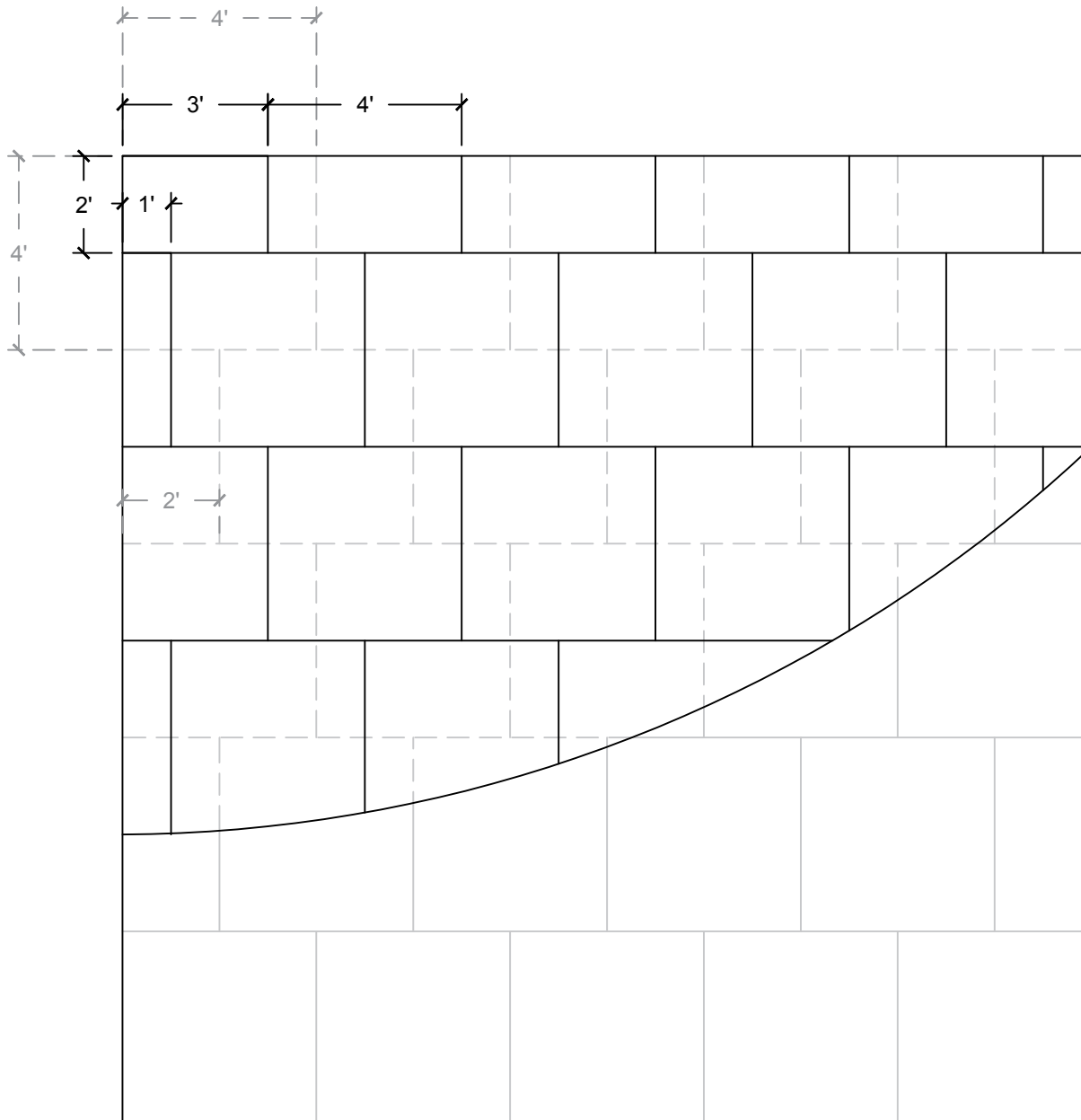

Scale: NTS	Detail Name: <b><i>Insulation Layout - Double Layer 4' x 4'</i></b>	Detail Number: <b><i>FD - 03</i></b>
Submitted By: Address: Telephone:		Project: Address:

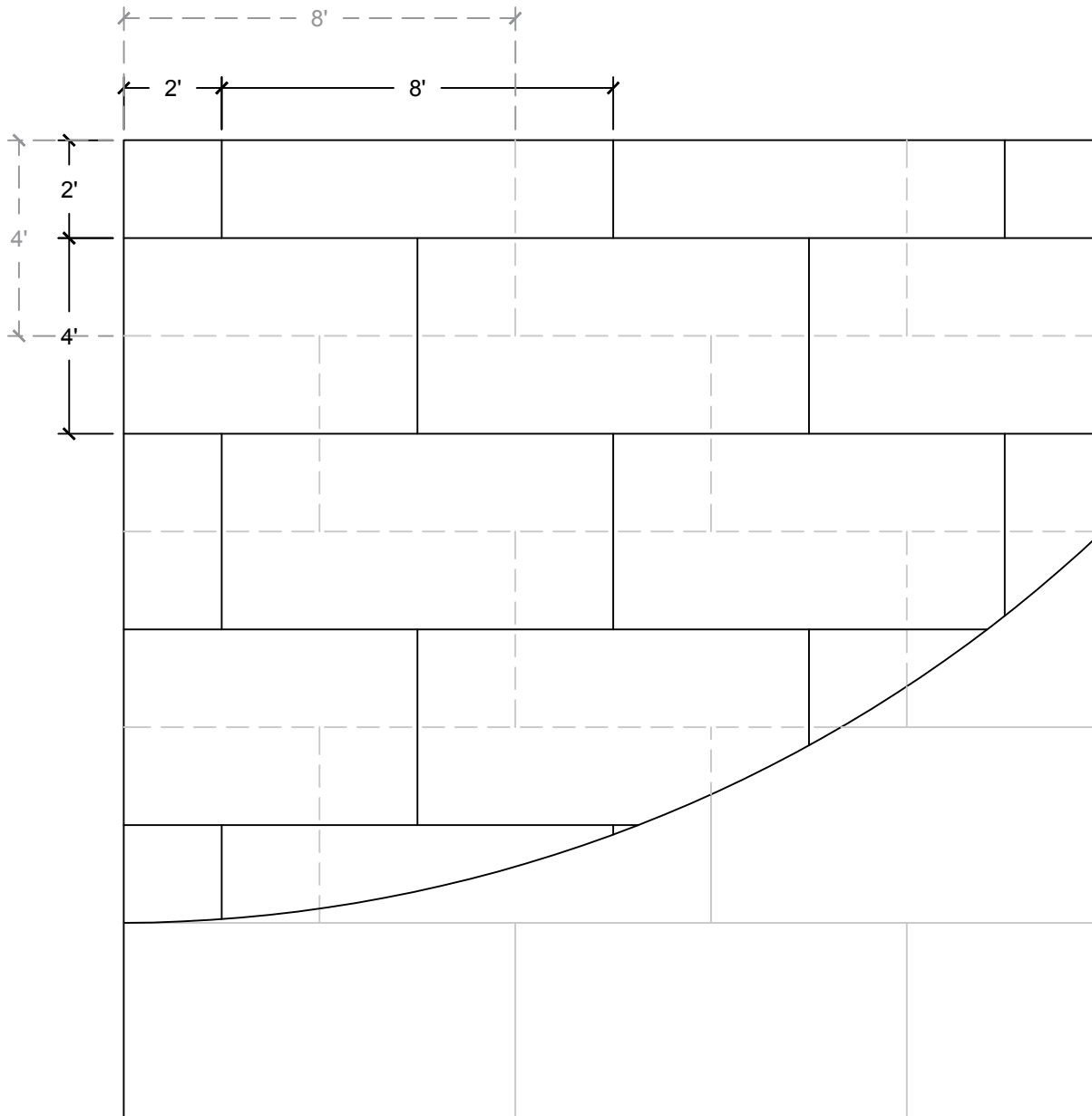

Scale: NTS	Detail Name: <b>Insulation Layout - Double Layer 4' x 8'</b>	Detail Number: <b>FD - 04</b>
Submitted By: Address: Telephone:		Project: Address:

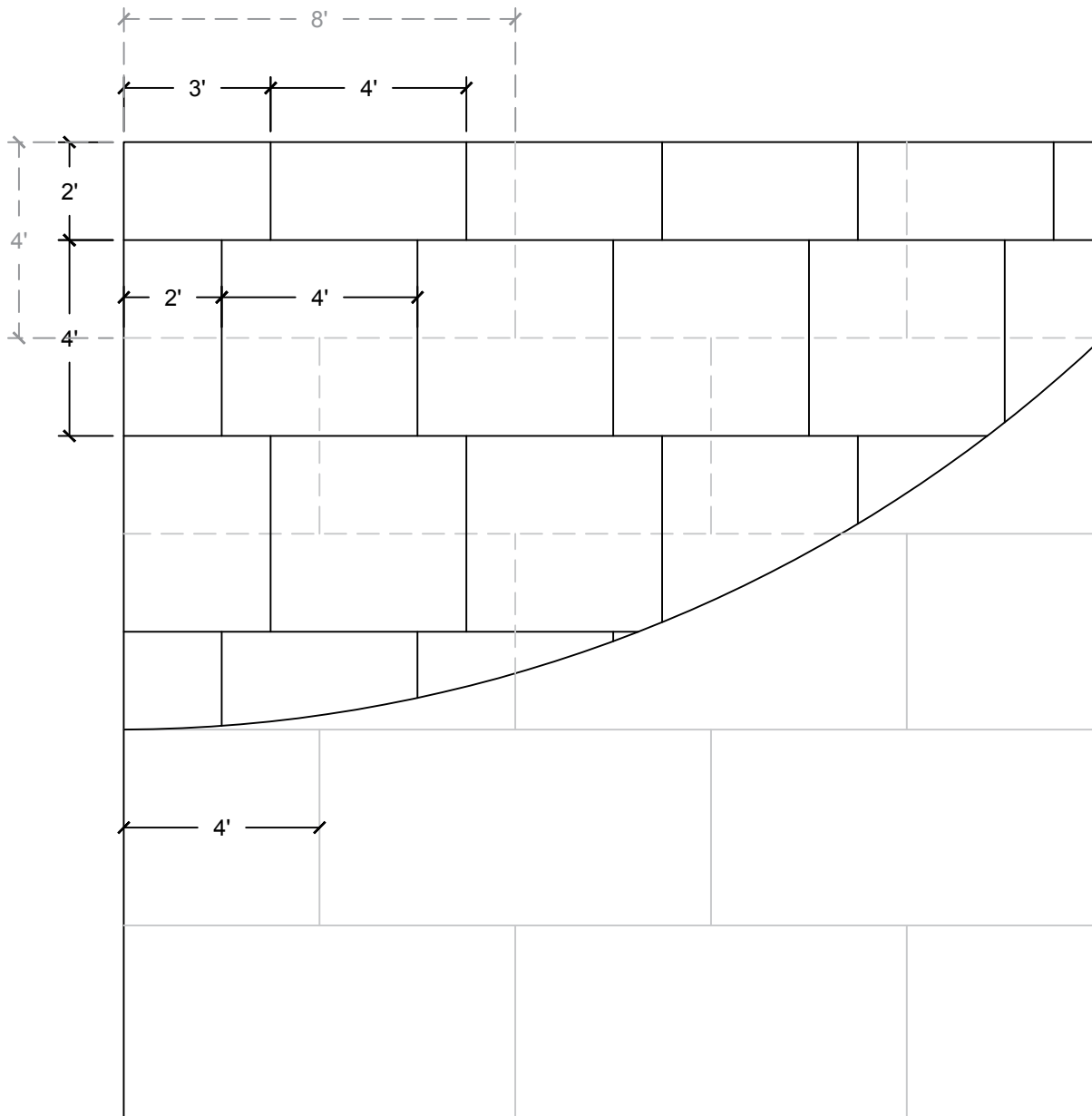

Scale: NTS	Detail Name: <b>Insulation Layout - Double Layer 4' x 4' over 4' x 8'</b>	Detail Number: <b>FD - 05</b>
Submitted By: Address: Telephone:		Project: Address:

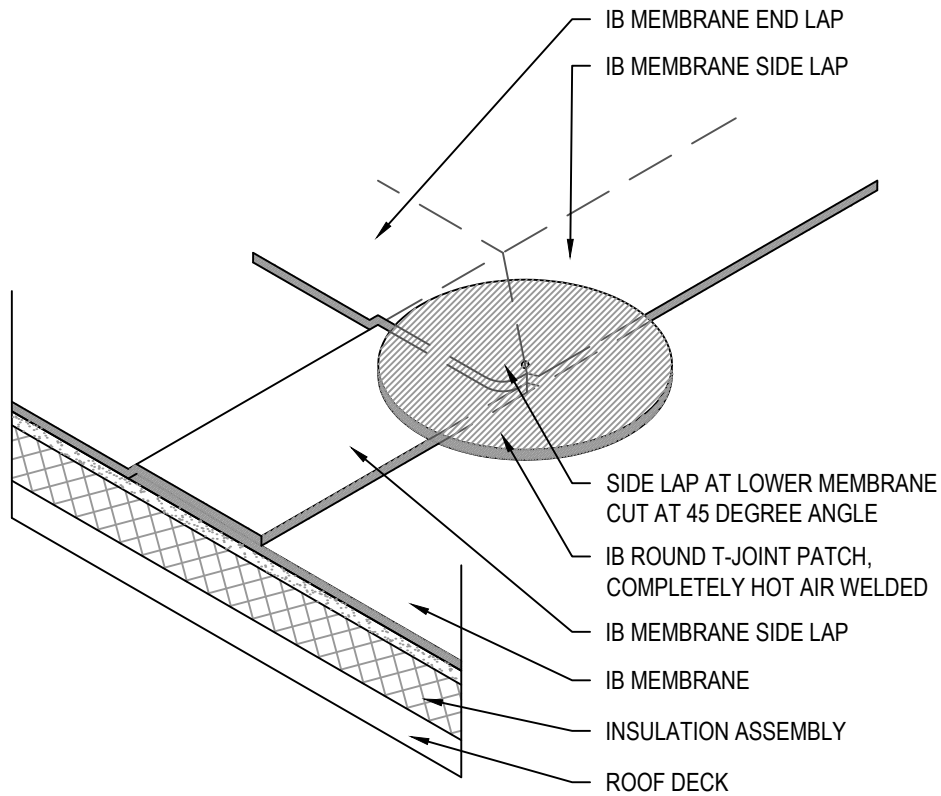

**NOTES:**

1. IB ROUND T- JOINT PATCHES ARE FOR USE WITH THE IB 80 MIL MEMBRANE ONLY.
2. REFER TO FULLY ADHERED END LAPS DETAIL FOR VARIATIONS BETWEEN IB PVC SINGLE-PLY AND FLEECEBACK MEMBRANES.

Scale: NTS	Detail Name: <b>IB Round T-Joint Patch</b>	Detail Number: <b>FD - 06</b>
Submitted By: Address: Telephone:		Project: Address:



**\*2":12" (16%) SLOPE**

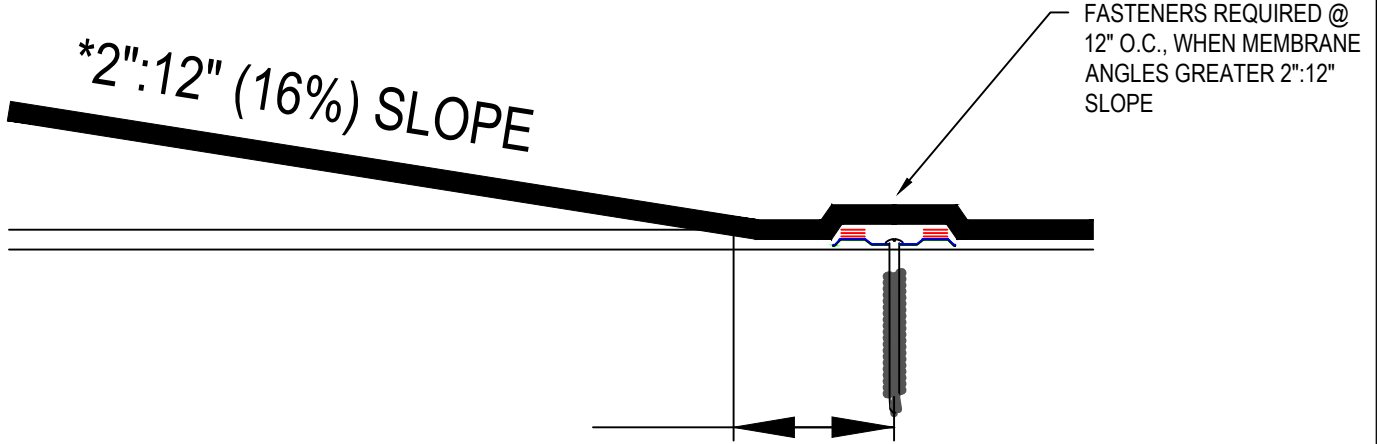

**ANGLE CHANGE FOR INDUCTION WELD**

**\*2":12" (16%) SLOPE**

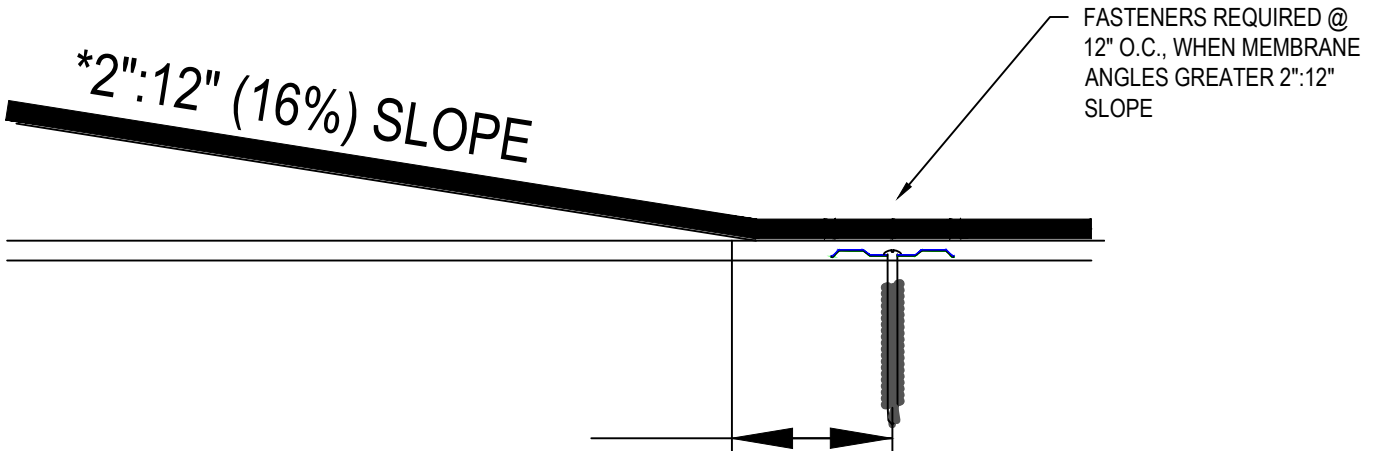

**ANGLE CHANGE FOR ADHERED AND MECHANICALLY ATTACHED**

Scale: NTS	Detail Name: <b>Angle Change Securement</b>	Detail Number: <b>FD - 07</b>
Submitted By: Address: Telephone:		Project: Address:

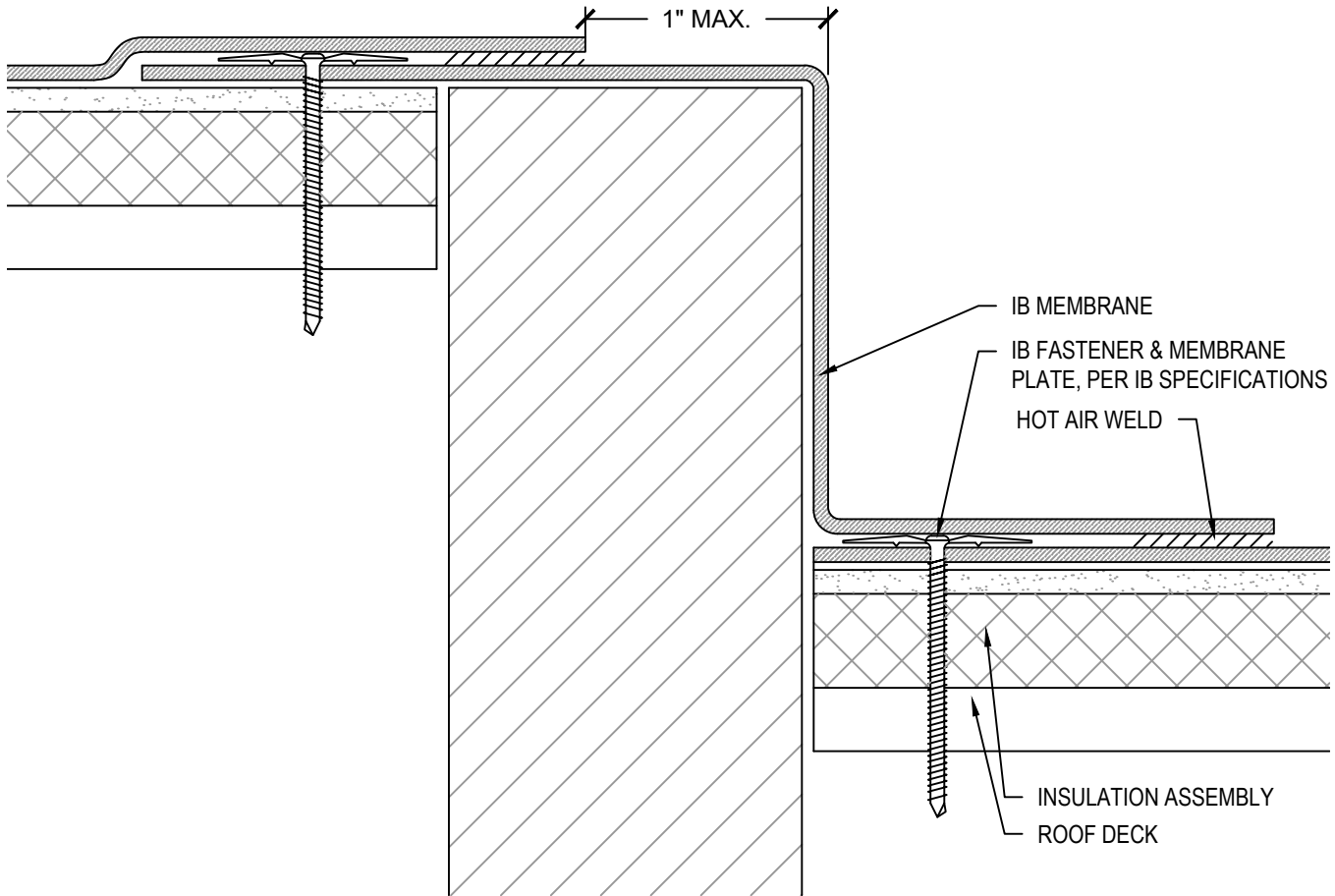

#### NOTES:

1. SINGLE COURSE WALL FLASHING MAXIMUM HEIGHTS:
  - A. 18" FOR MECHANICALLY ATTACHED FLASHINGS OR 60" FOR FULLY ADHERED FLASHINGS
  - B. FOR WALLS EXCEEDING MAXIMUM HEIGHTS, REFER TO MECHANICALLY ATTACHED OR ADHERED TALL WALL DETAILS.
2. ADHERED WALLS: INSTALL MEMBRANE IN IB VERTIBOND ADHESIVE ADDING NOMINAL RATE OF 1 GAL. PER 60 SQ. FT. NET INSTALLED COVERAGE (50% TO SUBSTRATE ALLOW TO DRY WITH REMAINING 50% TO BACK OF SHEET, INSTALL WHILE TACKY)
3. SECURE FLASHINGS AND METAL WORK IN ACCORDANCE WITH IB SPECIFICATIONS AND FLASHING SECUREMENT TABLE.

#### APPROVED SUBSTRATE / SEPARATION:

NEW CONSTRUCTION - FULLY ADHERED AND MECHANICALLY ATTACHED

- 1/2" PLYWOOD, 7/16" OSB, 1/2" APPROVED GYPSUM COVER BOARD, POURED / PRECAST CONCRETE, OR CEMENT BLOCK / MASONRY WALLS

MECHANICALLY ATTACHED RECOVER OVER APPROVED EXISTING WALL AND BASE FLASHINGS

- FULL SEPARATION REQUIRED WITH MINIMUM 1/2" PLYWOOD, 1/4" APPROVED GYPSUM COVER BOARD, 7/16" OSB, OR APPROVED IB SEPARATION SHEET

FULLY ADHERED RECOVER OVER APPROVED EXISTING WALL AND BASE FLASHINGS

- FULL SEPARATION REQUIRED WITH MINIMUM 1/2" PLYWOOD, 1/4" APPROVED GYPSUM COVER BOARD, OR 7/16" OSB

Scale: NTS	Detail Name: <b>Field Elevation Change</b>	Detail Number: <b>FD - 08</b>
Submitted By: Address: Telephone:		Project: Address:



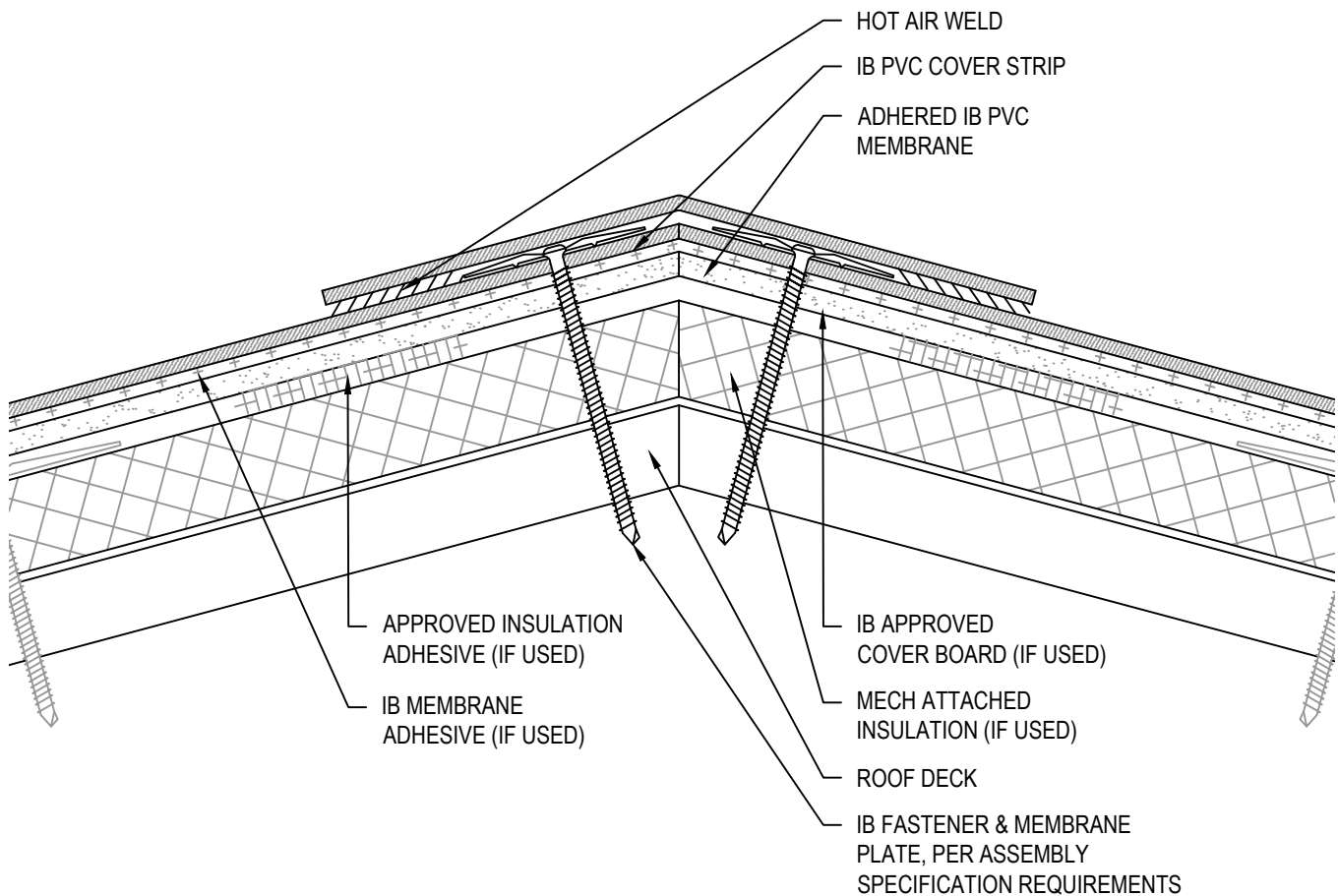

Scale:  
NTS

Detail Name:

***Ridge Detail with Cover Strip***

Detail Number:

***FD-09***

Submitted By:  
Address:  
Telephone:

Project:  
Address:

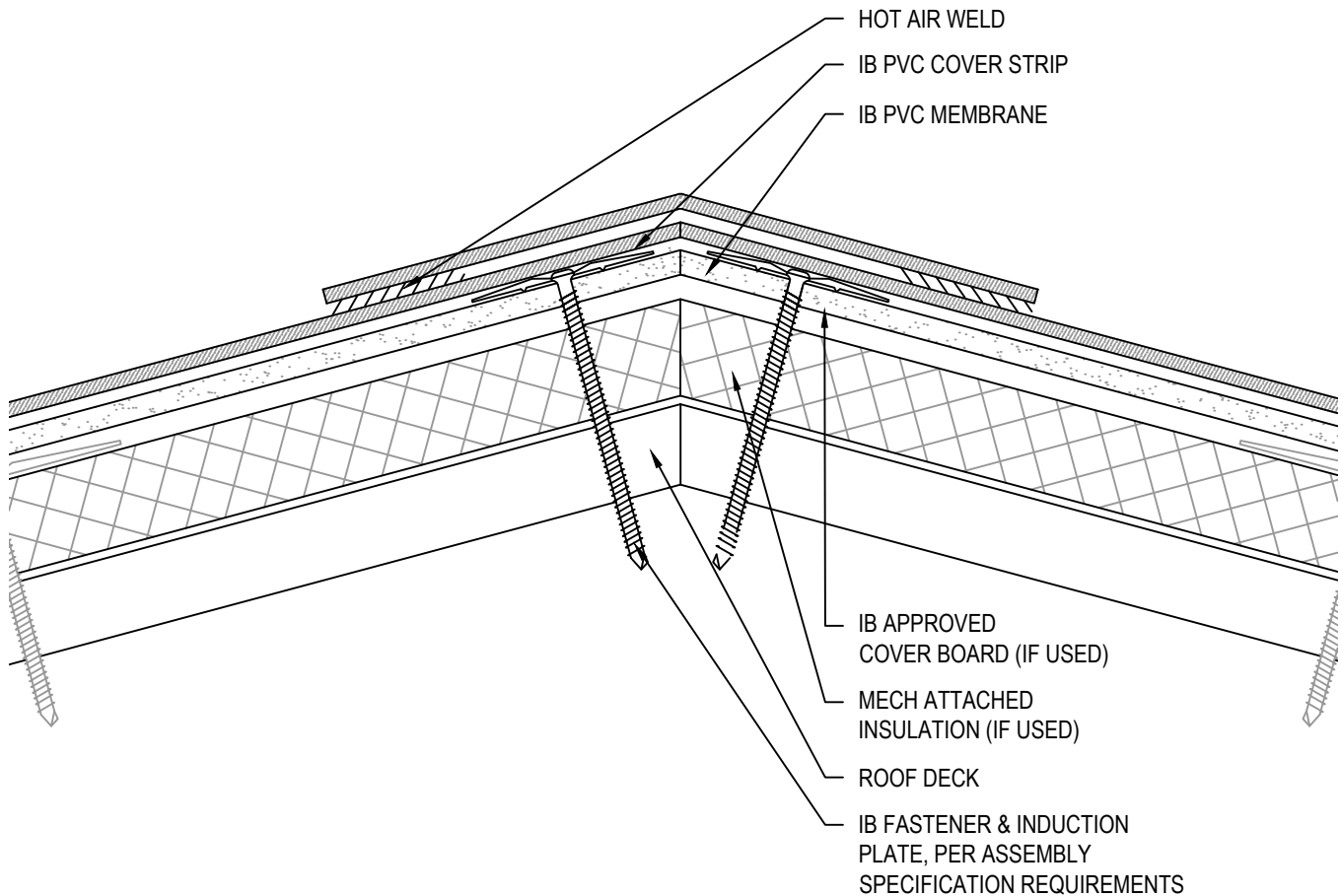

Scale: NTS	Detail Name: <b><i>Ridge Detail with Cover Strip - Induction Welded</i></b>	Detail Number: <b><i>FD-10</i></b>
Submitted By: Address: Telephone:		Project: Address:

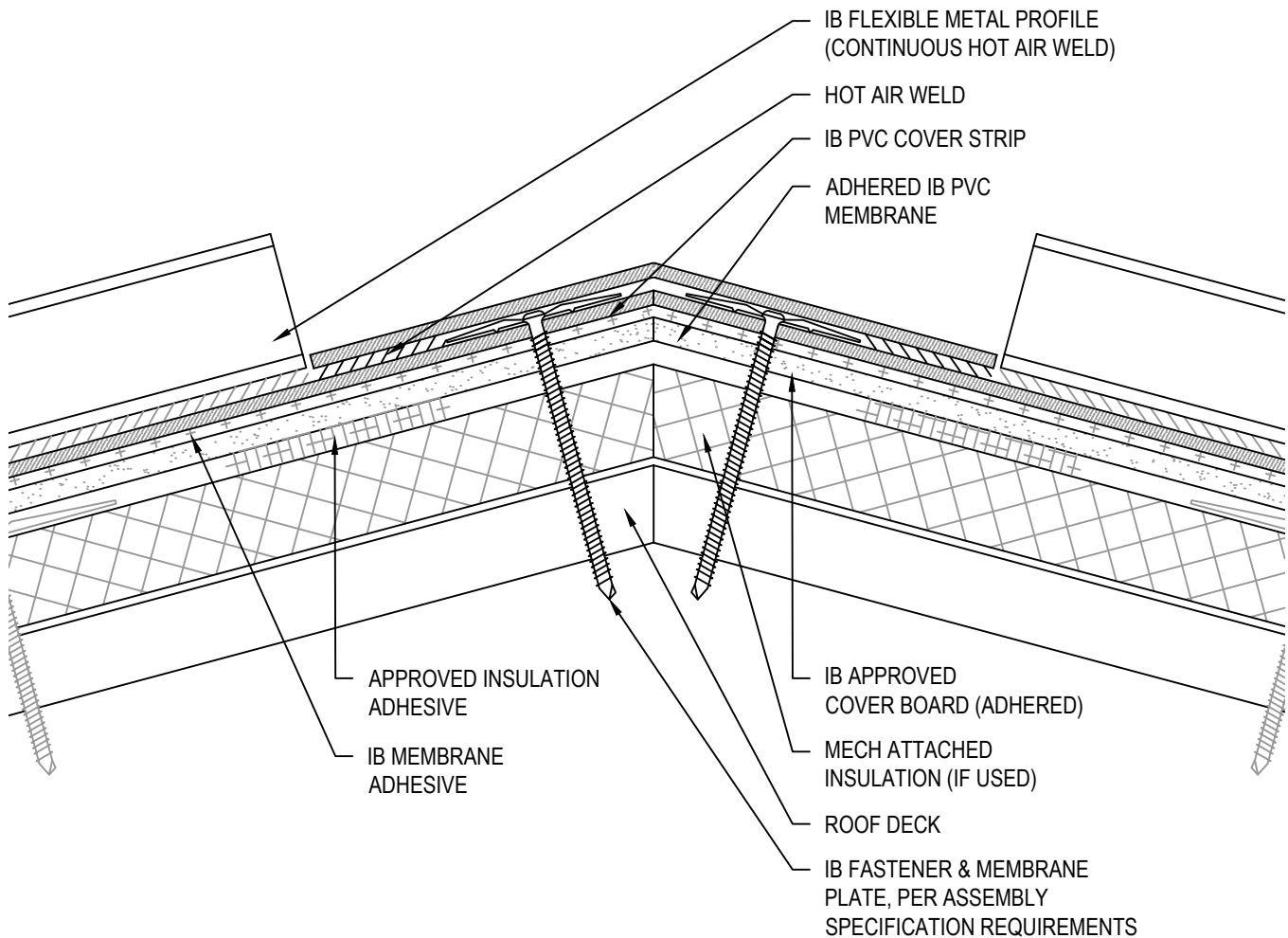

<b>Scale:</b> NTS	<b>Detail Name:</b> <b><i>Ridge Detail - Cover Strip With Flexible Metal Profile</i></b>	<b>Detail Number:</b> <b><i>FD-11</i></b>
<b>Submitted By:</b> Address: Telephone:		<b>Project:</b> Address:

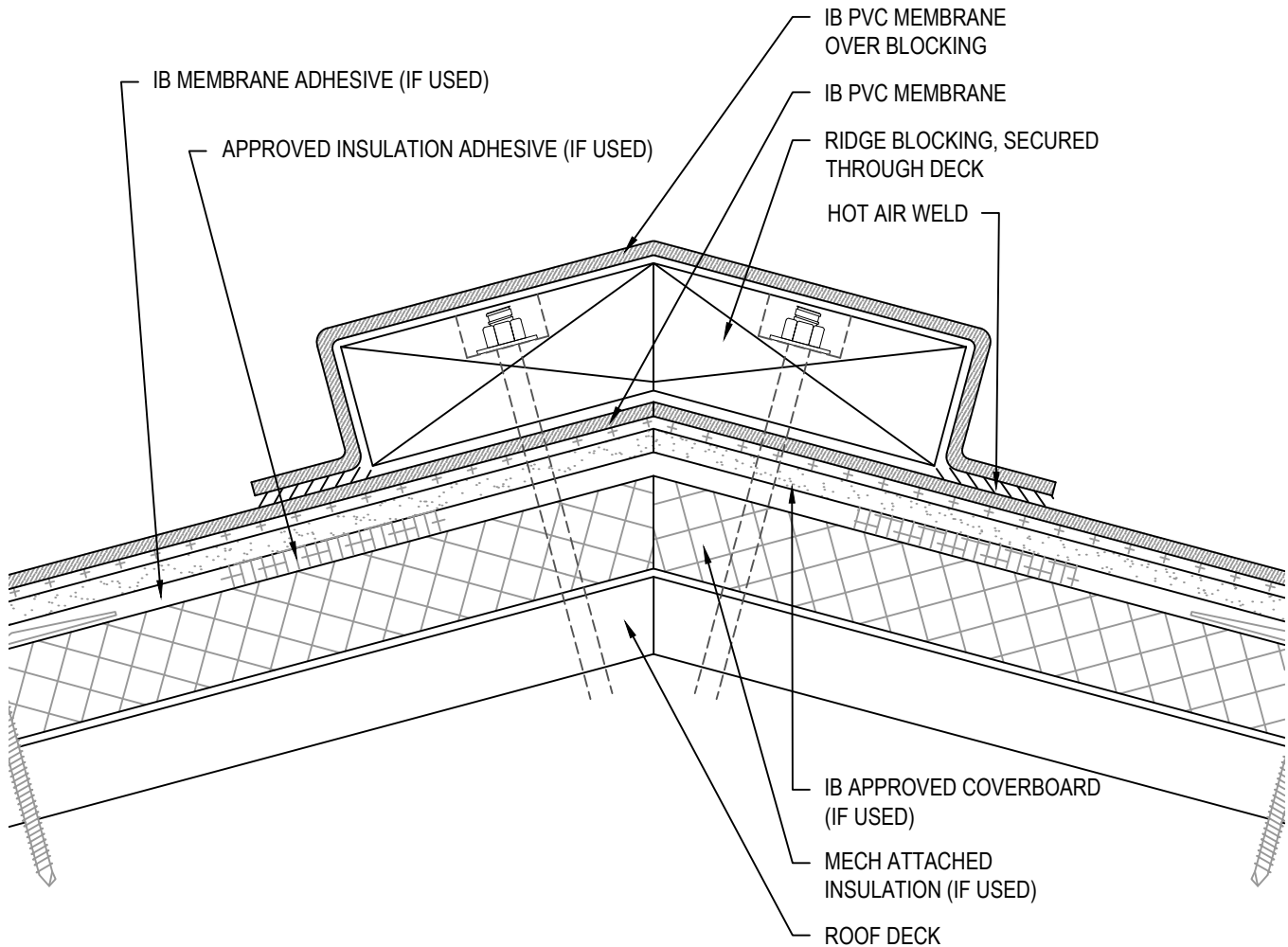

Scale:  
NTS

Detail Name:

***Ridge Detail with Ridge Blocking***

Detail Number:

***FD-12***

Submitted By:  
Address:  
Telephone:

Project:  
Address:

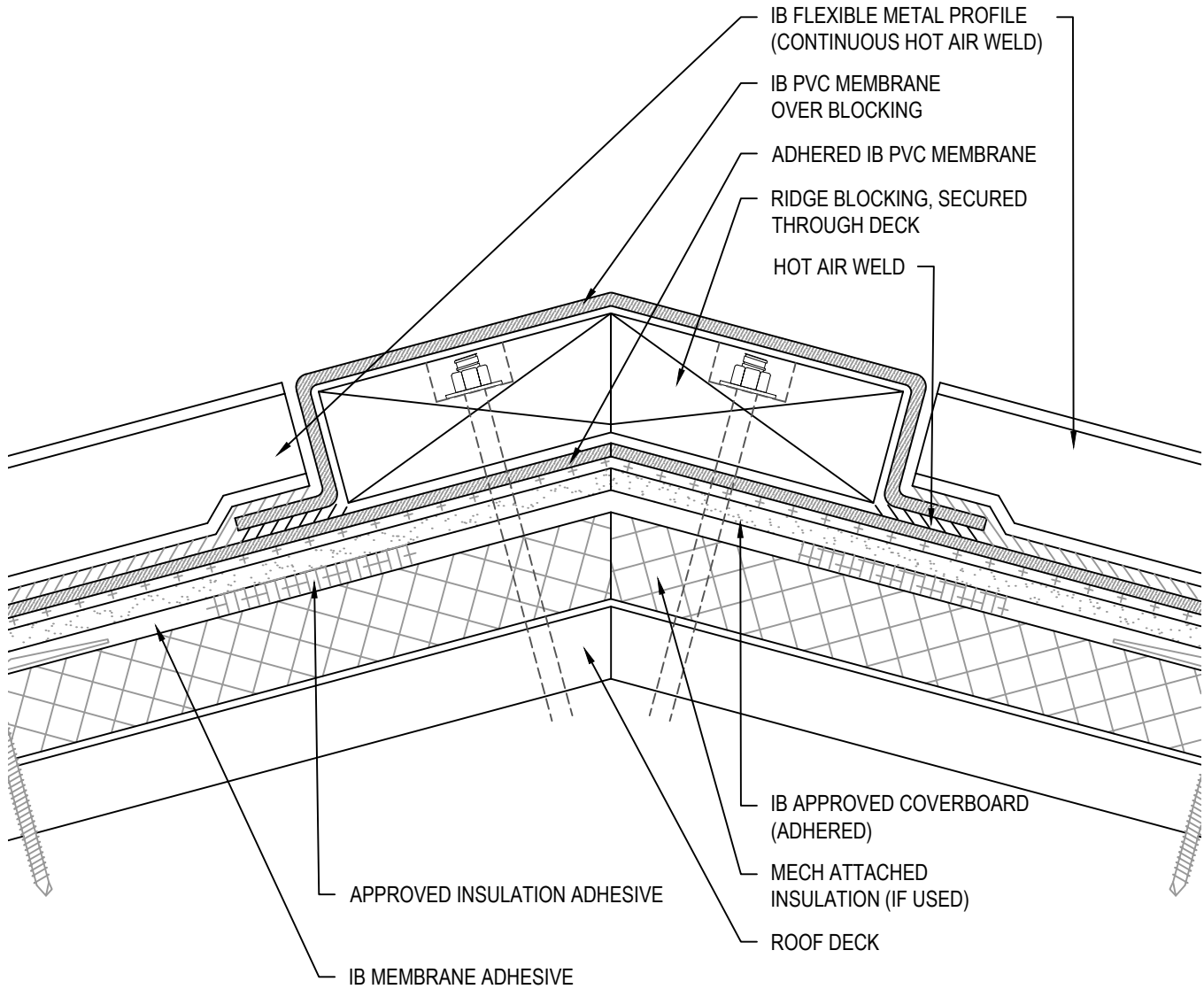

Scale: NTS	Detail Name: <b>Ridge Detail - Ridge Blocking With Flexible Metal Profile</b>	Detail Number: <b>FD-13</b>
Submitted By: Address: Telephone:		Project: Address:

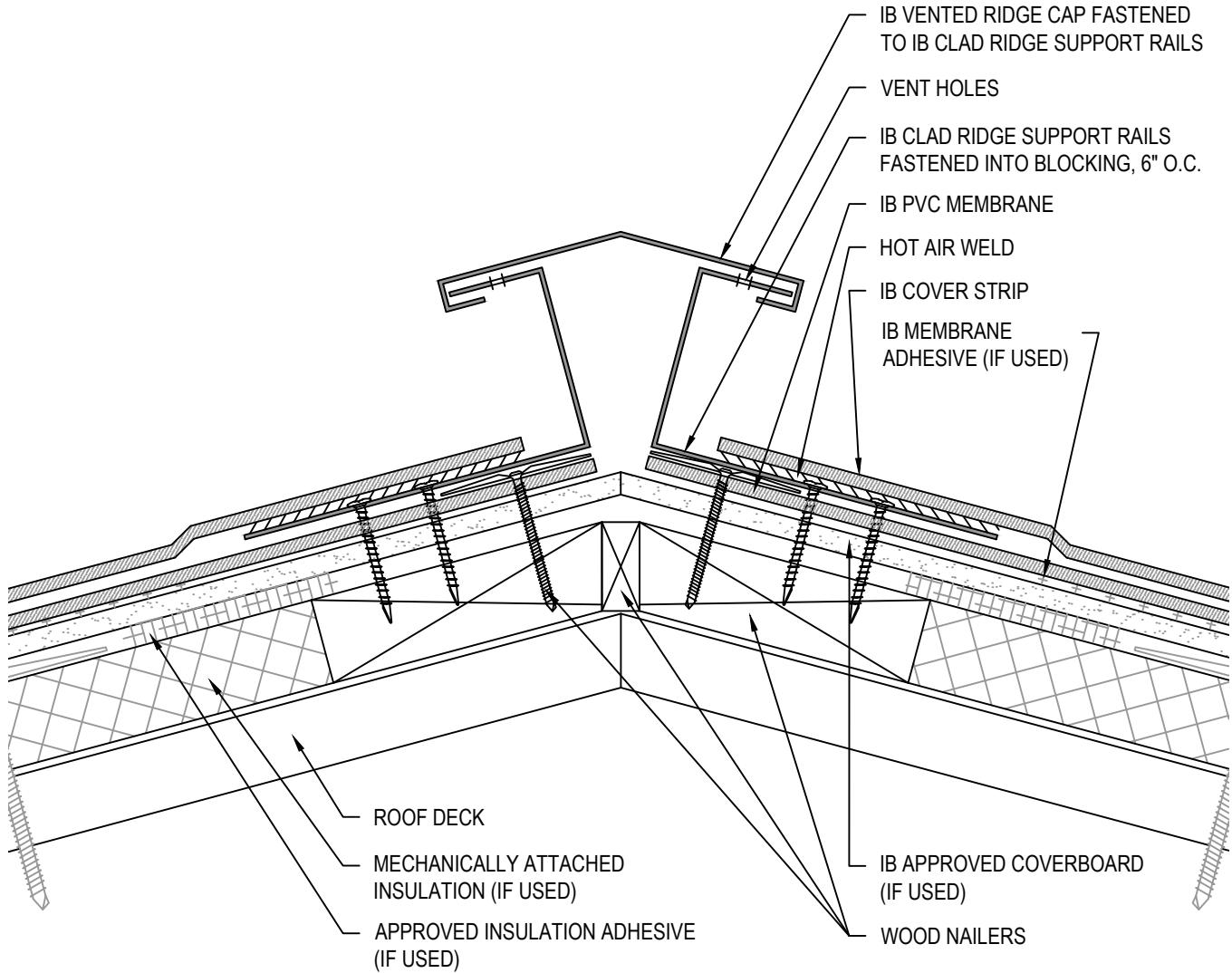

Scale: NTS	Detail Name: <b>Ridge Detail - Vented Ridge Cap</b>	Detail Number: <b>FD-14</b>
Submitted By: Address: Telephone:		Project: Address:

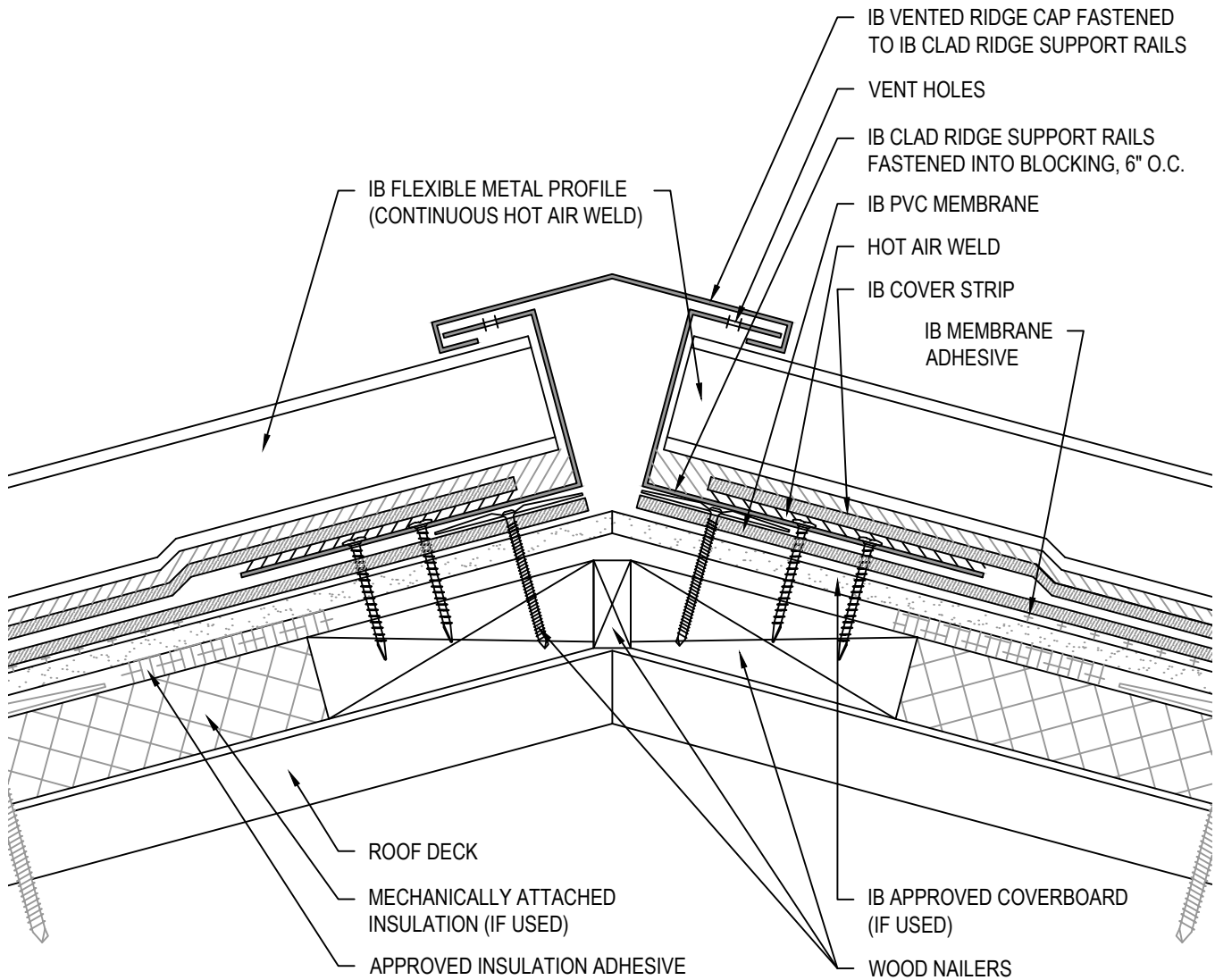

**NOTE:**

1. PROVIDE ENOUGH SPACE BETWEEN THE IB FLEXIBLE METAL PROFILE AND THE IB VENTED RIDGE CAP.

**Scale:**  
NTS

**Detail Name:**

***Ridge Detail - Vented Ridge Cap With Flexible Metal Profile***

**Detail Number:**

***FD-15***

**Submitted By:**  
Address:  
Telephone:

**Project:**  
Address:



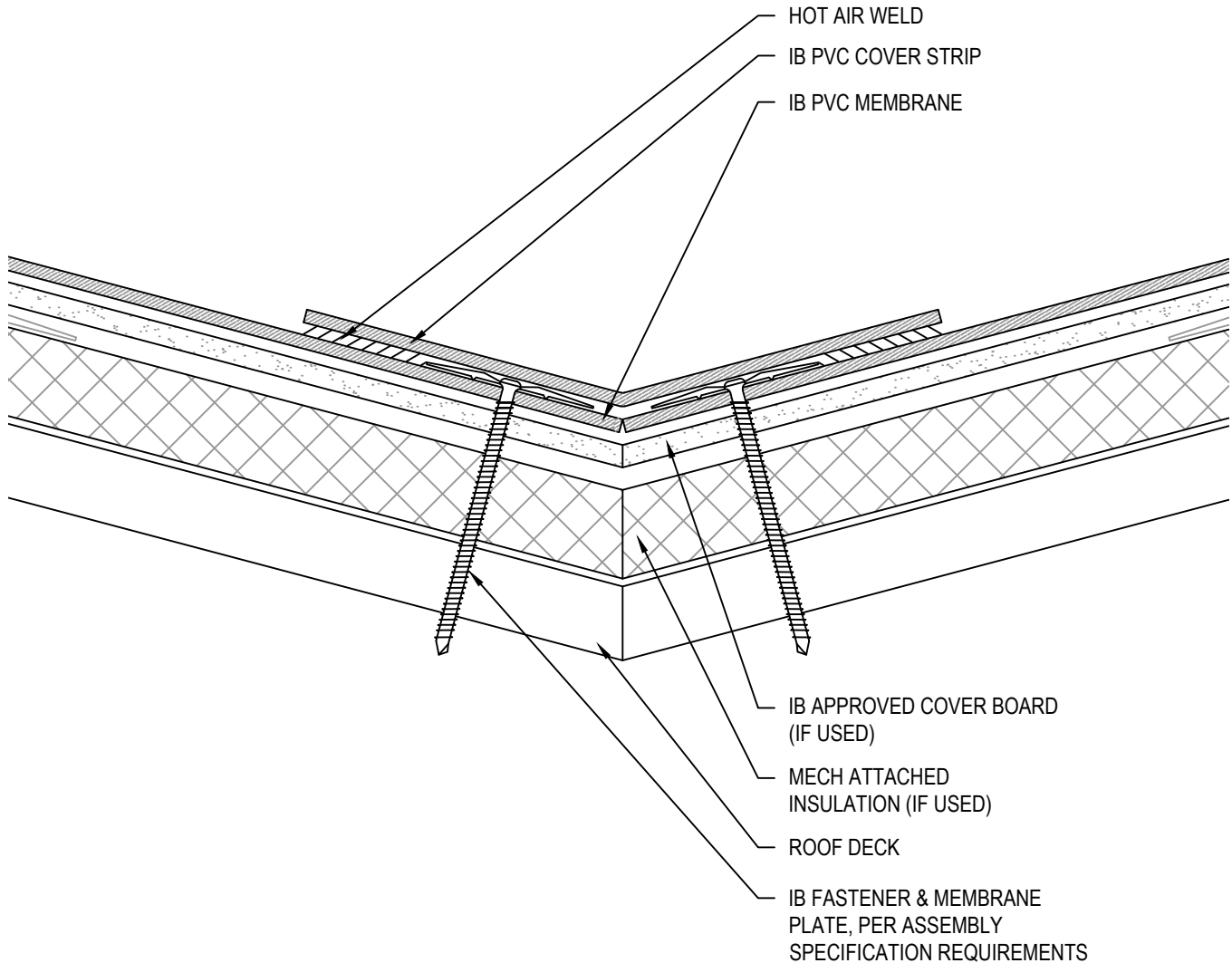

**Scale:**  
NTS

**Detail Name:**

***Valley Detail - Mechanically Attached***

**Detail Number:**

***FD-16***

**Submitted By:**  
**Address:**  
**Telephone:**

**Project:**  
**Address:**



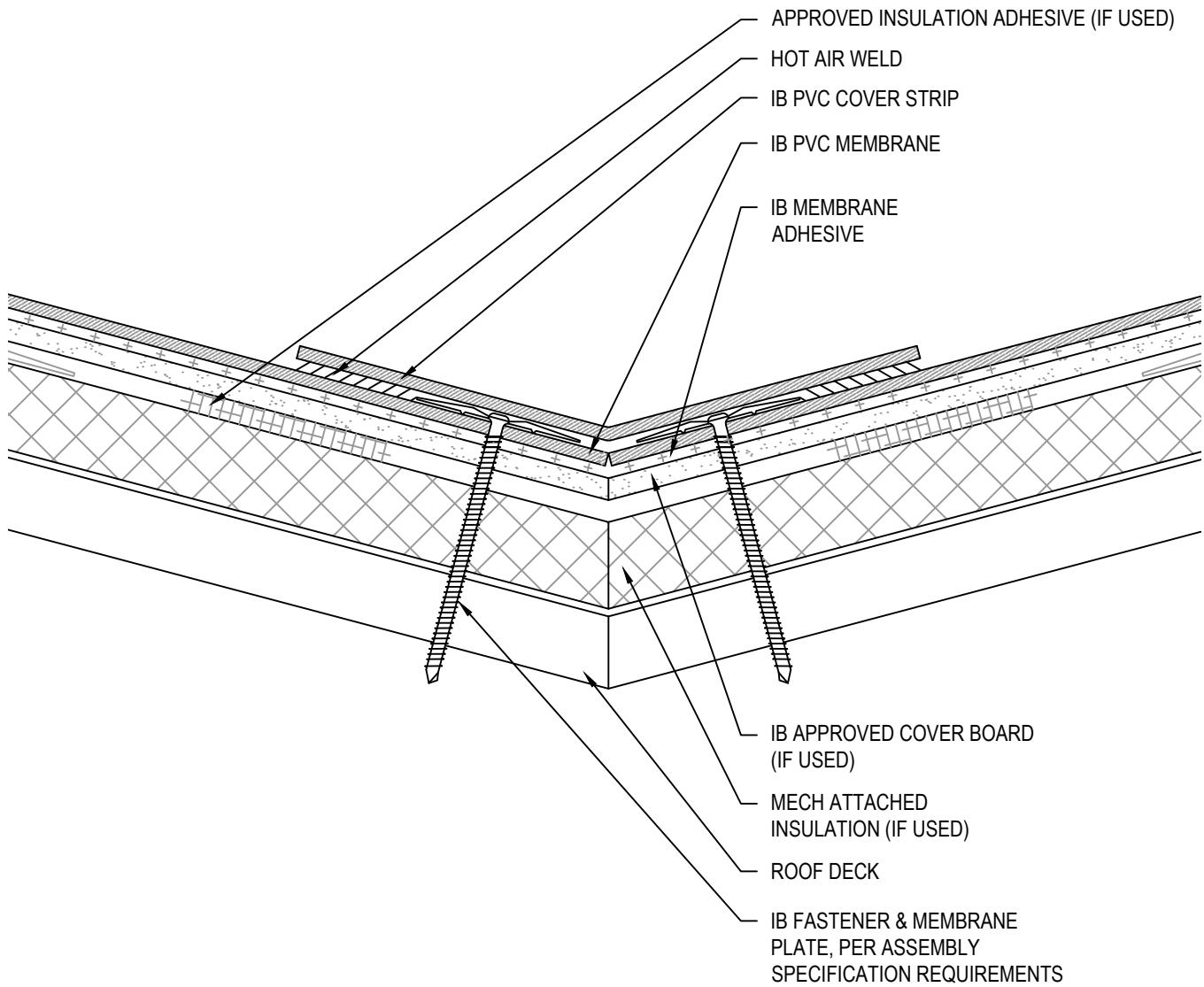

Scale:  
NTS

Detail Name:

**Valley Detail - Adhered**

Detail Number:

**FD-17**

Submitted By:  
Address:  
Telephone:

Project:  
Address:

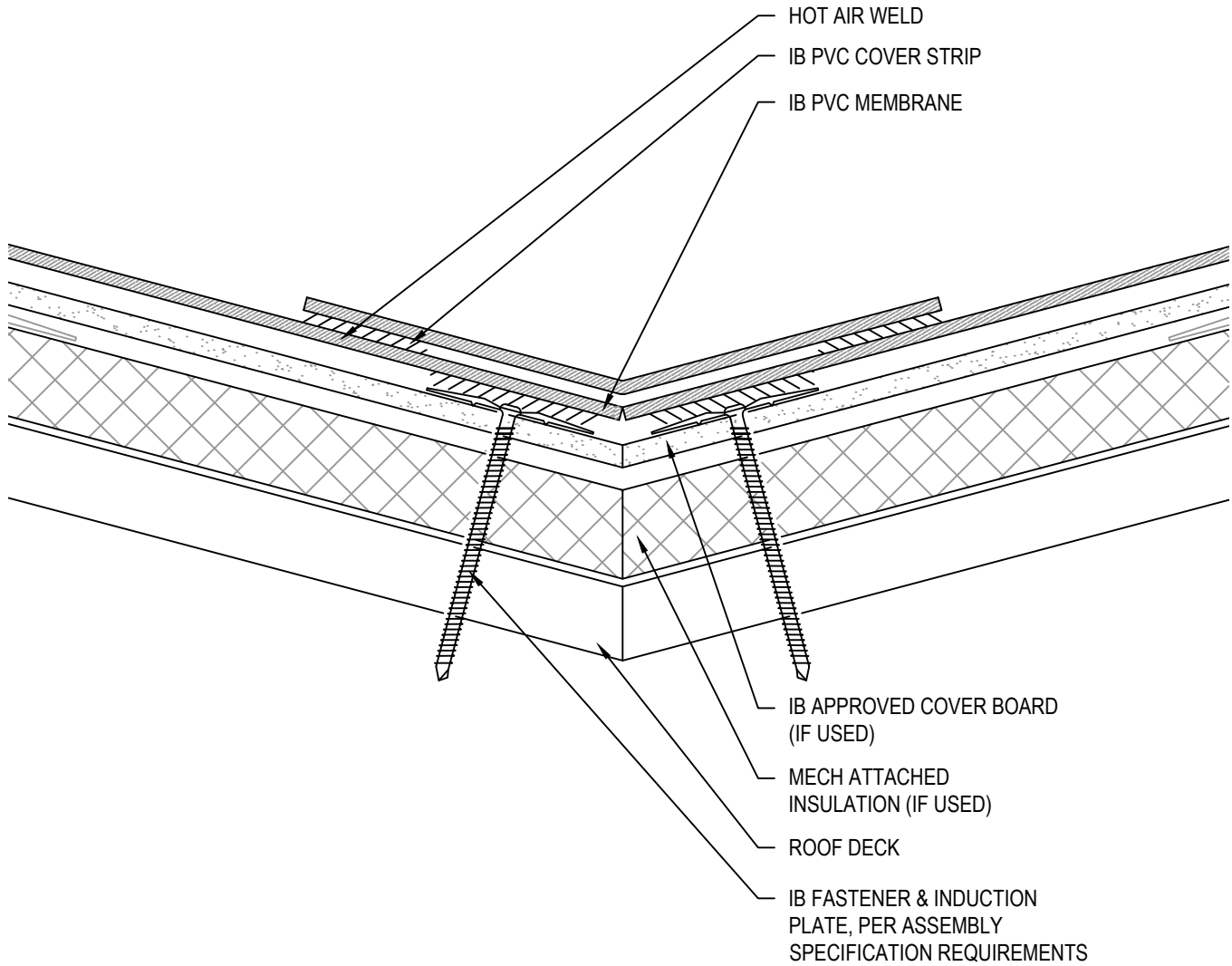

Scale: NTS	Detail Name: <b>Valley Detail - Induction Welded</b>	Detail Number: <b>FD-18</b>
Submitted By: Address: Telephone:		Project: Address:

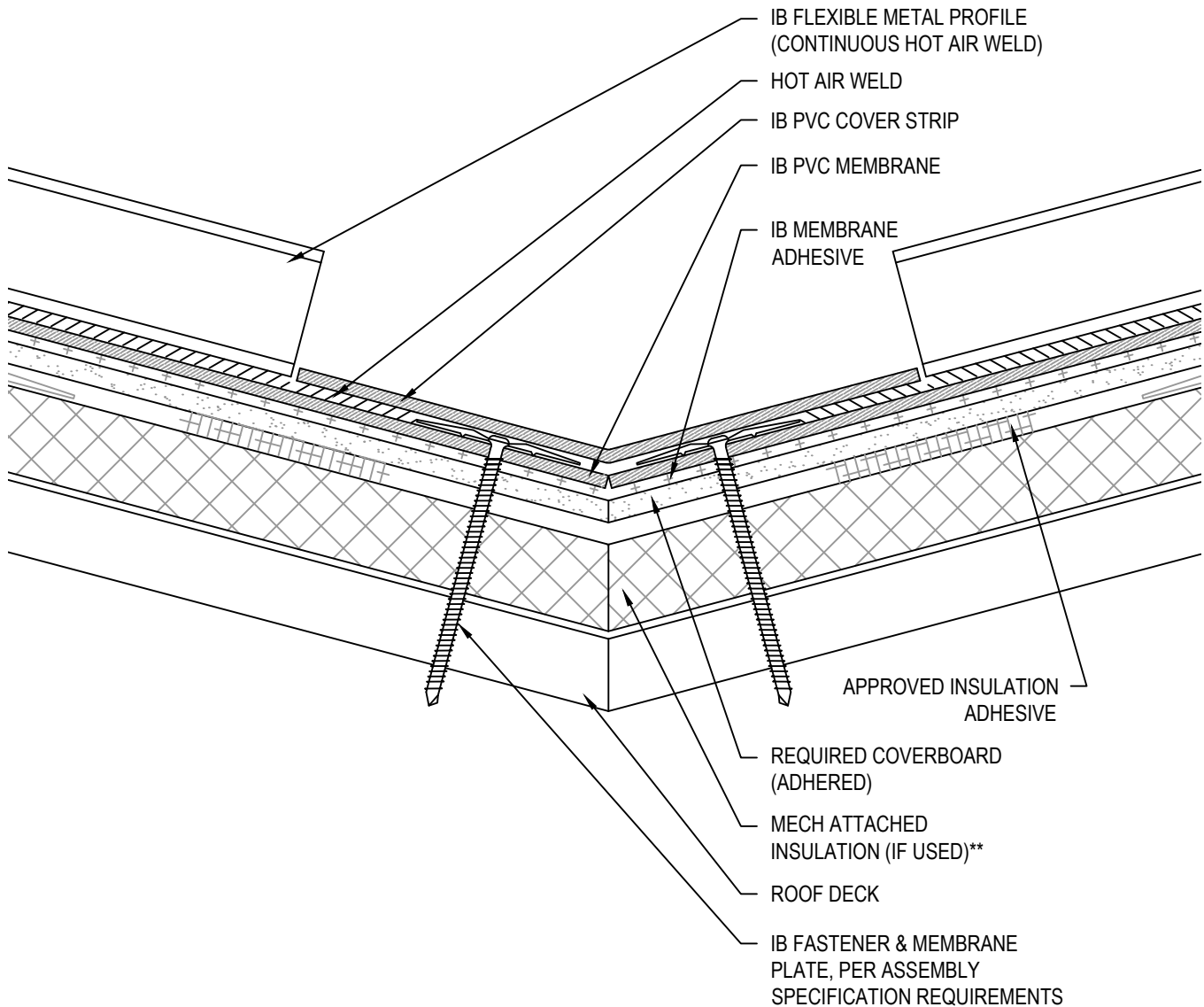

**NOTE:**

1. PROVIDE A MINIMUM OF 1-1/2" SPACE BETWEEN THE IB FLEXIBLE METAL PROFILE AND THE IB COVER STRIP

<b>Scale:</b> NTS	<b>Detail Name:</b> <h2 style="margin: 0;">Valley Detail With Flexible Metal Profile</h2>	<b>Detail Number:</b> <h2 style="margin: 0;">FD-19</h2>
<b>Submitted By:</b> Address: Telephone:		<b>Project:</b> Address:

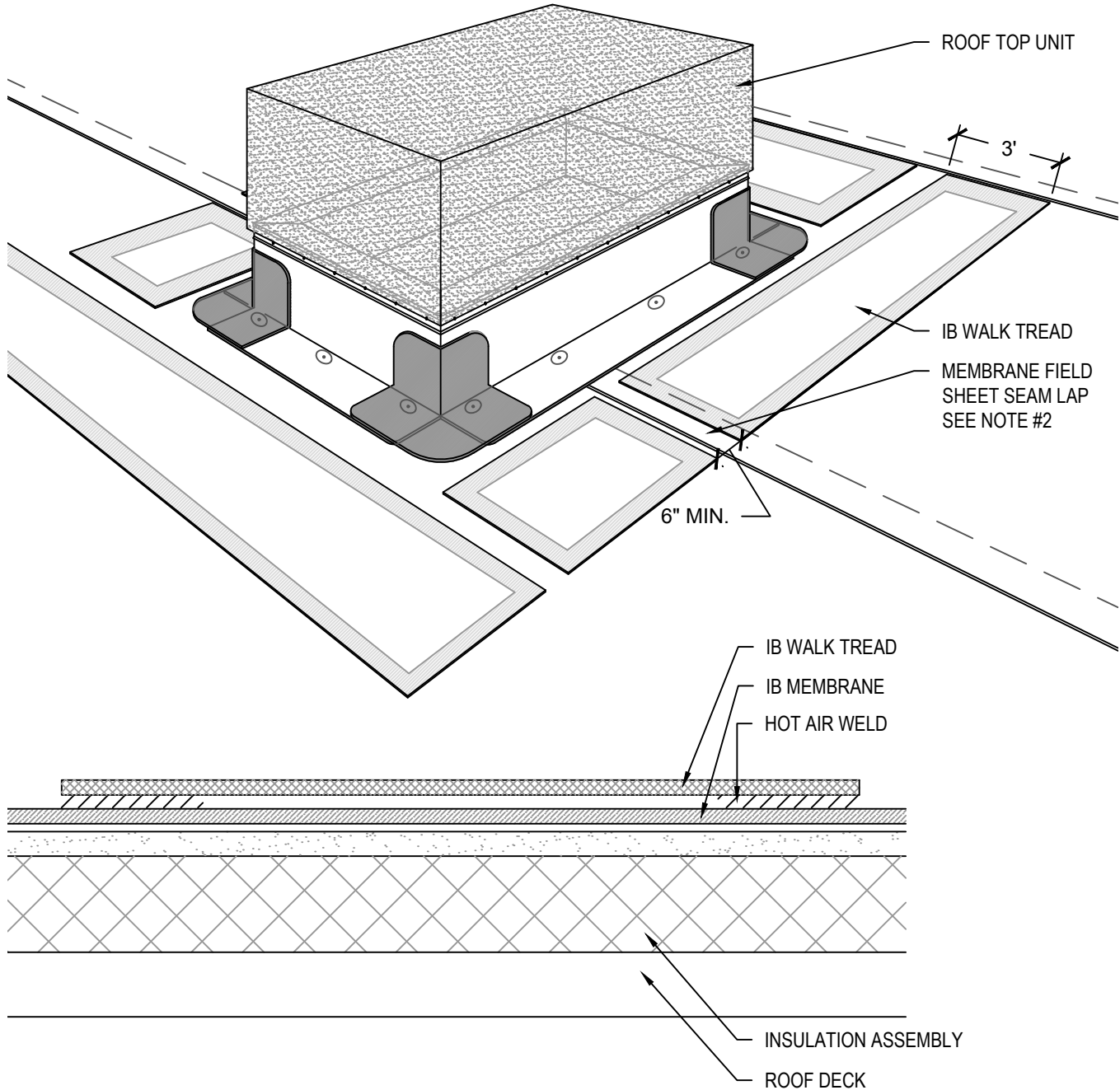

**NOTES:**

1. IB WALK TREAD IS RECOMMENDED FOR USE AT ALL ROOF ACCESS AND HIGH TRAFFIC AREAS OF THE ROOF.
2. WALK TREAD SHALL NOT BE INSTALLED OVER MEMBRANE SEAMS. STOP AND START WALK TREAD ON EITHER SIDE OF THE SEAM.

Scale: NTS	Detail Name:  <b>IB Walk Tread</b>	Detail Number:  <b>FD - 20</b>
Submitted By: Address: Telephone:		Project: Address: