

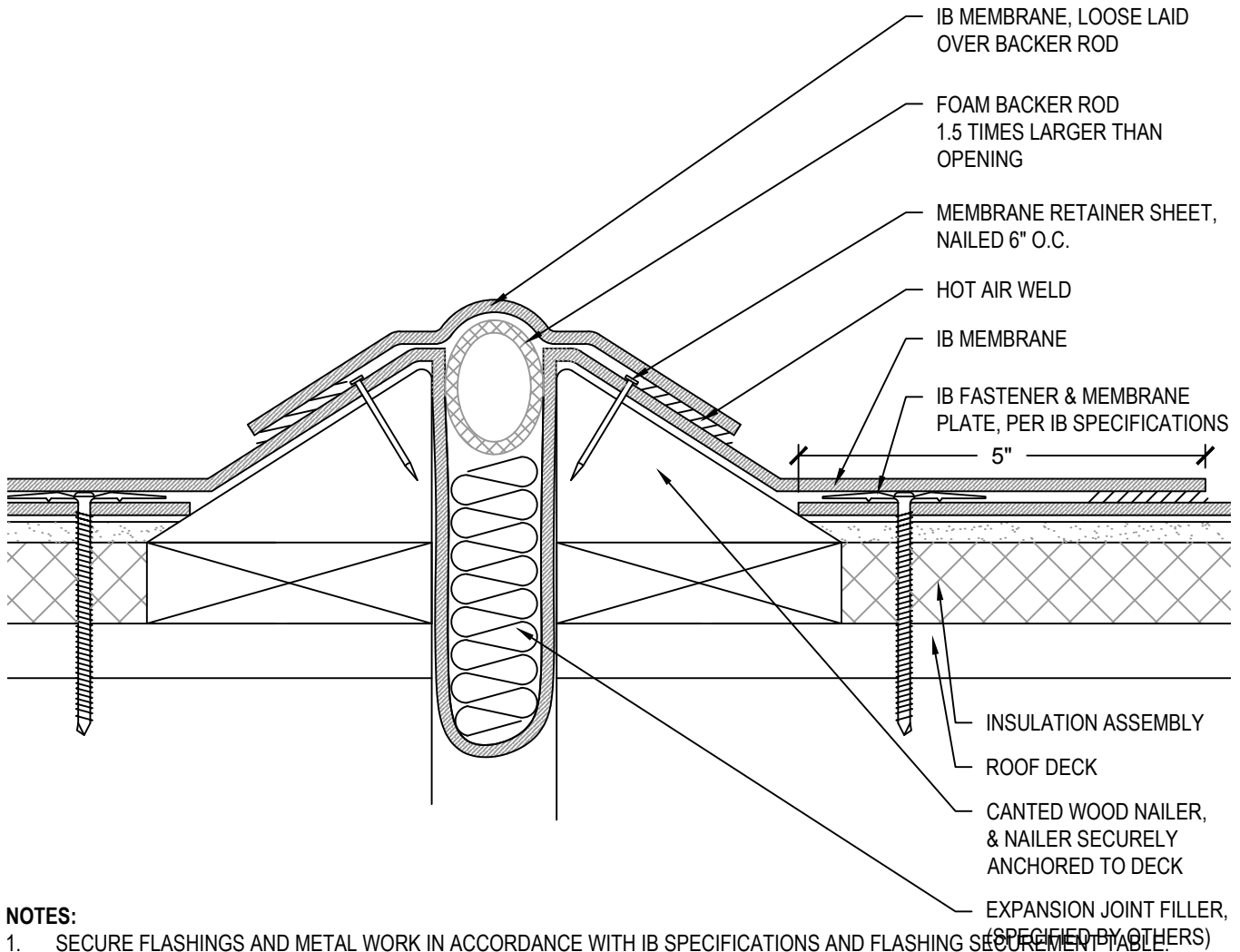

Expansion Joints & Dividers



NOTES:

1. SECURE FLASHINGS AND METAL WORK IN ACCORDANCE WITH IB SPECIFICATIONS AND FLASHING SEQUENCE TABLE
- APPROVED SUBSTRATE / SEPARATION:**
- NEW CONSTRUCTION - FULLY ADHERED, INDUCTION WELDED AND MECHANICALLY ATTACHED
- 1/2" PLYWOOD, 7/16" OSB, 1/2" APPROVED GYPSUM COVER BOARD, POURED / PRECAST CONCRETE, OR CEMENT BLOCK / MASONRY WALLS
- MECHANICALLY ATTACHED RECOVER OVER APPROVED EXISTING WALL AND BASE FLASHINGS
- FULL SEPARATION REQUIRED WITH MINIMUM 1/2" PLYWOOD, 1/4" APPROVED GYPSUM COVER BOARD, 7/16" OSB, OR APPROVED IB SEPARATION SHEET
- INDUCTION WELDED RECOVER OVER APPROVED EXISTING WALL BASE FLASHINGS
- FULL SEPARATION REQUIRED WITH MINIMUM 1/2" PLYWOOD, 1/4" APPROVED GYPSUM COVER BOARD, OR 7/16" OSB
- FULLY ADHERED RECOVER OVER APPROVED EXISTING WALL AND BASE FLASHINGS
- FULL SEPARATION REQUIRED WITH MINIMUM 1/2" PLYWOOD, 1/4" APPROVED GYPSYM COVER BOARD, OR 7/16" OSB

Scale: NTS	Detail Name: Canted Curb Expansion Joint	Detail Number: XD - 02
Submitted By: Address: Telephone:		Project: Address: