

**FIELD**  
(1 PER 1.6 SQ FT)

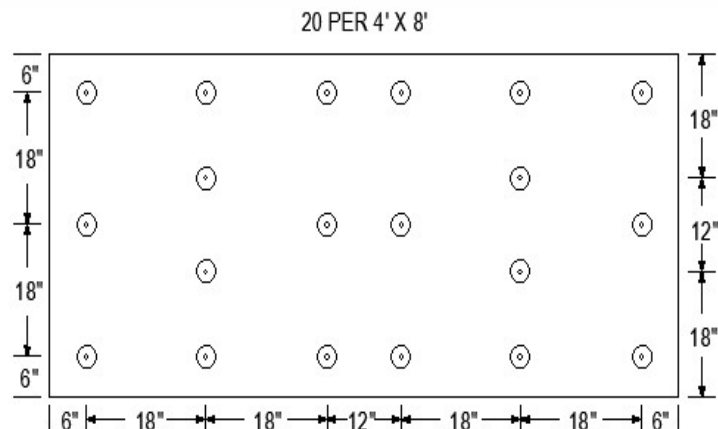

**PERIMETER**  
(ENHANCEMENT)

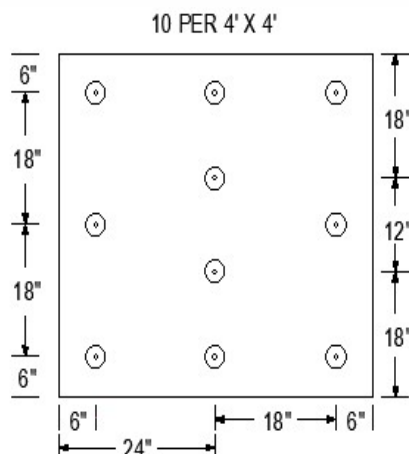
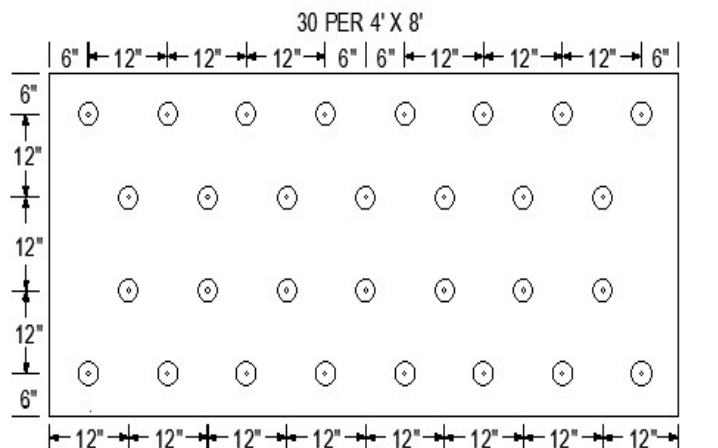
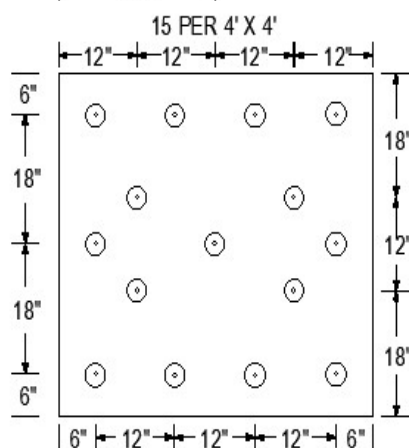

**CORNER**  
(ENHANCEMENT)

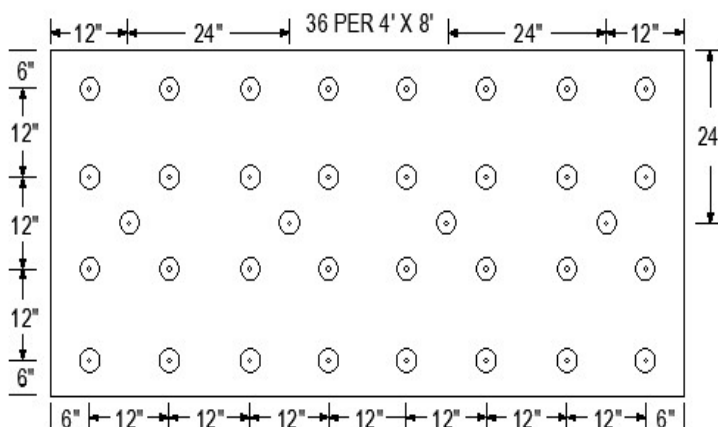
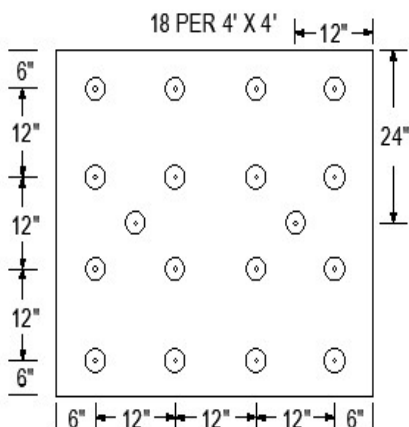

**NOTES:**

1. FASTENING PATTERNS ARE PROVIDED AS GUIDELINES FOR FASTENER PLACEMENT FOR MECHANICALLY ATTACHED INSULATION OR COVER BOARD UNDER A FULLY ADHERED MEMBRANE SYSTEM.
2. AN APPROVED COVER BOARD IS REQUIRED FOR EPS, XPS, & POLYISOCYANURATE INSULATIONS NOT APPROVED BY IB ROOF SYSTEMS.
3. REFER TO TABLE A.2 FOR MINIMUM REQUIREMENTS FOR INSULATION FASTENER SCHEDULE FOR ADHERED IB ROOF MEMBRANES.

Scale:  
NTS

Detail Name:

**1 Per 1.6 Fastening Patterns for Insulation/Cover Board**

Detail Number:

**FA-AT-09**

Submitted By:

Address:  
Telephone:

Project:

Address: