

## FA DETAILS – TABLE OF CONTENTS

### IB PVC FULLY ADHERED INSULATION & SINGLE PLY LAYOUT DETAILS

FA-AT-01 – Fully Adhered Membrane Seam .....	288
FA-AT-02 – 1 Per 4.0 Sq. Ft. Fastening Pattern for Insulation-Coverboard .....	289
FA-AT-03 – 1 Per 3.2 Sq. Ft. Fastening Pattern for Insulation-Coverboard .....	290
FA-AT-04 – 1 Per 2.9 Sq. Ft. Fastening Pattern for Insulation-Coverboard .....	291
FA-AT-05 – 1 Per 2.67 Sq. Ft. Fastening Pattern for Insulation-Coverboard .....	292
FA-AT-06 – 1 Per 2.3 Sq. Ft. Fastening Pattern for Insulation-Coverboard .....	293
FA-AT-07 – 1 Per 2.0 Sq. Ft. Fastening Pattern for Insulation-Coverboard .....	294
FA-AT-08 – 1 Per 1.78 Sq. Ft. Fastening Pattern for Insulation-Coverboard .....	295
FA-AT-09 – 1 Per 1.60 Sq. Ft. Fastening Pattern for Insulation-Coverboard .....	296
FA-AT-10 – 1 Per 1.33 Sq. Ft. Fastening Pattern for Insulation-Coverboard .....	297
FA-AT-11 – 1 Per 1.12 Sq. Ft. Fastening Pattern for Insulation-Coverboard .....	298
FA-AT-12 – 1 Per 1 Sq. Ft. Fastening Pattern for Insulation-Coverboard .....	299
FA-AT-13 – Ribbon Adhesive Layout 4x4 Board Pattern.....	300
FA-AT-14 – Ribbon Adhesive Layout 4x8 Board Pattern .....	301
FA-AT-15 – Spatter Adhesive Membrane Sheet Layout .....	302
FA-AT-16 – 4 ft Zone Layout .....	303
FA-AT-17 – 8 ft Zone Layout .....	304
FA-AT-18 – 12 ft Zone Layout .....	305
FA-AT-19 – 16 ft Zone Layout .....	306
FA-AT-20 – 20 ft Zone Layout .....	307
FA-AT-21 – Peel Stop Detail .....	308
FA-AT-22 – Membrane End Laps for FA Membrane .....	309
FA-AT-23 – IB Flexible Metal Profile Layout Membrane (1 & 2 per Sheet) .....	310
FA-AT-24 – IB Flexible Metal Profile Layout Membrane (3 & 4 per Sheet) .....	311

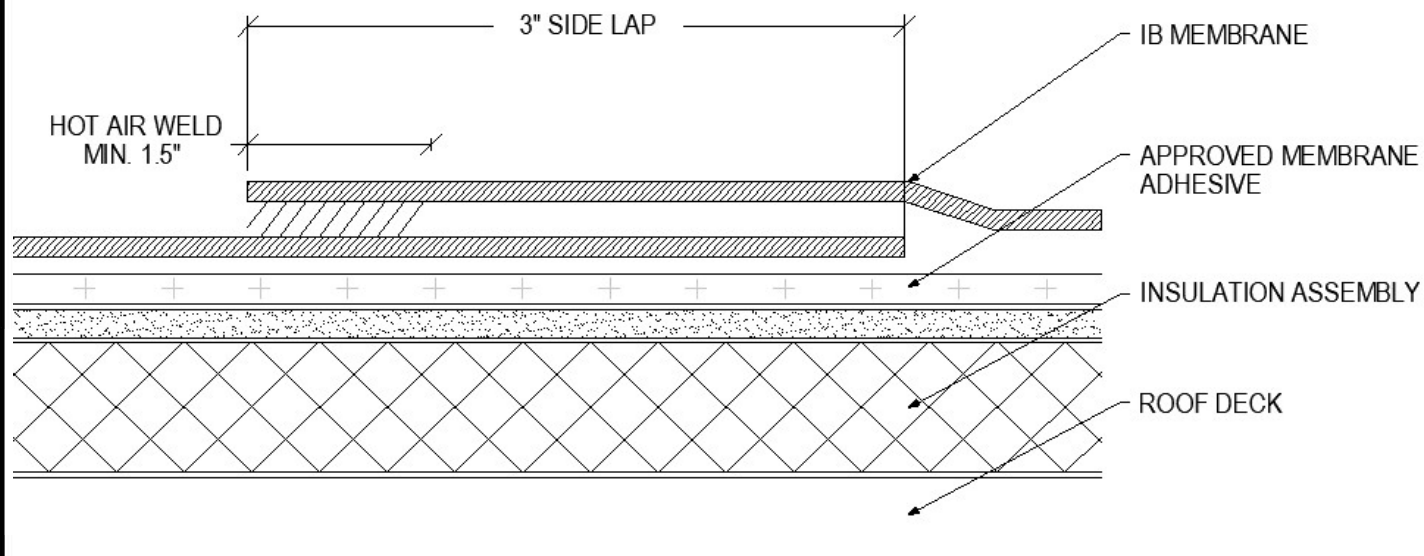

**MINIMUM FASTENER PENETRATIONS AT THE DECK  
(STANDARD ATTACHMENT):**

Deck Type:	Penetration Depth:	Fastener Type:
Plywood or Oriented Strand Board:	1/2" Completely through deck	IB HD #14 or IB XHD #15
1" Minimum Wood Plank:	1" into deck	IB HD #14 or IB XHD #15
Steel:	3/4" Completely through top flute	IB HD #14 or IB XHD #15
Light Weight Insulating Concrete over Steel Deck:	3/4" Completely through top flute	IB HD #14 or IB XHD #15
Light Weight Insulating Concrete:	1-1/2" into deck	Deklite
Structural Concrete:	1-1/4" into deck	CD-10 or Dekspike
Poured Gypsum:	1-1/2" into deck	Deklite
Cementitious Wood Fiber:	1-1/2" into deck	Deklite

**IB Standard Pull-Test Values for Fasteners**

7/16" OSB	275 lbs
5/8" OSB	350 lbs
1/2" Plywood	425 lbs
1" Minimum Wood Plank	450 lbs
22 ga. Steel	525 lbs
24 ga. Steel	425 lbs
Structural Concrete	800 lbs
LWIC over 24 ga. Steel	425 lbs
Poured Gypsum	300 lbs
Cementitious Wood Fiber	300 lbs

<b>Scale:</b> NTS	<b>Detail Name:</b> <div style="text-align: center; font-size: 1.2em; font-weight: bold;">Fully Adhered Membrane Seam</div>	<b>Detail Number:</b> <div style="text-align: center; font-size: 1.2em; font-weight: bold;">FA-AT-01</div>
<b>Submitted By:</b> Address: Telephone:		<b>Project:</b> Address:

**FIELD  
(1 PER 4 SQ FT)**

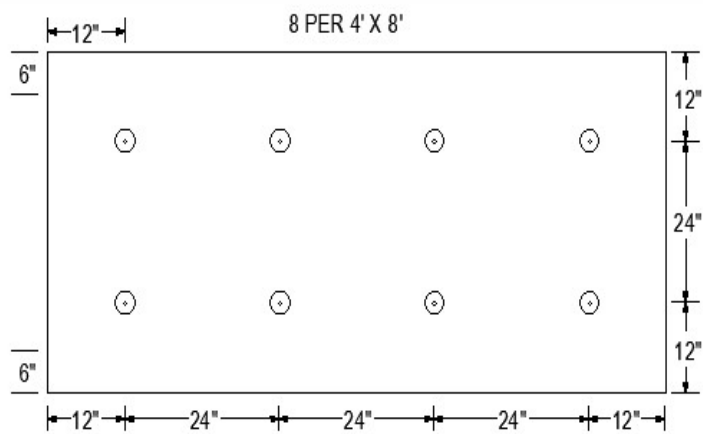
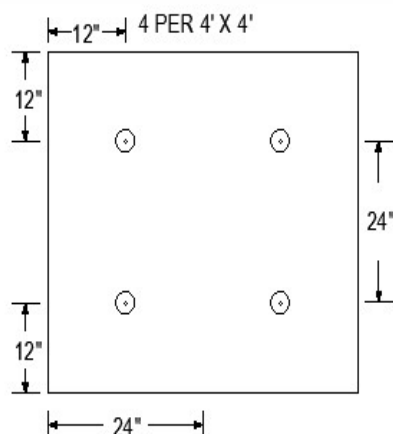

**PERIMETER  
(ENHANCEMENT)**

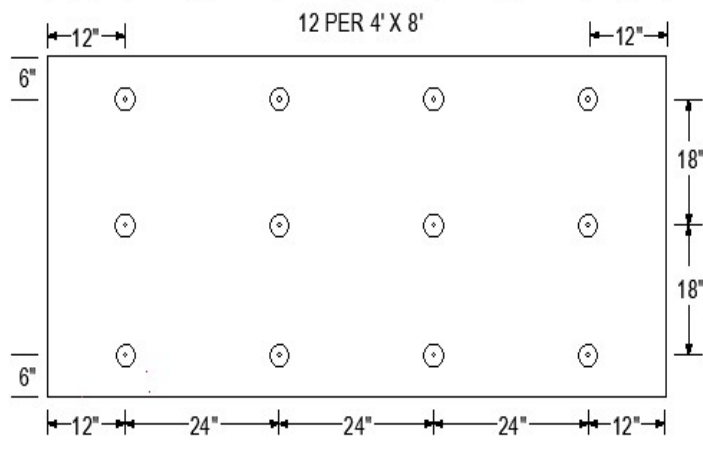
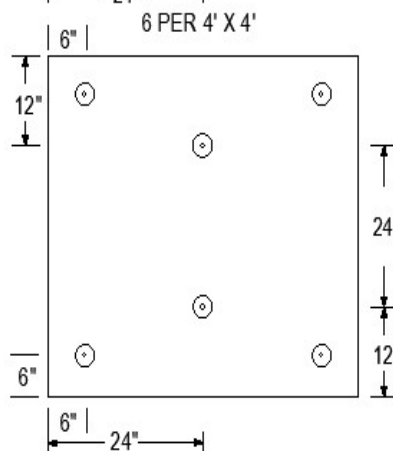

**CORNER  
(ENHANCEMENT)**

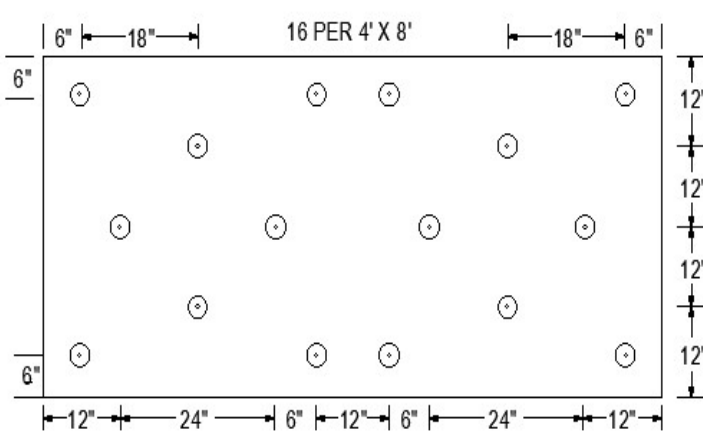
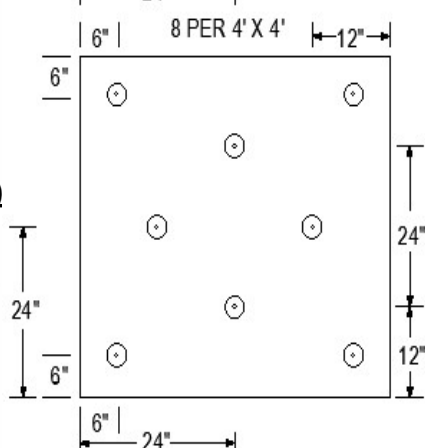

**NOTES:**

1. FASTENING PATTERNS ARE PROVIDED AS GUIDELINES FOR FASTENER PLACEMENT FOR MECHANICALLY ATTACHED INSULATION OR COVER BOARD UNDER A FULLY ADHERED MEMBRANE SYSTEM.
2. AN APPROVED COVER BOARD IS REQUIRED FOR EPS, XPS, & POLYISOCYANURATE INSULATIONS NOT APPROVED BY IB ROOF SYSTEMS.
3. REFER TO TABLE A.2 FOR MINIMUM REQUIREMENTS FOR INSULATION FASTENER SCHEDULE FOR ADHERED IB ROOF MEMBRANES.

<b>Scale:</b> NTS	<b>Detail Name:</b> <b>1 Per 4 Fastening Patterns for Insulation/Cover Board</b>	<b>Detail Number:</b> <b>FA-AT-02</b>
<b>Submitted By:</b> Address: Telephone:		<b>Project:</b> Address:

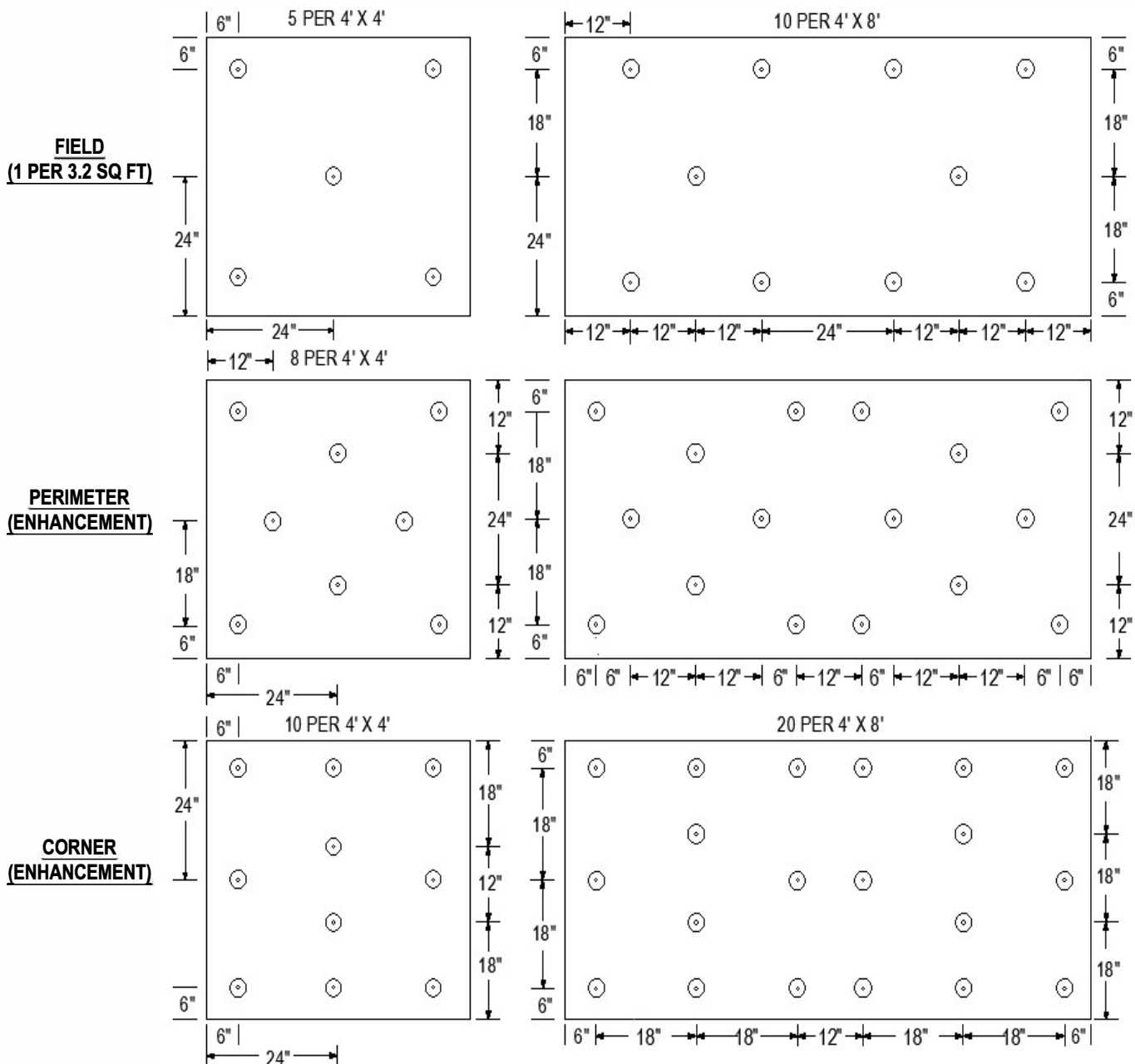

**NOTES:**

- FASTENING PATTERNS ARE PROVIDED AS GUIDELINES FOR FASTENER PLACEMENT FOR MECHANICALLY ATTACHED INSULATION OR COVER BOARD UNDER A FULLY ADHERED MEMBRANE SYSTEM.
- AN APPROVED COVER BOARD IS REQUIRED FOR EPS, XPS, & POLYISOCYANURATE INSULATIONS NOT APPROVED BY IB ROOF SYSTEMS.
- REFER TO TABLE A.2 FOR MINIMUM REQUIREMENTS FOR INSULATION FASTENER SCHEDULE FOR ADHERED IB ROOF MEMBRANES.

<b>Scale:</b> NTS	<b>Detail Name:</b> <b>1 Per 3.2 Fastening Patterns for Insulation/Cover Board</b>	<b>Detail Number:</b> <b>FA-AT-03</b>
<b>Submitted By:</b> Address: Telephone:		<b>Project:</b> Address:



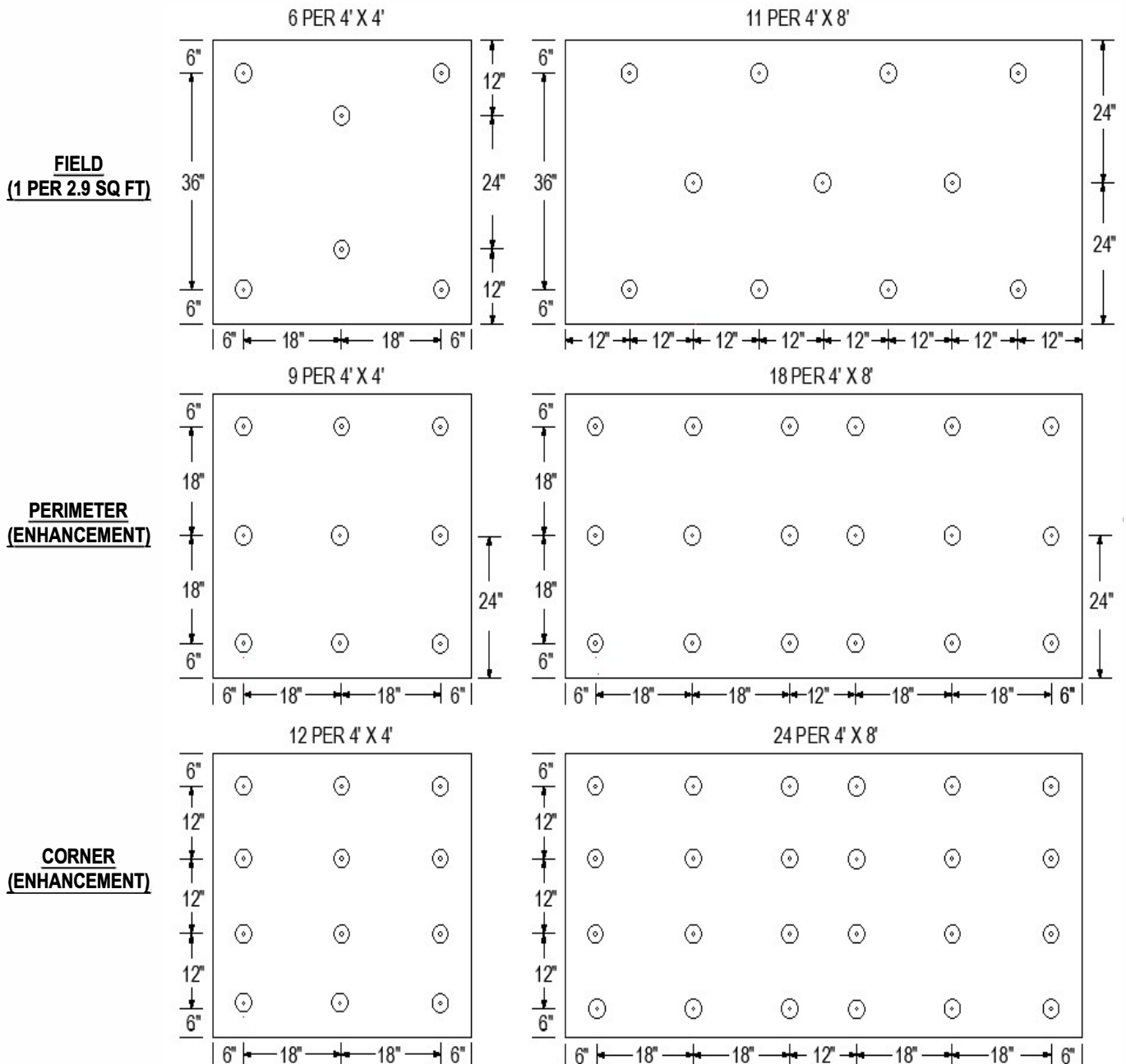

**NOTES:**

- FASTENING PATTERNS ARE PROVIDED AS GUIDELINES FOR FASTENER PLACEMENT FOR MECHANICALLY ATTACHED INSULATION OR COVER BOARD UNDER A FULLY ADHERED MEMBRANE SYSTEM.
- AN APPROVED COVER BOARD IS REQUIRED FOR EPS, XPS, & POLYISOCYANURATE INSULATIONS NOT APPROVED BY IB ROOF SYSTEMS.
- REFER TO TABLE A.2 FOR MINIMUM REQUIREMENTS FOR INSULATION FASTENER SCHEDULE FOR ADHERED IB ROOF MEMBRANES.

Scale: NTS	Detail Name: <b>1 Per 2.9 Fastening Patterns for Insulation/Cover Board</b>	Detail Number: <b>FA-AT-04</b>
Submitted By: Address: Telephone:		Project: Address:

**FIELD**  
(1 PER 2.67 SQ FT)

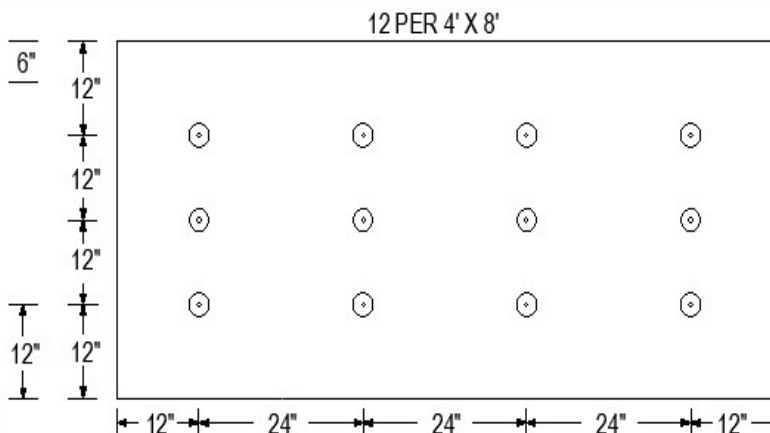
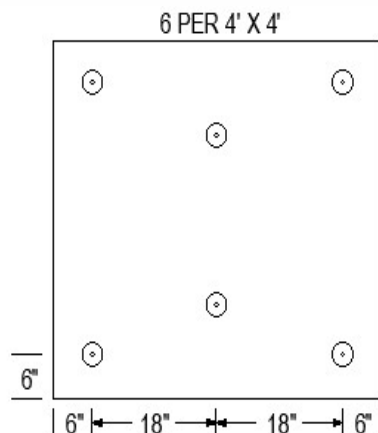

**PERIMETER**  
(ENHANCEMENT)

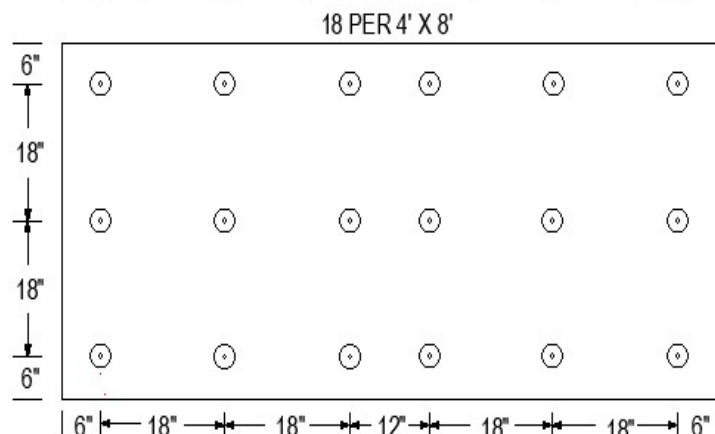
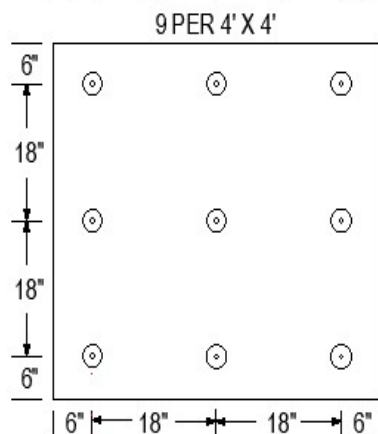

**CORNER**  
(ENHANCEMENT)

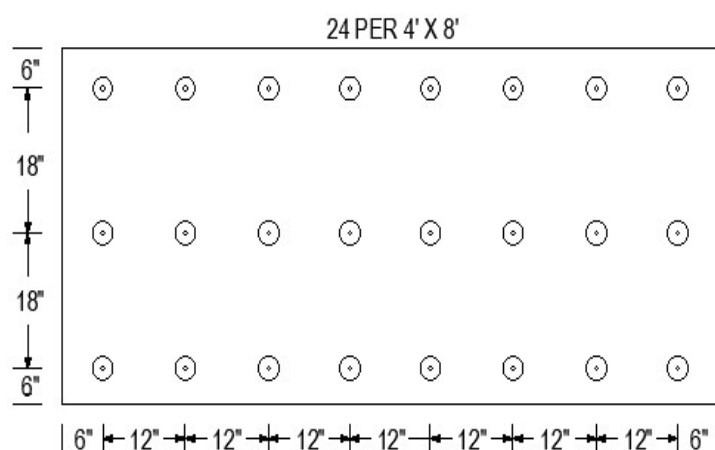
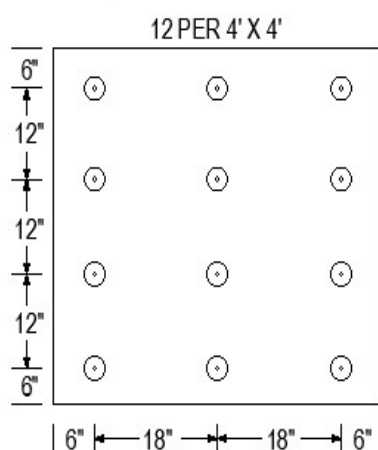

**NOTES:**

1. FASTENING PATTERNS ARE PROVIDED AS GUIDELINES FOR FASTENER PLACEMENT FOR MECHANICALLY ATTACHED INSULATION OR COVER BOARD UNDER A FULLY ADHERED MEMBRANE SYSTEM.
2. AN APPROVED COVER BOARD IS REQUIRED FOR EPS, XPS, & POLYISOCYANURATE INSULATIONS NOT APPROVED BY IB ROOF SYSTEMS.
3. REFER TO TABLE A.2 FOR MINIMUM REQUIREMENTS FOR INSULATION FASTENER SCHEDULE FOR ADHERED IB ROOF MEMBRANES.

Scale:  
NTS

Detail Name:

**1 Per 2.67 Fastening Patterns for Insulation/Cover Board**

Detail Number:

**FA-AT-05**

Submitted By:

Address:  
Telephone:

Project:

Address:

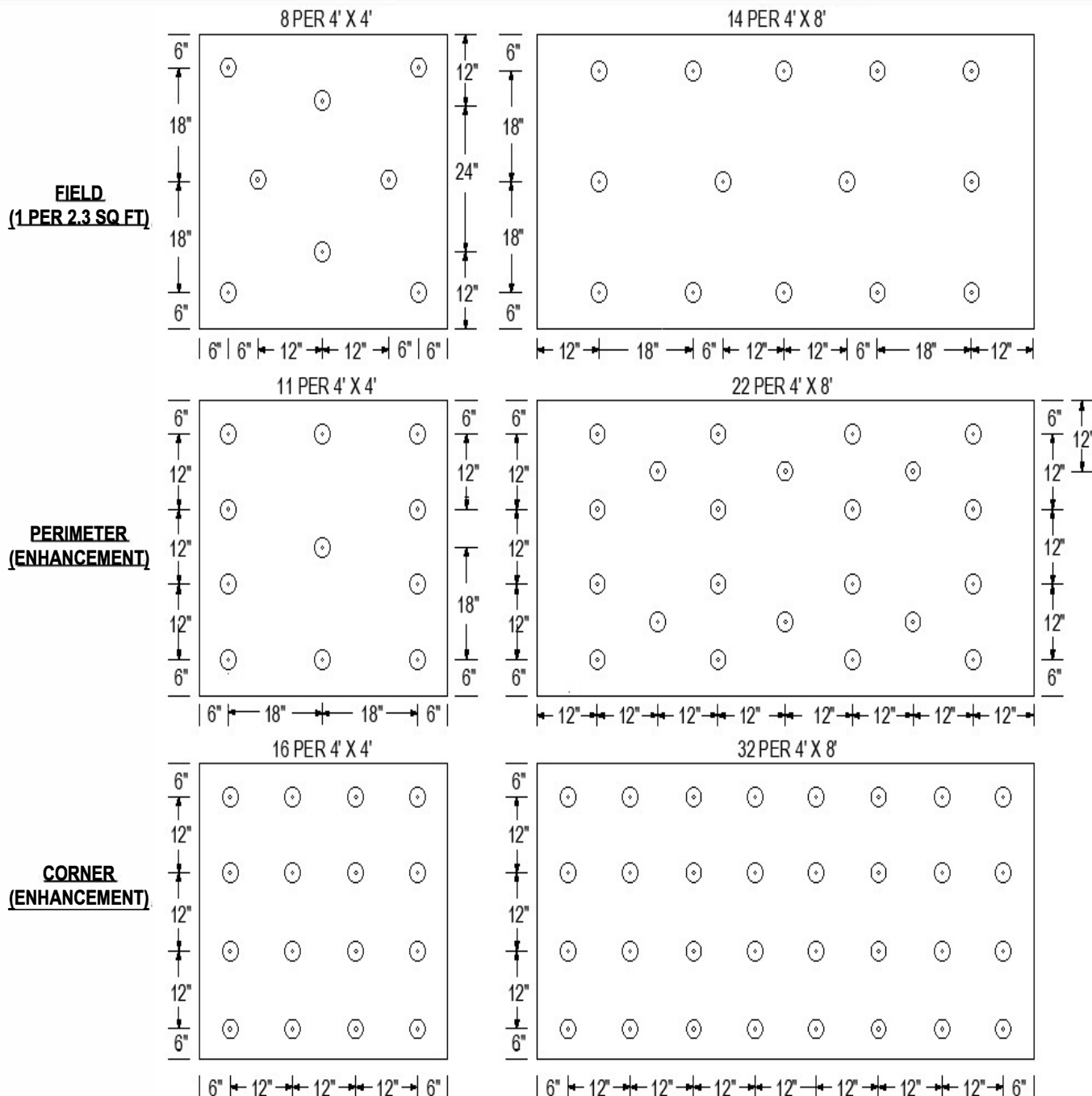

## NOTES:

1. FASTENING PATTERNS ARE PROVIDED AS GUIDELINES FOR FASTENER PLACEMENT FOR MECHANICALLY ATTACHED INSULATION OR COVER BOARD UNDER A FULLY ADHERED MEMBRANE SYSTEM.
2. AN APPROVED COVER BOARD IS REQUIRED FOR EPS, XPS, & POLYISOCYANURATE INSULATIONS NOT APPROVED BY IB ROOF SYSTEMS.
3. REFER TO TABLE A.2 FOR MINIMUM REQUIREMENTS FOR INSULATION FASTENER SCHEDULE FOR ADHERED IB ROOF MEMBRANES.

Scale:  
NTS

Detail Name:

**1 Per 2.3 Fastening Patterns for Insulation/Cover Board**

Detail Number:

**FA-AT-06**

Submitted By:

Address:  
Telephone:

Project:

Address:

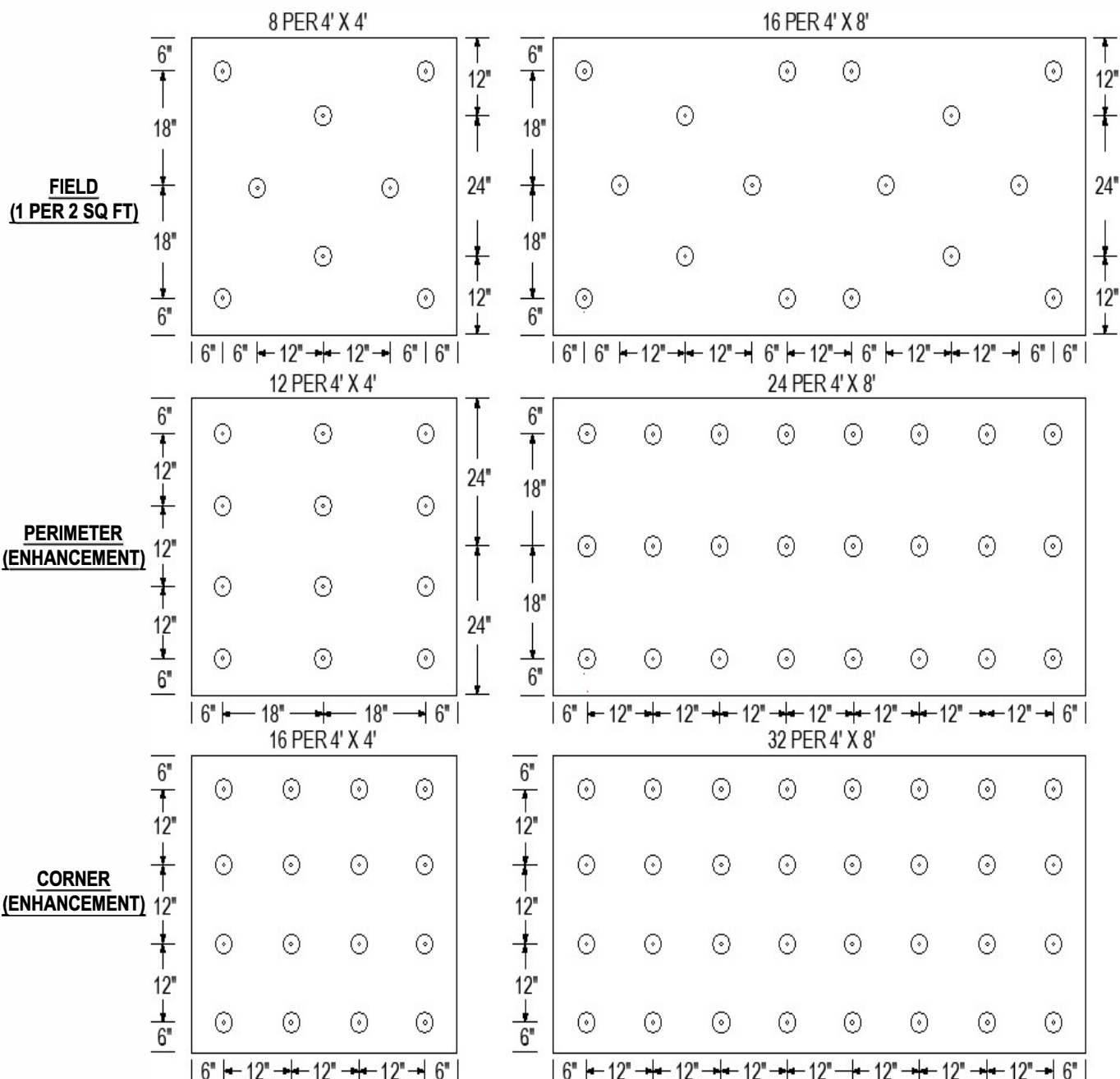

**NOTES:**

- FASTENING PATTERNS ARE PROVIDED AS GUIDELINES FOR FASTENER PLACEMENT FOR MECHANICALLY ATTACHED INSULATION OR COVER BOARD UNDER A FULLY ADHERED MEMBRANE SYSTEM.
- AN APPROVED COVER BOARD IS REQUIRED FOR EPS, XPS, & POLYISOCYANURATE INSULATIONS NOT APPROVED BY IB ROOF SYSTEMS.
- REFER TO TABLE A.2 FOR MINIMUM REQUIREMENTS FOR INSULATION FASTENER SCHEDULE FOR ADHERED IB ROOF MEMBRANES.

Scale: NTS	Detail Name: <b>1 Per 2 Fastening Patterns for Insulation/Cover Board</b>	Detail Number: <b>FA-AT-07</b>
Submitted By: Address: Telephone:		Project: Address:

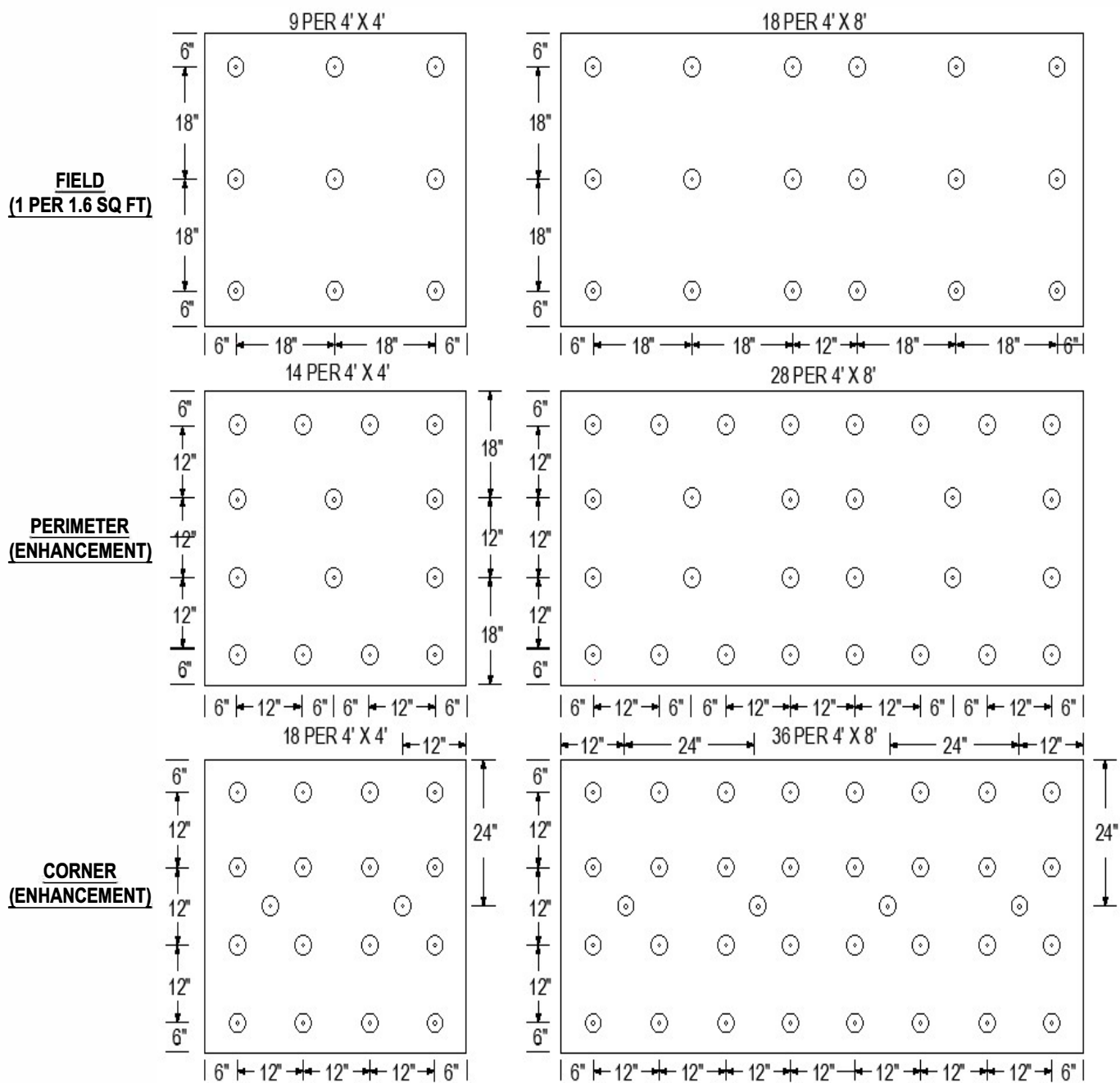

**NOTES:**

1. FASTENING PATTERNS ARE PROVIDED AS GUIDELINES FOR FASTENER PLACEMENT FOR MECHANICALLY ATTACHED INSULATION OR COVER BOARD UNDER A FULLY ADHERED MEMBRANE SYSTEM.
2. AN APPROVED COVER BOARD IS REQUIRED FOR EPS, XPS, & POLYISOCYANURATE INSULATIONS NOT APPROVED BY IB ROOF SYSTEMS.
3. REFER TO TABLE A.2 FOR MINIMUM REQUIREMENTS FOR INSULATION FASTENER SCHEDULE FOR ADHERED IB ROOF MEMBRANE.

Scale: NTS	Detail Name: <b>1 Per 1.78 Fastening Patterns for Insulation/Cover Board</b>	Detail Number: <b>FA-AT-08</b>
Submitted By: Address: Telephone:		Project: Address:

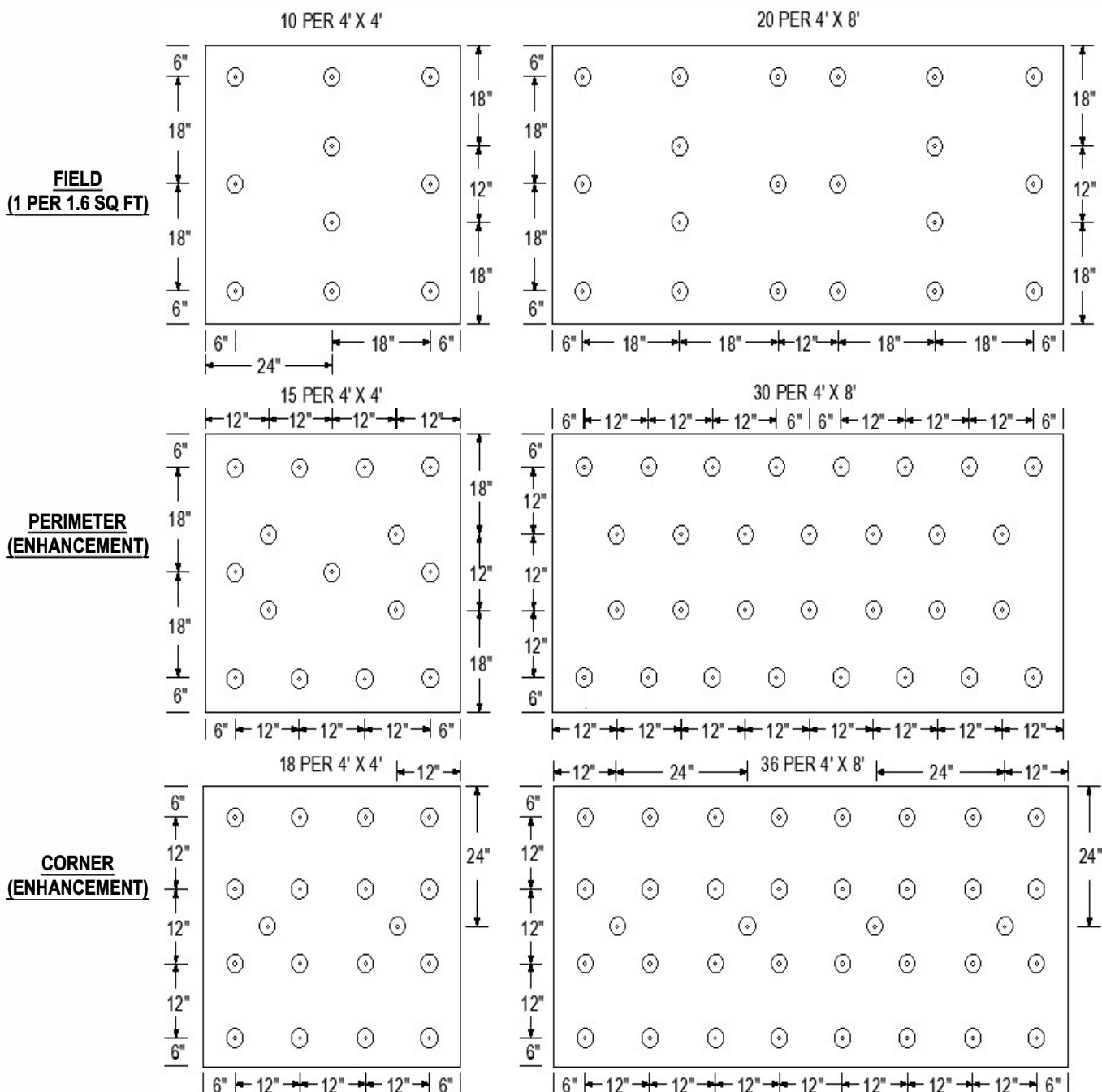

**NOTES:**

1. FASTENING PATTERNS ARE PROVIDED AS GUIDELINES FOR FASTENER PLACEMENT FOR MECHANICALLY ATTACHED INSULATION OR COVER BOARD UNDER A FULLY ADHERED MEMBRANE SYSTEM.
2. AN APPROVED COVER BOARD IS REQUIRED FOR EPS, XPS, & POLYISOCYANURATE INSULATIONS NOT APPROVED BY IB ROOF SYSTEMS.
3. REFER TO TABLE A.2 FOR MINIMUM REQUIREMENTS FOR INSULATION FASTENER SCHEDULE FOR ADHERED IB ROOF MEMBRANES.

Scale: NTS	Detail Name: <b>1 Per 1.6 Fastening Patterns for Insulation/Cover Board</b>	Detail Number: <b>FA-AT-09</b>
Submitted By: Address: Telephone:		Project: Address:



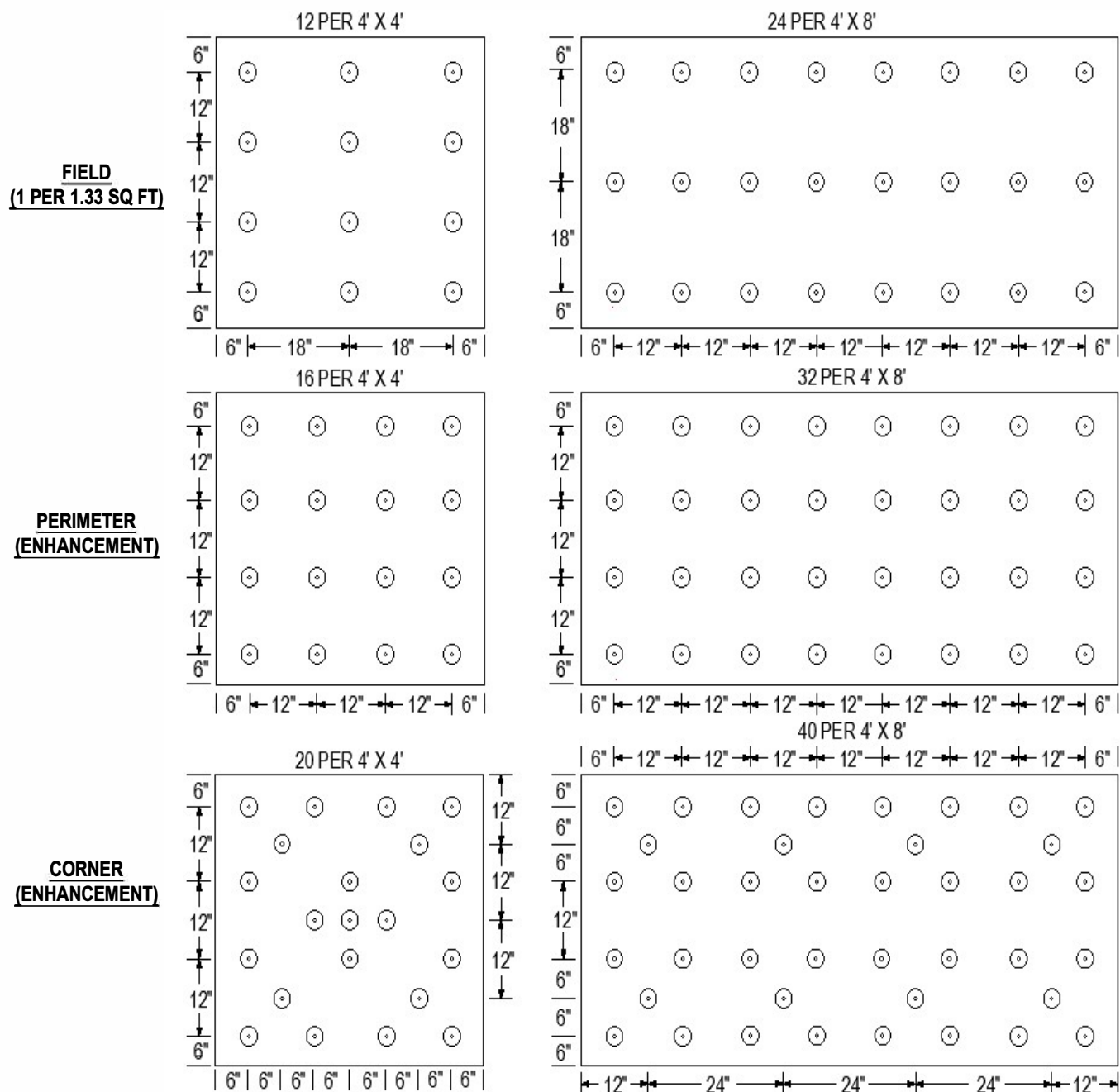

**NOTES:**

1. FASTENING PATTERNS ARE PROVIDED AS GUIDELINES FOR FASTENER PLACEMENT FOR MECHANICALLY ATTACHED INSULATION OR COVER BOARD UNDER A FULLY ADHERED MEMBRANE SYSTEM.
2. AN APPROVED COVER BOARD IS REQUIRED FOR EPS, XPS, & POLYISOCYANURATE INSULATIONS NOT APPROVED BY IB ROOF SYSTEMS.
3. REFER TO TABLE A.2 FOR MINIMUM REQUIREMENTS FOR INSULATION FASTENER SCHEDULE FOR ADHERED IB ROOF MEMBRANES.

<b>Scale:</b> NTS	<b>Detail Name:</b> <b>1 Per 1.33 Fastening Patterns for Insulation/Cover Board</b>	<b>Detail Number:</b> <b>FA-AT-10</b>
<b>Submitted By:</b> Address: Telephone:		<b>Project:</b> Address:

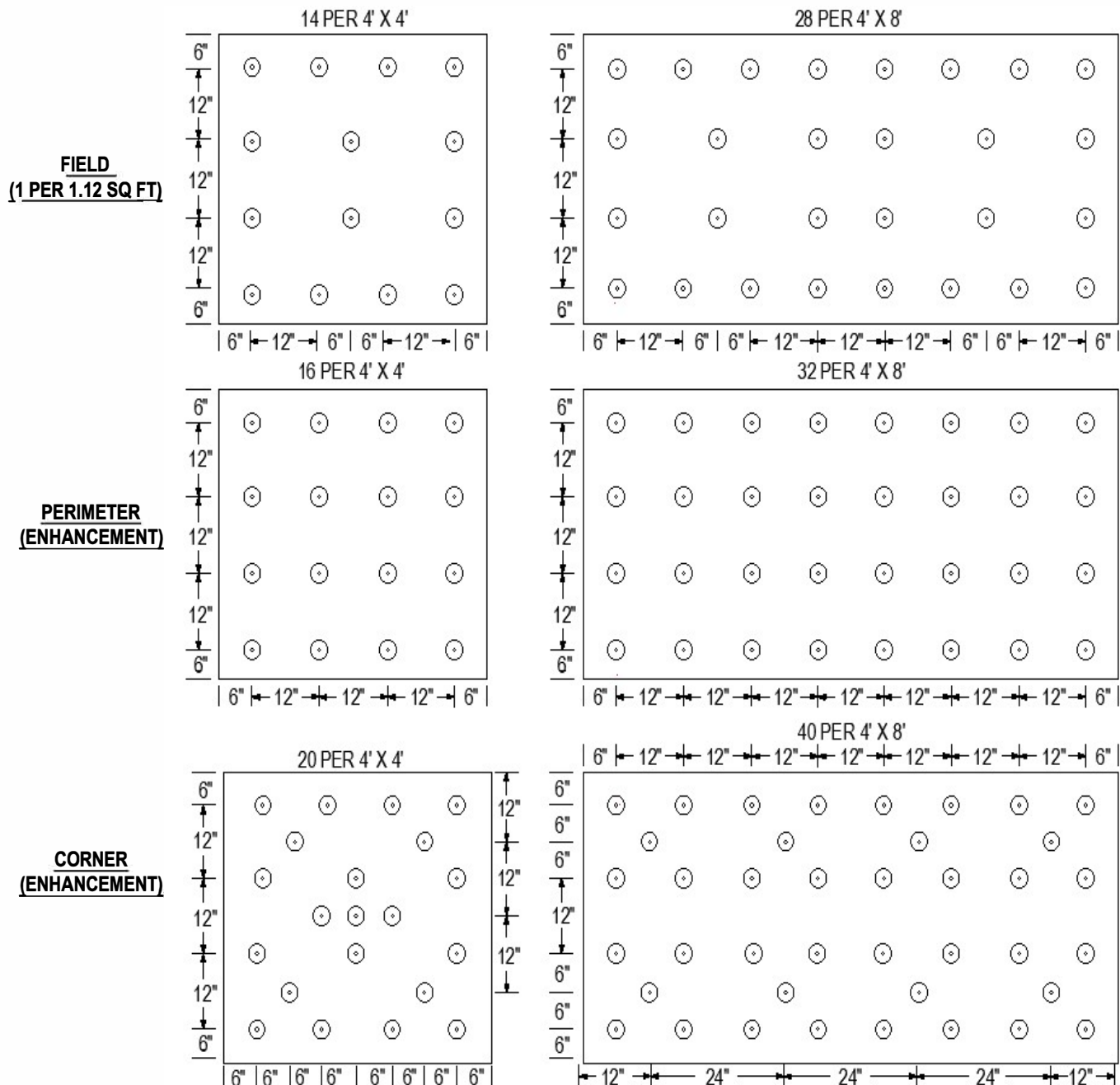

**NOTES:**

1. FASTENING PATTERNS ARE PROVIDED AS GUIDELINES FOR FASTENER PLACEMENT FOR MECHANICALLY ATTACHED INSULATION OR COVER BOARD UNDER A FULLY ADHERED MEMBRANE SYSTEM.
2. AN APPROVED COVER BOARD IS REQUIRED FOR EPS, XPS, & POLYISOCYANURATE INSULATIONS NOT APPROVED BY IB ROOF SYSTEMS.
3. REFER TO TABLE A.2 FOR MINIMUM REQUIREMENTS FOR INSULATION FASTENER SCHEDULE FOR ADHERED IB ROOF MEMBRANES.

Scale: NTS	Detail Name: <b>1 Per 1.12 Fastening Patterns for Insulation/Cover Board</b>	Detail Number: <b>FA-AT-11</b>
Submitted By: Address: Telephone:		Project: Address:



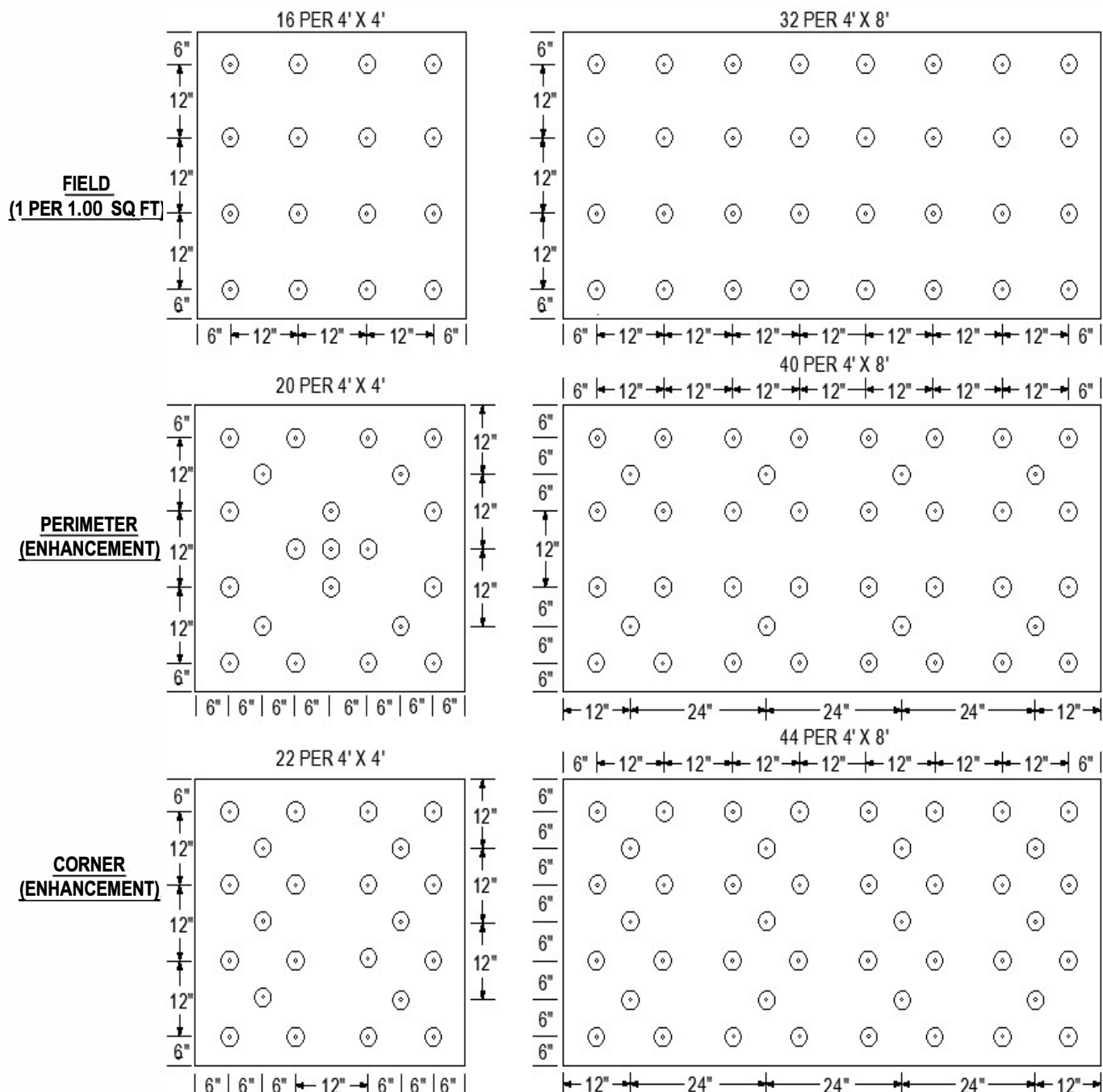

**NOTES:**

1. FASTENING PATTERNS ARE PROVIDED AS GUIDELINES FOR FASTENER PLACEMENT FOR MECHANICALLY ATTACHED INSULATION OR COVER BOARD UNDER A FULLY ADHERED MEMBRANE SYSTEM.
2. AN APPROVED COVER BOARD IS REQUIRED FOR EPS, XPS, & POLYISOCYANURATE INSULATIONS NOT APPROVED BY IB ROOF SYSTEMS.
3. REFER TO TABLE A.2 FOR MINIMUM REQUIREMENTS FOR INSULATION FASTENING SCHEDULE FOR ADHERED IB ROOF MEMBRANES

Scale: NTS	Detail Name: <b>1 Per 1 Fastening Patterns for Insulation/Cover Board</b>	Detail Number: <b>FA-AT-12</b>
Submitted By: Address: Telephone:		Project: Address:

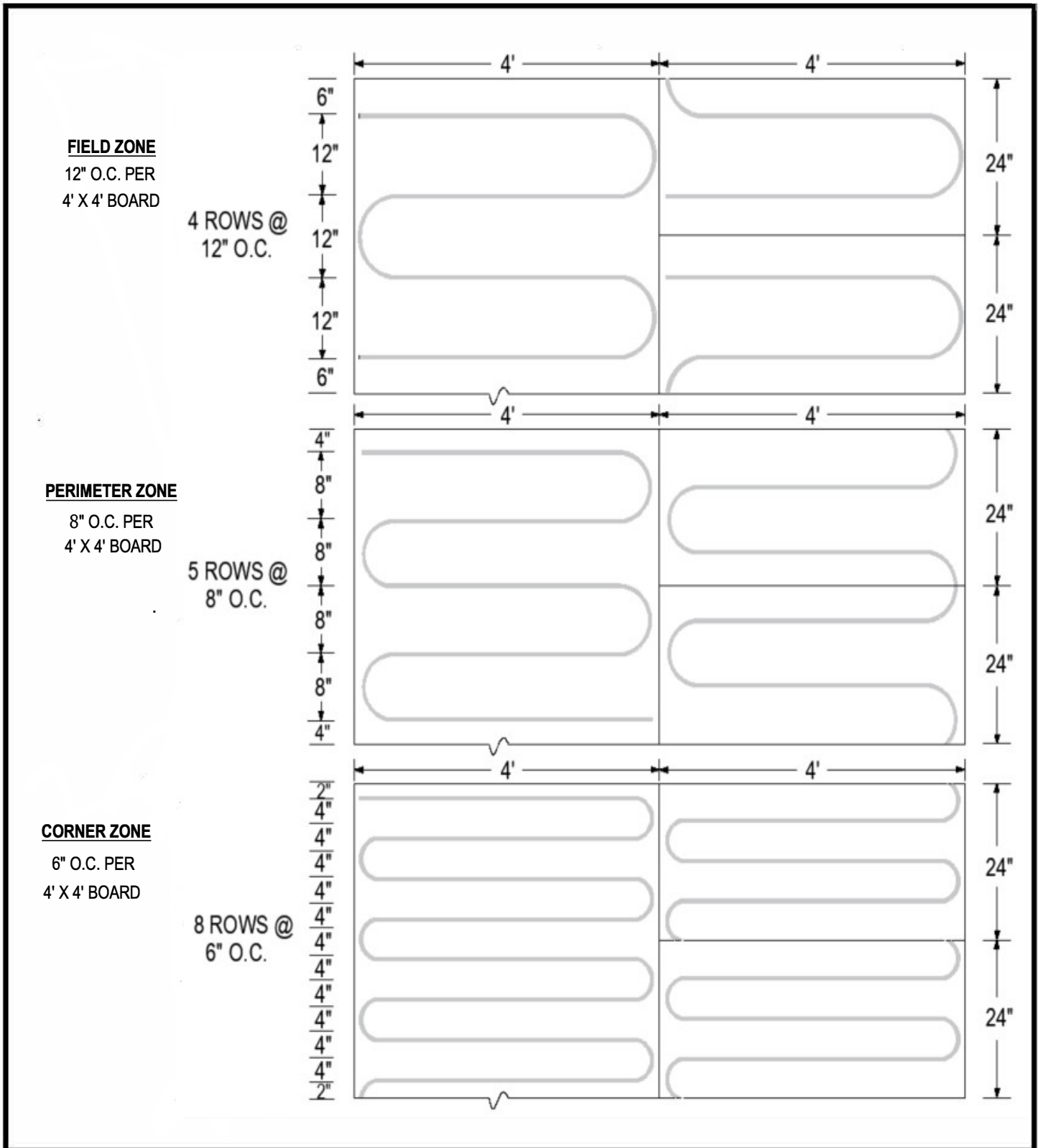

Scale: NTS	Detail Name: <b>Ribbon Adhesive Layout - 4' x 4'</b>	Detail Number: <b>FA-AT-13</b>
Submitted By: Address: Telephone:		Project: Address:

**FIELD ZONE**  
12" O.C. PER  
4' X 8' BOARD

8 ROWS @  
12" O.C.

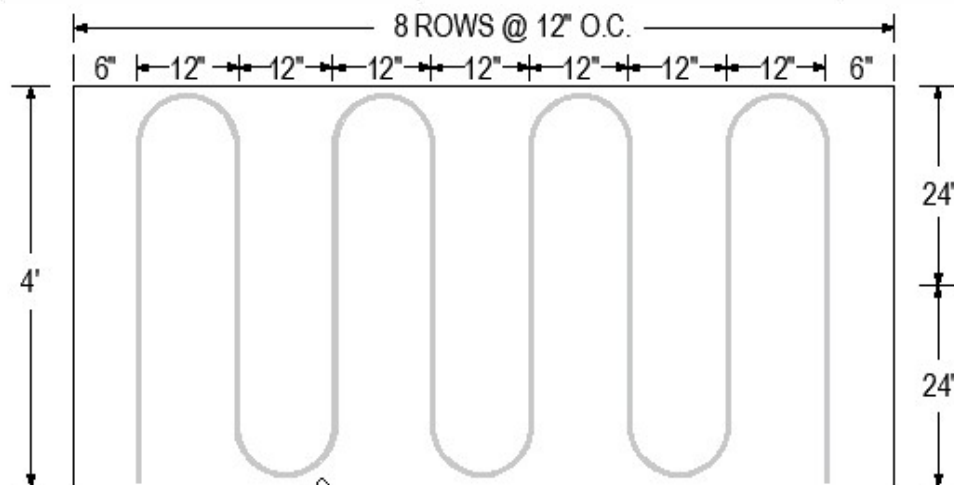

**PERIMETER ZONE**  
8" O.C. PER  
4' X 8' BOARD

11 ROWS @  
8" O.C.

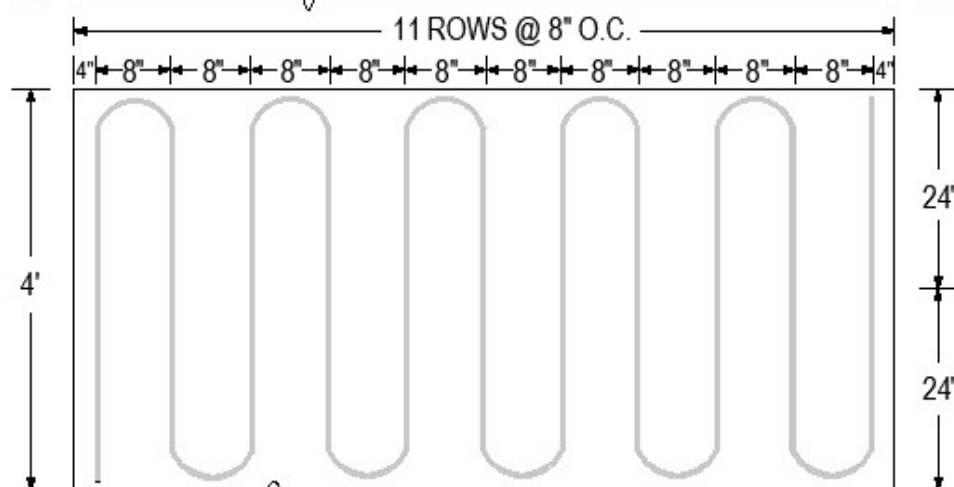

**CORNER ZONE**  
6" O.C. PER  
4' X 8' BOARD

16 ROWS @  
6" O.C.

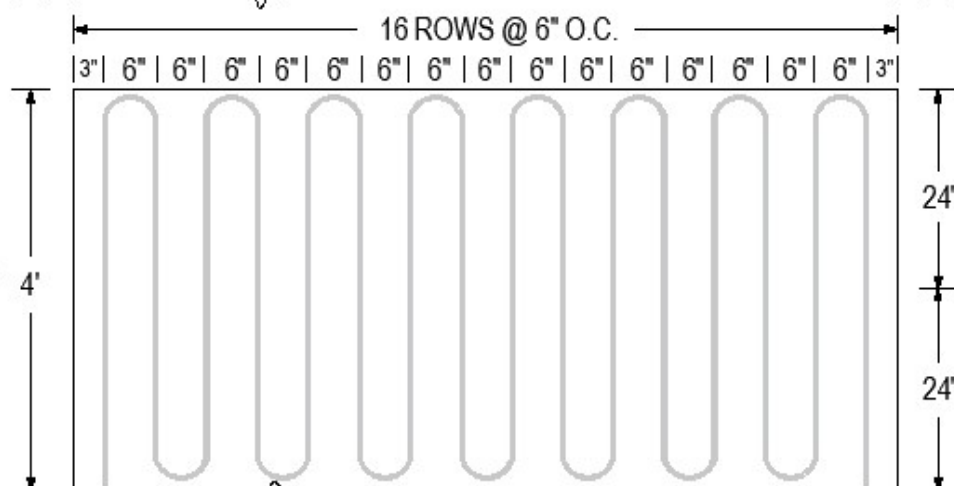

Scale:  
NTS

Detail Name:

**Ribbon Adhesive Layout - 4'x 8'**

Detail Number:

**FA-AT-14**

Submitted By:  
Address:  
Telephone:

Project:  
Address:

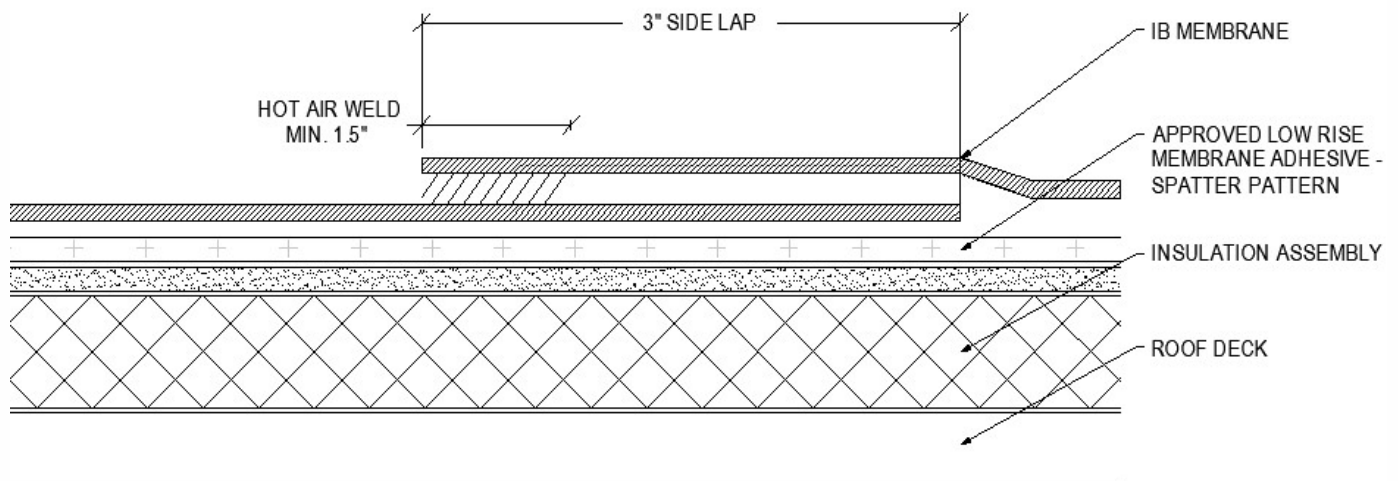
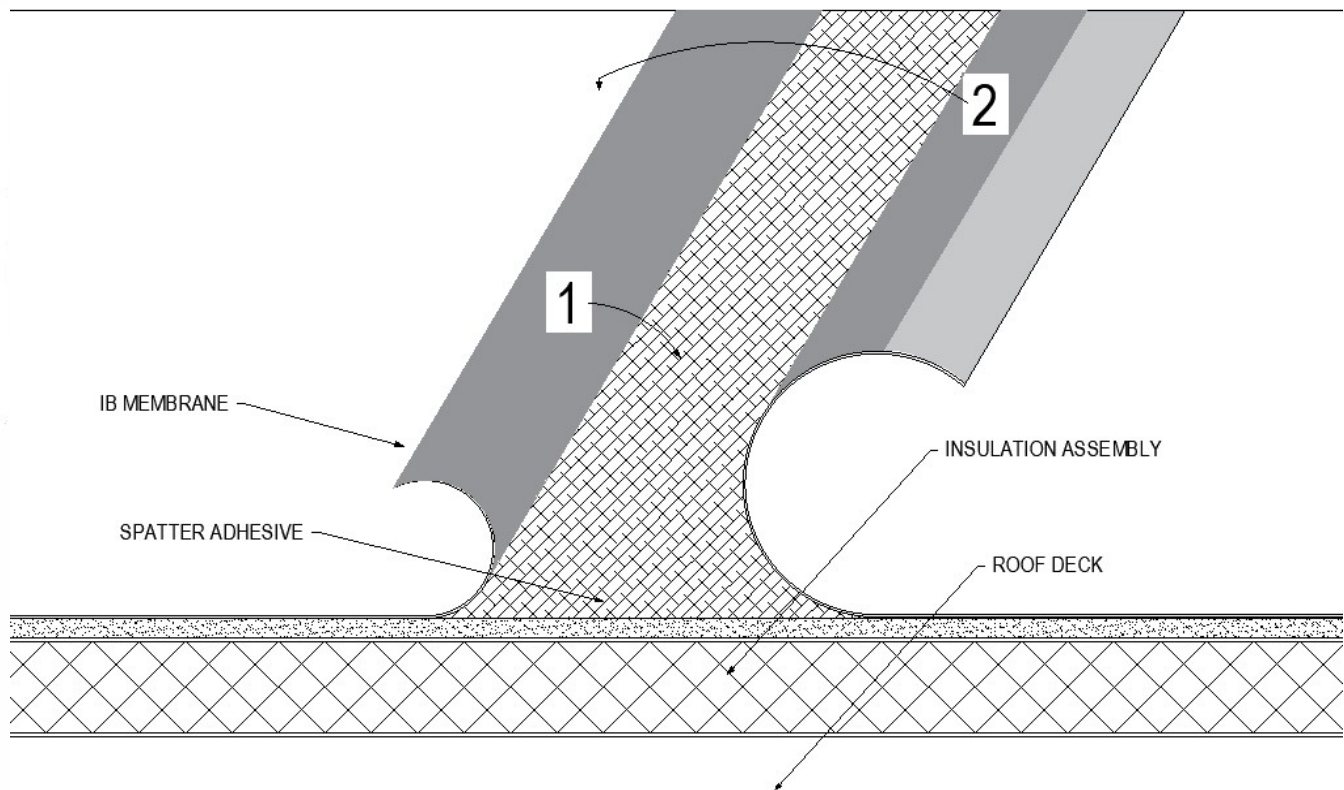

Scale: NTS	Detail Name: <b>Spatter Adhesive Membrane Sheet Layout</b>	Detail Number: <b>FA-AT-15</b>
Submitted By: Address: Telephone:	Project: Address:	

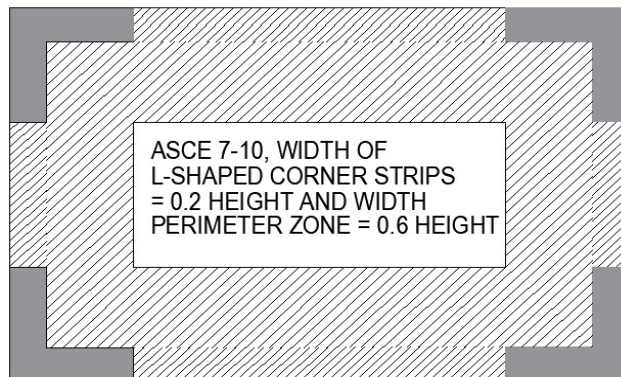
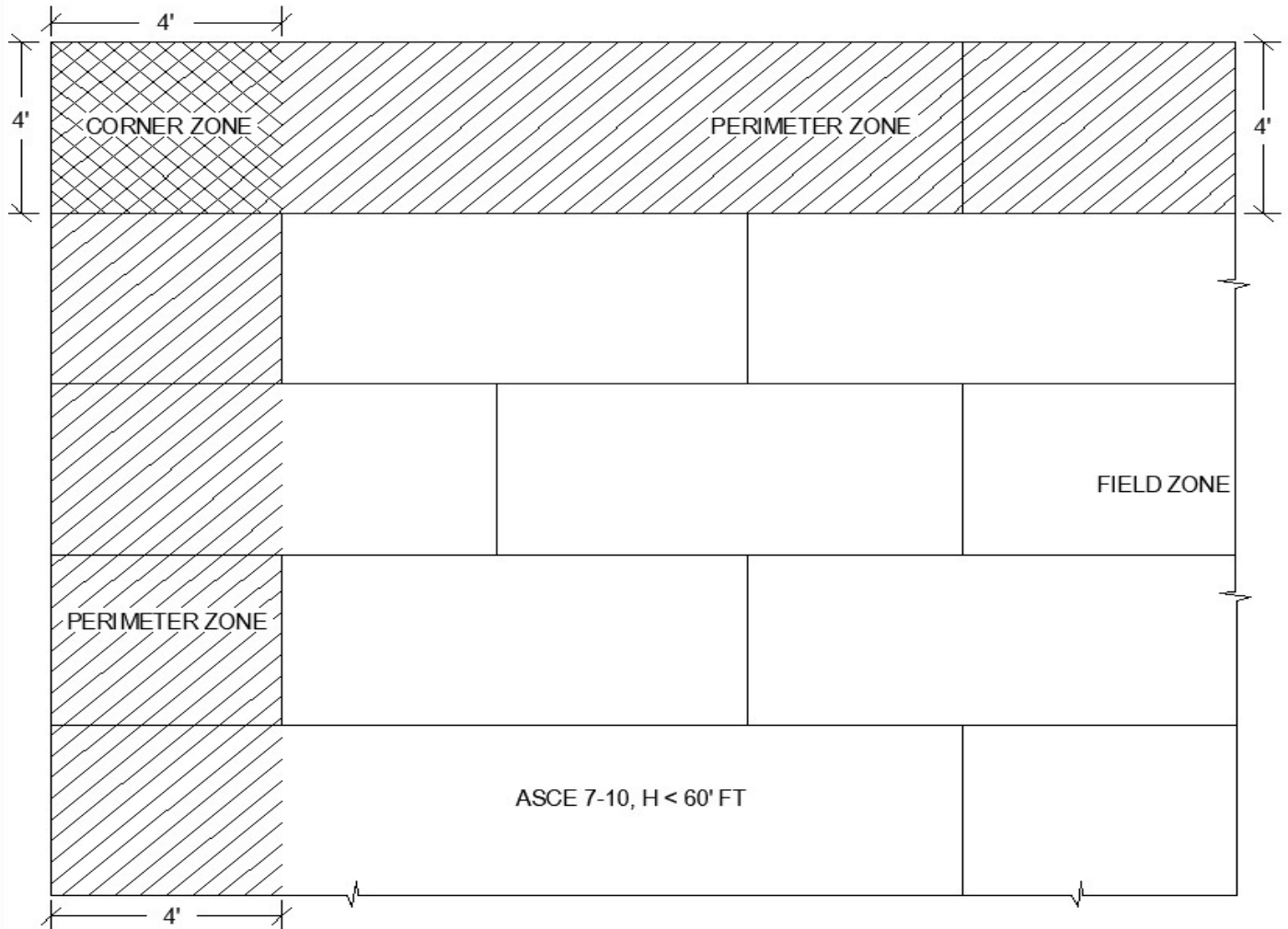

**NOTE:**

- 1 REFER TO TABLE A.7 FOR WIND RESISTANCE ENHANCEMENTS AT FIELD, PERIMETER, AND CORNER ZONE AREAS - STANDARD RECTANGULAR BUILDINGS WITH ROOF ANGLES 0° TO 7°

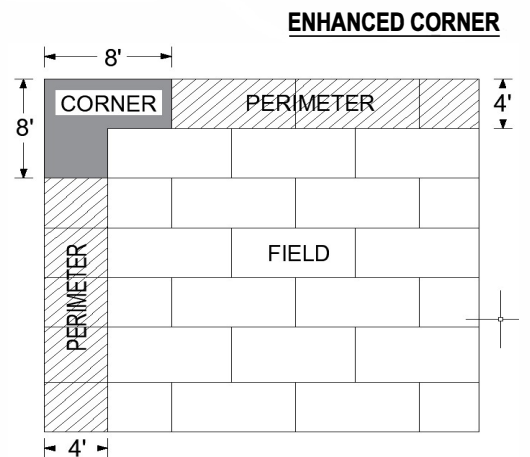

ASCE 7-10,  $h \geq 60'$  FT

Scale: NTS	Detail Name: <b>4 Foot Zone Layout</b>	Detail Number: <b>FA-AT-16</b>
Submitted By: Address: Telephone:		Project: Address:



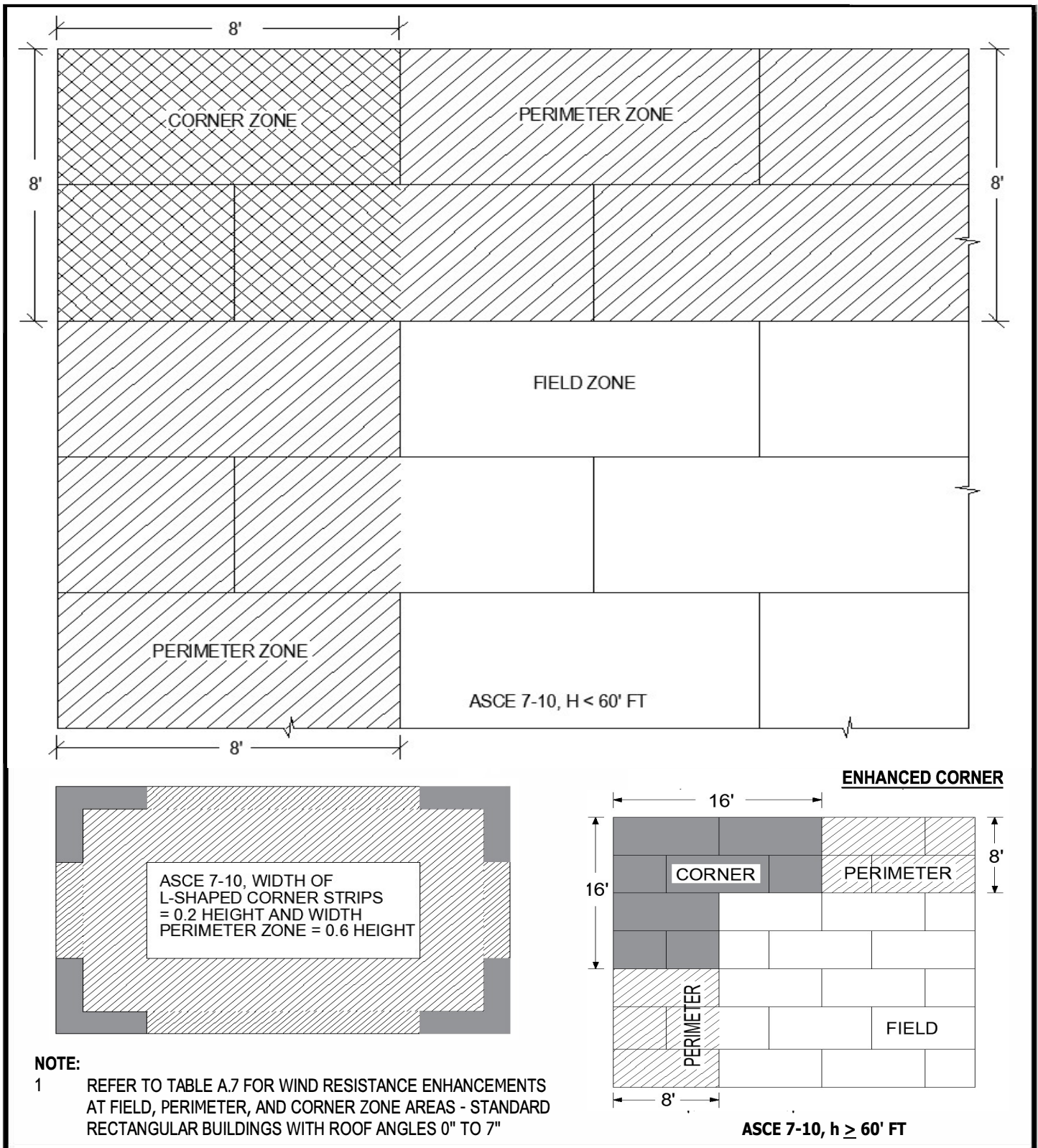

Scale: NTS	Detail Name: <b>8 Foot Zone Layout</b>	Detail Number: <b>FA-AT-17</b>
Submitted By: Address: Telephone:		Project: Address:

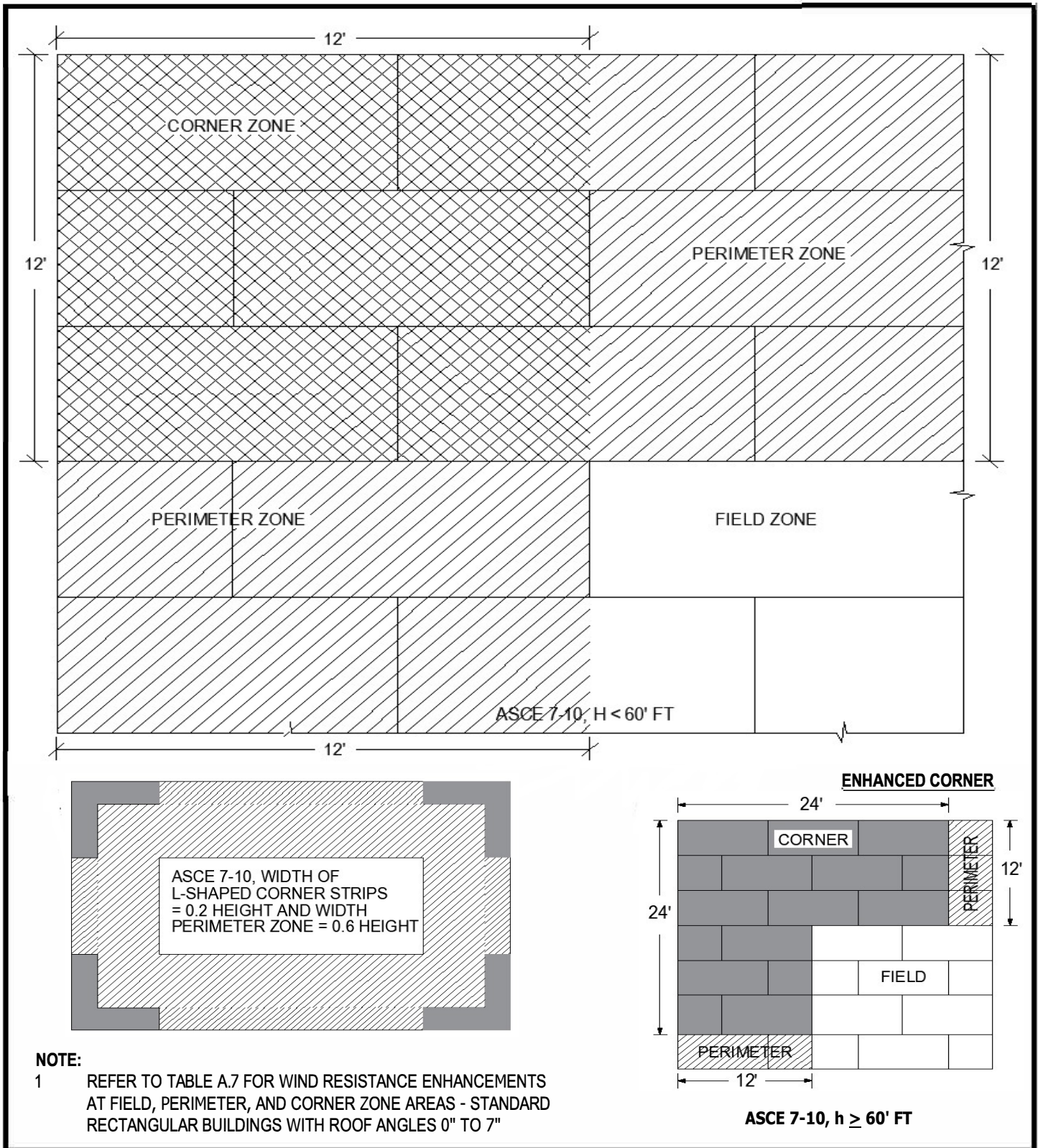

Scale: NTS	Detail Name: <b>12 Foot Zone Layout</b>	Detail Number: <b>FA-AT-18</b>
Submitted By: Address: Telephone:	Project: Address:	



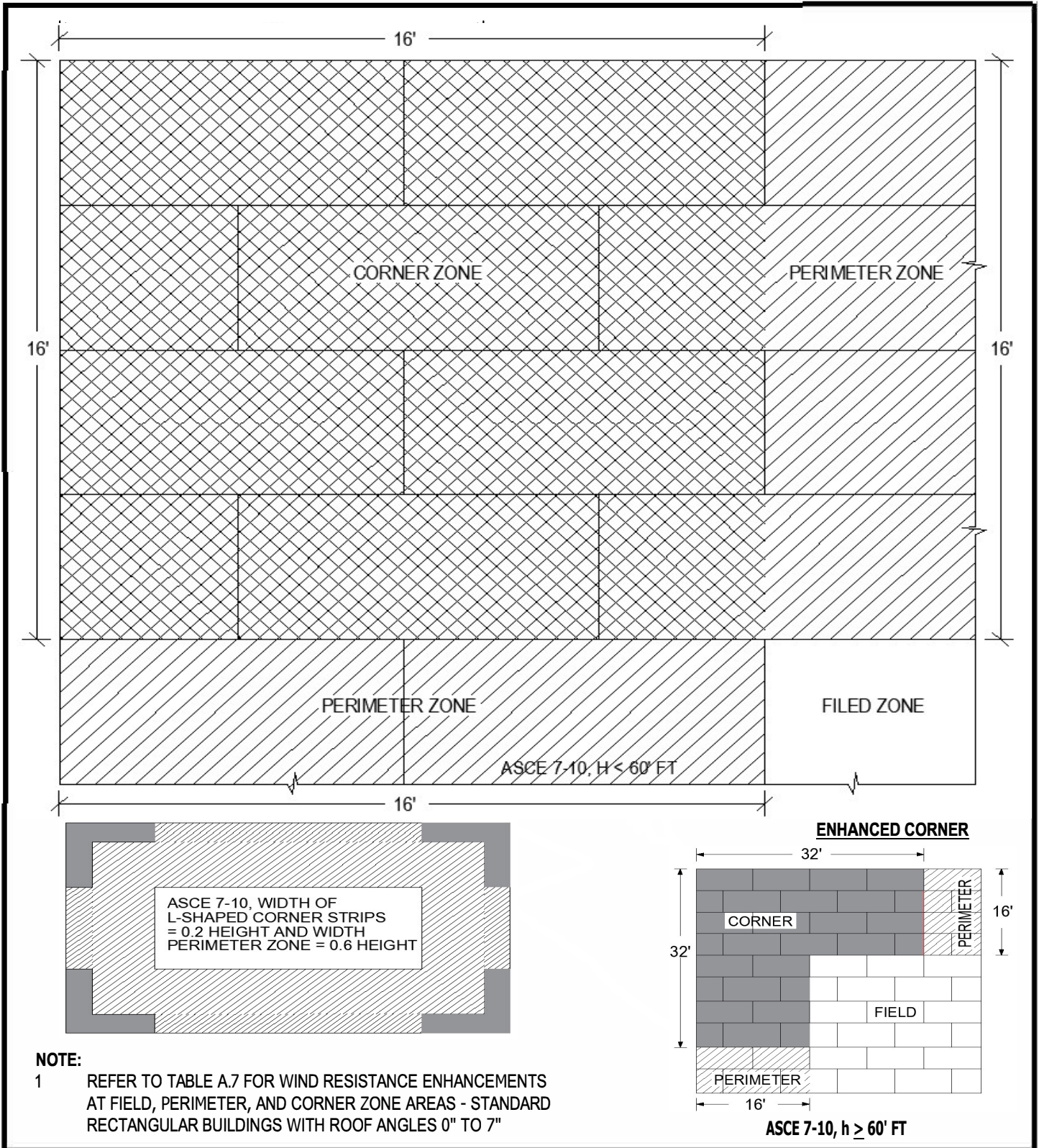

Scale: NTS	Detail Name: <b>16 Foot Zone Layout</b>	Detail Number: <b>FA-AT-19</b>
Submitted By: Address: Telephone:	Project: Address:	



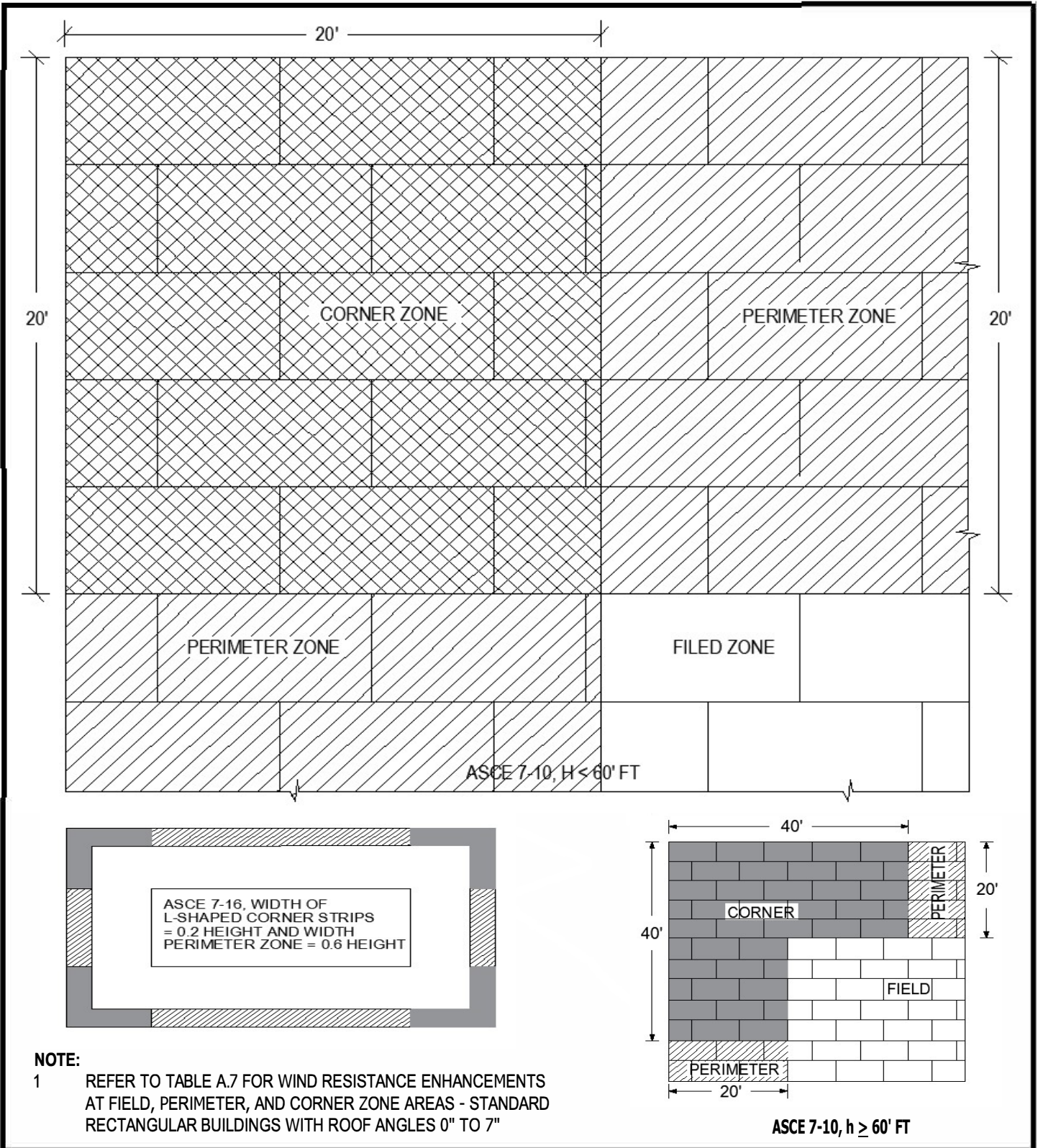

Scale: NTS	Detail Name: <b>20 Foot Zone Layout</b>	Detail Number: <b>FA-AT-20</b>
Submitted By: Address: Telephone:	Project: Address:	

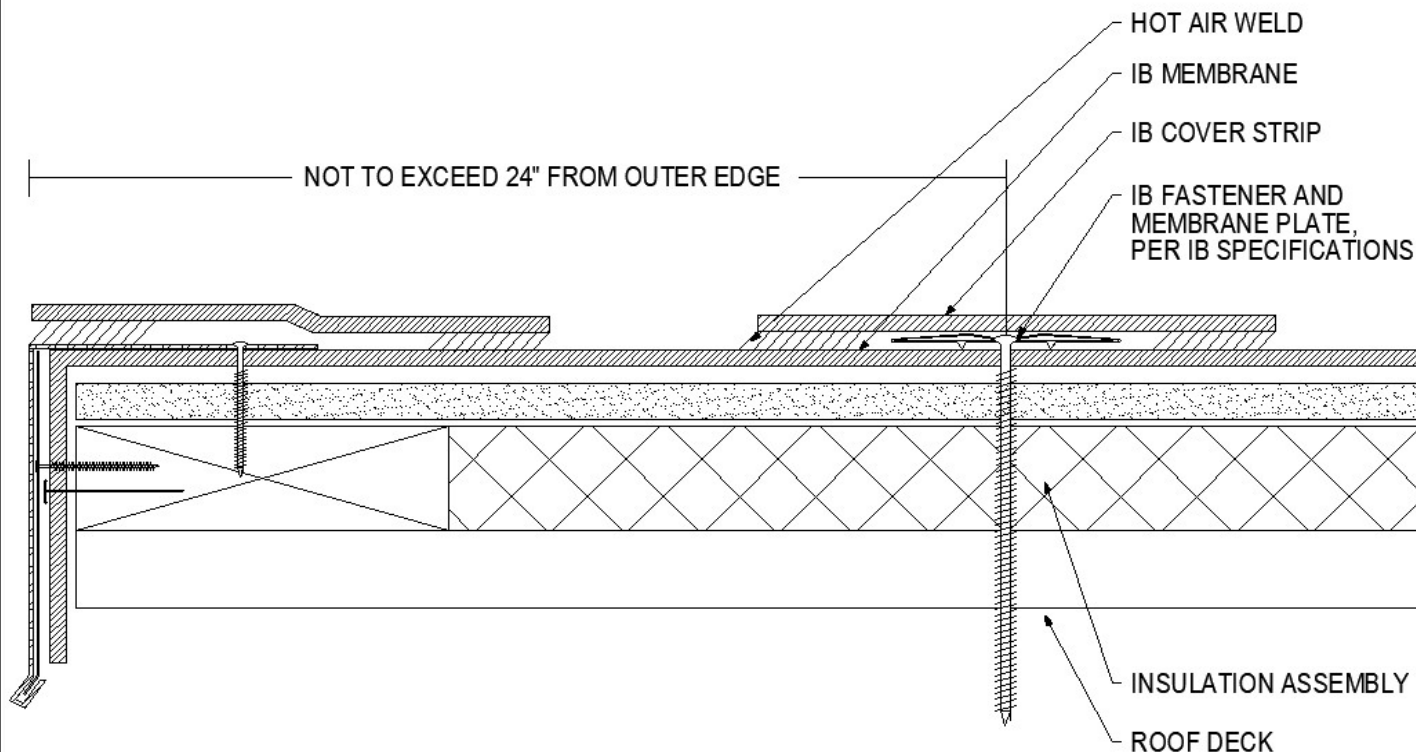

**NOTES:**

INSTALL IB APPROVED PEEL STOP DETAIL ON ALL FULLY ADHERED IB ROOF ASSEMBLIES WHERE THE FOLLOWING CONDITIONS OCCUR:

1. WIND RIDER WARRANTY IN EXCESS OF STANDARD PUBLISHED IB WARRANTY TERMS AND CONDITIONS
2. FACTORY MUTUAL PROJECTS WHERE REQUIRED BY FM INSTALLATION GUIDELINES
3. ROOF INSTALLATIONS WHERE:
  - A. BASIC WIND SPEED ZONE GREATER THAN ASCE 7-10 115 MPH (ASCE 7-05 90 MPH) WHERE ONE OR MORE OF THE FOLLOWING CONDITIONS OCCUR:
    - BUILDING CLASSIFICATION IS PARTIALLY ENCLOSED
    - DESIGN VELOCITY PRESSURES IS ABOVE -52.5 PSF
    - BUILDING LOCATED WITHIN SPECIAL WIND REGIONS OR HURRICANE ZONES
  - B. BASIC WIND SPEED ZONE LESS THAN OR EQUAL TO ASCE 7-10 115 MPH (ASCE 7-05 90 MPH) WHERE ONE OR MORE OF THE FOLLOWING CONDITIONS OCCUR:
    - ROOF HEIGHTS ABOVE 30' WITH PERIMETER METAL EDGE OR GUTTER DETAIL (NON-PARAPET WALL)
    - ALL ROOF HEIGHTS ABOVE 65'
    - BUILDING CLASSIFICATION IS PARTIALLY ENCLOSED
    - GUTTER OR EDGE DETAIL DOES NOT INCLUDE CONTINUOUS CLEAT

Scale: NTS	Detail Name: <b>Peel-Stop</b>	Detail Number: <b>FA-AT-21</b>
Submitted By: Address: Telephone:		Project: Address:

**IB MEMBRANE END LAPS**

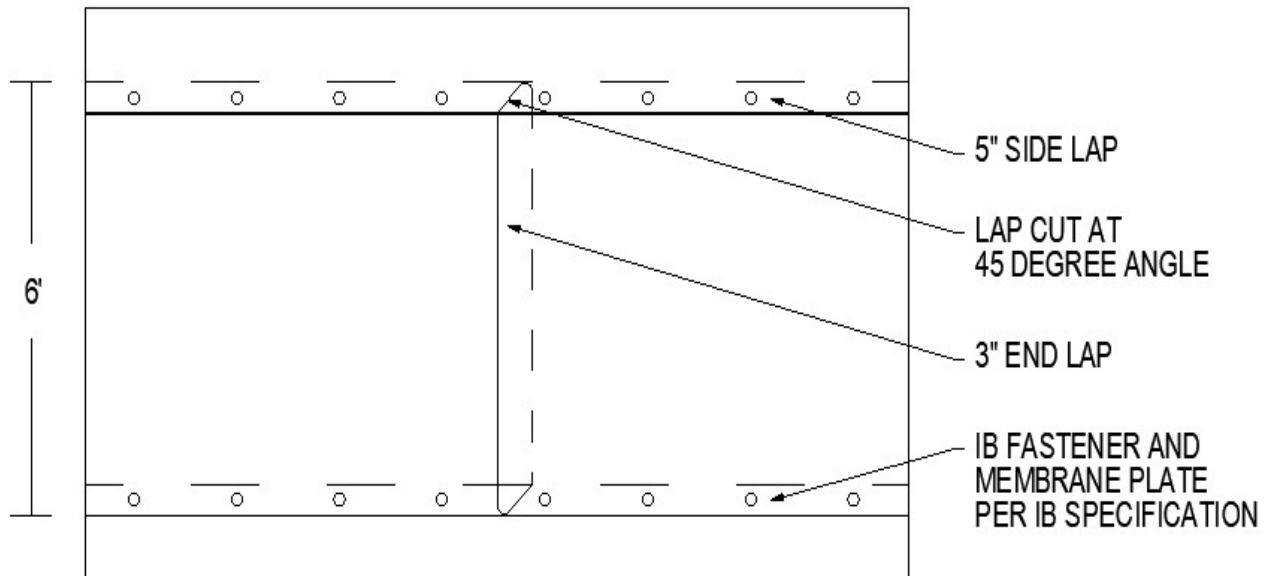

**IB FLEECKBACK MEMBRANE END LAPS**

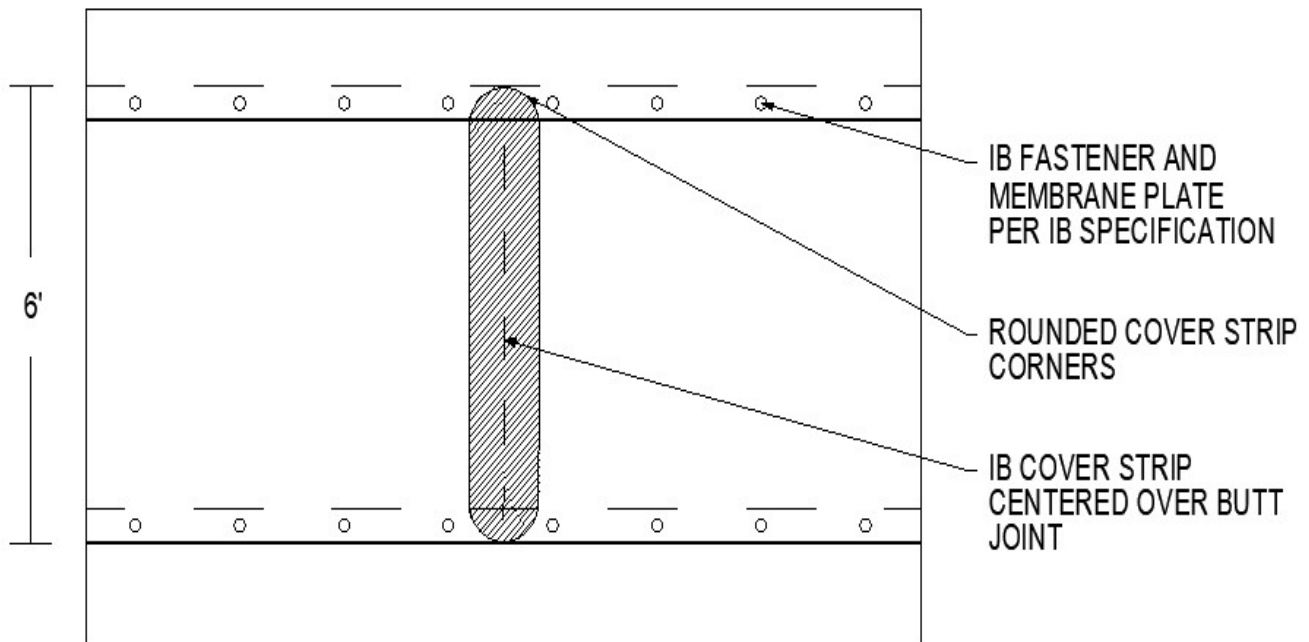

**NOTE:**

1. REFER TO IB ROUND T-JOINT PATCH DETAIL FOR IB 80 MIL SINGLE-PLY MEMBRANE

<b>Scale:</b> NTS	<b>Detail Name:</b> <b>Membrane End Laps for Fully Adhered Membrane</b>	<b>Detail Number:</b> <b>FA-AT-22</b>
<b>Submitted By:</b> Address: Telephone:		<b>Project:</b> Address:



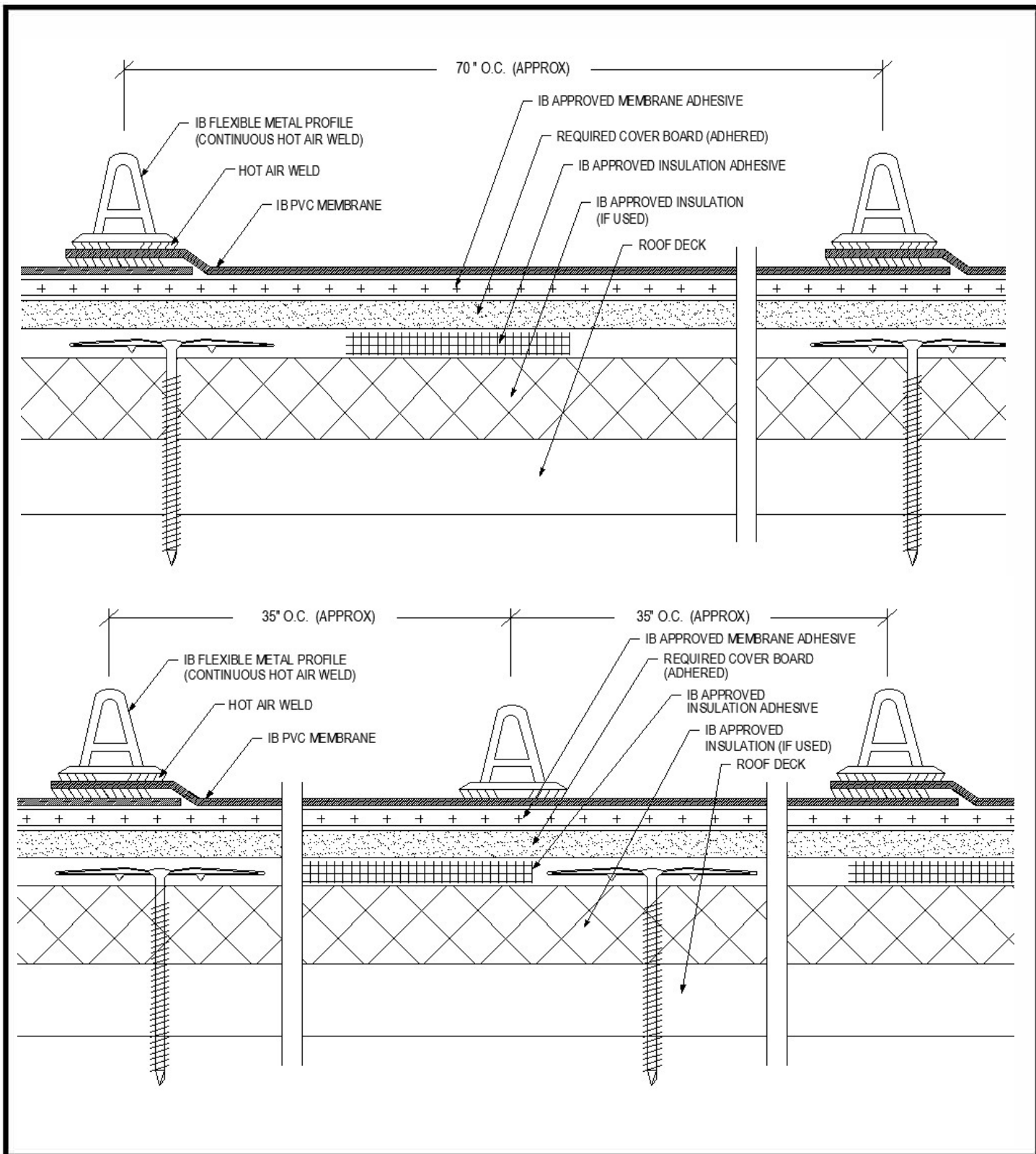

Scale:  
NTS

Detail Name:

**IB Flexible Metal Profile Layout - 1 & 2 per Sheet**

Detail Number:

**FA-AT-23**

Submitted By:  
Address:  
Telephone:

Project:  
Address:

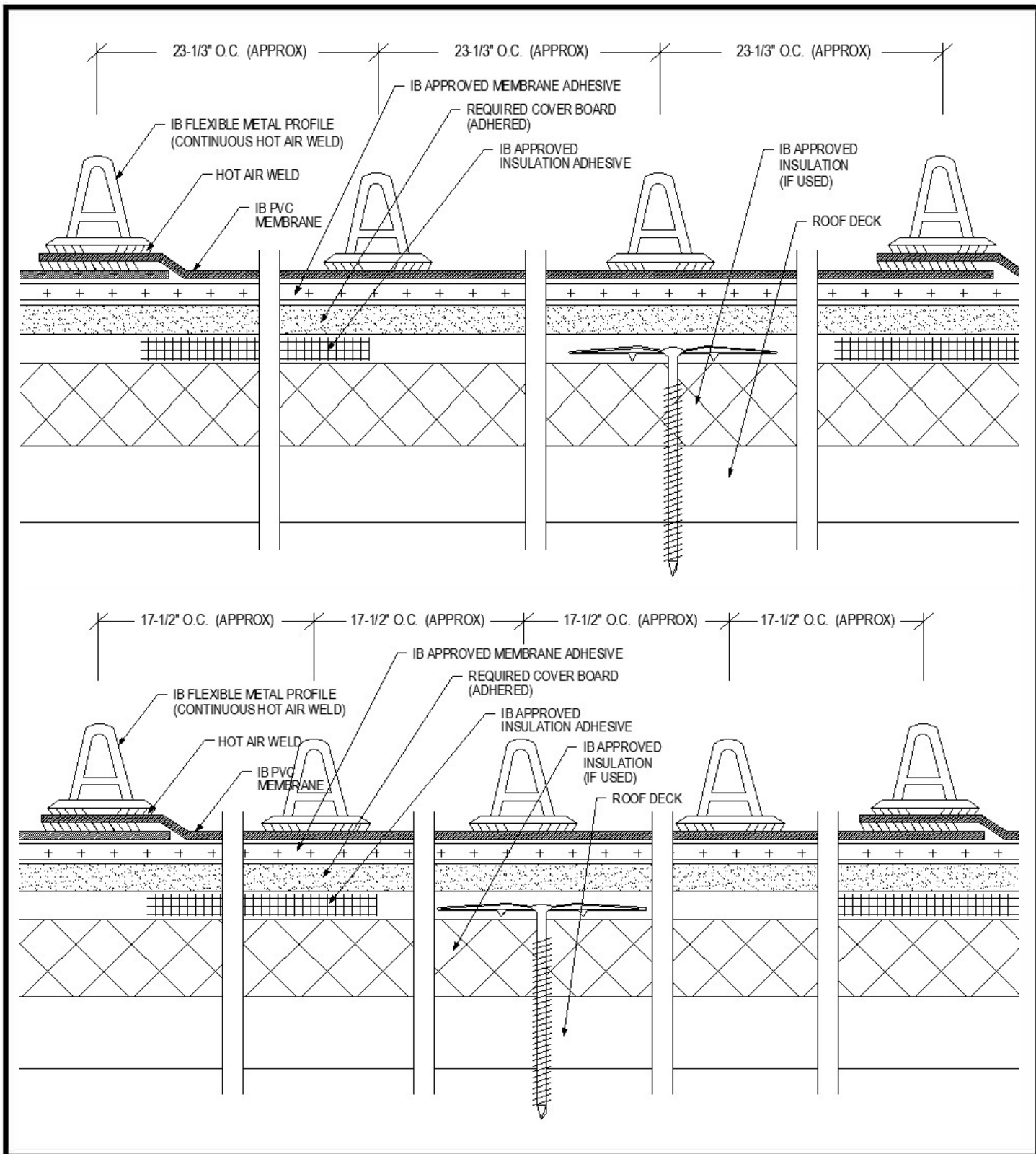

Scale: NTS	Detail Name: <b>IB Flexible Metal Profile Layout - 3 &amp; 4 per Sheet</b>	Detail Number: <b>FA-AT-24</b>
Submitted By: Address: Telephone:		Project: Address: