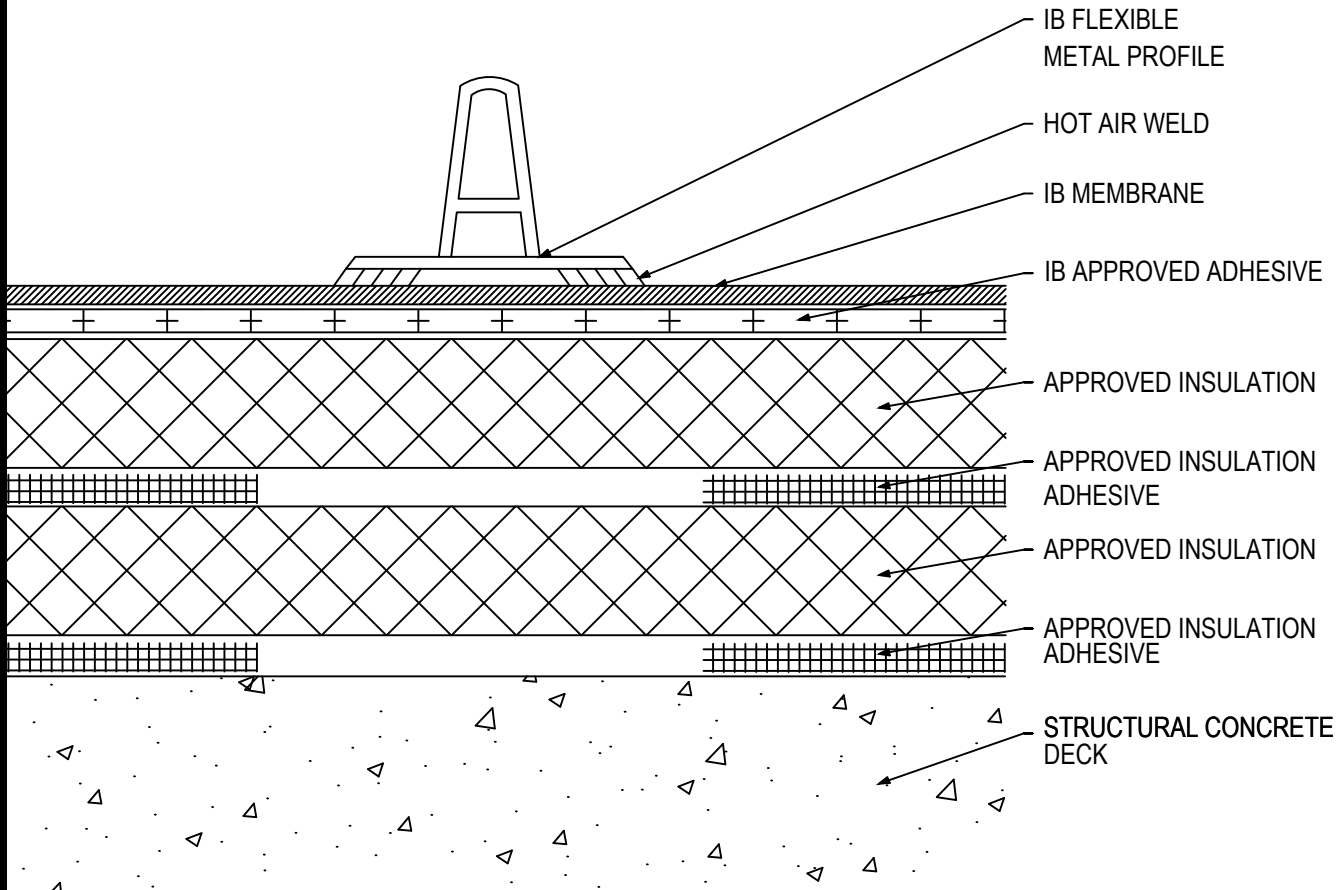

Flexible Metal Profile - Fully Adhered Membrane - Insulation (RB) - Insulation (RB) - Concrete Deck (New or Tear-Off)

Fire Rating / Max. Slope	Deck Type	Insulation			Insulation			IB Membrane Attachment	Max. Design Pressure**
		Type	Adhesive	Fastener	Type	Insulation Adhesive	Pattern		
<input type="checkbox"/> ¹ Class 'A' Unlimited	Structural Concrete	Min. 1" Approved Insulation	BM, CR20, OB500, OSFA, PG1, or RSIA	Four continuous ribbons, 12" o.c.	Min. 1" Approved Insulation	BM, CR20, OB500, OSFA, PG1, or RSIA	Four continuous ribbons, 12" o.c.	IB Approved Adhesive	Minimum Req for IB Warranty

Approved Insulation: IB EnergyBoard II or III, Atlas AC Foam II or III; H-Shield or H-Shield CG; or IB Approved UL Classified Polyisocyanurate
Approved Insulation Adhesive: BM = Polyset BoardMax, CR-20 = Polyset CR-20, OB500 = OlyBond 500 Adhesive Fastener, OSFA = Millennium One-Step Foamable Adhesive; PG-1 = Millennium PG-1 Pump Grade Adhesive; or RSIA = IB Rapid Set Insulation Adhesive; maximum bead spacing 12" o.c. unless otherwise indicated.
Fire Classification Note(s): ¹UL Class 'A' Classification with an unlimited slope when utilized with any UL Classified ISO insulation and membrane adhered using IB Vertibond 432 Bonding Adhesive at 1-gal/60-ft² or IB Water Borne 636 Adhesive at 1-gal/140-ft². ²UL Class 'A' up to 1-1/2":12" when utilized with any of the following IB Approved ISO Insulations: IB Energy Board II, IB Energy Board III, AC Foam II, or AC Foam III, any thickness and membrane adhered using IB Water Borne Adhesive. ³UL Class 'A' up to 1":12" when utilized with any of the following IB Approved ISO Insulations: H-Shield ISO or H-Shield CG, any thickness and membrane adhered using IB Water Borne Adhesive. ⁴UL Class 'C' Classification with an unlimited slope when utilized with any of the following IB Approved ISO Insulations: H-Shield ISO or H-Shield CG. ⁵Other IB Approved Insulations or lesser thicknesses may refer to Submittal Resistance table for required pull-out values.

For additional information about IB Roof Systems requirements, recommendations, installation details, approvals and limitations for the above assemblies, please refer to the latest edition of the IB Roof Systems Specifications Manual. For Technical Services please contact us at 800-426-1626.

Membranes:	Membrane Color:	Warranty Length***	Warranty Type***
<input type="checkbox"/> IB PVC Single-Ply 50 Mil	<input type="checkbox"/> White* <input type="checkbox"/> Gray <input type="checkbox"/> Tan <input type="checkbox"/> Bronze <input type="checkbox"/> ChemGuard*	<input type="checkbox"/> 10 Year <input type="checkbox"/> 15 Year <input type="checkbox"/> 20 Year	<input type="checkbox"/> Total System - No Dollar Limit (NDL)
<input type="checkbox"/> IB PVC Single-Ply 60 Mil	<input type="checkbox"/> White* <input type="checkbox"/> Cool Sand* <input type="checkbox"/> Cool Stone* <input type="checkbox"/> Gray <input type="checkbox"/> Tan	<input type="checkbox"/> 15 Year <input type="checkbox"/> 20 Year <input type="checkbox"/> 25 Year	<input type="checkbox"/> Warranty Plus (WP)
<input type="checkbox"/> IB PVC Single-Ply 80 Mil	<input type="checkbox"/> White* <input type="checkbox"/> Gray <input type="checkbox"/> Tan <input type="checkbox"/> Bronze <input type="checkbox"/> ChemGuard*	<input type="checkbox"/> 20 Year <input type="checkbox"/> 25 Year <input type="checkbox"/> 30 Year	<input type="checkbox"/> Commercial Limited Material Warranty (CLMW)
			<input type="checkbox"/> Residential Limited Material Warranty (RLMW)

* Meets CRRC, Title-24, & EnergyStar Standards

*** Refer to Warranty Selection Guide for Warranty Riders, Term Length Limitations, and eligibility requirements of the Warranty Program

Submitted By:
Address:
Email:

Project Name:
Address: