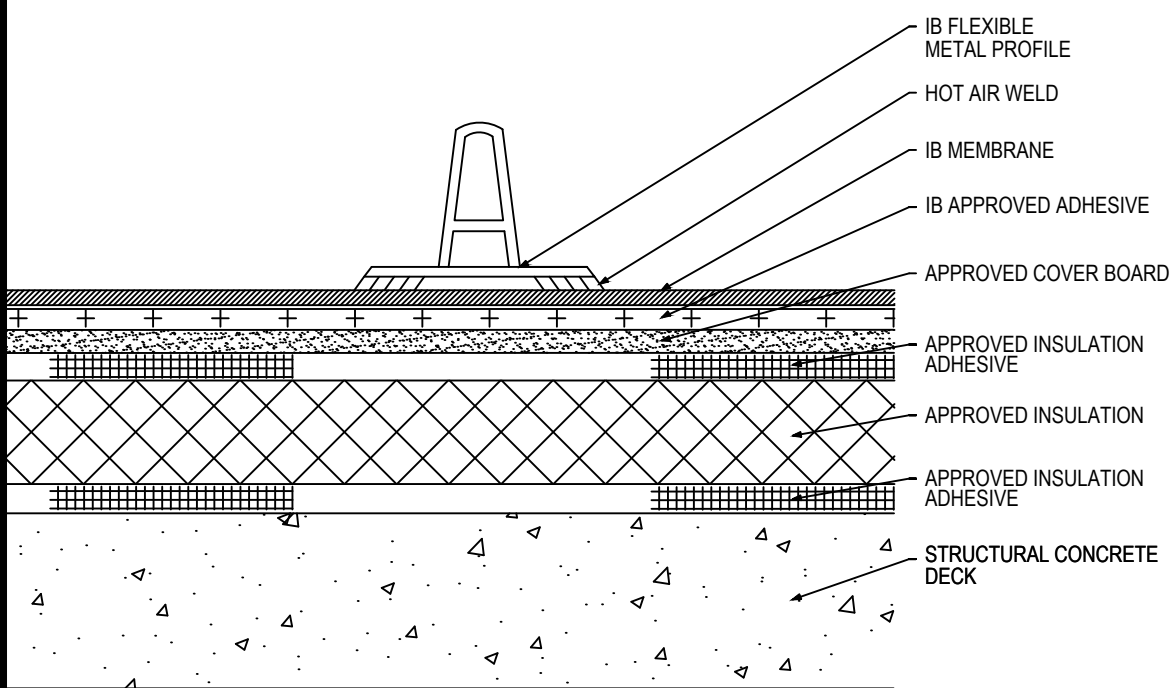

Flexible Metal Profile - Fully Adhered Membrane - Cover Board (RB) - Insulation (RB) - Concrete Deck (New or Tear-Off)

| Fire Rating / Max. Slope | Deck Type | Insulation | | | Cover Board | | | IB Membrane Attachment | Max. Design Pressure** |
|--|------------------------|------------------------|---|--------------------------------------|--|---|--------------------------------------|---------------------------|---------------------------|
| | | Type | Adhesive | Fastener | Type | Insulation Adhesive | Pattern | | |
| <input type="checkbox"/> ¹ Class 'A' Unlimited | Structural Concrete | Approved Insulation | BM, CR20, OB500, OSFA, PG1, or RSIA | Four continuous ribbons, 12" o.c. | Min. 1/4" DensDeck Prime | BM, CR20, OB500, OSFA, PG1, or RSIA | Four continuous ribbons, 12" o.c. | IB Approved Adhesive | -257.5 psf (Class 515) |
| <input type="checkbox"/> ¹ Class 'A' Unlimited | Structural Concrete | Approved Insulation | BM, CR20, OB500, OSFA, PG1, or RSIA | Four continuous ribbons, 12" o.c. | Min. 1/4" Securock Gypsum Fiber Board | BM, CR20, OB500, OSFA, PG1, or RSIA | Four continuous ribbons, 12" o.c. | IB Approved Adhesive | -267.5 psf (Class 535) |

Approved Insulation: IB EnergyBoard II or III, or IB Approved UL Classified Polyisocyanurate, IB Approved UL Classified Expanded Polystyrene, IB Approved UL Classified Extruded Polystyrene Insulation

Approved Cover Board: DensDeck Prime, Securock Gypsum Fiber Board, minimum 1/4" thickness; or minimum 1/2" IB HD ISO; or minimum 1/2" thick Structodek HD Primed

Approved Insulation Adhesive: BM = Polyset BoardMax, CR-20 = Polyset CR-20, OB500 = OlyBond 500 Adhesive Fastener, OSFA = Millennium One-Step Foamable Adhesive; PG-1 = Millennium PG-1 Pump Grade Adhesive; or RSIA = IB Rapid Set Insulation Adhesive; maximum bead spacing 12" o.c. unless otherwise indicated.

Fire Classification Note(s): ¹UL Class 'A' up with unlimited slope when utilized with minimum 1/4" gypsum cover board listed above. ²UL Class 'A' up to 1/2":12" when utilized with minimum 1/2" IB HD ISO or H-Shield HD ISO. ³The use of other IB Approved Cover Boards may not achieve UL classification.

**** Refer to Substrate Resistance table for required pull-out values.**

For additional information about IB Roof Systems requirements, recommendations, installation details, approvals and limitations for the above assemblies, please refer to the latest edition of the IB Roof Systems Specifications Manual. For Technical Services please contact us at 800-426-1626.

| Membranes: | Membrane Color: | Warranty Length*** | Warranty Type*** |
|---|---|--|---|
| <input type="checkbox"/> IB PVC Single-Ply 50 Mil | <input type="checkbox"/> White* <input type="checkbox"/> Gray <input type="checkbox"/> Tan <input type="checkbox"/> Bronze <input type="checkbox"/> ChemGuard* | <input type="checkbox"/> 10 Year <input type="checkbox"/> 15 Year <input type="checkbox"/> 20 Year | <input type="checkbox"/> Total System - No Dollar Limit (NDL) |
| <input type="checkbox"/> IB PVC Single-Ply 60 Mil | <input type="checkbox"/> White* <input type="checkbox"/> Cool Sand* <input type="checkbox"/> Cool Stone* <input type="checkbox"/> Gray <input type="checkbox"/> Tan | <input type="checkbox"/> 15 Year <input type="checkbox"/> 20 Year <input type="checkbox"/> 25 Year | <input type="checkbox"/> Warranty Plus (WP) |
| <input type="checkbox"/> IB PVC Single-Ply 80 Mil | <input type="checkbox"/> White* <input type="checkbox"/> Gray <input type="checkbox"/> Tan <input type="checkbox"/> Bronze <input type="checkbox"/> ChemGuard* | <input type="checkbox"/> 20 Year <input type="checkbox"/> 25 Year <input type="checkbox"/> 30 Year | <input type="checkbox"/> Commercial Limited Material Warranty (CLMW) |
| | | | <input type="checkbox"/> Residential Limited Material Warranty (RLMW) |

* Meets CRRC, Title-24, & EnergyStar Standards

*** Refer to Warranty Selection Guide for Warranty Riders, Term Length Limitations, and eligibility requirements of the Warranty Program

Submitted By:
Address:
Email:
Project Name:
Address: