

Fully Adhered Membrane - Insulation (RB) - Existing Roof - Wood Deck (New or Tear-Off)

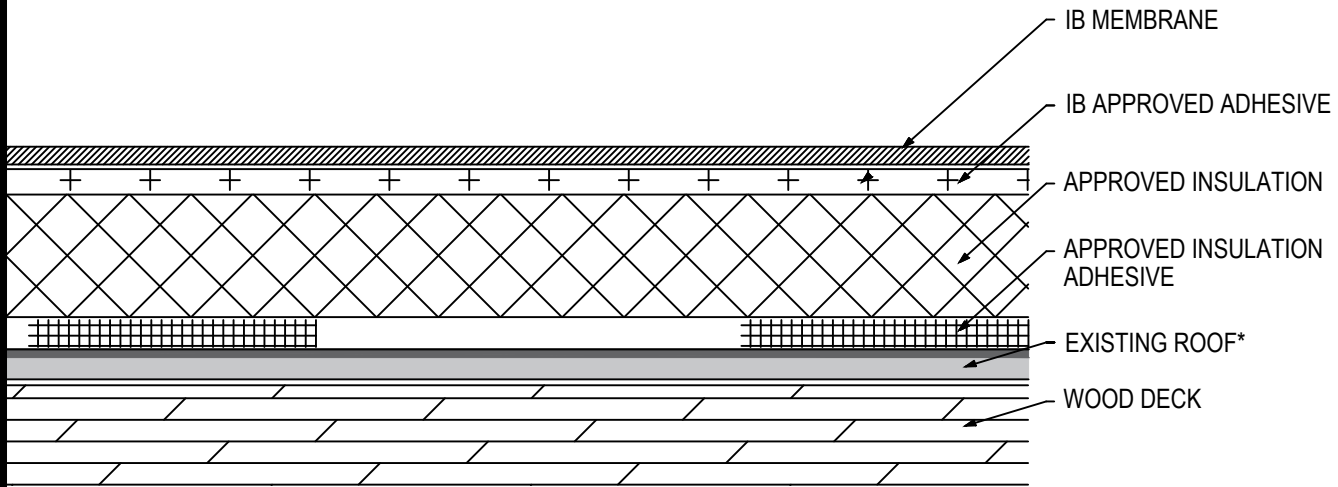

Fire Rating / Max. Slope	Deck Type	Insulation (over Existing Asphaltic Roof)			IB Membrane Attachment	Max. Design Pressure**
		Type	Insulation Attachment	Fasteners		
<input type="checkbox"/> Not Rated	7/16" OSB	1" Approved Insulation	BM, CR20, OB500, OSFA, PG1 or RSIA	Four Continuous Ribbons, 12" o.c.	IB Approved Adhesive	Minimum Req. for IB Warranty
<input type="checkbox"/> Not Rated	1/2" Plywood	1" Approved Insulation	BM, CR20, OB500, OSFA, PG1 or RSIA	Four Continuous Ribbons, 12" o.c.	IB Approved Adhesive	Minimum Req. for IB Warranty

Existing Roof: APP or SBS modified bitumen, smooth or granule surfaced asphaltic built-up roof only.

Approved Insulation: IB EnergyBoard II or III, Atlas AC Foam II or III; H-Shield, or H-Shield CG

Approved Insulation Adhesive: BM = Polyset BoardMax, CR-20 = Polyset CR-20, OB500 = OlyBond 500 Adhesive Fastener, OSFA = Millennium One-Step Foamable Adhesive; PG-1 = Millennium PG-1 Pump Grade Adhesive; or RSIA = IB Rapid Set Insulation Adhesive; maximum bead spacing 12" o.c.

Fire Classification Note(s): This assembly is not UL Classified.

**** Refer to Substrate Resistance table for required pull-out values.**

For additional information about IB Roof Systems requirements, recommendations, installation details, approvals and limitations for the above assemblies, please refer to the latest edition of the IB Roof Systems Specifications Manual. For Technical Services please contact us at 800-426-1626.

Membranes:	Membrane Color:	Warranty Length***	Warranty Type***
<input type="checkbox"/> IB PVC Single-Ply 50 Mil	<input type="checkbox"/> White* <input type="checkbox"/> Gray <input type="checkbox"/> Tan <input type="checkbox"/> Bronze <input type="checkbox"/> ChemGuard*	<input type="checkbox"/> 10 Year <input type="checkbox"/> 15 Year <input type="checkbox"/> 20 Year	<input type="checkbox"/> Total System - No Dollar Limit (NDL)
<input type="checkbox"/> IB PVC Single-Ply 60 Mil	<input type="checkbox"/> White* <input type="checkbox"/> Cool Sand* <input type="checkbox"/> Cool Stone* <input type="checkbox"/> Gray <input type="checkbox"/> Tan	<input type="checkbox"/> 15 Year <input type="checkbox"/> 20 Year <input type="checkbox"/> 25 Year	<input type="checkbox"/> Warranty Plus (WP)
<input type="checkbox"/> IB PVC Single-Ply 80 Mil	<input type="checkbox"/> White* <input type="checkbox"/> Gray <input type="checkbox"/> Tan <input type="checkbox"/> Bronze <input type="checkbox"/> ChemGuard*	<input type="checkbox"/> 15 Year <input type="checkbox"/> 20 Year <input type="checkbox"/> 25 Year	<input type="checkbox"/> Commercial Limited Material Warranty (CLMW)
			<input type="checkbox"/> Residential Limited Material Warranty (RLMW)

* Meets CRRC, Title-24, & EnergyStar Standards

*** Refer to Warranty Selection Guide for Warranty Riders, Term Length Limitations, and eligibility requirements of the Warranty Program

Submitted By:

Address:

Email:

Project Name:

Address:

