

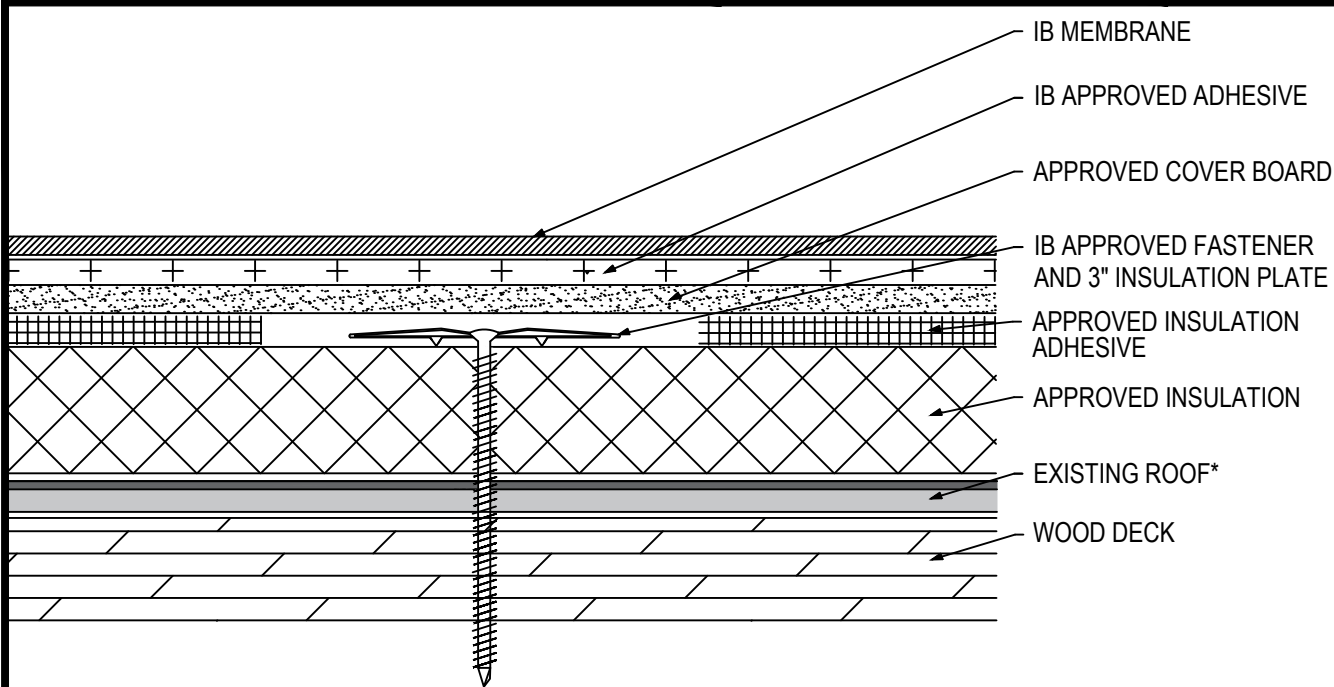





Fully Adhered Membrane - Cover Board (RB) - Insulation (MA) - Existing Roof - Wood Deck (New or Tear-Off)

Fire Rating / Max. Slope		Deck Type	Insulation (over Existing Roof)			Cover Board			IB Membrane Attachment	Max. Design Pressure**
			Type	Attachment	Fastener	Type	Insulation Adhesive	Fasteners		
	1Not Rated	7/16" OSB	Approved Insulation	16 per 4' x 8' (1 per 2 sq. ft.)	Min. IB SD #12 or HD #14, 3" IB Insulation Plate	Min. Approved 1/4" Cover Board	BM, CR20, OB500, OSFA, PG1, or RSIA	Four continuous ribbons, 12" o.c.	IB Approved Adhesive	Minimum Req. for IB Warranty
	1Not Rated	1/2" Plywood	Approved Insulation	10 per 4' x 8' (1 per 3.2 sq. ft.)	Min. IB SD #12 or HD #14, 3" IB Insulation Plate	Min. Approved 1/4" Cover Board	BM, CR20, OB500, OSFA, PG1, or RSIA	Four continuous ribbons, 12" o.c.	IB Approved Adhesive	Minimum Req. for IB Warranty
	1Not Rated	1/2" Plywood	Min. 1.5" Approved Insulation	20 per 4' x 8' (1 per 1.6 sq. ft.)	Min. IB SD #12 or HD #14, 3" IB Insulation Plate	Min. Approved 1/4" Cover Board	BM, CR20, OB500, OSFA, PG1, or RSIA	Four continuous ribbons, 12" o.c.	IB Approved Adhesive	-45.0 psf (Class 90)
	1Not Rated	19/32" Plywood	Min. 1.5" Approved Insulation	24 per 4' x 8' (1 per 1.3 sq. ft.)	Min. IB XHD #15, 3" IB Insulation Plate	Min. Approved 1/4" Cover Board	BM, CR20, OB500, OSFA, PG1, or RSIA	Four continuous ribbons, 12" o.c.	IB Approved Adhesive	-75.0 psf (Class 150)
	1Not Rated	19/32" Plywood	Min. 1.5" Approved Insulation	24 per 4' x 8' (1 per 1.3 sq. ft.)	Min. IB XHD #15, 3" IB Insulation Plate	Min. Approved 1/4" Cover Board	BM, CR20, OB500, OSFA, PG1, or RSIA	Four continuous ribbons, 12" o.c.	IB Approved Adhesive	-75.0 psf (Class 150)

Existing Roof: APP or SBS modified bitumen, smooth or granule surfaced asphaltic built-up roof, or single-ply membrane (CPA, CSPE, EPDM, PVC, or TPO)
Approved Insulation: IB EnergyBoard II or III, or IB Approved UL Classified Polyisocyanurate, IB Approved UL Classified Extruded Polystyrene, IB Approved UL Classified Insulation
Approved Cover Board: DensDeck Prime, Securock Gypsum Fiber Board, minimum 1/4\"/>

For additional information about IB Roof Systems requirements, recommendations, installation details, approvals and limitations for the above assemblies, please refer to the latest edition of the IB Roof Systems Specifications Manual. For Technical Services please contact us at 800-426-1626.

Membranes:	Membrane Color:	Warranty Length***	Warranty Type***
<input type="checkbox"/> IB PVC Single-Ply 50 Mil <input type="checkbox"/> IB PVC Single-Ply 60 Mil <input type="checkbox"/> IB PVC Single-Ply 80 Mil	<input type="checkbox"/> White* <input type="checkbox"/> Gray <input type="checkbox"/> Tan <input type="checkbox"/> Bronze <input type="checkbox"/> ChemGuard* <input type="checkbox"/> White* <input type="checkbox"/> Cool Sand* <input type="checkbox"/> Cool Stone* <input type="checkbox"/> Gray <input type="checkbox"/> Tan <input type="checkbox"/> White* <input type="checkbox"/> Gray <input type="checkbox"/> Tan <input type="checkbox"/> Bronze <input type="checkbox"/> ChemGuard*	<input type="checkbox"/> 10 Year <input type="checkbox"/> 15 Year <input type="checkbox"/> 20 Year <input type="checkbox"/> 15 Year <input type="checkbox"/> 20 Year <input type="checkbox"/> 25 Year <input type="checkbox"/> 15 Year <input type="checkbox"/> 20 Year <input type="checkbox"/> 25 Year	<input type="checkbox"/> Total System - No Dollar Limit (NDL) <input type="checkbox"/> Warranty Plus (WP) <input type="checkbox"/> Commercial Limited Material Warranty (CLMW) <input type="checkbox"/> Residential Limited Material Warranty (RLMW)

* Meets CRRC, Title-24, & EnergyStar Standards

*** Refer to Warranty Selection Guide for Warranty Riders, Term Length Limitations, and eligibility requirements of the Warranty Program

Submitted By:
Address:
Email:

Project Name:
Address: