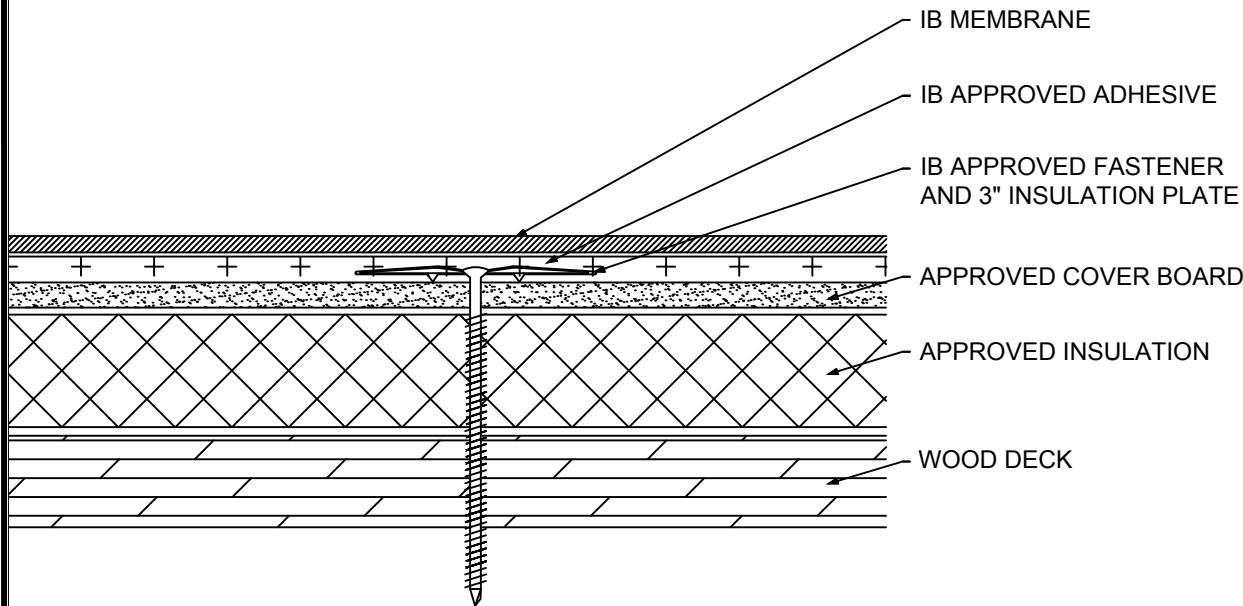

Fully Adhered Membrane - Cover Board (MA) - Insulation (MA) - Wood Deck (New or Tear-Off)

Fire Rating / Max. Slope	Deck Type	Insulation/Cover Board			IB Membrane Attachment	Max. Design Pressure**
		Type	Attachment	Fasteners		
<input type="checkbox"/> Not Classified	7/16" OSB	Min. Approved 1/4" Cover Board & Approved Insulation	16 per 4' x 8' (1 per 2 sq. ft.)	IB SD #12 or HD #14, IB 3" Insulation Plate	IB Approved Adhesive	Minimum Req. for IB Warranty
<input type="checkbox"/> Not Classified	7/16" OSB	Min. Approved 1/2" Cover Board & Approved Insulation	12 per 4' x 8' (1 per 2.67 sq. ft.)	IB SD #12 or HD #14, IB 3" Insulation Plate	IB Approved Adhesive	Minimum Req. for IB Warranty
<input type="checkbox"/> ¹ Class 'A' Unlimited	1/2" Plywood	Min. Approved 1/4" Cover Board & Approved Insulation	12 per 4' x 8' (1 per 2.67 sq. ft.)	IB SD #12 or HD #14, IB 3" Insulation Plate	IB Approved Adhesive	Minimum Req. for IB Warranty
<input type="checkbox"/> ¹ Class 'A' Unlimited	1/2" Plywood	Min. Approved 1/2" Cover Board & Approved Insulation	10 per 4' x 8' (1 per 3.2 sq. ft.)	IB SD #12 or HD #14, IB 3" Insulation Plate	IB Approved Adhesive	Minimum Req. for IB Warranty
<input type="checkbox"/> ¹ Class 'A' Unlimited	19/32" Plywood	Min. Approved 1/4" Cover Board & Approved Insulation	20 per 4' x 8' (1 per 1.6 sq. ft.)	IB SD #12 or HD #14, IB 3" Insulation Plate	IB Approved Adhesive	-45.0 psf (Class 90)
<input type="checkbox"/> ¹ Class 'A' Unlimited	19/32" Plywood	Min. Approved 1/4" Cover Board & Approved Insulation	24 per 4' x 8' (1 per 1.3 sq. ft.)	IB XHD #15, IB 3" Insulation Plate	IB Approved Adhesive	-75.0 psf (Class 150)

Approved Insulation: IB EnergyBoard II or III, or IB Approved UL Classified Polyisocyanurate, IB Approved UL Classified Expanded Polystyrene, IB Approved UL Classified Extruded Polystyrene Insulation Board; minimum ¹IB HD ISO or HShield HD ISO; or minimum ²thick Structodek HD Primed

Approved Cover Board: DensDeck Prime, DensDeck StormX, Securock Ultralight Coated Glass-Mat, Securock Gypsum Fiber Board, or DexCell FA Glass Mat Roof Board, minimum ¹thickness; or minimum 7/16" DexCell Cement Board; minimum ¹IB HD ISO or HShield HD ISO; or minimum ²thick Structodek HD Primed

Fire Classification Note(s): ¹UL Class 'A' with unlimited slope when utilized with any UL Classified insulation and any of the following gypsum cover boards: minimum ¹DensDeck Prime, Securock Ultralight Coated Glass-Mat, or DexCell FA Glass Mat Roof Board, or minimum 7/16" DexCell Cement Board with all joints staggered 6-in. from the plywood joints, mechanically attached or adhered and membrane adhered using ¹IB Vertibond 432 Bonding Adhesive¹ at 1-gal/60-ft² or ¹IB Water Borne 636 Adhesive¹ at 1-gal/140-ft². ²UL Class 'A' up to 4":12" when utilized with any UL Classified insulation and minimum ¹Securock Gypsum Fiber Board. ³UL Class 'A' up to 4":12" when utilized with minimum ¹H-Shield HD ISO over any UL Classified insulation (except expanded or extruded polystyrene), any combination, any thickness, may be used below the 1/2 in. minimum thickness. ⁴UL Class 'A' up to 4":12" when utilized with any UL Classified insulation and minimum ¹Securock Gypsum Fiber Board. ⁵Use of other IB Approved Insulations and/or IB Approved Cover Boards may not achieve UL Classification.

*** Refer to Substrate Resistance table for required pull-out values.

For additional information about IB Roof Systems requirements, recommendations, installation details, approvals and limitations for the above assemblies, please refer to the latest edition of the IB Roof Systems Specifications Manual. For Technical Services please contact us at 800-426-1626.

Membranes:	Membrane Color:	Warranty Length***	Warranty Type***
<input type="checkbox"/> IB PVC Single-Ply 50 Mil	<input type="checkbox"/> White* <input type="checkbox"/> Gray <input type="checkbox"/> Tan <input type="checkbox"/> Bronze <input type="checkbox"/> ChemGuard*	<input type="checkbox"/> 10 Year <input type="checkbox"/> 15 Year <input type="checkbox"/> 20 Year	<input type="checkbox"/> Total System - No Dollar Limit (NDL)
<input type="checkbox"/> IB PVC Single-Ply 60 Mil	<input type="checkbox"/> White* <input type="checkbox"/> Cool Sand* <input type="checkbox"/> Cool Stone* <input type="checkbox"/> Gray <input type="checkbox"/> Tan	<input type="checkbox"/> 15 Year <input type="checkbox"/> 20 Year <input type="checkbox"/> 25 Year	<input type="checkbox"/> Warranty Plus (WP)
<input type="checkbox"/> IB PVC Single-Ply 80 Mil	<input type="checkbox"/> White* <input type="checkbox"/> Gray <input type="checkbox"/> Tan <input type="checkbox"/> Bronze <input type="checkbox"/> ChemGuard*	<input type="checkbox"/> 20 Year <input type="checkbox"/> 25 Year <input type="checkbox"/> 30 Year	<input type="checkbox"/> Commercial Limited Material Warranty (CLMW)
			<input type="checkbox"/> Residential Limited Material Warranty (RLMW)

* Meets CRRC, Title-24, & EnergyStar Standards

*** Refer to Warranty Selection Guide for Warranty Riders, Term Length Limitations, and eligibility requirements of the Warranty Program

Submitted By:
Address:
Email:
Project Name:
Address: