

Fully Adhered Membrane (SP) - Insulation(MA) - Steel Deck (New or Tear-Off)

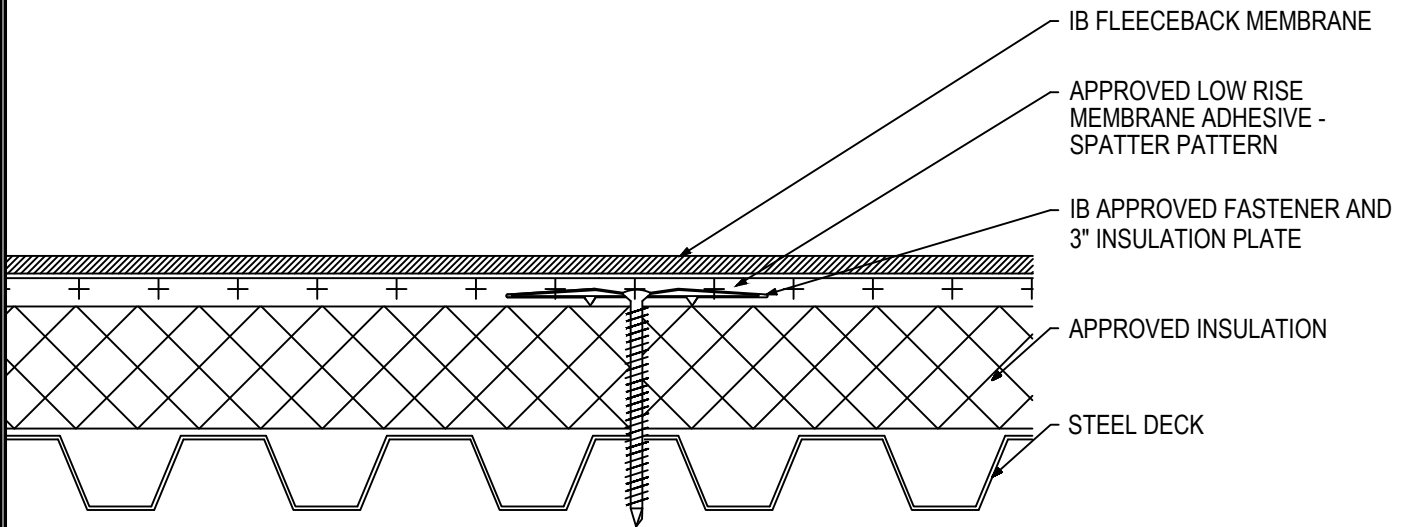

Fire Rating / Max. Slope	Deck Type	Insulation			IB Fleeceback Membrane Attachment	Max. Design Pressure**
		Type	Attachment	Fasteners		
<input type="checkbox"/> 'Class 'A' Unlimited	Min 22 ga. Type B, Grade 33 Steel	Min. 1" Approved Insulation	12 per 4' x 8' (1 per 2.67 sq. ft.)	IB SD #12 or HD #14, IB 3" Insulation Plate	CR-20 Spatter Pattern 3.75 lbs/square	Minimum Req. for IB Warranty
<input type="checkbox"/> 'Class 'A' Unlimited	Min 22 ga. Type B, Grade 33 Steel	Min. 1.5" Approved Insulation	10 per 4' x 8' (1 per 3.2 sq. ft.)	IB SD #12 or HD #14, IB 3" Insulation Plate	CR-20 Spatter Pattern 3.75 lbs/square	-30.0 psf (Class 60)
<input type="checkbox"/> 'Class 'A' Unlimited	Min 22 ga. Type B, Grade 33 Steel	Min. 1.5" Approved Insulation	16 per 4' x 8' (1 per 2.0 sq. ft.)	IB SD #12 or HD #14, IB 3" Insulation Plate	CR-20 Spatter Pattern 3.75 lbs/square	-45.0 psf (Class 90)
<input type="checkbox"/> 'Class 'A' Unlimited	Min 22 ga. Type B, Grade 33 Steel	Min. 2" Approved Insulation	8 per 4' x 8' (1 per 4.0 sq. ft.)	IB SD #12 or HD #14, IB 3" Insulation Plate	CR-20 Spatter Pattern 3.75 lbs/square	-45.0 (Class 90)
<input type="checkbox"/> 'Class 'A' Unlimited	Min 22 ga. Type B, Grade 33 Steel	Min. 2" Approved Insulation	24 per 4' x 8' (1 per 1.3 sq. ft.)	IB XHD #15, IB 3" Insulation Plate	CR-20 Spatter Pattern 3.75 lbs/square	-75.0 (Class 150)

Approved Insulation: IB Energy Board II or III, Atlas AC Foam II or III; H-Shield or H-Shield CG.

Fire Classification Note(s): ¹UL Class 'A' with unlimited slope when utilized with any of the following IB Approved ISO insulations: IB Energy Board II, IB Energy Board III, AC Foam II, AC Foam III, any thickness, mechanically attached.. ²UL Class 'A' up to 1/2":12" when utilized with minimum 1" IB H-Shield CG ISO, mechanically attached. ³The use of other IB Approved Insulations may not achieve UL classification.

**** Refer to Substrate Resistance table for required pull-out values.**

For additional information about IB Roof Systems requirements, recommendations, installation details, approvals and limitations for the above assemblies, please refer to the latest edition of the IB Roof Systems Specifications Manual. For Technical Services please contact us at 800-426-1626.

Membranes:	Membrane Color:	Warranty Length***	Warranty Type***
<input type="checkbox"/> IB PVC Single-Ply FB50 Mil	<input type="checkbox"/> White*	<input type="checkbox"/> 10 Year <input type="checkbox"/> 15 Year <input type="checkbox"/> 20 Year	<input type="checkbox"/> Total System - No Dollar Limit (NDL)
<input type="checkbox"/> IB PVC Single-Ply FB60 Mil	<input type="checkbox"/> White*	<input type="checkbox"/> 15 Year <input type="checkbox"/> 20 Year <input type="checkbox"/> 25 Year	<input type="checkbox"/> Warranty Plus (WP)
<input type="checkbox"/> IB PVC Single-Ply FB80 Mil	<input type="checkbox"/> White*	<input type="checkbox"/> 20 Year <input type="checkbox"/> 25 Year <input type="checkbox"/> 30 Year	<input type="checkbox"/> Commercial Limited Material Warranty (CLMW)
			<input type="checkbox"/> Residential Limited Material Warranty (RLMW)

* Meets CRRC, Title-24, & EnergyStar Standards

*** Refer to Warranty Selection Guide for Warranty Riders, Term Length Limitations, and eligibility requirements of the Warranty Program

Submitted By:
Address:
Email:

Project Name:
Address: