

Fully Adhered Membrane (SP) - Existing Roof (SA) - LWIC Deck (Recover)

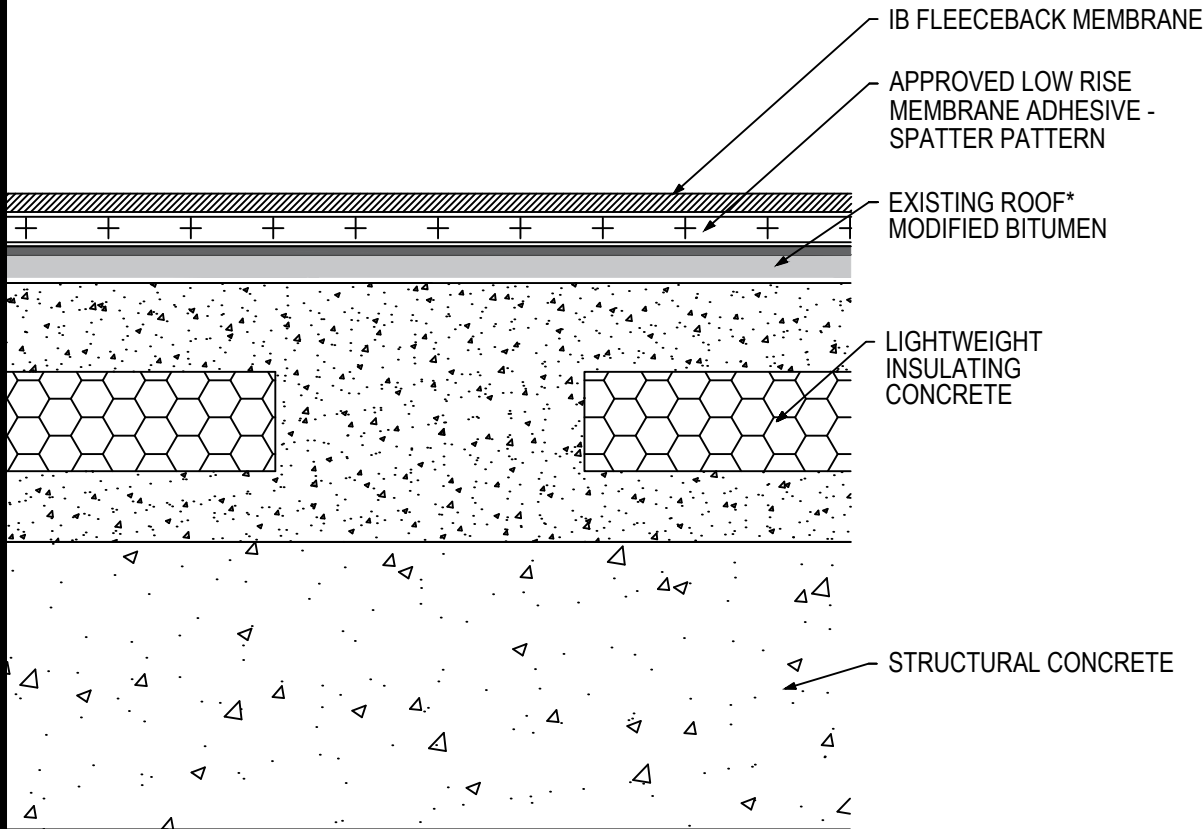

Fire Rating / Max. Slope	Deck Type	IB Fleeceback Membrane (over Existing Smooth Asphaltic Roof)	Max. Design Pressure**
		Attachment	
<input type="checkbox"/> Class 'A' 1":12"	Lightweight Concrete / Structural Concrete	CR-20 Spatter Pattern 3.75 lbs/square	-112.5 psf (Class 225)

Existing Roof: Smooth or granule surfaced asphaltic built-up roof only.

Fire Classification Note(s):¹UL Class A up to 1":12" limited to any Class A, B or C built up roof system.²The use of other IB Approved adhesives may not retain UL Classification.³Recover over modified bitumen may not retain fire classification.

** Refer to Substrate Resistance table for required pull-out values.

For additional information about IB Roof Systems requirements, recommendations, installation details, approvals and limitations for the above assemblies, please refer to the latest edition of the IB Roof Systems Specifications Manual. For Technical Services please contact us at 800-426-1626.

Membranes:	Membrane Color:	Warranty Length***	Warranty Type***
<input type="checkbox"/> IB PVC Single-Ply FB 50 Mil	<input type="checkbox"/> White*	<input type="checkbox"/> 10 Year <input type="checkbox"/> 15 Year <input type="checkbox"/> 20 Year	<input type="checkbox"/> Total System - No Dollar Limit (NDL)
<input type="checkbox"/> IB PVC Single-Ply FB 60 Mil	<input type="checkbox"/> White*	<input type="checkbox"/> 15 Year <input type="checkbox"/> 20 Year <input type="checkbox"/> 25 Year	<input type="checkbox"/> Warranty Plus (WP)
<input type="checkbox"/> IB PVC Single-Ply FB 80 Mil	<input type="checkbox"/> White*	<input type="checkbox"/> 15 Year <input type="checkbox"/> 20 Year <input type="checkbox"/> 25 Year	<input type="checkbox"/> Commercial Limited Material Warranty (CLMW)
			<input type="checkbox"/> Residential Limited Material Warranty (RLMW)

* Meets CRRC, Title-24, & EnergyStar Standards

*** Refer to Warranty Selection Guide for Warranty Riders, Term Length Limitations, and eligibility requirements of the Warranty Program

Submitted By: Address: Email:	Project Name: Address:
-------------------------------------	---------------------------