

Fully Adhered Membrane - Cover Board (RB) - Existing Roof - Concrete Deck (New or Tear-Off)

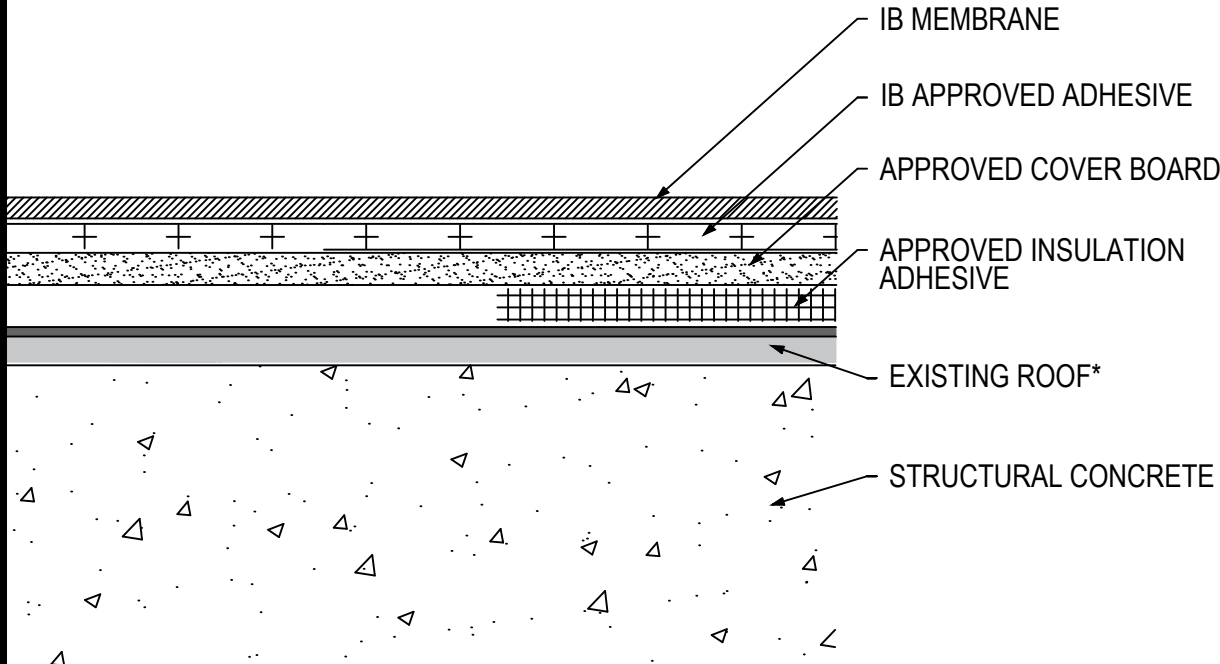

Fire Rating / Max. Slope	Deck Type	Cover Board			IB Membrane Attachment	Max. Design Pressure**
		Type	Insulation Adhesive	Pattern		
<input type="checkbox"/> Class 'A' 1":12"	Structural Concrete	1/4" DensDeck Prime	BM, CR20, OB500, OSFA, PG1, or RSIA	Four continuous ribbons, 12" o.c.	IB Approved Adhesive	-257.5 psf (Class 515)
<input type="checkbox"/> Class 'A' 1":12"	Structural Concrete	1/4" Securock Gypsum Fiber Board	BM, CR20, OB500, OSFA, PG1, or RSIA	Four continuous ribbons, 12" o.c.	IB Approved Adhesive	-267.5 psf (Class 535)

Existing Roof: APP or SBS modified bitumen, smooth or granule surfaced asphaltic built-up roof only

Approved Cover Board: DensDeck Prime, Securock Gypsum Fiber Board, minimum 1/4" thickness; or minimum 1/2" IB HD ISO; or minimum 1/2" thick Structodek HD Primed

Approved Insulation Adhesive: BM = Polyset BoardMax, CR-20 = Polyset CR-20, OB500 = OlyBond 500 Adhesive Fastener, OSFA = Millennium One-Step Foamable Adhesive; PG-1 = Millennium PG-1 Pump Grade Adhesive; or RSIA = IB Rapid Set Insulation Adhesive; maximum bead spacing 12" o.c. unless otherwise indicated.

Fire Classification Note(s): ¹UL Class A up to 1":12" limited to insulated or non-insulated cap sheet, smooth or gravel surfaced Built-Up Roof System, covered with any of the following gypsum cover boards: minimum 1/4" DensDeck Prime, Securock Ultralight Coated Glass-Mat, or DexCell FA Glass Mat Roof Board, or minimum 7/16" DexCell Cement Board. ²Maintains existing Classification for any Class A, B or C, coated or uncoated, insulated, or un-insulated, smooth surfaced, Type G3 mineral surfaced cap sheet or mineral surfaced modified bitumen membrane BUR system when utilized with minimum 1/4" Securock Gypsum Fiber Board. ³The use of other IB Approved Cover Boards may not retain UL Classification. ⁴Recover over modified bitumen or single-ply roof may not retain fire classification.

** Refer to Substrate Resistance table for required pull-out values.

For additional information about IB Roof Systems requirements, recommendations, installation details, approvals and limitations for the above assemblies, please refer to the latest edition of the IB Roof Systems Specifications Manual. For Technical Services please contact us at 800-426-1626.

Membranes:	Membrane Color:	Warranty Length***	Warranty Type***
<input type="checkbox"/> IB PVC Single-Ply 50 Mil	<input type="checkbox"/> White* <input type="checkbox"/> Gray <input type="checkbox"/> Tan <input type="checkbox"/> Bronze <input type="checkbox"/> ChemGuard*	<input type="checkbox"/> 10 Year <input type="checkbox"/> 15 Year <input type="checkbox"/> 20 Year	<input type="checkbox"/> Total System - No Dollar Limit (NDL)
<input type="checkbox"/> IB PVC Single-Ply 60 Mil	<input type="checkbox"/> White* <input type="checkbox"/> Cool Sand* <input type="checkbox"/> Cool Stone* <input type="checkbox"/> Gray <input type="checkbox"/> Tan	<input type="checkbox"/> 15 Year <input type="checkbox"/> 20 Year <input type="checkbox"/> 25 Year	<input type="checkbox"/> Warranty Plus (WP)
<input type="checkbox"/> IB PVC Single-Ply 80 Mil	<input type="checkbox"/> White* <input type="checkbox"/> Gray <input type="checkbox"/> Tan <input type="checkbox"/> Bronze <input type="checkbox"/> ChemGuard*	<input type="checkbox"/> 15 Year <input type="checkbox"/> 20 Year <input type="checkbox"/> 25 Year	<input type="checkbox"/> Commercial Limited Material Warranty (CLMW)
			<input type="checkbox"/> Residential Limited Material Warranty (RLMW)

* Meets CRRC, Title-24, & EnergyStar Standards

*** Refer to Warranty Selection Guide for Warranty Riders, Term Length Limitations, and eligibility requirements of the Warranty Program

Submitted By:

Address:

Email:

Project Name:

Address: