

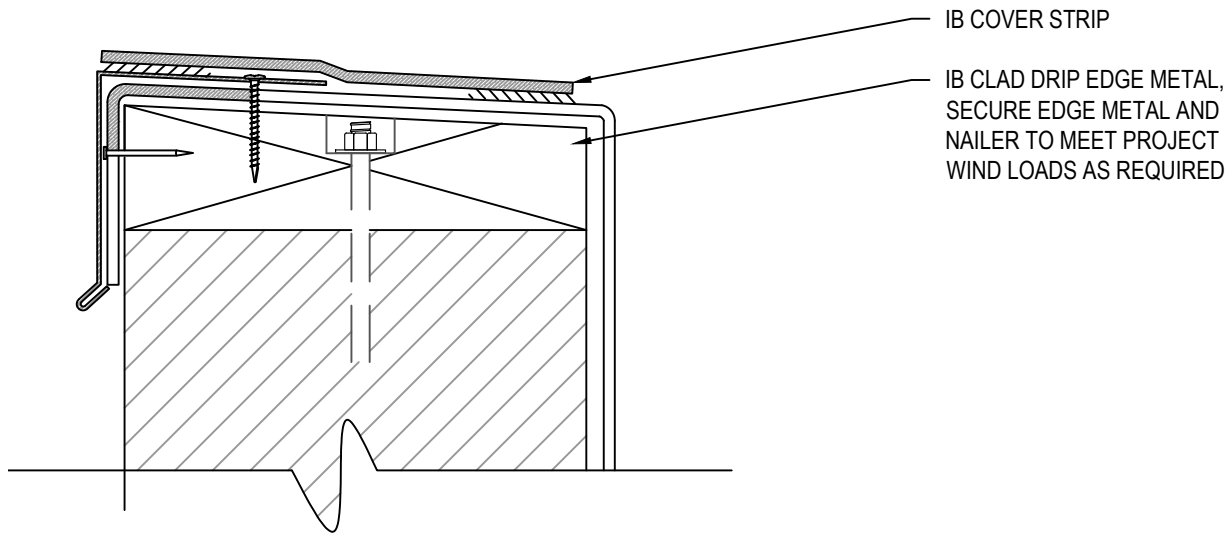

Parapet Terminations



NOTES:

- SINGLE COURSE WALL FLASHING MAXIMUM HEIGHTS:
 - 18' FOR MECHANICALLY ATTACHED FLASHING INDUCTION WELDED OR 60' FOR FULLY ADHERED FLASHINGS.
 - FOR WALLS EXCEEDING MAXIMUM HEIGHTS, REFER TO APPLICABLE TALL WALL DETAILS.
- SECURE FLASHINGS AND METAL WORK IN ACCORDANCE WITH IB SPECIFICATIONS AND FLASHING SECUREMENT TABLE.
- SEALANTS AND CAULKING REQUIRE PERIODIC OWNER MAINTENANCE.
- MAXIMUM WARRANTY TERM LIMITED TO TWENTY (20) YEARS FOR THIS DETAIL.

APPROVED SUBSTRATE / SEPARATION:

NEW CONSTRUCTION - FULLY ADHERED, INDUCTION WELDED, AND MECHANICALLY ATTACHED

- 1/2" PLYWOOD, 7/16" OSB, 1/2" APPROVED GYPSUM COVER BOARD, POURED / PRECAST CONCRETE, OR CEMENT BLOCK / MASONRY WALLS.

MECHANICALLY ATTACHED RECOVER OVER APPROVED EXISTING WALL AND BASE FLASHINGS

- FULL SEPARATION REQUIRED WITH MINIMUM 1/2" PLYWOOD, 1/4" APPROVED GYPSUM COVER BOARD, 7/16" OSB, OR APPROVED INDUCTION WELDED RECOVER OVER APPROVED EXISTING WALL AND BASE FLASHINGS

- FULL SEPARATION REQUIRED WITH MINIMUM 1/4" APPROVED GYPSUM COVER BOARD

FULLY ADHERED RECOVER OVER APPROVED EXISTING WALL AND BASE FLASHINGS

- FULL SEPARATION REQUIRED WITH MINIMUM 1/2" PLYWOOD, 1/4" APPROVED GYPSUM COVER BOARD, OR 7/16" OSB

| | | |
|---|---|----------------------------------|
| Scale: NTS | Detail Name: Parapet Fascia - IB Clad Drip Edge | Detail Number: PT - 03 |
| Submitted By: Address: Telephone: | | Project: Address: |